

Initial Application Date: 1-25-16

Application # 1650037904

CU# _____

COUNTY OF HARNETT RESIDENTIAL LAND USE APPLICATION

Central Permitting 108 E. Front Street, Lillington, NC 27546 Phone: (910) 893-7525 ext:2 Fax: (910) 893-2793 www.harnett.org/permits

****A RECORDED SURVEY MAP, RECORDED DEED (OR OFFER TO PURCHASE) & SITE PLAN ARE REQUIRED WHEN SUBMITTING A LAND USE APPLICATION****

AKA Eldon F III

LANDOWNER: DON SLOAN Mailing Address: PO BOX 145

City: SANFORD State: NC Zip: 27330 Contact No: 919 770 4693 Email: _____

APPLICANT*: BRAD D. Cummings Mailing Address: PO Box 145

City: SANFORD State: NC Zip: 27330 Contact No: 919-770-4693 Email: _____

*Please fill out applicant information if different than landowner

CONTACT NAME APPLYING IN OFFICE: BRAD D Cummings Phone # 919-770-4693

PROPERTY LOCATION: Subdivision: NA Lot #: NA Lot Size: AAK

State Road # US 421 N State Road Name: US 421 N Map Book & Page: 2014 / 321

Parcel: 130601 0005 PIN: 0601-50-5532.000

Zoning: RA 30 Flood Zone: X Watershed: WS-4 Deed Book & Page: 0000 / 0000 Power Company*: SREMC

3302 0471

*New structures with Progress Energy as service provider need to supply premise number _____ from Progress Energy.

PROPOSED USE:

SFD: (Size 60 x 40) # Bedrooms: 3 # Baths: 3 1/2 Basement(w/wo bath): N Garage: N Deck: Y Crawl Space: Y Slab: N Slab: _____ Monolithic
(Is the bonus room finished? () yes () no w/ a closet? () yes () no (if yes add in with # bedrooms))

Mod: (Size _____ x _____) # Bedrooms _____ # Baths _____ Basement (w/wo bath) _____ Garage: _____ Site Built Deck: _____ On Frame _____ Off Frame _____
(Is the second floor finished? () yes () no Any other site built additions? () yes () no)

Manufactured Home: _____ SW _____ DW _____ TW (Size _____ x _____) # Bedrooms: _____ Garage: _____ (site built? _____) Deck: _____ (site built? _____)

Duplex: (Size _____ x _____) No. Buildings: _____ No. Bedrooms Per Unit: _____

Home Occupation: # Rooms: _____ Use: _____ Hours of Operation: _____ #Employees: _____

Addition/Accessory/Other: (Size _____ x _____) Use: _____ Closets in addition? () yes () no

Water Supply: County _____ Existing Well _____ New Well (# of dwellings using well _____) *Must have operable water before final

Sewage Supply: New Septic Tank (Complete Checklist) _____ Existing Septic Tank (Complete Checklist) _____ County Sewer

Does owner of this tract of land, own land that contains a manufactured home within five hundred feet (500') of tract listed above? () yes () no

Does the property contain any easements whether underground or overhead () yes () no

Structures (existing or proposed): Single family dwellings: N/A Manufactured Homes: N/A Other (specify): _____

Required Residential Property Line Setbacks:

Front	Minimum	<u>35</u>	Actual	<u>500+</u>
Rear		<u>25</u>		<u>100+</u>
Closest Side		<u>10</u>		<u>100 80'</u>
Sidestreet/corner lot		<u>NA</u>		<u>NA</u>
Nearest Building on same lot		<u>NA</u>		<u>NA</u>

Comments: _____

SPECIFIC DIRECTIONS TO THE PROPERTY FROM LILLINGTON: _____

If permits are granted I agree to conform to all ordinances and laws of the State of North Carolina regulating such work and the specifications of plans submitted. I hereby state that foregoing statements are accurate and correct to the best of my knowledge. Permit subject to revocation if false information is provided.

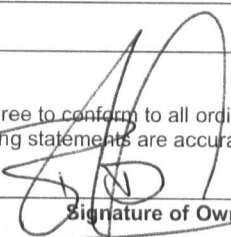

Signature of Owner or Owner's Agent

24-DEC-2015
Date

It is the owner/applicants responsibility to provide the county with any applicable information about the subject property, including but not limited to: boundary information, house location, underground or overhead easements, etc. The county or its employees are not responsible for any incorrect or missing information that is contained within these applications.

This application expires 6 months from the initial date if permits have not been issued

HARNETT COUNTY, NORTH CAROLINA
 GIS/LAND RECORDS
 Rd 5102a - 275' - US 421 4.00 Acres

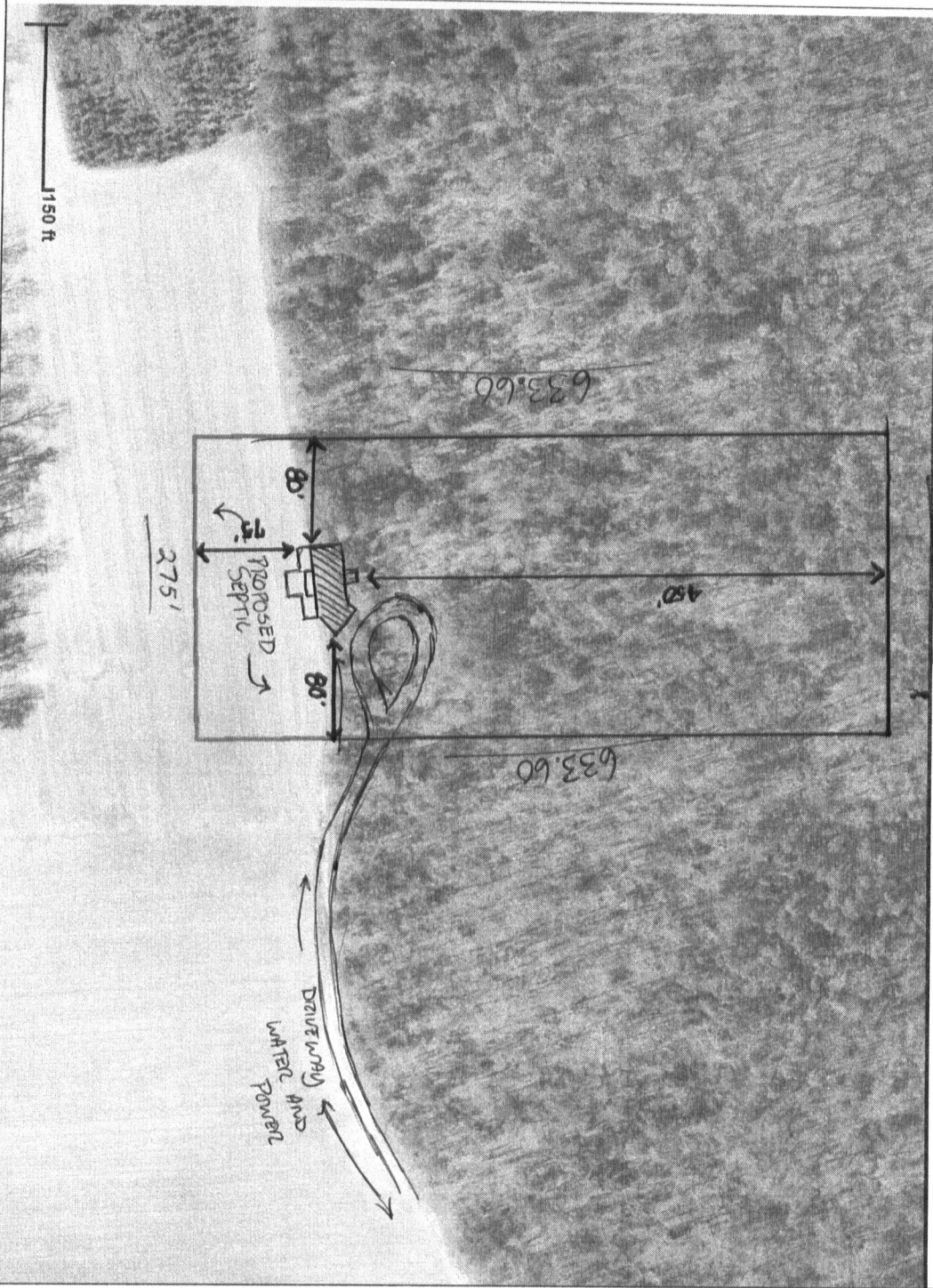

Harnett County GIS
 305 W Cornelius Harnett Blvd, Suite 100
 Lillington NC 27546
 Phone: 910-893-7523 www.harnett.org

Any use of this map shall be at the sole risk of the user of this map. Although all effort has been taken to insure accuracy in the data presented, Harnett County makes no warranty, expressed or implied as to the accuracy of this information represented herein. Any user of this product shall hold harmless Harnett County, its elected officials, employees and agents from and against any claim, damage, loss, action, cause of action, or liability arising from the use of this GIS product.

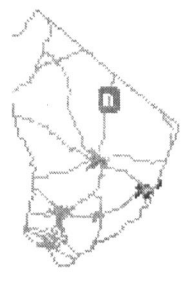

- AddressPoints
- Road Centerlines
- MajorRoads
- Rivers
- Parcels
- County_Boundary
- CityLimits
- Hammett_2013 sid
 - Red: Band_1
 - Green: Band_2
 - Blue: Band_3

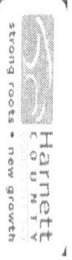

NAME: BRAD D Commmins-SLOAN

APPLICATION #: _____

This application to be filled out when applying for a septic system inspection.

County Health Department Application for Improvement Permit and/or Authorization to Construct

IF THE INFORMATION IN THIS APPLICATION IS FALSIFIED, CHANGED, OR THE SITE IS ALTERED, THEN THE IMPROVEMENT PERMIT OR AUTHORIZATION TO CONSTRUCT SHALL BECOME INVALID. The permit is valid for either 60 months or without expiration depending upon documentation submitted. (Complete site plan = 60 months; Complete plat = without expiration)

910-893-7525 option 1

CONFIRMATION # _____

- Environmental Health New Septic System** Code 800
 - **All property irons must be made visible.** Place "pink property flags" on each corner iron of lot. All property lines must be clearly flagged approximately every 50 feet between corners.
 - Place "orange house corner flags" at each corner of the proposed structure. Also flag driveways, garages, decks, out buildings, swimming pools, etc. Place flags per site plan developed at/for Central Permitting.
 - Place orange Environmental Health card in location that is easily viewed from road to assist in locating property.
 - If property is thickly wooded, Environmental Health requires that you clean out the undergrowth to allow the soil evaluation to be performed. Inspectors should be able to walk freely around site. **Do not grade property.**
 - **All lots to be addressed within 10 business days after confirmation. \$25.00 return trip fee may be incurred for failure to uncover outlet lid, mark house corners and property lines, etc. once lot confirmed ready.**
 - After preparing proposed site call the voice permitting system at 910-893-7525 option 1 to schedule and use code **800** (after selecting notification permit if multiple permits exist) for Environmental Health inspection. Please note confirmation number given at end of recording for proof of request.
 - Use Click2Gov or IVR to verify results. Once approved, proceed to Central Permitting for permits.
- Environmental Health Existing Tank Inspections** Code 800
 - Follow above instructions for placing flags and card on property.
 - Prepare for inspection by removing soil over **outlet end** of tank as diagram indicates, and lift lid straight up (*if possible*) and then **put lid back in place.** (Unless inspection is for a septic tank in a mobile home park)
 - **DO NOT LEAVE LIDS OFF OF SEPTIC TANK**
 - After uncovering **outlet end** call the voice permitting system at 910-893-7525 option 1 & select notification permit if multiple permits, then use code **800** for Environmental Health inspection. Please note confirmation number given at end of recording for proof of request.
 - Use Click2Gov or IVR to hear results. Once approved, proceed to Central Permitting for remaining permits.

SEPTIC

If applying for authorization to construct please indicate desired system type(s): can be ranked in order of preference, must choose one.

- Accepted Innovative Conventional Any
 Alternative Other _____

The applicant shall notify the local health department upon submittal of this application if any of the following apply to the property in question. If the answer is "yes", applicant **MUST ATTACH SUPPORTING DOCUMENTATION**:

- YES NO Does the site contain any Jurisdictional Wetlands?
- YES NO Do you plan to have an irrigation system now or in the future?
- YES NO Does or will the building contain any drains? Please explain. _____
- YES NO Are there any existing wells, springs, waterlines or Wastewater Systems on this property?
- YES NO Is any wastewater going to be generated on the site other than domestic sewage?
- YES NO Is the site subject to approval by any other Public Agency?
- YES NO Are there any Easements or Right of Ways on this property?
- YES NO Does the site contain any existing water, cable, phone or underground electric lines?

If yes please call No Cuts at 800-632-4949 to locate the lines. This is a free service.

I Have Read This Application And Certify That The Information Provided Herein Is True, Complete And Correct. Authorized County And State Officials Are Granted Right Of Entry To Conduct Necessary Inspections To Determine Compliance With Applicable Laws And Rules.

I Understand That I Am Solely Responsible For The Proper Identification And Labeling Of All Property Lines And Corners And Making The Site Accessible So That A Complete Site Evaluation Can Be Performed.

PROPERTY OWNERS OR OWNERS LEGAL REPRESENTATIVE SIGNATURE (REQUIRED)

25-JAN-2016
DATE

Harnett County Central Permitting
PO Box 65 Lillington NC 27546
910 893 7525 Fax 910 893 2793 www.harnett.org/permits

Each section below to be filled out by whomever performing work. Must be owner or licensed contractor. Address company name & phone must match.

Application for Residential Building and Trades Permit

Owner's Name DON SLOAN Date 25-JAN-16
Site Address 9661 US 421 NORTH, BROADWAY Phone _____
Directions to job site from Lillington 27505
 Hwy 421 TOWARDS SANFORD
 PASS SLOAN RD, PATTERSON RD
Subdivision DRIVEWAY ON LEFT Lot NA
Description of Proposed Work NEW HOME # of Bedrooms 3
Heated SF 3293 Unheated SF _____ Finished Bonus Room? N Crawl Space Y Slab N

General Contractor Information

BRAD D. CUMMINGS CONST. CO. INC 919-770-4693
Building Contractor's Company Name Telephone
PO BOX 145 SANFORD NC 27330 BRAD_CUMMINGS@YAHOO.COM
Address Email Address
68866

License #

Electrical Contractor Information

Description of Work 400 AMP NEW Service Size 400 Amps T-Pole Yes No
PIONEER ELECTRICAL 919-499-7767
Electrical Contractor's Company Name Telephone
80 NEIL THOMAS RD LILLINGTON, NC
Address Email Address
21643

License #

Mechanical/HVAC Contractor Information

Description of Work 2-NEW HVAC SYSTEMS
CAROLINA AIR 910-947-7707
Mechanical Contractor's Company Name Telephone
CARTHAGE, NC
Address Email Address
23549

License #

Plumbing Contractor Information

Description of Work NEW PLUMBING # Baths 2 1/2
WAGNER PLUMBING 910-890-2299
Plumbing Contractor's Company Name Telephone
LILLINGTON, NC
Address Email Address
31576

License #

Insulation Contractor Information

TRI-CITY 910-486-8855
Insulation Contractor's Company Name & Address Telephone

*NOTE General Contractor must fill out and sign the second page of this application

I hereby certify that I have the authority to make necessary application that the application is correct and that the construction will conform to the regulations in the Building Electrical Plumbing and Mechanical codes and the Harnett County Zoning Ordinance. I state the information on the above contractors is correct as known to me and that **by signing below I have obtained all subcontractors permission to obtain these permits** and if **any** changes occur including listed contractors site plan number of bedrooms building and trade plans Environmental Health permit changes or proposed use changes I certify it is my responsibility to notify the Harnett County Central Permitting Department of any and all changes.

EXPIRED PERMIT FEES - 6 Months to 2 years permit re-issue fee is \$150.00 After 2 years re-issue fee is as per current fee schedule

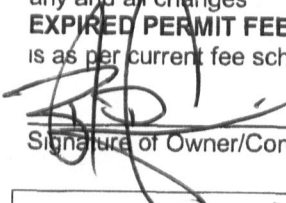
Signature of Owner/Contractor/Officer(s) of Corporation

29-DEC-2015
Date

Affidavit for Worker's Compensation N C G S 87-14

The undersigned applicant being the

General Contractor Owner Officer/Agent of the Contractor or Owner

Do hereby confirm under penalties of perjury that the person(s) firm(s) or corporation(s) performing the work set forth in the permit

Has three (3) or more employees and has obtained workers compensation insurance to cover them

Has one (1) or more subcontractors(s) and has obtained workers compensation insurance to cover them

Has one (1) or more subcontractors(s) who has their own policy of workers compensation insurance covering themselves

Has no more than two (2) employees and no subcontractors

While working on the project for which this permit is sought it is understood that the Central Permitting Department issuing the permit may require certificates of coverage of worker's compensation insurance prior to issuance of the permit and at any time during the permitted work from any person firm or corporation carrying out the work

Company or Name BRAD D. CUMMINGS

Sign w/Title PRESIDENT

Date 29-DEC-2015

HARNETT COUNTY CENTRAL PERMITTING

P.O. BOX 65

LILLINGTON, NC 27546

For Inspections Call: (910) 893-7525 Fax: (910) 893-2793

Bldg Insp scheduled before 2pm available next business day.

Application Number	16-50037904	Date	2/24/16
Property Address	US 421		
PARCEL NUMBER	13-0601- - -0005- - -		
Application type description	CP NEW RESIDENTIAL (SFD)		
Subdivision Name			
Property Zoning	PENDING		

Owner	Contractor
-------	------------

SLOAN ELDON F & B JR
 PO BOX 70
 BROADWAY NC 27505

OWNER

Applicant

CUMMINGS BRAD D
 PO BOX 145
 SANFORD NC 27330
 (919) 770-4693

--- Structure Information 000 000 60X40 3BDR CRAWL W/ DECK

Flood Zone	FLOOD ZONE X	
Other struct info	# BEDROOMS	3000000.00
	PROPOSED USE	SFD
	SEPTIC - EXISTING?	NEW TANK
	WATER SUPPLY	COUNTY

Permit	BLDG, MECH, ELEC, PLB, INSU PERMIT		
Additional desc			
Phone Access Code	1124692		
Issue Date	2/24/16	Valuation	0
Expiration Date	2/23/17		

Special Notes and Comments

T/S: 01/25/2016 12:29 PM JBROCK ----
 US 421 N PROPERTY ACROSS RD & DOWN A
 LITTLE PASSED PATTERSON RD
 XXX
 PERMIT INCLUDES BLDG, ELEC, MECH, PLUMB
 INSULATION AND LAND USE.
 XXX
 Work must conform and comply with the
 STATE BUILDING CODE and all other State
 and local laws, ordinances & regulations

HARNETT COUNTY CENTRAL PERMITTING

P.O. BOX 65

LILLINGTON, NC 27546

For Inspections Call: (910) 893-7525 Fax: (910) 893-2793

Bldg Insp scheduled before 2pm available next business day.

Application Number 16-50037904
 Property Address US 421
 PARCEL NUMBER 13-0601- - -0005- - -
 Application description CP NEW RESIDENTIAL (SFD)
 Subdivision Name
 Property Zoning PENDING

Page 2
 Date 2/24/16

Permit BLDG,MECH,ELEC,PLB,INSU PERMIT

Additional desc . . .
 Phone Access Code . . . 1124692

Required Inspections

Seq	Phone Insp#	Insp Code	Description	Initials	Date
10	101	B101	R*BLDG FOOTING / TEMP SVC POLE	_____	___/___/___
20	103	B103	R*BLDG FOUND & TEMP SVC POLE	_____	___/___/___
20-30	814	A814	ADDRESS CONFIRMATION	_____	___/___/___
30-999	105	B105	R*OPEN FLOOR	_____	___/___/___
40-50	129	I129	R*INSULATION INSPECTION	_____	___/___/___
40-60	425	R425	FOUR TRADE ROUGH IN	_____	___/___/___
40-60	125	R125	ONE TRADE ROUGH IN	_____	___/___/___
40-60	325	R325	THREE TRADE ROUGH IN	_____	___/___/___
40-60	225	R225	TWO TRADE ROUGH IN	_____	___/___/___
50-60	429	R429	FOUR TRADE FINAL	_____	___/___/___
50-60	131	R131	ONE TRADE FINAL	_____	___/___/___
50-60	329	R329	THREE TRADE FINAL	_____	___/___/___
50-60	229	R229	TWO TRADE FINAL	_____	___/___/___
999		H824	ENVIR. OPERATIONS PERMIT	_____	___/___/___