

HTE# 16-5-37764

# Harnett County Department of Public Health

28644

## Improvement Permit

A building permit cannot be issued with only an Improvement Permit

PROPERTY LOCATION: OLD US421

ISSUED TO: Brend Cummings SUBDIVISION \_\_\_\_\_ LOT # A1

NEW  REPAIR  EXPANSION

Site Improvements required prior to Construction Authorization Issuance:

Type of Structure: 500 (70x74)

Proposed Wastewater System Type: Pump To 25% Reduction

Projected Daily Flow: 360 GPD

Number of bedrooms: 3 Number of Occupants: 6 max

Basement  Yes  No

Pump Required:  Yes  No  May be required based on final location and elevations of facilities

Type of Water Supply:  Community  Public  Well Distance from well 100+ feet

Permit valid for:  Five years  No expiration

Permit conditions: \_\_\_\_\_

Authorized State Agent: [Signature] Date: 2/4/16

SEE ATTACHED SITE SKETCH

The issuance of this permit by the Health Department in no way guarantees the issuance of other permits. The permit holder is responsible for checking with appropriate governing bodies in meeting their requirements. This site is subject to revocation if the site plan, plat, or the intended use changes. The Improvement Permit shall not be affected by a change in ownership of the site. This permit is subject to compliance with the provisions of the Laws and Rules for Sewage Treatment and Disposal and to conditions of this permit.

## Construction Authorization

(Required for Building Permit)

The construction and installation requirements of Rules .1950, .1952, .1954, .1955, .1956, .1957, .1958, and .1959 are incorporated by references into this permit and shall be met. Systems shall be installed in accordance with the attached system layout.

ISSUED TO: Brend Cummings PROPERTY LOCATION: OLD US421

SUBDIVISION \_\_\_\_\_ LOT # A1

Facility Type: 500 (70x74)  New  Expansion  Repair

Basement?  Yes  No Basement Fixtures?  Yes  No

Type of Wastewater System\*\* Pump To 25% Reduction (Initial) Wastewater Flow: 360 GPD

(See note below, if applicable)  Pump To 25% Red (Repair)

### Installation Requirements/Conditions

Septic Tank Size 1000 gallons

Pump Tank Size 1000 gallons

Number of trenches 3 Exact length of each trench 100 feet

Trenches shall be installed on contour at a Maximum Trench Depth of: 18-22 inches (Trench bottoms shall be level to +/-1/4" in all directions)

Trench Spacing: 9 Feet on Center

Soil Cover: 6-10 inches (Maximum soil cover shall not exceed 36" above the trench bottom)

Pump Requirements: \_\_\_\_\_ ft. TDH vs. \_\_\_\_\_ GPM \_\_\_\_\_ inches below pipe

Aggregate Depth: \_\_\_\_\_ inches above pipe

Conditions: \_\_\_\_\_ inches total

**WATER LINES (INCLUDING IRRIGATION) MUST BE 10FT. FROM ANY PART OF SEPTIC SYSTEM OR REPAIR AREA. NO UTILITIES ALLOWED IN INITIAL OR REPAIR DRAIN FIELD AREA.**

\*\*If applicable: I understand the system type specified is different from the type specified on the application. I accept the specifications of this permit.

Owner/Legal Representative Signature: \_\_\_\_\_ Date: \_\_\_\_\_

This Construction Authorization is subject to revocation if the site plan, plat, or the intended use changes. The Construction Authorization shall not be transferred when there is a change in ownership of the site. This Construction Authorization is subject to compliance with the provisions of the Laws and Rules for Sewage Treatment and Disposal and to the conditions of this permit.

SEE ATTACHED SITE SKETCH

Authorized State Agent: [Signature] Date: 2/4/16

Construction Authorization Expiration Date: 2/4/21

HTE# 16-5-37724

Permit # 28644

# Harnett County Department of Public Health Site Sketch

ISSUED TO: BRAD CUMMINGS PROPERTY LOCATOR: OLO US421  
SUBDIVISION \_\_\_\_\_ LOT # A1

Authorized State Agent: ~~REHS (OLIVER TOLKSDORF)~~ Date: 2/4/16

DRAWING  
N55

↑  
TO  
421

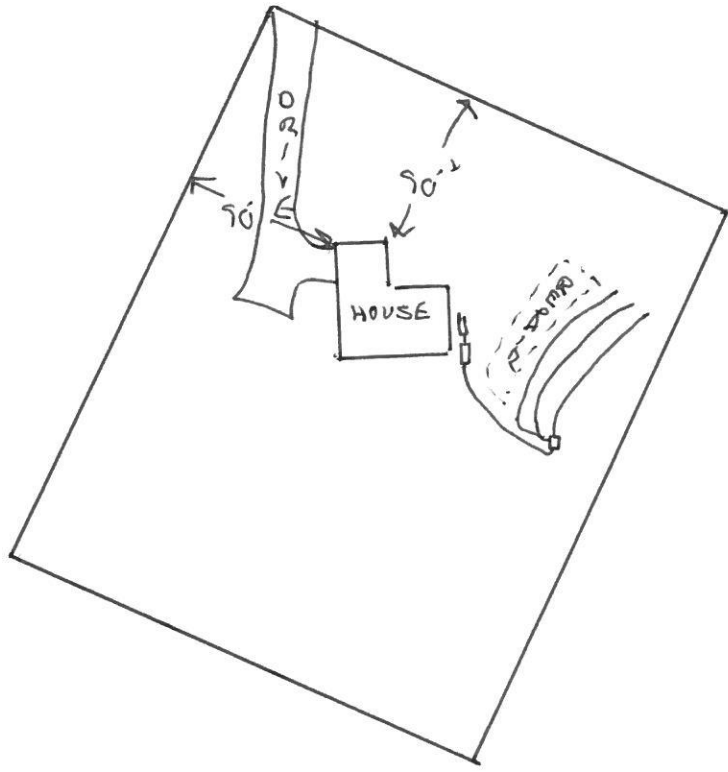

**SOIL/SITE EVALUATION  
 for ON-SITE WASTEWATER SYSTEM**

Owner:                      Applicant:  
 Address:                      Date Evaluated:  
 Proposed Facility: 3825                      Design Flow (.1949): 360 gpd                      Property Size:  
 Location of Site:                      Property Recorded:  
 Water Supply:                       Public  Individual  Well  Spring  Other  
 Evaluation Method:  Auger Boring  Pit  Cut  
 Type of Wastewater:  Sewage  Industrial Process  Mixed

P R O F I L E #	.1940 Landscape Position/ Slope %	Horizon Depth (In.)	SOIL MORPHOLOGY .1941		OTHER PROFILE FACTORS				Profile Class & LTAR
			.1941 Structure/ Texture	.1941 Consistence Mineralogy	.1942 Soil Wetness/ Color	.1943 Soil Depth (IN.)	.1956 Sapro Class	.1944 Restr Horiz	
1	LS 5-7	0-22	G S	VFI w/np					
		22-26	SPK SCL	FR SS/S					
		26-40	SPK SC	FR S/P	10-12 7/10 C 38"				P5 .3
2		0-24	G S	VFI w/np					
		24-30	SPK SC	FR S/P	10-12 7/10 C 38"				P5 .3
3		0-12	G S	VFI w/np					
		12-36	SPK SC*	FR S/P				←	P5 .3
		36-48	G S2	VFI w/np					

Description	Initial System	Repair System	Other Factors (.1946):
Available Space (.1945)	<input checked="" type="checkbox"/>	<input checked="" type="checkbox"/>	Site Classification (.1948):
System Type(s)	0 VMP 25%/6		Evaluated By: 19.8
Site LTAR	.3	3	Others Present: