

HTE# 15-5-36954

Harnett County Department of Public Health

23917

PERMIT # 28559

Operation Permit

New Installation Septic Tank Nitrification Line Repair Expansion

PROPERTY LOCATION: 52215 Harnett Central RD

Name: (owner) Cumbehead Acres SUBDIVISION Brim Keith Meadows LOT # 23

System Installer: TED BROWN Registration # _____

Basement with plumbing: Garage Number of Bedrooms 3

Type of Water Supply: Community Public Well Distance from well _____ feet

System Type: 2500 Gallon System Type B Types V and VI Systems expire in 5 years.

(In accordance with Table V a)

Owner must advise Health Department 6 months prior to expiration for permit renewal.

QUICK

This system has been installed in compliance with applicable North Carolina General Statutes, Rules for Sewage Treatment and Disposal, and all conditions of the Improvement Permit and Construction Authorization.

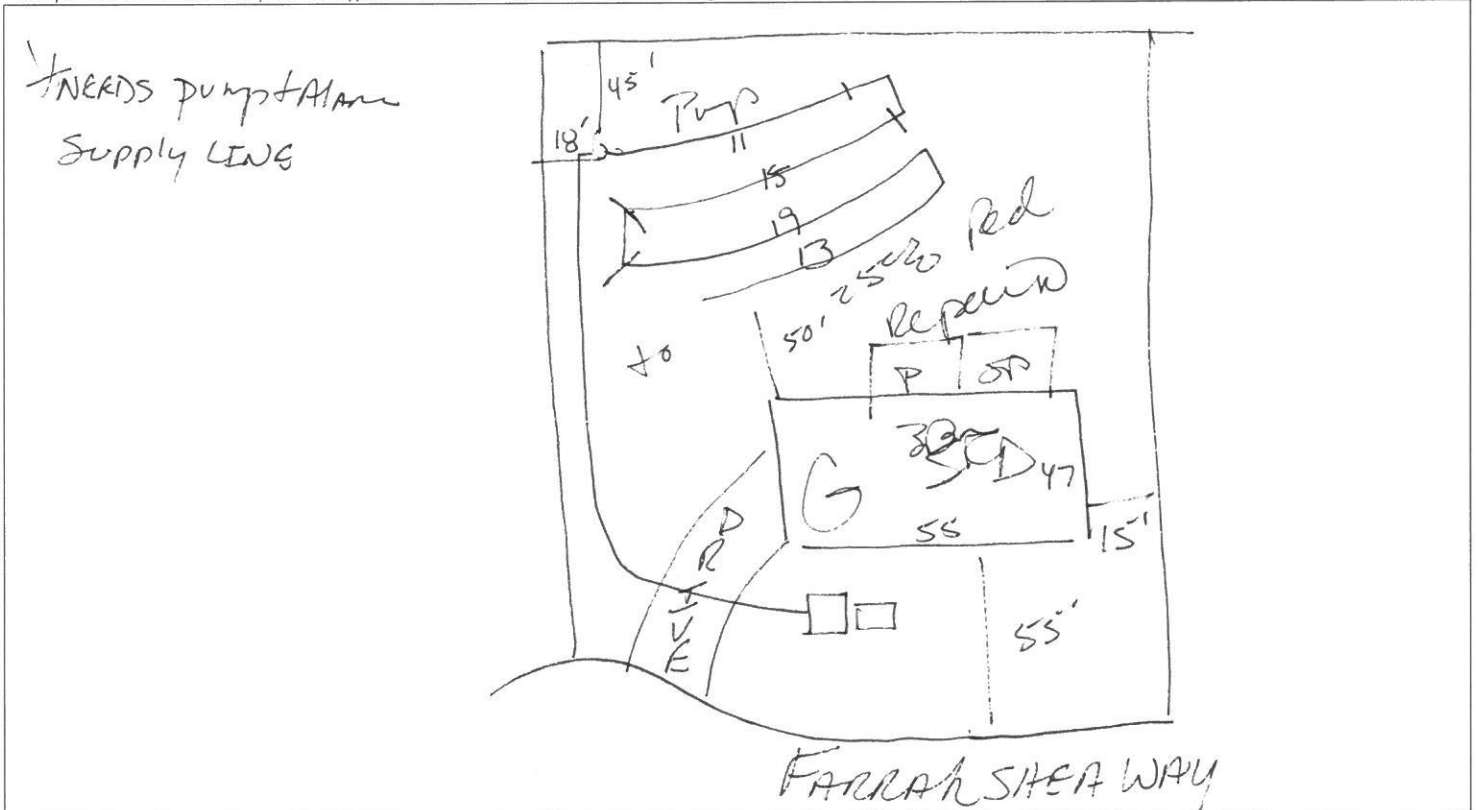

PERMIT CONDITIONS:

- I. Performance: System shall perform in accordance with Rule .1961.
- II. Monitoring: As required by Rule .1961.
- III. Maintenance: As required by Rule .1961. Other: _____
Subsurface system operator required? Yes No
If yes, see attached sheet for additional operation conditions, maintenance and reporting.
- IV. Operation: _____
- V. Other: _____

D-Box Pump Alarm H2O Line PWR Line

Following are the specifications for the sewage disposal system on the above captioned property.

Type of system: Conventional Other 2500 GPD SYSTEM Septic Tank: 1000 gallons Pump Tank: 1000 gallons
 Subsurface No. of exact length width of depth of
 Drainage Field ditches 1 of each ditch 240 feet ditches 3 feet ditches 22-18 inches
 French Drain Required: _____ Linear feet

Authorized State Agent James E. Markant Date 4-20-16