

HTE# 15-5-35834

Harnett County Department of Public Health

28363

Improvement Permit

A building permit cannot be issued with only an Improvement Permit

ISSUED TO: VEKKI LESAC PROPERTY LOCATION: 521769 OLD STAGE RD
 NEW REPAIR EXPANSION SUBDIVISION: POST INN ESTATES LOT # 10
 Type of Structure: SFD Site Improvements required prior to Construction Authorization Issuance: _____
 Proposed Wastewater System Type: 25% REDUCTION
 Projected Daily Flow: 600 GPD
 Number of bedrooms: 5 Number of Occupants: 10 max
 Basement Yes No
 Pump Required: Yes No May be required based on final location and elevations of facilities
 Type of Water Supply: Community Public Well Distance from well _____ feet Permit valid for: Five years
 Permit conditions: _____ No expiration
Contractor to meet ON SITE prior to install

Authorized State Agent: James E Markant Date: 4-27-15 SEE ATTACHED SITE SKETCH
 The issuance of this permit by the Health Department in no way guarantees the issuance of other permits. The permit holder is responsible for checking with appropriate governing bodies in meeting their requirements. This site is subject to revocation if the site plan, plat, or the intended use changes. The Improvement Permit shall not be affected by a change in ownership of the site. This permit is subject to compliance with the provisions of the Laws and Rules for Sewage Treatment and Disposal and to conditions of this permit.

Construction Authorization

(Required for Building Permit)

The construction and installation requirements of Rules .1950, .1952, .1954, .1955, .1956, .1957, .1958, and .1959 are incorporated by references into this permit and shall be met. Systems shall be installed in accordance with the attached system layout.

ISSUED TO: VEKKI LESAC PROPERTY LOCATION: 521765 OLD STAGE RD
 Facility Type: SFD New Expansion Repair
 Basement? Yes No Basement Fixtures? Yes No
 Type of Wastewater System** 25% REDUCTION SYSTEM (Pump) (Initial) Wastewater Flow: 600 GPD
 (See note below, if applicable)
Repair to 25% REDUCTION (Repair)

Installation Requirements/Conditions

Septic Tank Size <u>1200</u> gallons	Number of trenches <u>1</u>	Trench Spacing: <u>9</u> Feet on Center
Pump Tank Size <u>1200</u> gallons	Exact length of each trench <u>500</u> feet	Soil Cover: <u>6</u> inches
	Trenches shall be installed on contour at a	(Maximum soil cover shall not exceed
	Maximum Trench Depth of: <u>20-18" max</u> inches	36" above the trench bottom)
	(Trench bottoms shall be level to $\pm 1/4"$ in all directions)	
Pump Requirements: _____ ft. TDH vs. _____ GPM		Aggregate Depth: <u>6</u> inches below pipe
		<u>2</u> inches above pipe
Conditions: <u>Chamber Product MUST BE USED</u>		<u>12</u> inches total
		<u>Contractor to meet ON SITE prior to install.</u>

**WATER LINES (INCLUDING IRRIGATION) MUST BE 10FT. FROM ANY PART OF SEPTIC SYSTEM OR REPAIR AREA.
NO UTILITIES ALLOWED IN INITIAL OR REPAIR DRAIN FIELD AREA.**

**If applicable: I understand the system type specified is different from the type specified on the application. I accept the specifications of this permit.

Owner/Legal Representative Signature: _____ Date: _____

This Construction Authorization is subject to revocation if the site plan, plat, or the intended use changes. The Construction Authorization shall not be transferred when there is a change in ownership of the site. This Construction Authorization is subject to compliance with the provisions of the Laws and Rules for Sewage Treatment and Disposal and to the conditions of this permit. SEE ATTACHED SITE SKETCH

Authorized State Agent: James E Markant Date: 4-27-15
 Construction Authorization Expiration Date: 4-27-20

HTE# 15-5-35834

Permit # 28363

Harnett County Department of Public Health Site Sketch

ISSUED TO: VEKKE LISEC

PROPERTY LOCATOR: 201769 OLD STAGE RD

SUBDIVISION POST INN Estates LOT # 10

Authorized State Agent: James E. Manhart

Date: 4-27-15

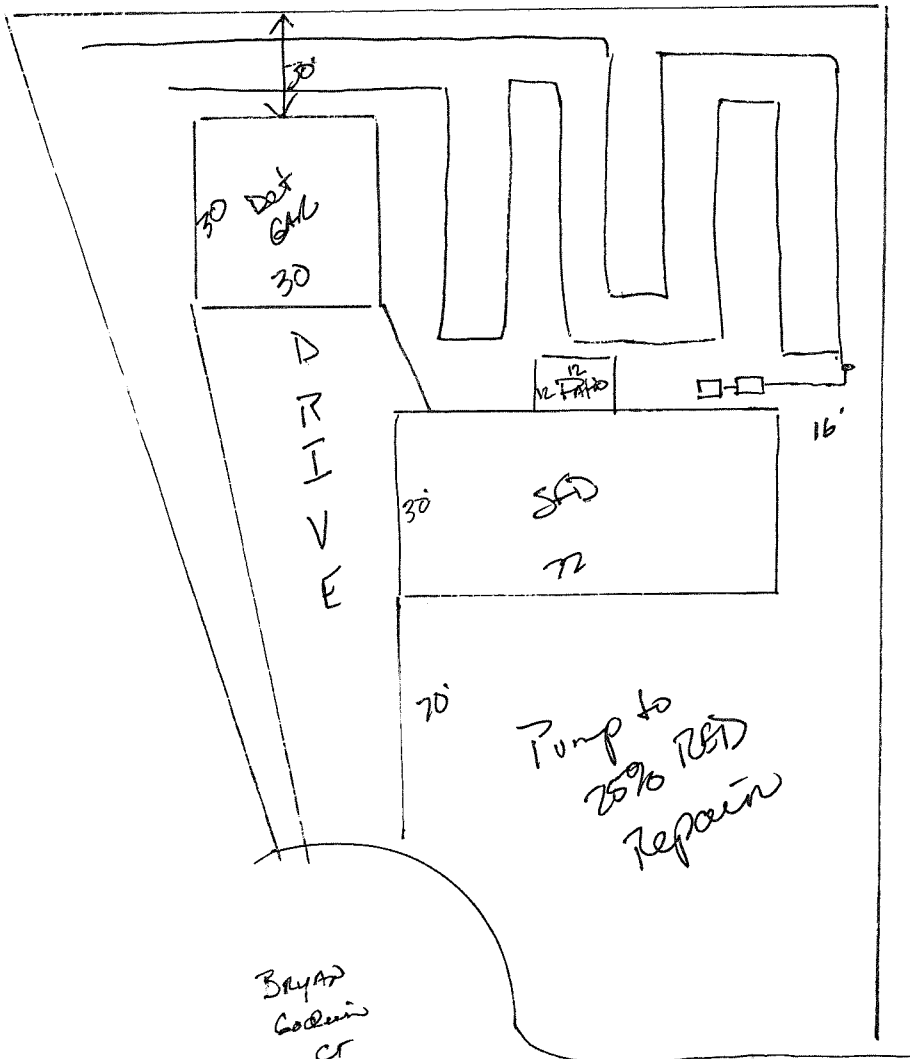

* Contractor to meet
ONSETT Prior to
INSTALL.

* Chamber Product
MUST BE USED

* SIAB Home - IF STORBED
OUT HIGH ENOUGH - Pump
WILL NOT BE REQUIRED