

HTE# 15-5-35484

Halifax County Department of Public Health

23815

PERMIT # 28234

Operation Permit

New Installation Septic Tank Nitrification Line Repair Expansion

PROPERTY LOCATION: 21215 Hammett Central RD

Name: (owner) RONALD + WANDA GIBSON SUBDIVISION PEARL MENDON LOT # 26

System Installer: Clint Adams Registration # _____

Basement with plumbing: Garage Number of Bedrooms 3

Type of Water Supply: Community Public Well Distance from well _____ feet

System Type: 2500 Reducton System Type III G - B2.0mg Types V and VI Systems expire in 5 years.

(In accordance with Table V a) Owner must contact Health Department 6 months prior to expiration for permit renewal.

This system has been installed in compliance with applicable North Carolina General Statutes, Rules for Sewage Treatment and Disposal, and all conditions of the Improvement Permit and Construction Authorization.

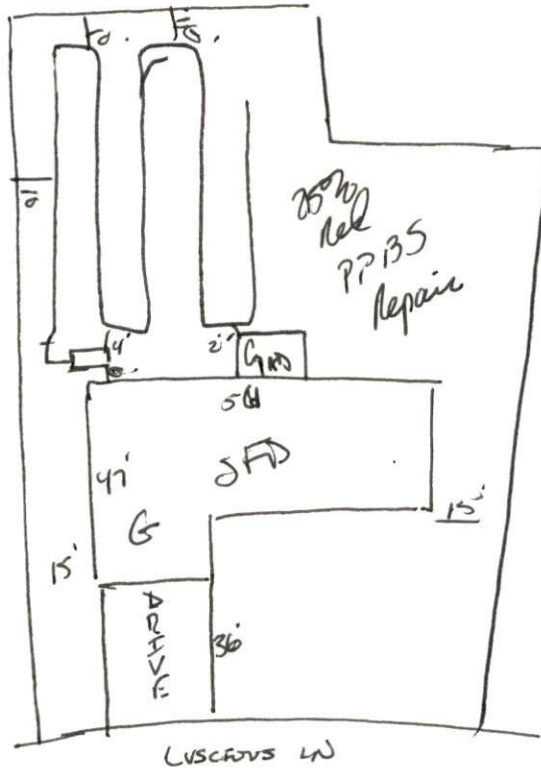

PERMIT CONDITIONS:

I. Performance: System shall perform in accordance with Rule .1961.

II. Monitoring: As required by Rule .1961.

III. Maintenance: As required by Rule .1961. Other: _____

Subsurface system operator required? Yes No

If yes, see attached sheet for additional operation conditions, maintenance and reporting.

IV. Operation: _____

V. Other: _____

D-Box Pump Alarm H2O Line PWR Line

Following are the specifications for the sewage disposal system on the above captioned property.

Type of system: Conventional Other 2500 REDUCTON Septic Tank: 1000 gallons Pump Tank: _____ gallons

Subsurface Drainage Field ditches 1 exact length of each ditch 300 feet width of ditches 3 feet depth of ditches 26-18 inches

French Drain Required: _____ Linear feet

Authorized State Agent

James E. Markham

Date 11-13-15