

HTE# 15-5-35436

Harnett County Department of Public Health

23793

PERMIT # 28373

Operation Permit

New Installation Septic Tank Nitrification Line Repair Expansion

PROPERTY LOCATION: Aug 27

Name: (owner) Jamie B Hughes SUBDIVISION Caring Caley LOT # _____

System Installer: Charles Barbore Registration # _____

Basement with plumbing: Garage Number of Bedrooms 3

Type of Water Supply: Community Public Well Distance from well _____ feet

System Type: 252 Down System Type B-12 Types V and VI Systems expire in 5 years.

(In accordance with Table V a)

Owner must contact Health Department 6 months prior to expiration for permit renewal.

This system has been installed in compliance with applicable North Carolina General Statutes, Rules for Sewage Treatment and Disposal, and all conditions of the Improvement Permit and Construction Authorization.

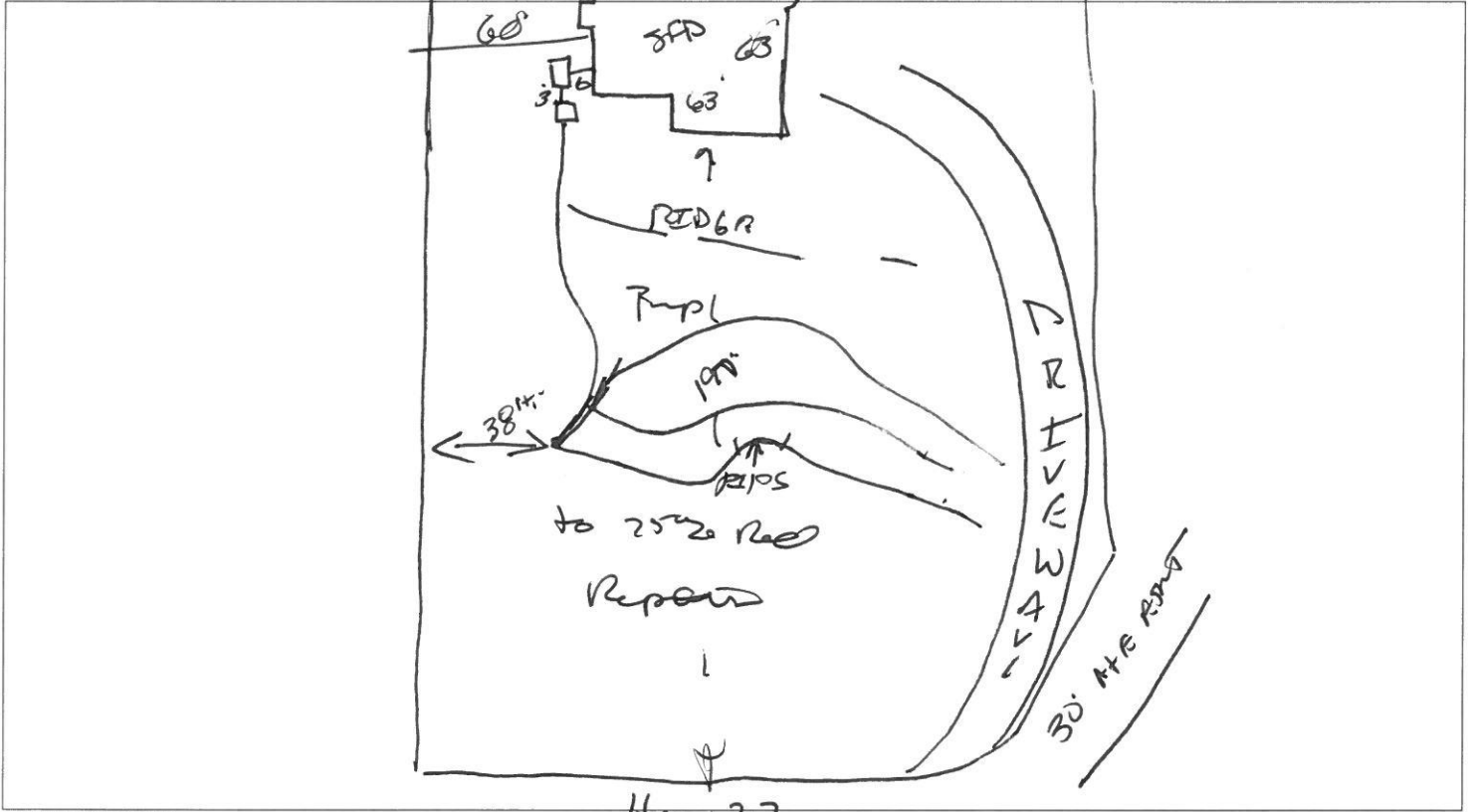

Aug 27

PERMIT CONDITIONS:

- I. Performance: System shall perform in accordance with Rule .1961.
- II. Monitoring: As required by Rule .1961.
- III. Maintenance: As required by Rule .1961. Other: _____
Subsurface system operator required? Yes No
If yes, see attached sheet for additional operation conditions, maintenance and reporting.
- IV. Operation: _____
- V. Other: _____

D-Box Pump Alarm H2O Line PWR Line

Following are the specifications for the sewage disposal system on the above captioned property.

Type of system: Conventional Other 252 Down System Septic Tank: 1060 gallons Pump Tank: 1000 gallons
 Subsurface Drainage Field No. of ditches 3 exact length of each ditch 100 feet width of ditches 3 feet depth of ditches 20-18 inches
 French Drain Required: _____ Linear feet

Authorized State Agent James E. Mahler Date 12-44-15