

PREPARED 5/21/15, 14:12:41  
Harnett County

INSPECTION TICKET  
INSPECTOR: IVR

PAGE 10  
DATE 5/22/15

-----  
ADDRESS . . : 472 PRAIRIE LN  
CONTRACTOR :  
OWNER . . : SOUTH-SCAN, INC  
PARCEL . . : 03-0507- - -0067- -45-  
APPL NUMBER: 15-50035300 CP NEW RESIDENTIAL (SFD)  
DIRECTIONS : T/S: 01/13/2015 03:57 PM VBROWN ----  
472 PRAIRIE LANE, TROTTERS BLUFF AT FOX  
RUN #46. 27W, LEFT DOCS RD, RIGHT AT  
PRAIRIE LANE.  
-----

-----  
STRUCTURE: 000 000 54X52 3BDR 2BATH SFD W GAR STEMWALLSLAB  
FLOOD ZONE . . . . : FLOOD ZONE X  
# BEDROOMS . . . . . : 3.00  
SEPTIC - EXISTING? . . . . : NEW TANK  
PROPOSED USE . . . . . : SFD  
WATER SUPPLY . . . . . : COUNTY  
-----

PERMIT: CPSF 00 CP \* SFD

TYP/SQ	REQUESTED COMPLETED	INSP RESULT	DESCRIPTION RESULTS/COMMENTS
B101 01	4/08/15 4/08/15	MR AP	R*BLDG FOOTING / TEMP SVC POLE TIME: 17:00 VRU #: 002643245 T/S: 04/07/2015 08:21 AM LBENNETT ----- T/S: 04/08/2015 02:02 PM MREARIC -----
A814 01	4/28/15 4/28/15	TW AP	ADDRESS CONFIRMATION TIME: 17:00 VRU #: 002652287 T/S: 04/27/2015 02:36 PM DJOHNSON ----- 472 PRAIRIE LN LILLINGTON 27546 T/S: 04/28/2015 11:26 AM TWARD -----
B103 01	4/28/15 4/28/15	MR AP	R*BLDG FOUND & TEMP SVC POLE TIME: 17:00 VRU #: 002652261 T/S: 04/27/2015 01:33 PM LBENNETT ----- T/S: 04/28/2015 02:29 PM MREARIC -----
P309 01	5/18/15 5/18/15	MR AP	R*PLUMB UNDER SLAB TIME: 17:00 VRU #: 002660306 T/S: 05/15/2015 02:34 PM LBENNETT ----- T/S: 05/18/2015 11:27 AM MREARIC -----
B111 01	5/22/15 <u>11</u>	TI <u>AP-MR</u>	R*BLDG SLAB INSP/TEMP SVC POLE TIME: 17:00 VRU #: 002662401 T/S: 05/21/2015 08:06 AM DJOHNSON -----

-----  
COMMENTS AND NOTES  
-----



**ECS Carolinas, LLP**

726 Ramsey Street

Suite 3

Fayetteville, NC 28301

(910) 401-3288 [Phone]

(910) 323-0539 [Fax]

NC Registered Engineering Firm # F-1078

**LETTER OF TRANSMITTAL**

May 8, 2015

South Scan, Inc  
3128 Gold Dust Lane  
Willow Springs, NC 27592

ATTN: Mr. Bert Kymalainen

**RE: Trotters Ridge Phase II**

**ECS Job # 33:2503-B**

Permits:

Location: **472 Prairie Lane, Lot 46**  
**Lillington, NC**

We are enclosing:

Materials Engineering Division Reports

For your use

As requested

ENCL:

Field Report # 1

05/07/2015

Scott Garland Dowell, PE  
Vice President / Branch Manager  
**MAY 8 2015**

Aaron Cain  
Project Manager



29362



PROJECT: 2503 B

SHEET NO: 1

TITLE: Trotters Ridge Lot 46

PROJ. NO: 2503-B

BY: J. Patton

DATE: 5-7-15

APPROVED:

SCALE: DATE:

Legend  
⊙ DCP  
Test

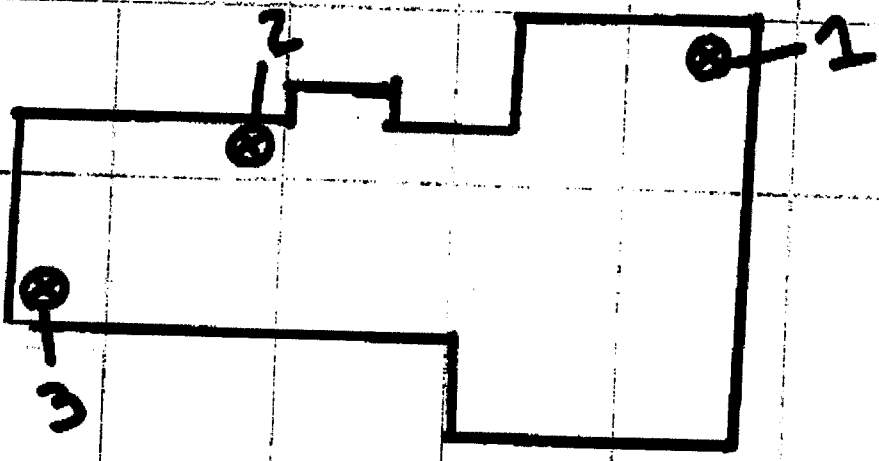

Prairie Rd

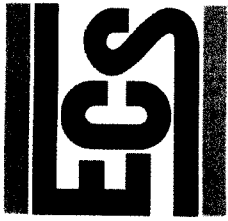

## Report of Spread Footing - Foundation Observations

Project: Trotters Ridge Phase II

Project No. 2503-B

Location: 472 Prairie Lane, Lot 46  
Lillington - Harnett County - NC -

Day/Date: 05/07/15

Contractor: South Scan, Inc

Footing Number	Location	Size (W x H x L)		Footing Bottom Elevation		Description of Subgrade Material	Required Blow Counts		Design Bearing Pressure
		Design	Actual	Design	Depth of Undercut (in)		# of Blows / increment		
1	northeast corner	x x	x x	N/A	0	light brown sand		3-5-6	2000
1	northeast corner	x x	x x	N/A	-1	light brown sand		5-6-7	2000
1	northeast corner	x x	x x	N/A	-2	light brown sandy clay		6-7-8	2000
1	northeast corner	x x	x x	N/A	-3	light brown sandy clay (trace gravel)		7-8-8	2000
1	northeast corner	x x	x x	N/A	-4	light brown sandy clay (trace gravel)		7-8-8	2000
2	northern side of pad	x x	x x	N/A	0	light brown sand		7-8-9	2000
2	northern side of pad	x x	x x	N/A	-1	light brown sand		7-8-8	2000

By: Sean J. Batton

ECS Carolinas, LLP

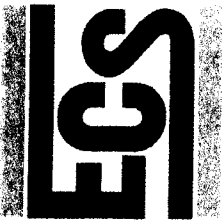

## Report of Spread Footing - Foundation Observations

Project: Trotters Ridge Phase II

Project No. 2503-B

Location: 472 Prairie Lane, Lot 46  
Lillington - Harnett County - NC -

Day/Date: 05/07/15

Contractor: South Scan, Inc

Footing Number	Location	Size (W x H x L)		Footing Bottom Elevation		Description of Subgrade Material	Required Blow Counts		Design Bearing Pressure
		Design	Actual	Design	Depth of Undercut (in)		# of Blows / increment		
2	northern side of pad	x x	x x	N/A	-2	light brown sandy clay (trace gravel)		7-7-9	2000
2	northern side of pad	x x	x x	N/A	-3	light brown sandy clay		7-7-9	2000
2	northern side of pad	x x	x x	N/A	-4	light brown sandy clay (trace gravel)		7-7-9	2000
3	southwest corner of pad	x x	x x	N/A	0	light brown sand		6-7-7	2000
3	southwest corner of pad	x x	x x	N/A	-1	light brown sand		6-7-8	2000
3	southwest corner of pad	x x	x x	N/A	-2	light brown sand		7-7-8	2000
3	southwest corner of pad	x x	x x	N/A	-3	light brown sandy clay		7-8-9	2000

By: Sean J. Batton

ECS Carolinas, LLP

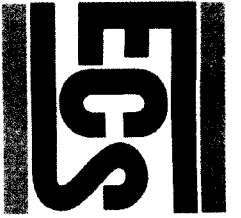

## Report of Spread Footing - Foundation Observations

Project: Trotters Ridge Phase II Project No. 2503-B  
 Location: 472 Prairie Lane, Lot 46 Day/Date: 05/07/15  
Lillington - Harrett County - NC -  
 Contractor: South Scan, Inc

Footing Number	Location	Size (W x H x L)		Footing Bottom Elevation		Description of Subgrade Material	Required Blow Counts		Design Bearing Pressure
		Design	Actual	Design	Depth of Undercut (in)		# of Blows / Increment		
3	southwest corner of pad	x x	x x	N/A	-4 .	light brown sandy clay (trace gravel)	7-8-9		2000

By: Sean J. Batton

EGS Carolinas, LLP

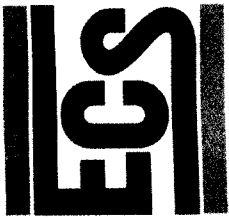

## Report of Spread Footing - Foundation Observations

Project: Trotters Ridge Phase II Project No. 2503-B

Location: 472 Prairie Lane, Lot 46 Day/Date: 05/07/15

Lillington - Hammett County - NC -

Contractor: South Scan, Inc

Footing Number	Location	Size (W x H x L)		Footing Bottom Elevation		Description of Subgrade Material	Required Blow Counts	Design Bearing Pressure
		Design	Actual	Design	Depth of Undercut (in)			
3	southwest corner of pad	x x	x x	N/A	-4	light brown sandy clay (trace gravel)	7-8-9	2000

By: Sean J. Batton

ECS Carolinas, LLP