

HTE# 15-5-35271

Harnett County Department of Public Health

28215

Improvement Permit

A building permit cannot be issued with only an Improvement Permit

PROPERTY LOCATION: 5118 1/2 BUD HAWKINS

ISSUED TO: RED DOOR Homes of Fayetteville SUBDIVISION LARRY W GODWIN LOT # 1

NEW REPAIR EXPANSION

Site Improvements required prior to Construction Authorization Issuance:

Type of Structure: SFD
Proposed Wastewater System Type: Pump to 25% REDUCTION

Projected Daily Flow: 600 GPD

Number of bedrooms: 5 Number of Occupants: 10 max

Basement Yes No

Pump Required: Yes No May be required based on final location and elevations of facilities

Type of Water Supply: Community Public Well Distance from well _____ feet

Permit valid for: Five years
 No expiration

Permit conditions: _____

Authorized State Agent: James E Markant Date: 1-30-15 SEE ATTACHED SITE SKETCH

The issuance of this permit by the Health Department in no way guarantees the issuance of other permits. The permit holder is responsible for checking with appropriate governing bodies in meeting their requirements. This site is subject to revocation if the site plan, plat, or the intended use changes. The Improvement Permit shall not be affected by a change in ownership of the site. This permit is subject to compliance with the provisions of the Laws and Rules for Sewage Treatment and Disposal and to conditions of this permit.

Construction Authorization

(Required for Building Permit)

The construction and installation requirements of Rules .1950, .1952, .1954, .1955, .1956, .1957, .1958, and .1959 are incorporated by references into this permit and shall be met. Systems shall be installed in accordance with the attached system layout.

ISSUED TO: RED DOOR Homes of Fayetteville PROPERTY LOCATION: 5118 1/2 BUD HAWKINS RD
SUBDIVISION LARRY W GODWIN LOT # 1

Facility Type: SFD New Expansion Repair

Basement? Yes No Basement Fixtures? Yes No

Type of Wastewater System** Pump to 25% REDUCTION System (Initial) Wastewater Flow: 600 GPD
(See note below, if applicable
Pump to 25% REDUCTION (Repair)

Installation Requirements/Conditions

Septic Tank Size 1200 gallons

Pump Tank Size 1200 gallons

Number of trenches 3

Exact length of each trench 200 feet

Trenches shall be installed on contour at a

Maximum Trench Depth of: 22-18 inches

(Trench bottoms shall be level to +/-1/4"

in all directions)

Trench Spacing: 9 Feet on Center

Soil Cover: 6 inches

(Maximum soil cover shall not exceed

36" above the trench bottom)

Pump Requirements: _____ ft. TDH vs. _____ GPM

Aggregate Depth: 6 inches below pipe

2 inches above pipe

Conditions: NO WATER OR PONDING IN SEPTIC OR REPAIR AREAS 12 inches total

**WATER LINES (INCLUDING IRRIGATION) MUST BE 10FT. FROM ANY PART OF SEPTIC SYSTEM OR REPAIR AREA.
NO UTILITIES ALLOWED IN INITIAL OR REPAIR DRAIN FIELD AREA.**

**If applicable: I understand the system type specified is different from the type specified on the application. I accept the specifications of this permit.

Owner/Legal Representative Signature: _____ Date: _____

This Construction Authorization is subject to revocation if the site plan, plat, or the intended use changes. The Construction Authorization shall not be transferred when there is a change in ownership of the site. This Construction Authorization is subject to compliance with the provisions of the Laws and Rules for Sewage Treatment and Disposal and to the conditions of this permit. SEE ATTACHED SITE SKETCH

Authorized State Agent: James E Markant Date: 1-30-15
Construction Authorization Expiration Date: 1-30-20

HTE# 15-5-35271

Permit # 28215

Harnett County Department of Public Health Site Sketch

PROPERTY LOCATOR: 21811 BUD HAWKINS

ISSUED TO: 26th DOOR Home of Faith SUBDIVISION Lanny W Godwin LOT # 1

Authorized State Agent: James E. Manhart Date: 1-30-15

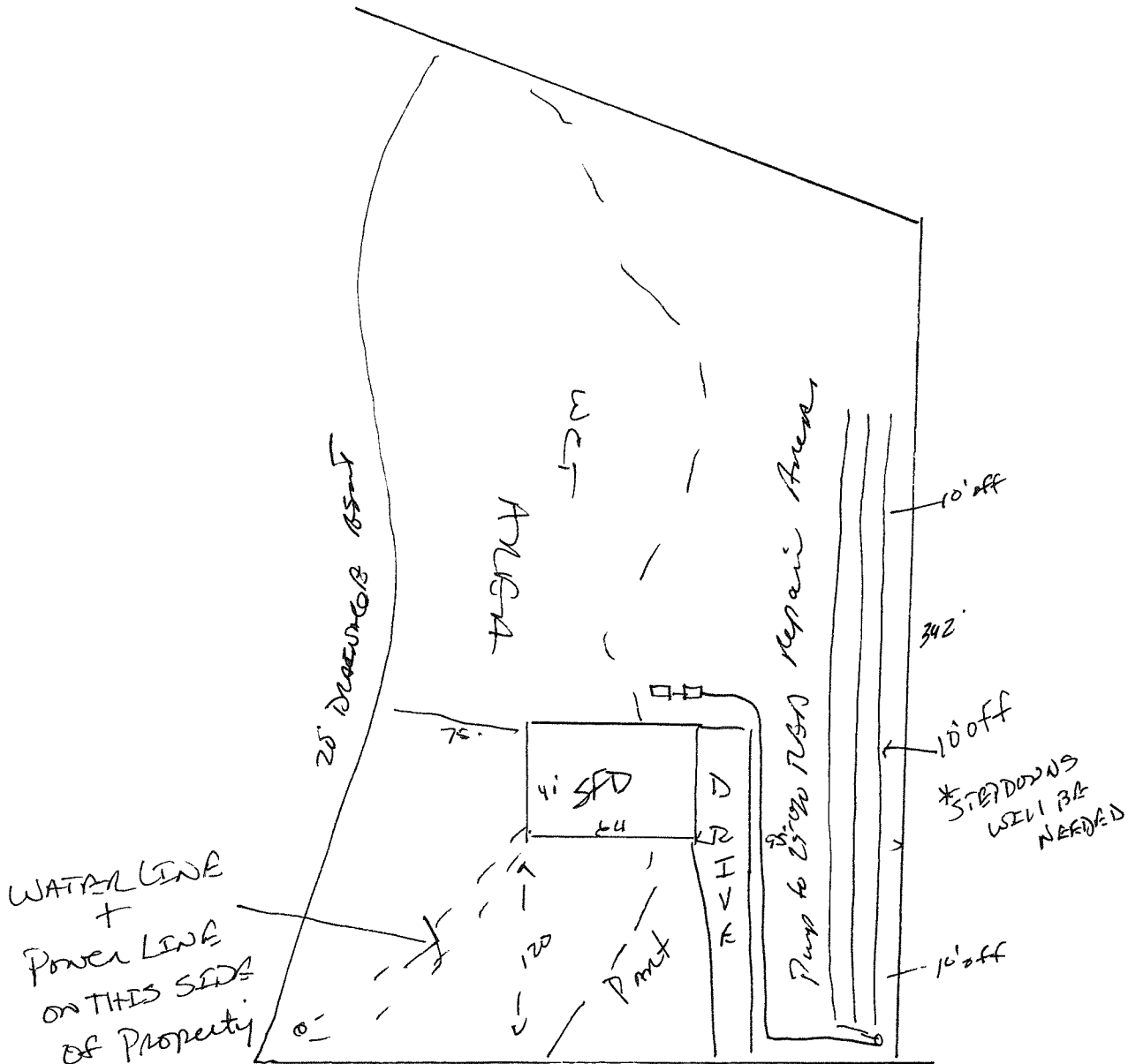

21811 BUD HAWKINS RD

**SOIL/SITE EVALUATION
 for ON-SITE WASTEWATER SYSTEM**

Owner: Applicant: *Red Door*
 Address: Date Evaluated: *1-29-11*
 Proposed Facility: *SFD* Design Flow (.1949): *600* Property Size:
 Location of Site: Property Recorded:
 Water Supply: Public Individual Well Spring Other
 Evaluation Method: Auger Boring Pit Cut
 Type of Wastewater: Sewage Industrial Process Mixed

P R O F I L E #	.1940 Landscape Position/ Slope %	Horizon Depth (In.)	SOIL MORPHOLOGY .1941		OTHER PROFILE FACTORS				Profile Class & LTAR
			.1941 Structure/ Texture	.1941 Consistence Mineralogy	.1942 Soil Wetness/ Color	.1943 Soil Depth (IN.)	.1956 Sapro Class	.1944 Restr Horiz	
1	<i>L-2%</i>	0-14	<i>Loam</i>	<i>fine sand</i>					
		14-18	<i>SLC</i>	<i>slty fine sand</i>					
		18-40	<i>SCC clay</i>	<i>fine sand</i>	<i>34-36 5.1</i>				<i>-3</i>
2	<i>L-2%</i>	0-5	<i>Loam</i>	<i>fine sand</i>					
		5-10	<i>SLC</i>	<i>slty fine sand</i>					
		10-36	<i>SCC clay</i>	<i>fine sand</i>	<i>32-30 5.1</i>				<i>-3</i>
3	<i>L-2%</i>	0-5	<i>Loam</i>	<i>fine sand</i>					
		5-10	<i>SLC</i>	<i>slty fine sand</i>					
		10-36	<i>SLC</i>	<i>fine sand</i>	<i>28-30 5.1</i>				<i>-3</i>
4	<i>L-3%</i>	0-5	<i>Loam</i>	<i>with</i>					
		<i>5 ft</i>		<i>with vegetation</i>					

Description	Initial System	Repair System	Other Factors (.1946):
Available Space (.1945)	<input checked="" type="checkbox"/>	<input checked="" type="checkbox"/>	Site Classification (.1948):
System Type(s)	<i>7.5 ft</i>	<i>7.5 ft</i>	Evaluated By: <i>PS</i>
Site LTAR	<i>1.3</i>	<i>1.3</i>	Others Present: