

Initial Application Date: 11/04/2014

Application # 1450034943

CU# _____

COUNTY OF HARNETT RESIDENTIAL LAND USE APPLICATION
Central Permitting 108 E. Front Street, Lillington, NC 27546 Phone: (910) 893-7525 ext:2 Fax: (910) 893-2793 www.harnett.org/permits

****A RECORDED SURVEY MAP, RECORDED DEED (OR OFFER TO PURCHASE) & SITE PLAN ARE REQUIRED WHEN SUBMITTING A LAND USE APPLICATION****

LANDOWNER: Comfort Homes, Inc. Fish Brothers Mailing Address: P O Box 369
City: Clayton State: NC Zip: 27528 Contact No: 919 553 3242 Email: comfrthomes@aol.com

APPLICANT: Comfort Homes, Inc. Mailing Address: P O Box 369
City: Clayton State: NC Zip: 27528 Contact No: 919 553 3242 Email: comfrthomes@aol.com

*Please fill out applicant information if different than landowner

CONTACT NAME APPLYING IN OFFICE: Julian Stewart Phone # 919 422 1481

PROPERTY LOCATION: Subdivision: Stetson Lot # 410 Lot Size: .708 ac
State Road # 1448 State Road Name: Rawls Church Road Map Book & Page 2008/193-200

Parcel: 040674 0046 40 PIN: 0665-70-7233.000

Zoning: RA-30 Flood Zone: X Watershed: IV Deed Book & Page: / Power Company*: Duke Progress Energy

*New structures with Progress Energy as service provider need to supply premise number 56126929 from Progress Energy.

PROPOSED USE:

- SFD: (Size 69'2" x 37') # Bedrooms: 3 # Baths: 2 Basement(w/wo bath): _____ Garage: Deck: Crawl Space: Slab: _____ Slab: _____
(Is the bonus room finished? () yes () no w/ a closet? () yes () no (if yes add in with # bedrooms)
- Mod: (Size _____ x _____) # Bedrooms _____ # Baths _____ Basement (w/wo bath) _____ Garage: _____ Site Built Deck: _____ On Frame _____ Off Frame _____
(Is the second floor finished? () yes () no Any other site built additions? () yes () no
- Manufactured Home: _____ SW _____ DW _____ TW (Size _____ x _____) # Bedrooms: _____ Garage: _____ (site built? _____) Deck: _____ (site built? _____)
- Duplex: (Size _____ x _____) No. Buildings: _____ No. Bedrooms Per Unit: _____
- Home Occupation: # Rooms: _____ Use: _____ Hours of Operation: _____ #Employees: _____
- Addition/Accessory/Other: (Size _____ x _____) Use: _____ Closets in addition? () yes () no

Water Supply: County _____ Existing Well _____ New Well (# of dwellings using well _____) *Must have operable water before final

Sewage Supply: New Septic Tank (Complete Checklist) _____ Existing Septic Tank (Complete Checklist) _____ County Sewer

Does owner of this tract of land, own land that contains a manufactured home within five hundred feet (500') of tract listed above? () yes () no

Does the property contain any easements whether underground or overhead () yes () no

Structures (existing or proposed): Single family dwellings: proposed Manufactured Homes: _____ Other (specify): _____

Required Residential Property Line Setbacks:

Front	Minimum	35'	Actual	51'
Rear		25'		127'
Closest Side		10'		11'
Sidestreet/corner lot		n/a		
Nearest Building on same lot		n/a		

Comments: _____

SPECIFIC DIRECTIONS TO THE PROPERTY FROM LILLINGTON: 401 N. right on Rawls Church Rd, left on Atkins Road, subdivision on righ

If permits are granted I agree to conform to all ordinances and laws of the State of North Carolina regulating such work and the specifications of plans submitted. I hereby state that foregoing statements are accurate and correct to the best of my knowledge. Permit subject to revocation if false information is provided.

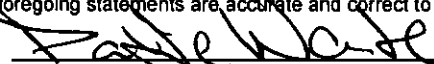

Signature of Owner or Owner's Agent

11/04/2014
Date

It is the owner/applicants responsibility to provide the county with any applicable information about the subject property, including but not limited to: boundary information, house location, underground or overhead easements, etc. The county or its employees are not responsible for any incorrect or missing information that is contained within these applications.

****This application expires 6 months from the initial date if permits have not been issued****

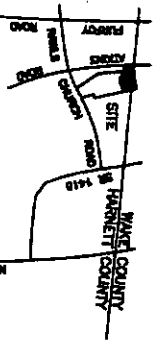

VICINITY MAP

IMPERVIOUS SURFACE COVERAGE
 2037 SQ.FT. - HOUSE & GARAGE
 126 SQ.FT. - WALK & STEPS
 1152 SQ.FT. - DRIVEWAY
 3315 TOTAL SQ.FT. - PROPOSED COVERAGE
 1103 SQ.FT. - ALLOWABLE COVERAGE
 7788 SQ.FT. - AVAILABLE COVERAGE

NOTE: BEING LOT 40 OF STEIJSOON SUBDIVISION, RECORDED IN MAP NUMBER 2008 PGS. 193-196 AND RE-RECORDED IN MAP NUMBER 2008 PGS. 199-200.

NOTE: AREA COMPUTED BY COORDINATE METHOD.

NOTE: NO NCGS CONTROL MONUMENT WITHIN 2000'.

NOTE: LOTS TO BE SERVED BY HARNETT COUNTY WATER AND INDIVIDUAL SEPTIC SYSTEMS.

NOTE: THIS PROPERTY IS SUBJECT TO EASEMENTS AND RESTRICTIONS OF RECORD.

PRELIMINARY PLAT - NOT FOR RECORDATION, CONVEYANCES, OR SALES.

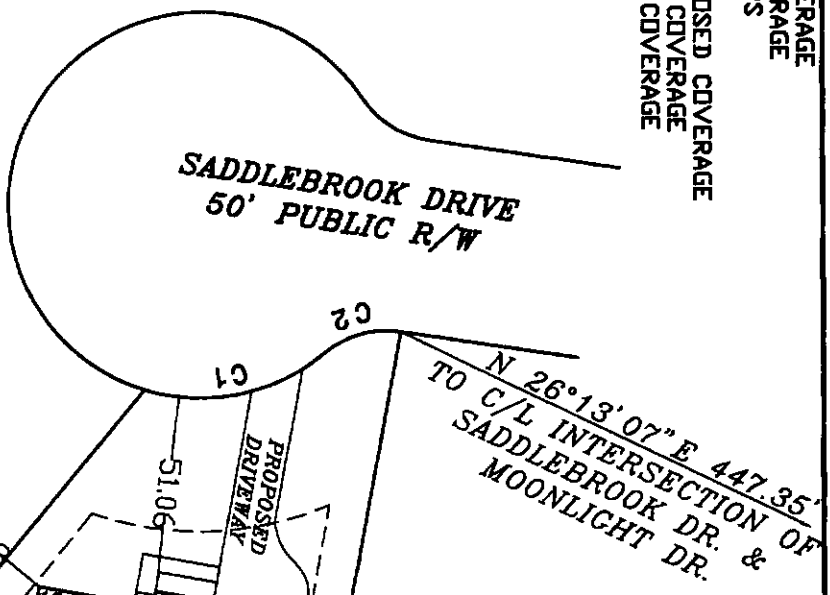
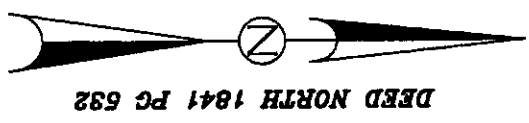

Curve	Radius	Length	Chord	Chord Bear.
C1	50.00'	49.44'	47.45'	N 11°00'58" W
C2	25.00'	21.03'	20.41'	N 15°14'59" W

LOT 39 OF MAP NUMBER 2008-199

**PLOT PLAN FOR
 COMFORT HOMES
 BLACK RIVER TOWNSHIP
 HARNETT COUNTY
 NORTH CAROLINA**

I, Danny D. Williams, certify that this map was drawn under my supervision that the boundaries not surveyed are indicated as drawn from information in Map Number 2008, Pages 193-196, the title being as stated, precision or positional accuracy is 1/10,000 and that this map meets the requirements of The Standards of Practice for Land Surveyors in North Carolina (21 NCAC 56.1600).
 This 29th day of October, 2014.

Seal

DANNY D. WILLIAMS
 LAND SURVEYOR
 PROFESSIONAL SEAL
 License No. 294

NOTE: NOT AN ACTUAL FIELD SURVEY. INFORMATION DERIVED FROM MAP NUMBER 2008 PGS 193-196.

WILLIAMS - PEARCE and ASSOC.,
 PROFESSIONAL LAND SURVEYORS, P.A.
 1000 N. ARENDELL AVE.
 P.O. BOX 892, ZEBULON, N.C. 27597
 PHONE: 919-269-9605 LIC. # C-0243

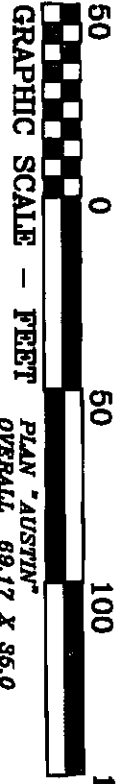

DRAWN BY: DDW & BGW
 CHECKED BY: DDW
 DATE: 10-29-2014
 SCALE: 1" = 50'
 JOB: STEIJSOON CF

LOT 35 OF MAP NUMBER 2008-199

LOT 36 OF MAP NUMBER 2008-199

LOT 40
 0.708 ACRE

LOT 41 OF MAP NUMBER 2008-199

Harnett County Central Permitting
PO Box 65 Lillington NC 27546
910 893 7525 Fax 910 893 2793 www.harnett.org/permits

Each section below to be filled out by whomever performing work. Must be owner or licensed contractor. Address company name & phone must match.

Application for Residential Building and Trades Permit

Owner's Name Comfort Homes Inc. Date 10-31-11
Site Address 99 Saddlebrook Drive Phone 919-553-3242
Directions to job site from Lillington 401 North, Right on Rawls Church Rd, left on Atkins Road, subdivision on right
Subdivision Stetson Lot 40
Description of Proposed Work Construction of Single Family Home # of Bedrooms 3
Heated SF 1402 Unheated SF 576 Finished Bonus Room? NO Crawl Space Slab

General Contractor Information

Comfort Homes Inc Telephone 919-553-3242
Building Contractor's Company Name
PO Box 309, Clayton NC 27528 Email Address comfathomes@aol.com
Address 33184
License # _____

Electrical Contractor Information

Description of Work Rough in + trim out Service Size 200 Amps T-Pole Yes No
Summerfield Electric Telephone 919-975-0599
Electrical Contractor's Company Name
705 Thanksgiving Val. Fire Dep. Rd. Selma NC Email Address _____
Address 22825
License # _____

Mechanical/HVAC Contractor Information

Description of Work Rough in + trim out + other Ventilation
Stephenson Heating + Air Telephone 919-329-0686
Mechanical Contractor's Company Name
343 Shipwash Dr. Garner NC - 27529 Email Address _____
Address 18644
License # _____

Plumbing Contractor Information

Description of Work Rough in + Trimouts # Baths _____
Ambit Plumbing Telephone 919-934-1379
Plumbing Contractor's Company Name
755 Rock Pillar Rd. Clayton NC 27520 Email Address _____
Address 20823
License # _____

Insulation Contractor Information

Tatum Insulation - 519 old Drug Store Pl. Garner Telephone 919-661-0999
Insulation Contractor's Company Name & Address

*NOTE General Contractor must fill out and sign the second page of this application

I hereby certify that I have the authority to make necessary application that the application is correct and that the construction will conform to the regulations in the Building Electrical Plumbing and Mechanical codes and the Harnett County Zoning Ordinance. I state the information on the above contractors is correct as known to me and that by signing below I have obtained all subcontractors permission to obtain these permits and if any changes occur including listed contractors site plan number of bedrooms building and trade plans Environmental Health permit changes or proposed use changes I certify it is my responsibility to notify the Harnett County Central Permitting Department of any and all changes.

EXPIRED PERMIT FEES - 6 Months to 2 years permit re-issue fee is \$150.00 After 2 years re-issue fee is as per current fee schedule

Rallie Waite
Signature of Owner/Contractor/Officer(s) of Corporation

10-31-14
Date

Affidavit for Worker's Compensation N C G S 87-14

The undersigned applicant being the

General Contractor Owner Officer/Agent of the Contractor or Owner

Do hereby confirm under penalties of perjury that the person(s) firm(s) or corporation(s) performing the work set forth in the permit

Has three (3) or more employees and has obtained workers compensation insurance to cover them

Has one (1) or more subcontractors(s) and has obtained workers compensation insurance to cover them

Has one (1) or more subcontractors(s) who has their own policy of workers compensation insurance covering themselves

Has no more than two (2) employees and no subcontractors

While working on the project for which this permit is sought it is understood that the Central Permitting Department issuing the permit may require certificates of coverage of worker's compensation insurance prior to issuance of the permit and at any time during the permitted work from any person firm or corporation carrying out the work

Company or Name Comfort Homes Inc

Sign w/Title Rallie Waite assist Sec'y Date 10-31-14

NAME: Confort Homes, Inc.

APPLICATION #: _____

This application to be filled out when applying for a septic system inspection.

County Health Department Application for Improvement Permit and/or Authorization to Construct

IF THE INFORMATION IN THIS APPLICATION IS FALSIFIED, CHANGED, OR THE SITE IS ALTERED, THEN THE IMPROVEMENT PERMIT OR AUTHORIZATION TO CONSTRUCT SHALL BECOME INVALID. The permit is valid for either 60 months or without expiration depending upon documentation submitted. (Complete site plan = 60 months; Complete plat = without expiration)

910-893-7525 option 1

CONFIRMATION # _____

Environmental Health New Septic System Code 800

- **All property irons must be made visible.** Place "pink property flags" on each corner iron of lot. All property lines must be clearly flagged approximately every 50 feet between corners.
- Place "orange house corner flags" at each corner of the proposed structure. Also flag driveways, garages, decks, out buildings, swimming pools, etc. Place flags per site plan developed at/for Central Permitting.
- Place orange Environmental Health card in location that is easily viewed from road to assist in locating property.
- If property is thickly wooded, Environmental Health requires that you clean out the undergrowth to allow the soil evaluation to be performed. Inspectors should be able to walk freely around site. **Do not grade property.**
- **All lots to be addressed within 10 business days after confirmation. \$25.00 return trip fee may be incurred for failure to uncover outlet lid, mark house corners and property lines, etc. once lot confirmed ready.**
- After preparing proposed site call the voice permitting system at 910-893-7525 option 1 to schedule and use code 800 (after selecting notification permit if multiple permits exist) for Environmental Health inspection. Please note confirmation number given at end of recording for proof of request.
- Use Click2Gov or IVR to verify results. Once approved, proceed to Central Permitting for permits.

Environmental Health Existing Tank Inspections Code 800

- Follow above instructions for placing flags and card on property.
- Prepare for inspection by removing soil over outlet end of tank as diagram indicates, and lift lid straight up (*if possible*) and then **put lid back in place.** (Unless inspection is for a septic tank in a mobile home park)
- **DO NOT LEAVE LIDS OFF OF SEPTIC TANK**
- After uncovering outlet end call the voice permitting system at 910-893-7525 option 1 & select notification permit if multiple permits, then use code 800 for Environmental Health inspection. Please note confirmation number given at end of recording for proof of request.
- Use Click2Gov or IVR to hear results. Once approved, proceed to Central Permitting for remaining permits.

SEPTIC

If applying for authorization to construct please indicate desired system type(s): can be ranked in order of preference. must choose one.

- Accepted Innovative Conventional Any
 Alternative Other _____

The applicant shall notify the local health department upon submittal of this application if any of the following apply to the property in question. If the answer is "yes", applicant **MUST ATTACH SUPPORTING DOCUMENTATION**:

- YES NO Does the site contain any Jurisdictional Wetlands? unknown
 YES NO Do you plan to have an irrigation system now or in the future?
 YES NO Does or will the building contain any drains? Please explain. _____
 YES NO Are there any existing wells, springs, waterlines or Wastewater Systems on this property?
 YES NO Is any wastewater going to be generated on the site other than domestic sewage?
 YES NO Is the site subject to approval by any other Public Agency?
 YES NO Are there any Easements or Right of Ways on this property?
 YES NO Does the site contain any existing water, cable, phone or underground electric lines? - only @ street right of way

If yes please call No Cuts at 800-632-4949 to locate the lines. This is a free service.

I Have Read This Application And Certify That The Information Provided Herein Is True, Complete And Correct. Authorized County And State Officials Are Granted Right Of Entry To Conduct Necessary Inspections To Determine Compliance With Applicable Laws And Rules. I Understand That I Am Solely Responsible For The Proper Identification And Labeling Of All Property Lines And Corners And Making The Site Accessible So That A Complete Site Evaluation Can Be Performed.

PROPERTY OWNERS OR OWNERS LEGAL REPRESENTATIVE SIGNATURE (REQUIRED)

10-31-14
DATE

DO NOT REMOVE!

Details: Appointment of Lien Agent

Entry #: 209930

Filed on: 10/30/2014

Initially filed by: ComfortHomes

Designated Lien Agent

WFG National Title Insurance Company

Online: www.liensnc.com <http://www.liensnc.com>

Address: 19 W. Hargett St., Suite 507 / Raleigh, NC 27601

Phone: 888-690-7384

Fax: 913-489-5231

Email: support@liensnc.com help@support.liensnc.com

Project Property

Stetson Lot 40
99 SADDLEBROOK DRIVE
FUQUAY-VARINA, NC 27526
Harnett County

Property Type

1-2 Family Dwelling

Print & Post



Contractors:

Please post this notice on the Job Site.

Suppliers and Subcontractors:

Scan this image with your smart phone to view this filing. You can then file a Notice to Lien Agent for this project.

Owner Information

Comfort Homes, Inc.
P O Box 369
Clayton, NC 27528
United States
Email: comfthomes@aol.com
Phone: 919-553-3242

View Comments (0)

Technical Support Hotline: (888) 690-7384

October 31, 2014

Comfort Homes, Inc. has an option to purchase Lots 4, 25, and 40 in Stetson Subdivision, recorded in Map Book 2008, Pages 193-200, Harnett County Register of Deeds.

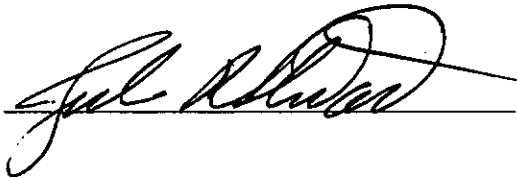
 (Seal)

I, Patricia F. Waite, do hereby certify that Julian R. Stewart, President of Comfort Homes, Inc., personally appeared before me this day and acknowledged the due execution of the foregoing instrument.

Witness my hand and Notarial Seal, this 3rd day of November 2014.

 (Notary Public)

My commission expires 4/2/17.

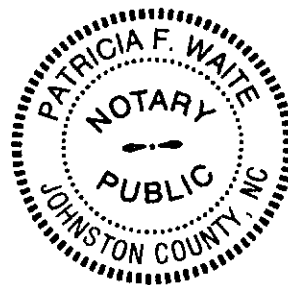

Station # 99

Plan Box # C-6

Date 11-14-14

Job Name Comfort Homes

App # 14500 34943

Valuation \$ 91,116
Not incl. garage

Heated SQ Feet 1402

Garage _____

Inspections for SFD/SFA

Crawl Slab _____ Mono _____ Basement _____

Footing	Footing	Plum Under Slab	Footing
Foundation	Foundation	Ele. Under Slab	Foundation
Address	Address	Address	Waterproofing
Open Floor	Slab	Mono Slab	Plum Under slab
Rough In	Rough In	Rough In	Address
Insulation	Insulation	Insulation	Slab
Final	Final	Final	Open Floor
			Rough In
			Insulation
			Final

Foundation Survey No

Envir. Health New

Other _____

Additions / Other

Footing _____

Foundation _____

Slab _____

Mono _____

Open Floor _____

Rough In _____

Insulation _____

Final _____

HARNETT COUNTY CENTRAL PERMITTING
P.O. BOX 65
LILLINGTON, NC 27546
For Inspections Call: (910) 893-7525 Fax: (910) 893-2793
Bldg Insp scheduled before 2pm available next business day.

Application Number 14-50034943 Date 12/08/14
Property Address 99 SADDLEBROOK DR
PARCEL NUMBER 04-0674- - -0046- -40-
Application type description CP NEW RESIDENTIAL (SFD)
Subdivision Name STETSON 53LOTS
Property Zoning RES/AGRI DIST - RA-30

Owner	Contractor
-----	-----
FISH BROTHERS INC	COMFORT HOMES INC
7440 KENNEBEC RD	PO BOX 369
WILLOW SPRINGS NC 27592	CLAYTON NC 27520
	(919) 553-3242

Applicant

COMFORT HOMES INC #99

--- Structure Information 000 000 70X37 3BDR 2BATH SFD W GAR DECK CRAWL
Flood Zone FLOOD ZONE X
Other struct info # BEDROOMS 3.00
PROPOSED USE SFD
SEPTIC - EXISTING? NEW TANK
WATER SUPPLY COUNTY

Permit BLDG, MECH, ELEC, PLB, INSU PERMIT
Additional desc
Phone Access Code 1062793
Issue Date 12/08/14 Valuation 0
Expiration Date 12/08/15

Special Notes and Comments
T/S: 11/17/2014 09:00 AM VBROWN ----
99 SADDLEBROOK DRIVE FUQ VAR, STETSON
SUB DIV #99
XX
PERMIT INCLUDES BLDG, ELEC, MECH, PLUMB
INSULATION AND LAND USE.
XX
Work must conform and comply with the
STATE BUILDING CODE and all other State
and local laws, ordinances & regulations

HARNETT COUNTY CENTRAL PERMITTING
P.O. BOX 65
LILLINGTON, NC 27546
For Inspections Call: (910) 893-7525 Fax: (910) 893-2793
Bldg Insp scheduled before 2pm available next business day.

Application Number 14-50034943 Page 2
Property Address 99 SADDLEBROOK DR Date 12/08/14
PARCEL NUMBER 04-0674- - -0046- -40-
Application description . . . CP NEW RESIDENTIAL (SFD)
Subdivision Name STETSON 53LOTS
Property Zoning RES/AGRI DIST - RA-30

Permit BLDG, MECH, ELEC, PLB, INSU PERMIT

Additional desc . . .
Phone Access Code . 1062793

Required Inspections

Seq	Phone Insp#	Insp Code	Description	Initials	Date
10	101	B101	R*BLDG FOOTING / TEMP SVC POLE	_____	___/___/___
20	103	B103	R*BLDG FOUND & TEMP SVC POLE	_____	___/___/___
20-30	814	A814	ADDRESS CONFIRMATION	_____	___/___/___
30-999	105	B105	R*OPEN FLOOR	_____	___/___/___
40-50	129	I129	R*INSULATION INSPECTION	_____	___/___/___
40-60	425	R425	FOUR TRADE ROUGH IN	_____	___/___/___
40-60	125	R125	ONE TRADE ROUGH IN	_____	___/___/___
40-60	325	R325	THREE TRADE ROUGH IN	_____	___/___/___
40-60	225	R225	TWO TRADE ROUGH IN	_____	___/___/___
50-60	429	R429	FOUR TRADE FINAL	_____	___/___/___
50-60	131	R131	ONE TRADE FINAL	_____	___/___/___
50-60	329	R329	THREE TRADE FINAL	_____	___/___/___
50-60	229	R229	TWO TRADE FINAL	_____	___/___/___
999		H824	ENVIR. OPERATIONS PERMIT	_____	___/___/___