

HTE# 14-5-34752

# Harnett County Department of Public Health

23556

PERMIT # 28049

## Operation Permit

New Installation  Septic Tank  Nitrification Line  Repair  Expansion

PROPERTY LOCATION: CHERRY HILL DR

Name: (owner) McKEE HOMES SUBDIVISION ORAMONT LOT # 107

System Installer: EDDIE GARNER Registration # \_\_\_\_\_

Basement with plumbing:  Garage  Number of Bedrooms 4

Type of Water Supply:  Community  Public  Well Distance from well 100 feet

System Type: IIIb Types V and VI Systems expire in 5 years.

(In accordance with Table V a)

Owner must contact Health Department 6 months prior to expiration for permit renewal.

This system has been installed in compliance with applicable North Carolina General Statutes, Rules for Sewage Treatment and Disposal, and all conditions of the Improvement Permit and Construction Authorization.

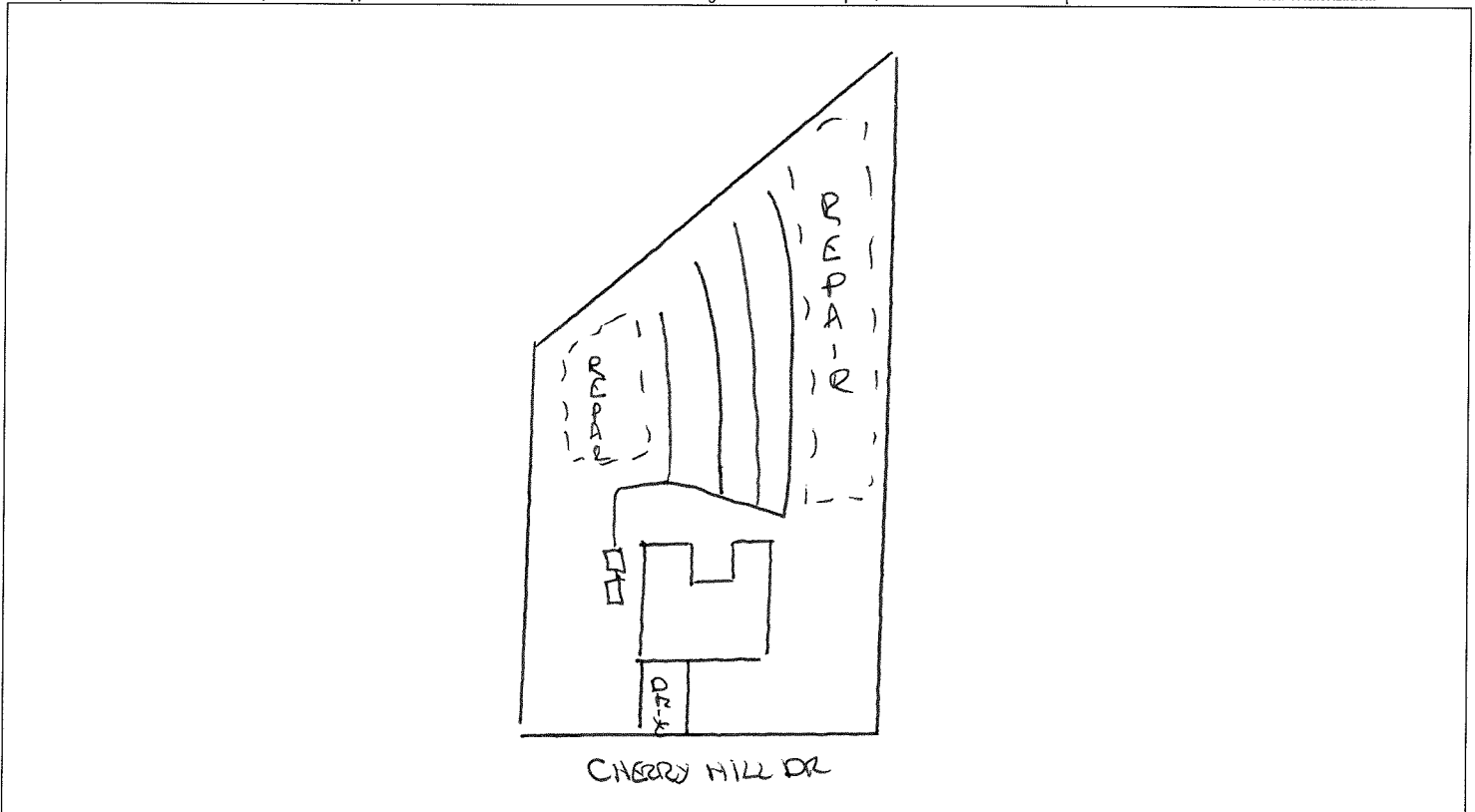

### PERMIT CONDITIONS:

- I. Performance: System shall perform in accordance with Rule .1961.
- II. Monitoring: As required by Rule .1961.
- III. Maintenance: As required by Rule .1961. Other: \_\_\_\_\_  
Subsurface system operator required? Yes  No   
If yes, see attached sheet for additional operation conditions, maintenance and reporting.

- IV. Operation: \_\_\_\_\_
- V. Other: \_\_\_\_\_

D-Box  Pump  Alarm  H2O Line  PWR Line

Following are the specifications for the sewage disposal system on the above captioned property.

Type of system:  Conventional  Other Pump To Chamber (PH+) Septic Tank: 1000 gallons Pump Tank: 1000 gallons

Subsurface Drainage Field: No. of ditches 1 exact length of each ditch 300 feet width of ditches 3 feet depth of ditches 18-24 inches

French Drain Required: \_\_\_\_\_ Linear feet

Authorized State Agent [Signature] Date 3/3/15