ADDRESS . . : 216 TILDEN HOWINGTON DR
CONTRACTOR : SAVVY HOMES, LLC
OWNER . . : DAKOTA LAND PARTNERS LLC
PARCEL . . : 13-0630-01- -0029- -26-
APPL NUMBER: 14-50034716 CP NEW RESIDENTIAL (SFD)
DIRECTIONS : T/S: 10/06/2014 03:39 PM JBROCK ----
MAMIE BELL RIDGE LOT 86

SUBDIV: MAMIE BELL PH# 1&2&5 46LOTS
PHONE : (919) 781-8104
PHONE :

STRUCTURE: 000 000 42X48 4BDR MONO W/ GARAGE

FLOOD ZONE : FLOOD ZONE X
BEDROOMS : 4000000.00
SEPTIC - EXISTING? : NEW TANK
PROPOSED USE : SFD
WATER SUPPLY : COUNTY

PERMIT: CPSF 00 CP * SFD

TYP/SQ	REQUESTED COMPLETED	INSP RESULT	DESCRIPTION RESULTS/COMMENTS
P309 01	12/11/14 12/11/14	TSG AP	R*PLUMB UNDER SLAB VRU #: 002607026
A814 01	12/15/14	TI	ADDRESS CONFIRMATION VRU #: 002608974
B114 01	12/15/14 <u>11</u>	TI <u>AP MR</u>	R*BLDG MONO SLAB/TEMP SVC POLE VRU #: 002608966

----- COMMENTS AND NOTES -----

2725 E. Millbrook Rd Suite 121
 Raleigh, North Carolina 27604
 (919) 871-0999 Fax (919) 871-0335

Project: Mamie Bell Ridge Lot 86
 Client: Sunny Homes
 Location: Billington

Project Number: Sunny 003
 Day/Date: Mon 12-15-11
 Temp/Weather: 70° Clear

Type of Inspection: Soils () Concrete () Structural Steel () Asphalt Foundation () Masonry () Other

Arrive ___:___ I ___:___ I ___:___
 Depart ___:___ I ___:___ I ___:___

On-Site Time _____ Travel Time _____
 Lab Time _____ Total Time _____

No. Trips _____ Total Mileage _____

Chargeable Equipment _____

Notes:

ATC Engineer arrived as requested to observe and test soils to support proposed footings. Pad construction / Footing excavation complete upon arrival. Soils transition cut at front right up to 3' fill back left.

ATC tested soil bearing capacity at BOF elevation. Hand auger and bearing tests at back left. Results indicate soils should be satisfactory to support foundation designed for net allowable bearing capacity of 2000 psf, except for isolated areas marked and undercut 1' (to be backfilled w/ extra concrete).

Recommend 2#4 rebar for back and left perimeter and interior footing behind garage. See below.

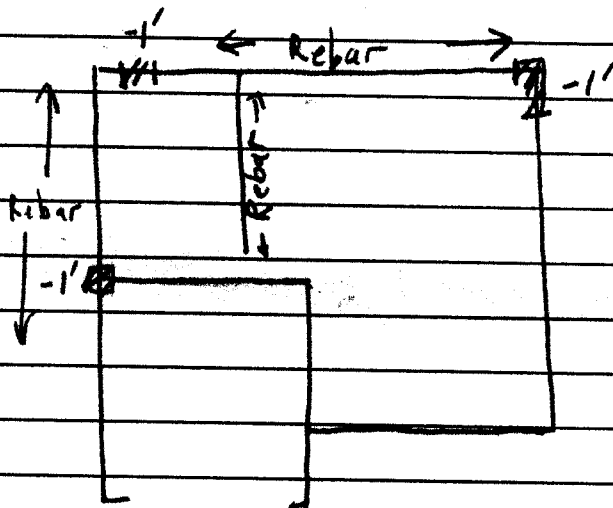

Reviewed By: _____

Printed Name Herbert L. Holes Jr. PE

This Report is Preliminary until reviewed by the engineering staff.

Field Test Data, Locations, Elevations and Depths are Estimated.

Lic # 34487