

ADDRESS : ~~757 JUNO DR~~  
CONTRACTOR : CATES BUILDING INC  
OWNER : THE HARNETT LAND GROUP II LLC  
PARCEL : 03-9576-01- -0088- -81-  
APPL NUMBER: 14-50034278 CP NEW RESIDENTIAL (SFD)  
DIRECTIONS : T/S: 07/25/2014 09:17 AM JBROCK ----  
~~TINGEN POINTE #169~~

SUBDIV: TINGEN POINTE PH6  
PHONE : (910) 481-0503  
PHONE :

**STRUCTURE: 000 000 42X45 3BDR MONO W/ GARAGE**

FLOOD ZONE : FLOOD ZONE X  
# BEDROOMS : 3000000.00  
SEPTIC - EXISTING? : NEW TANK  
PROPOSED USE : SFD  
WATER SUPPLY : COUNTY

**PERMIT: CPSF 00 CP \* SFD**

TYP/SQ	REQUESTED COMPLETED	INSP RESULT	DESCRIPTION RESULTS/COMMENTS
A814 01	9/24/14	SB	ADDRESS CONFIRMATION TIME: 17:00 VRU #: 002582187
	9/24/14	AP	T/S: 09/24/2014 09:10 AM SBENNETT 757 JUNO DR BROADWAY 27505 POST # ON HOME
P309 01	9/24/14	TSG	R*PLUMB UNDER SLAB TIME: 17:00 VRU #: 002582195
	9/24/14	AP	
B114 01	10/02/14	TSG	R*BLDG MONO SLAB/TEMP SVC POLE VRU #: 002584654
	10/02/14	DA	job not ready
B114 02	10/07/14	TI	R*BLDG MONO SLAB/TEMP SVC POLE VRU #: 002586196

*TSV AC*

COMMENTS AND NOTES

*Street Test*



**ECS Carolinas, LLP**

726 Ramsey Street

Suite 3

Fayetteville, NC 28301

(910) 401-3288 [Phone]

(910) 323-0539 [Fax]

NC Registered Engineering Firm # F-1078

**LETTER OF TRANSMITTAL**

October 3, 2014

Cates Building

639 Executive Place

Suite 400

Fayetteville, NC 28305

ATTN: Mr. Cameron Mackethan

RE: **Tingen Pointe Foundation Evaluations**

ECS Job # **33:3047**

Permits:

Location: **Juno Dr  
Broadway, NC**

*LIT #  
168  
169  
170*

We are enclosing:

X Materials Engineering Division Reports

X For your use

X As requested

ENCL:

Field Report # 2

09/30/2014

Scott Garland Dowell, PE

Vice President, Branch Manager

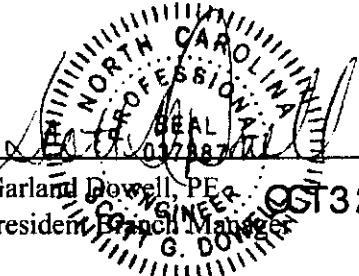

Aaron Cain  
Project Manager





①

20707



ECS CAROLINAS, LLC  
 726 RAMSEY ST SUITE 3  
 Fayetteville NC 28301  
 (910) 401-3288 phone  
 (910) 323-0539 fax

Job Number: 333649  
 Job Name: Tingen Pointe  
 Date: 9/30/14  
 Technician: D. Walton  
 Weather: Sunny

### DYNAMIC CONE PENETROMETER REPORT

Test Method: ASTM STP-399

Average Criteria: 3 Blows For 600PSF

Designed Bearing PSF: 2500

#### FIELD TEST DATA REPORT

LOCATION	TEST DEPTH/ ELEVATION	1-3/4"	1-3/4"	1-3/4"	*REMARKS/SOIL DESCRIPTION
Site 170					
	BOF	4	4	5	Brown sandy clay
	-1	6	7	8	↓
	-2	6	7	7	
	-3	8	8	8	Black top soil
	BOF	5	6	6	Brown red sandy clay
	-1	7	7	6	↓
	-2	8	7	8	
	-3	7	8	8	Black top soil
	BOF	5	5	6	Red Brown sandy clay
	-1	6	6	7	↓
	-2	8	8	8	
	-3	9	8	8	Black top soil
	BOF	4	5	5	Red Brown sandy clay
	-1	5	6	6	↓
	-2	5	6	5	
	-3	7	7	7	Black top soil
	BOF	4	5	5	Red Brown sandy clay
	-1	6	6	7	↓
	-2	7	7	8	
	-3	8	8	8	Black top soil
Site 69					
	BOF	5	6	6	Red sandy clay w/ Black top soil
	-1	5	5	5	↓
	-2	6	7	7	
	-3	8	8	8	
	BOF	7	6	6	
	-1	8	8	8	
	-2	7	8	8	
	-3	8	8	7	
	BOF	5	5	6	
	-1	6	6	7	
	-2	7	8	7	
	-3	7	8	8	
	BOF	5	5	6	
	-1	6	7	7	
	-2	8	8	7	
	-3	8	8	8	



ECS CAROLINAS, LLC  
 726 RAMSEY ST SUITE 3  
 Fayetteville NC 28301  
 (910) 401-3288 phone  
 (910) 323-0539 fax

Job Number: 333047  
 Job Name:  
 Date: 9/30/14  
 Technician: D. Walton  
 Weather: sunny

**DYNAMIC CONE PENETROMETER REPORT**

Test Method: ASTM STP-399

Average Criteria: 3 Blows For <sup>1000</sup> PSF

Designed Bearing PSF: 2500

**FIELD TEST DATA REPORT**

LOCATION	TEST DEPTH/ ELEVATION	1-3/4"	1-3/4"	1-3/4"	*REMARKS/SOIL DESCRIPTION
Site 16A					
	BoF	5	6	6	Brown sandy clay
	-1	6	5	6	↓
	-2	17	7	8	Black top soil
	-3	8	8	8	Brown sandy black top soil
	BoF	3	3	4	Brown sandy clay
	-1	5	6	6	black top soil
	-2	8	7	8	Brown sand black red clay
	-3	8	9	8	↓
Site 16B					
	BoF	4	4	5	Brown sandy clay
	-1	6	6	7	Black top soil
	-2	8	8	17	Brown sandy clay
	-3	8	9	9	↓
	BoF	3	3	4	Brown sandy red clay
	-1	4	5	5	Brown sandy red black clay
	-2	5	6	5	Black top soil
	-3	17	17	17	↓
	BoF	4	4	5	Red sandy brown clay
	-1	6	6	17	↓
	-2	17	8	8	↓
	-3	17	7	8	Black top soil
	BoF	5	5	6	Brown sandy clay
	-1	17	17	8	Red brown sandy clay
	-2	8	7	8	↓
	-3	9	8	8	



PROJECT: 33:	SHEET NO: 1 of 3
TITLE: Tingen Pointe	PROJ. NO: 3047
BY: D. Walton	SCALE:
DATE: 9/30/14	APPROVED:
	DATE:

N.T.S 9 #170

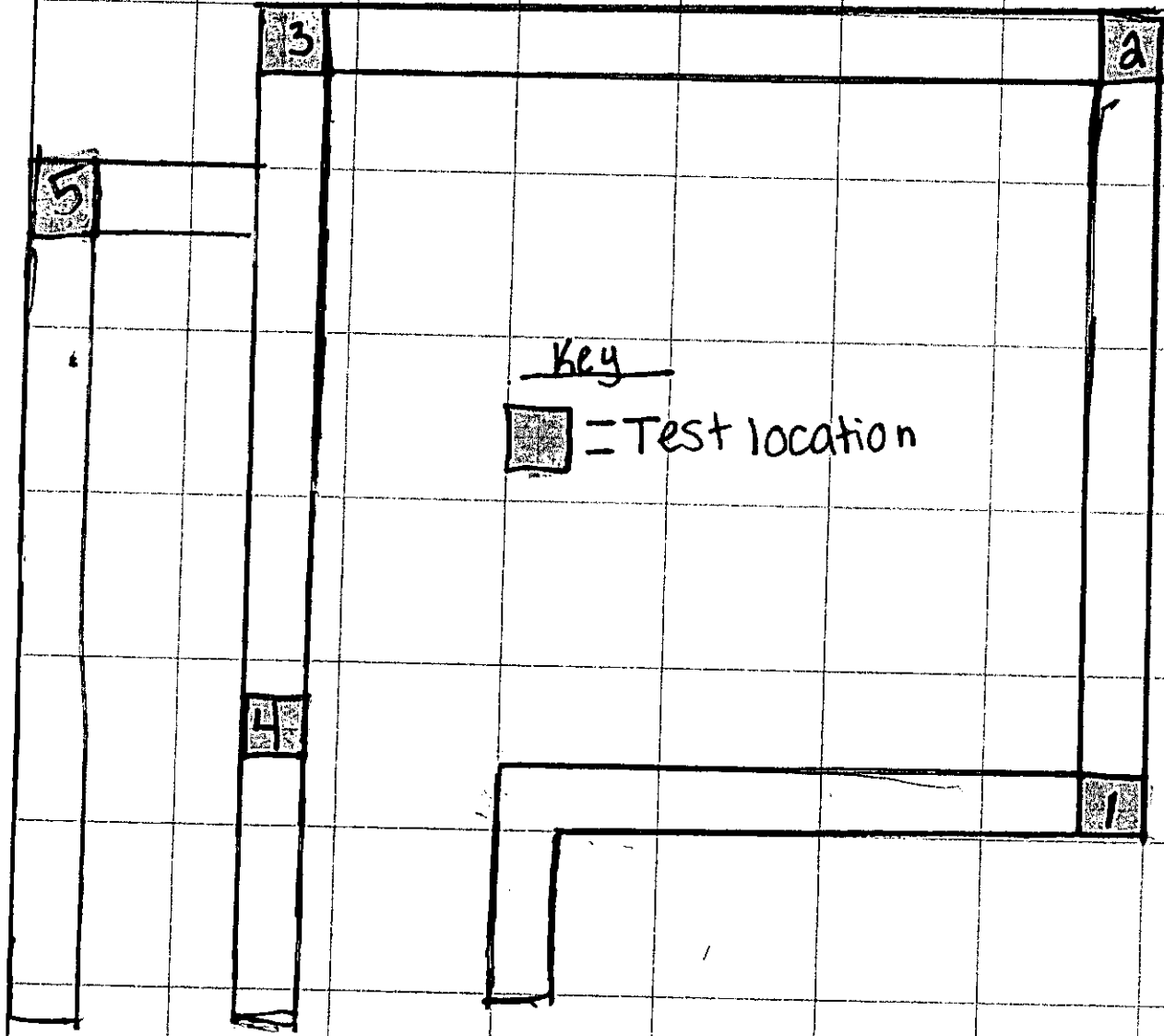



PROJECT:

SHEET NO:

2 of 3

TITLE:

Tingen Pointe

PROJ. NO:

3047

SCALE:

BY:

O. Walton

DATE:

9/30/14

APPROVED:

DATE:

N.T.S #169

3

6

2

key

 = Test location

4

5

1





PROJECT:		SHEET NO: 3043
TITLE: Tingen Pointe		PROJ. NO: 3047
BY: D. Walton	DATE: 9/30/14	APPROVED:
		SCALE:
		DATE:

N.T.S

#68

