

HTE# 14-5-34122

Harnett County Department of Public Health

27983

Improvement Permit

(J. Edward Averrett) A building permit cannot be issued with only an Improvement Permit

ISSUED TO: Wynn Construction PROPERTY LOCATION: Doc's Rd.
 SUBDIVISION: Trotters Ridge LOT # 34

NEW REPAIR EXPANSION
 Type of Structure: SFD 60x60
 Proposed Wastewater System Type: 25% Reduction System
 Projected Daily Flow: 480 GPD
 Number of bedrooms: 4 Number of Occupants: 8 max
 Basement Yes No
 Pump Required: Yes No May be required based on final location and elevations of facilities
 Type of Water Supply: Community Public Well Distance from well _____ feet Permit valid for: Five years
 Permit conditions: _____ No expiration

Authorized State Agent: [Signature] Date: 8/11/2014 SEE ATTACHED SITE SKETCH

The issuance of this permit by the Health Department in no way guarantees the issuance of other permits. The permit holder is responsible for checking with appropriate governing bodies in meeting their requirements. This site is subject to revocation if the site plan, plat, or the intended use changes. The Improvement Permit shall not be affected by a change in ownership of the site. This permit is subject to compliance with the provisions of the Laws and Rules for Sewage Treatment and Disposal and to conditions of this permit.

Construction Authorization

(Required for Building Permit)

The construction and installation requirements of Rules .1950, .1952, .1954, .1955, .1956, .1957, .1958, and .1959 are incorporated by references into this permit and shall be met. Systems shall be installed in accordance with the attached system layout.

ISSUED TO: Wynn Construction PROPERTY LOCATION: Doc's Rd.
 SUBDIVISION: Trotters Ridge LOT # 34

Facility Type: SFD New Expansion Repair
 Basement? Yes No Basement Fixtures? Yes No
 Type of Wastewater System** 25% Reduction System (Initial) Wastewater Flow: 480 GPD
 (See note below, if applicable)
25% Reduction System (Repair)

Installation Requirements/Conditions	Number of trenches <u>3</u>	
Septic Tank Size <u>1000</u> gallons	Exact length of each trench <u>80</u> feet	Trench Spacing: <u>9</u> Feet on Center
Pump Tank Size _____ gallons	Trenches shall be installed on contour at a	Soil Cover: <u>6</u> inches
	Maximum Trench Depth of: <u>18</u> inches	(Maximum soil cover shall not exceed
	(Trench bottoms shall be level to +/-1/4"	36" above the trench bottom)
	in all directions)	
Pump Requirements: _____ ft. TDH vs. _____ GPM		_____ inches below pipe
		Aggregate Depth: _____ inches above pipe
Conditions: <u>Run lines on contour</u>		_____ inches total

**WATER LINES (INCLUDING IRRIGATION) MUST BE 10FT. FROM ANY PART OF SEPTIC SYSTEM OR REPAIR AREA.
NO UTILITIES ALLOWED IN INITIAL OR REPAIR DRAIN FIELD AREA.**

**If applicable: I understand the system type specified is different from the type specified on the application. I accept the specifications of this permit.

Owner/Legal Representative Signature: _____ Date: _____

This Construction Authorization is subject to revocation if the site plan, plat, or the intended use changes. The Construction Authorization shall not be transferred when there is a change in ownership of the site. This Construction Authorization is subject to compliance with the provisions of the Laws and Rules for Sewage Treatment and Disposal and to the conditions of this permit. SEE ATTACHED SITE SKETCH

Authorized State Agent: [Signature] Date: 8/11/2014
 Construction Authorization Expiration Date: 8/11/2019

HTE# 14-5-34122

Permit # 27983

Harnett County Department of Public Health Site Sketch

(J. Edward Averrett)

PROPERTY LOCATION: Doc's Rd

ISSUED TO: Wynn Construction

SUBDIVISION Trotter Ridge

LOT # 34

Authorized State Agent: Bryan McSwain, REHS

Date: 8/11/2014

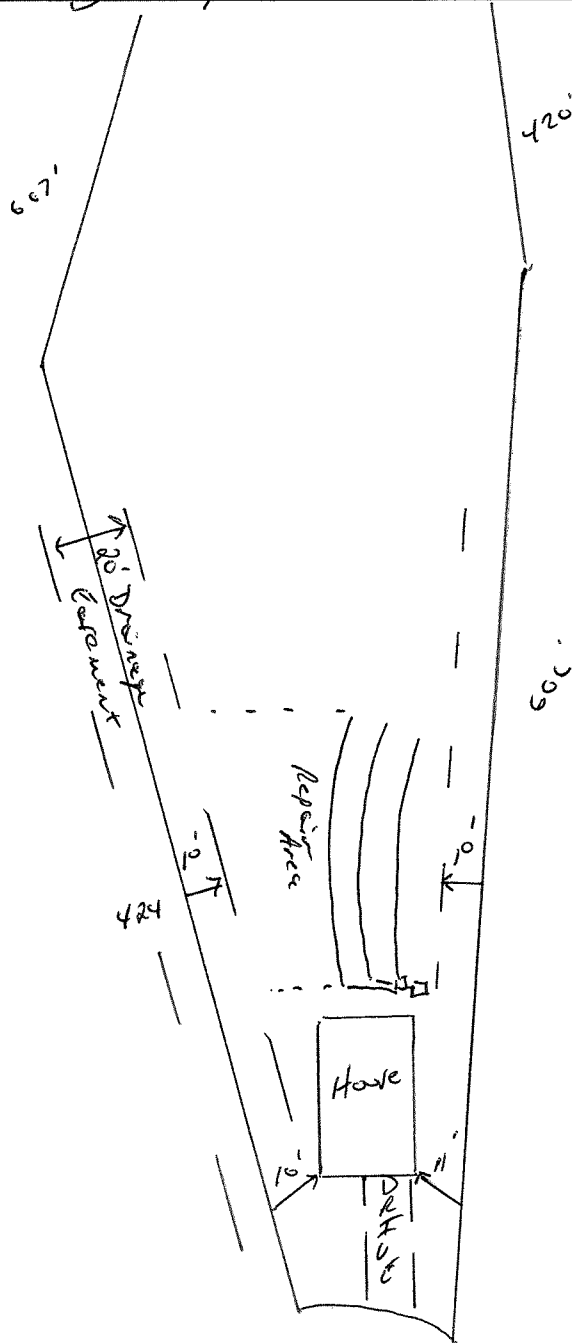

Kentucky
Derby Ln.

*Not to Scale