

COMMENTS: _____

<u>LANDSCAPE POSITIONS</u>	<u>GROUP</u>	<u>TEXTURES</u>	<u>.1955 LTAR</u>	<u>CONSISTENCE MOIST</u>	<u>WET</u>
R-RIDGE	I	S-SAND	1.2 - 0.8	VFR-VERY FRIABLE FR-FRIABLE FI-FIRM VFI-VERY FIRM EFI-EXTREMELY FIRM	NS-NON-STICKY SS-SLIGHTY STICKY S-STICKY VS-VERY STICKY NP-NON-PLASTIC SP-SLIGHTLY STICKY P-PLASTIC VP-VERY PLASTIC
S-SHOULDER SLOPE		LS-LOAMY SAND			
L-LINEAR SLOPE					
FS-FOOT SLOPE	II	SL-SANDY LOAM	0.8 - 0.6		
N-NOSE SLOPE		L-LOAM			
H-HEAD SLOPE	III	SI-SILT	0.6 - 0.3		
CC-CONCLAVE SLOPE		SIL-SILT LOAM			
CV-CONVEX SLOPE		CL-CLAY LOAM			
T-TERRACE		SCL-SANDY CLAY LOAM			
FP-FLOOD PLAN	IV	SIC-SILTY CLAY	0.4 - 0.1		
		C-CLAY			
		SC-SANDY CLAY			

STRUCTURE

- SG-SINGLE GRAIN
- M- MASSIVE
- CR-CRUMB
- GR-GRANULAR
- SBK-SUBANGULAR BLOCKY
- ABK-ANGULAR BLOCKY
- PL-PLATY
- PR-PRISMATIC

MINERALOGY

- SLIGHTLY EXPANSIVE
- EXPANSIVE

Show profile locations and other site features (dimensions, references or benchmark, and North)

A large grid for recording profile locations and site features. The grid is approximately 20 columns wide and 25 rows high. It is intended for drawing or marking profile locations, dimensions, references, benchmarks, and orientation (North).

Scale

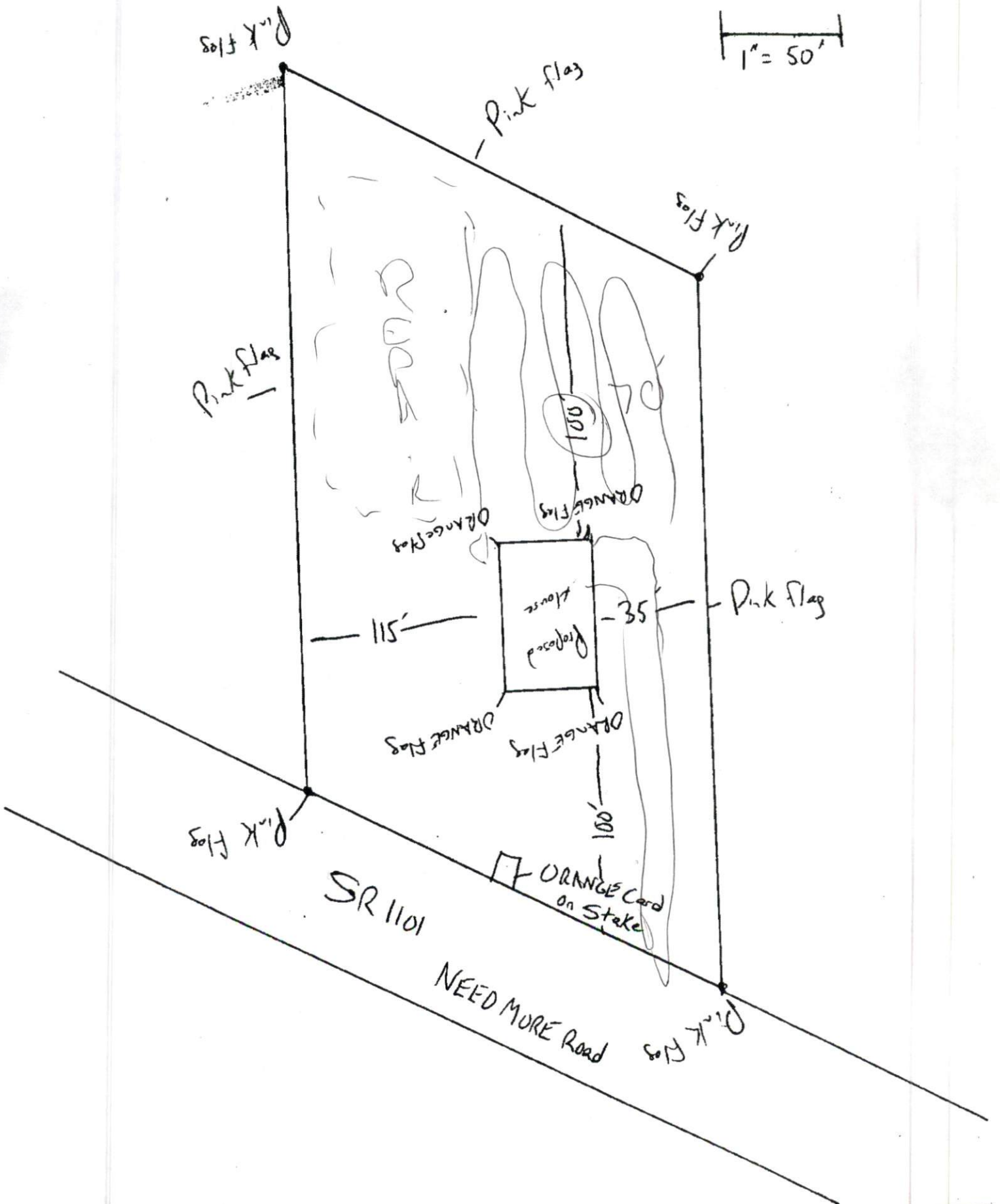
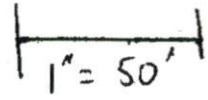

Handwritten signature

DOUGHERTY, ROBERT E &
DOUGHERTY, ANNE C
DBB49, P480

SITE PLAN APPROVAL
DISTRICT RA20 USE SFD
#BEDROOMS 4
4-7-14 V. C. [Signature]
Date Zoning Administrator

N 12°28'25" E
TIE TO PINE
1" NIP3AG

S 48°53'42" E 190.27'

01" NIP3AG

1.13 ACRES (TOTAL)
0.13 ACRES (IN RAM)
1.00 ACRE (NET)

N 12°28'25" E
259.71'

Needmore Rd

DMORE ROAD
R. 1101)

SR 1101

01" NIP3AG

34.42'

1/2" EXISTING IRON STAKE,
12" BELOW GRADE,
CONTROL CORNER

100'



S 12°28'25" W
259.71'

3/4" EXISTING IRON PIPE,
1" ABOVE GRADE

N 48°56'00" W 190.20'

01" NIP3AG

34.28'

S 94.4'

BOSCH, ENRIQUE J
DB1036, P100

OWNERSHIP
THE OWNER OF THE PROPERTY DESCRIBED HEREON,
SUBDIVISION REGULATION JURISDICTION OF
AND THAT I FREELY ADOPT THIS PLAN OF

WS
III

1 = 50

RA20

Map 2014-80

99545-39-1264