

ADDRESS : 41 GOLD CUP CT
 CONTRACTOR : WYNN CONSTRUCTION, INC.
 OWNER : HARNETT DEVELOPERS LLC
 PARCEL : 03-0507- - -0200- -89-
 APPL NUMBER: 13-50032640 CP NEW RESIDENTIAL (SFD)
 DIRECTIONS : T/S: 12/17/2013 09:05 AM JBROCK ----
 TROTTERS RIDGE #64

SUBDIV: TROTTER'S RIDGE PH2B 23LOTS
 PHONE : (919) 528-1347
 PHONE :

STRUCTURE: 000 000 60X60 4BDR MONO W/ GARAGE

FLOOD ZONE : FLOOD ZONE X
 # BEDROOMS : 4000000.00
 SEPTIC - EXISTING? : NEW TANK
 PROPOSED USE : SFD
 WATER SUPPLY : COUNTY

PERMIT: CPSF 00 CP * SFD

TYP/SQ	REQUESTED COMPLETED	INSP RESULT	DESCRIPTION RESULTS/COMMENTS
B101 01	7/16/15	MR	R*BLDG FOOTING / TEMP SVC POLE TIME: 17:00 VRU #: 002688612
	7/16/15	AP	T/S: 07/16/2015 01:37 PM MREARIC -----
B103 01	7/31/15	MR	R*BLDG FOUND & TEMP SVC POLE TIME: 17:00 VRU #: 002697357
	7/31/15	AP	T/S: 07/31/2015 12:41 PM MREARIC -----
A814 01	8/03/15	SB	ADDRESS CONFIRMATION TIME: 17:00 VRU #: 002697365
	7/31/15	AP	41 GOLD CUP CT LILLINGTON 27546 T/S: 07/31/2015 09:25 AM SBENNETT -----
B105 01	8/06/15	MR	R*OPEN FLOOR TIME: 17:00 VRU #: 002699312
	8/06/15	AP	T/S: 08/06/2015 01:44 PM MREARIC -----
R425 01	8/28/15	JH	FOUR TRADE ROUGH IN TIME: 17:00 VRU #: 002710739
	8/28/15	DP	T/S: 08/27/2015 01:59 PM LBENNETT ----- 2) Need 3 studs each side of garage doors at lug footings. 1) Missing anchor bolt in back left corner of garage. 3) Missing 2 jack studs each side of windows in garage per plans. 4) Missing 2 studs point load windows in garage & 3 studs on back wall per plans. 4) Need 2 full jack stud on each side of sliding door on back wall not 1/2 studs. 1) Seal all holes in air barriers under stairs. 1) Replace studs in half bath where holes for pipes are drilled & move 1 pipe so that one hole is drilled in double stud. 2) studs each side of window in stairs @ bottom window. 9) 4 studs on right side of double window in stairs per plans. 1) Fire caulk hole to right of window in left front bedroom. DO NOT INSULATE OK TO SIDE
R425 02	9/04/15	TI	FOUR TRADE ROUGH IN TIME: 17:00 VRU #: 002713519

9-4-15 *DAJH*

COMMENTS AND NOTES

[Handwritten Signature]
 NORTH CAROLINA
 PROFESSIONAL
 SEAL
 124898
 9/2/15
 PRENTICE A. TYNDALL JR.
 ENGINEER

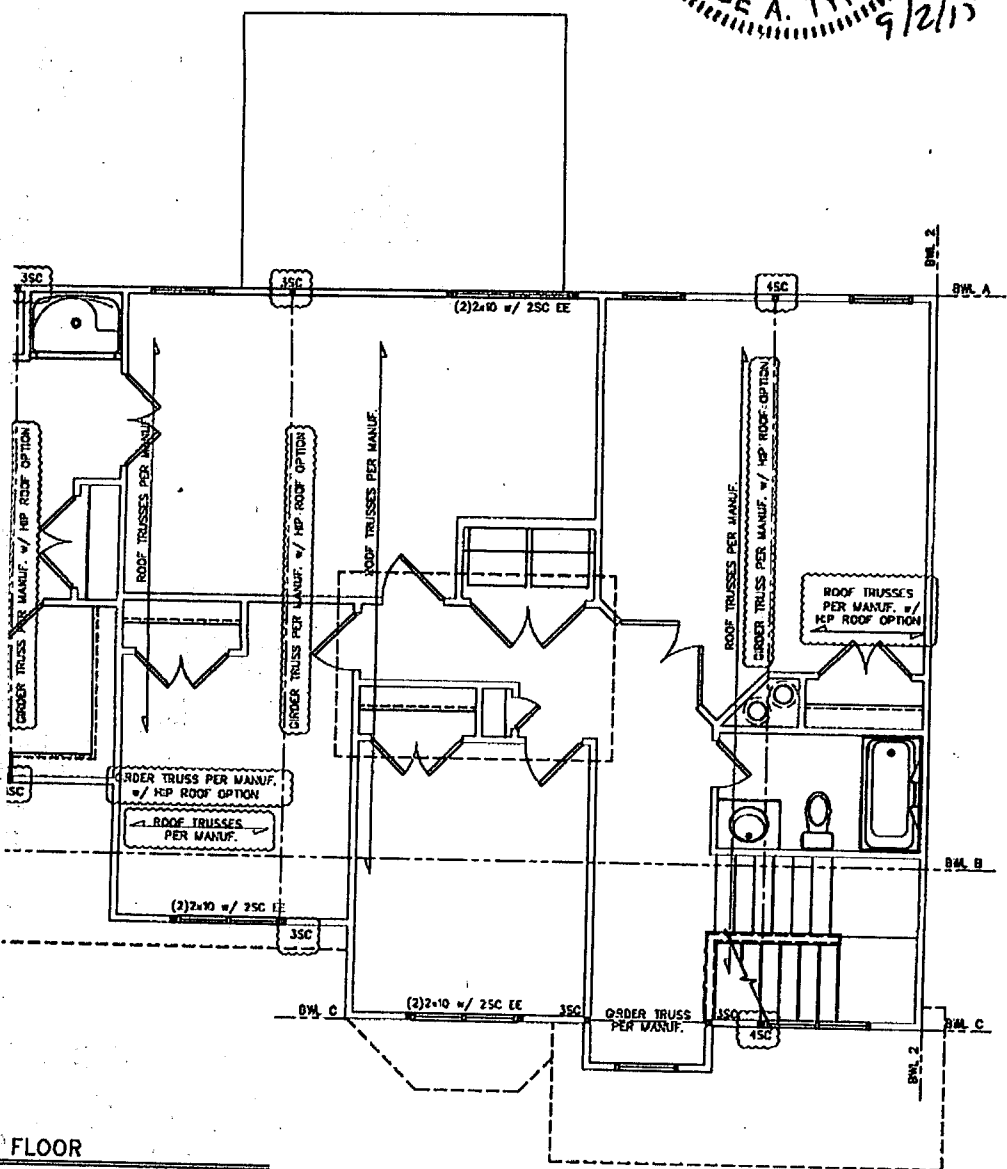

ALL AREAS IN
 "CLOUDED" SQUARES ARE POINT
 LOADS FOR HIP ROOF DESIGN,
 NOT GABLE.

* Engineers seal does not include construction means, methods, techniques, sequences, procedures or safety precautions.
 * Any deviations or discrepancies on plans are to be brought to the immediate attention of Tyndall Engineering & Design, P.A. Failure to do so will void Tyndall Engineering & Design, P.A. liability.
 * Please review these documents carefully. Tyndall Engineering & Design, P.A. will interpret that all dimensions, recommendations, etc. presented in these documents were deemed acceptable once construction begins.

TYNDALL
 ENGINEERING & DESIGN, P.A.



T 919 775-1200 • F 919 775-9658
 69 Shipwash Drive • Garner • North Carolina • 27529
 www.tyndallengineering.com

Client:
 WYNN HOMES
 2550 CAPITOL DR.
 CREEDMOOR, NC
 27522

Plan:
 ANTHONY
 GARAGE LEFT

**FRAMING
 PLAN**

Project #: 1301-010147
 Date: 9/1/15
 Drawn/Design By: JWA
 DWG. Checked By: PAT
 Scale: 1/8" = 1'-0"

REVISIONS		
No.	Date	Remarks
▲		
▲		
▲		

Sheet Number

100

100

