

ADDRESS : 163 WILDWOOD WAY SUBDIV: CAROLINA SEASONS PH2 SECT 2 59
 CONTRACTOR : BILL CLARK HOMES LLC PHONE : (252) 355-5805
 OWNER : CRESTVIEW DEVELOPMENT LLC PHONE :
 PARCEL : 09-9567-03- -0006- -12-
 APPL NUMBER: 13-50032553 CP NEW RESIDENTIAL (SFD)
 DIRECTIONS : T/S: 12/10/2013 08:42 AM JBROCK ----
 CAROLINA SEASONS #69

STRUCTURE: 000 000 46X43.5 3BDR 2.5BATH SFD
 FLOOD ZONE : FLOOD ZONE X
 # BEDROOMS : 3.00 PROPOSED USE : SFD
 SEPTIC - EXISTING? : NEW TANK WATER SUPPLY : COUNTY

PERMIT: CPSF 00 CP * SFD

TYP/SQ	REQUESTED COMPLETED	INSP RESULT	DESCRIPTION RESULTS/COMMENTS
B101 01	12/18/13 12/18/13	FS AP	R*BLDG FOOTING / TEMP SVC POLE VRU #: 002477610 If possible could inspector come before 11 a.m. Concrete ordered for noon T/S: 12/18/2013 03:14 PM FSPIVEY -----
B103 01	12/23/13 12/23/13	FS AP	R*BLDG FOUND & TEMP SVC POLE TIME: 17:00 VRU #: 002479749 T/S: 12/20/2013 02:17 PM VBROWN ----- T/S: 12/23/2013 03:41 PM FSPIVEY -----
A814 01	12/27/13 1/09/14	TW AP	ADDRESS CONFIRMATION TIME: 17:00 VRU #: 002479756 163 wildwood way cameron 28326 -- T/S: 01/09/2014 04:27 PM TWARD ----- T/S: 01/09/2014 04:28 PM TWARD -----
P309 01	12/30/13 12/30/13	FS AP	R*PLUMB UNDER SLAB TIME: 17:00 VRU #: 002480663 T/S: 12/30/2013 08:09 AM VBROWN ----- T/S: 12/30/2013 02:26 PM FSPIVEY -----
B111 01	12/31/13 12/31/13	FS AP	R*BLDG SLAB INSP/TEMP SVC POLE TIME: 17:00 VRU #: 002480853 T/S: 12/30/2013 12:31 PM DJOHNSON ----- CONCRETE IS ORDERED FOR 11 AM TODAY T/S: 12/31/2013 02:54 PM FSPIVEY -----
R425 01	1/23/14	TI	FOUR TRADE ROUGH IN TIME: 17:00 VRU #: 002487130
I129 01	1/24/14 <i>1/24/14</i>	TI <i>AP</i>	R*INSULATION INSPECTION TIME: 17:00 VRU #: 002487619 T/S: 01/23/2014 01:01 PM VBROWN -----

COMMENTS AND NOTES

ITW Building Components Group, Inc.

2400 Lake Orange Drive suite 150 Orlando FL 32837
Engineering services provided by ABCD Engineering, PLLC NC COA 0838
Page 1 of 1 Document ID:1V2W8976Z1409142904

Truss Fabricator: **R&D Thiel dba Carpenter Contractors of America**
Job Identification: **REPAIR / 43448-1D1 PBA;C -A1**
Truss Count: **1**
Model Code: **IRC**
Truss Criteria: **IRC2009/TPI-2007(STD)**
Engineering Software: **Alpine Software, Version 13.01.**
Minimum Design Loads: **Roof - 40.0 PSF @ 1.15 Duration**
Floor - N/A
Wind - 100 MPH ASCE 7-05 -Closed

Notes:

- Determination as to the suitability of these truss components for the structure is the responsibility of the building designer/engineer of record, as defined in ANSI/TPI 1**
- As shown on attached drawings; the drawing number is preceded by: HCUSR8976**

Details: -

01/09/2014

-Truss Design Engineer-
William H. Krick

1950 Marley Drive
Haines City, FL 33844

#	Ref	Description	Drawing#	Date
1	45178--A1		14009076	01/09/14

(43448-101 PMA.C - A1)

This truss is repaired for a damaged bottom chord (excessive wane) at right end of truss as shown. Refer to drawing R8976 13353020 for plates and other data not given here.

Repair(s) must comply with Alpine designs & specifications Shore Truss and any supported spans in proper position as repair is being made.

THIS DWG PREPARED FROM COMPUTER INPUT (LOADS & DIMENSIONS) SUBMITTED BY TRUSS MFR.

(A) (2) 2X8X 3-0-0 SP #2 12A SCAB; ATTACH ONE SCAB TO EACH FACE OF TRUSS WITH 10d BOX (0.128"X3.0") NAILS @ 4"OC, PLUS A CLUSTER OF (3) NAILS IN RIGHT END VERTICAL WITHOUT SPLITTING LUMBER.

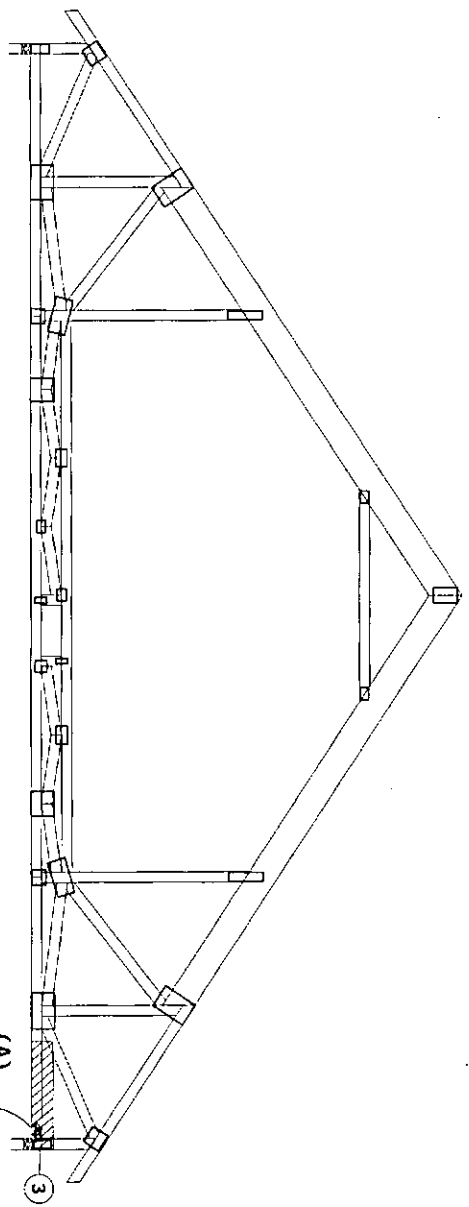

0-10-8
 R=2333 U=311 W=3.5"
 RL=233/-233

7-9-0 15-5-8 4-8-12 30-11-0 Over 2 Supports 10-8-4 4-8-0 15-5-8 7-7-4

EXCESSIVE WANES ON
 BOTTOM CHORD NEAR
 RIGHT END OF TRUSS
 0-10-8
 R=2333 U=309 W=3.5"

PLT TYP. Wave Design Crit: IRC2009/TPI-2007(STD) FT/RT=20%(0%)/10(0) 13.01.06.0823.06 QTY: 0 Scale = .1875"/ft.

TRUSS REPAIR

DAMAGED TRUSSES MUST BE CAREFULLY EVALUATED TO DETERMINE THE EXTENT OF DAMAGE AND THE FEASIBILITY OF REPAIR. IN SOME CASES THE PROPER SOLUTION IS TO SCRAP THE DAMAGED TRUSSES AND REBUILD. INTERNAL WOOD FIBER DAMAGE AND EXCESSIVE CONNECTOR STRESS FROM BENDING OR SHOCK CANNOT BE READILY DETECTED. THEREFORE, IT IS VITAL THAT THE TRUSS FABRICATOR AND BUILDING CONTRACTOR CONSIDER THE CAUSE OF THE DAMAGE IN THEIR DECISION WHETHER TO REPAIR OR REBUILD.

REPAIR WORK SHOWN ON THIS DRAWING APPLIES ONLY TO THOSE SECTIONS OF THE TRUSS REPORTED BY THE TRUSS MANUFACTURER TO HAVE BEEN DAMAGED. A QUALIFIED THIRD PARTY INSPECTOR SHALL CHECK TRUSSES TO DETERMINE THE EXTENT OF ANY FURTHER DAMAGE. IF ANY, AND VERIFY THAT REPAIRS HAVE BEEN PERFORMED AS INDICATED ON THIS DRAWING.

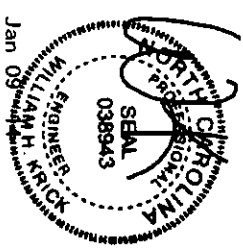

TC LL	20.0 PSF	REF	R8976-45176
TC DL	10.0 PSF	DATE	01/09/14
BC DL	10.0 PSF	DRW	HCUSR8976 14009076
BC LL	0.0 PSF	HC-ENG	JB/WPF
TOT. LD.	40.0 PSF	SEQN-	395873
DUR. FAC.	1.15	FROM	WEB
SPACING	24.0"	REF -	1V2W8976Z14