

HTE# B-5-32444

# Harnett County Department of Public Health

27711

## Improvement Permit

A building permit cannot be issued with only an Improvement Permit

ISSUED TO: Cumberland Homes Inc PROPERTY LOCATION: SA 1437 Balland RD  
 NEW  REPAIR  EXPANSION  SUBDIVISION: Balland Woods LOT # 143  
 Type of Structure: SFD Site Improvements required prior to Construction Authorization Issuance: \_\_\_\_\_  
 Proposed Wastewater System Type: \_\_\_\_\_  
 Projected Daily Flow: 360 GPD  
 Number of bedrooms: 3 Number of Occupants: 6 max  
 Basement  Yes  No  
 Pump Required:  Yes  No  May be required based on final location and elevations of facilities  
 Type of Water Supply:  Community  Public  Well Distance from well \_\_\_\_\_ feet Permit valid for:  Five years  
 Permit conditions: Follow Consultants Report  No expiration

Authorized State Agent: James E. Montague Date: 12-18-13 SEE ATTACHED SITE SKETCH  
 The issuance of this permit by the Health Department in no way guarantees the issuance of other permits. The permit holder is responsible for checking with appropriate governing bodies in meeting their requirements. This site is subject to revocation if the site plan, plat, or the intended use changes. The Improvement Permit shall not be affected by a change in ownership of the site. This permit is subject to compliance with the provisions of the Laws and Rules for Sewage Treatment and Disposal and to conditions of this permit.

## Construction Authorization

(Required for Building Permit)

The construction and installation requirements of Rules .1950, .1952, .1954, .1955, .1956, .1957, .1958, and .1959 are incorporated by references into this permit and shall be met. Systems shall be installed in accordance with the attached system layout.

ISSUED TO: Cumberland Homes Inc PROPERTY LOCATION: SA 1437 Balland RD  
 SUBDIVISION: Balland Woods LOT # 143  
 Facility Type: SFD  New  Expansion  Repair  
 Basement?  Yes  No Basement Fixtures?  Yes  No  
 Type of Wastewater System\*\* Pressure Main/Manifold (Initial) Wastewater Flow: 360 GPD  
 (See note below, if applicable  THP Pool Block (Repair))

**Installation Requirements/Conditions**

Septic Tank Size <u>1000</u> gallons	Number of trenches _____	Trench Spacing: <u>9</u> Feet on Center
Pump Tank Size <u>1000</u> gallons	Exact length of each trench _____ feet	Soil Cover: <u>6</u> inches
	Trenches shall be installed on contour at a	(Maximum soil cover shall not exceed
	Maximum Trench Depth of: <u>24</u> inches	36" above the trench bottom)
	(Trench bottoms shall be level to +/- 1/4" in all directions)	
Pump Requirements: _____ ft. TDH vs. _____ GPM		Aggregate Depth: <u>6</u> inches below pipe
		<u>2</u> inches above pipe
Conditions: <u>Follow Consultants Report</u>		<u>12</u> inches total

**WATER LINES (INCLUDING IRRIGATION) MUST BE 10FT. FROM ANY PART OF SEPTIC SYSTEM OR REPAIR AREA.  
NO UTILITIES ALLOWED IN INITIAL OR REPAIR DRAIN FIELD AREA.**

\*\*If applicable: I understand the system type specified is different from the type specified on the application. I accept the specifications of this permit.

Owner/Legal Representative Signature: \_\_\_\_\_ Date: \_\_\_\_\_

This Construction Authorization is subject to revocation if the site plan, plat, or the intended use changes. The Construction Authorization shall not be transferred when there is a change in ownership of the site. This Construction Authorization is subject to compliance with the provisions of the Laws and Rules for Sewage Treatment and Disposal and to the conditions of this permit. SEE ATTACHED SITE SKETCH

Authorized State Agent: James E. Montague Date: 12-18-13  
 Construction Authorization Expiration Date: 12-18-18

HTE# 13-5-32444

Permit # 27711

# Harnett County Department of Public Health Site Sketch

ISSUED TO: Cumberland Homes Inc PROPERTY LOCATOR: 501437 Ballant RD  
SUBDIVISION: Ballant Woods LOT # 143

Authorized State Agent: Jane E. Martin Date: 12-18-13

*Follow Consultants Report*

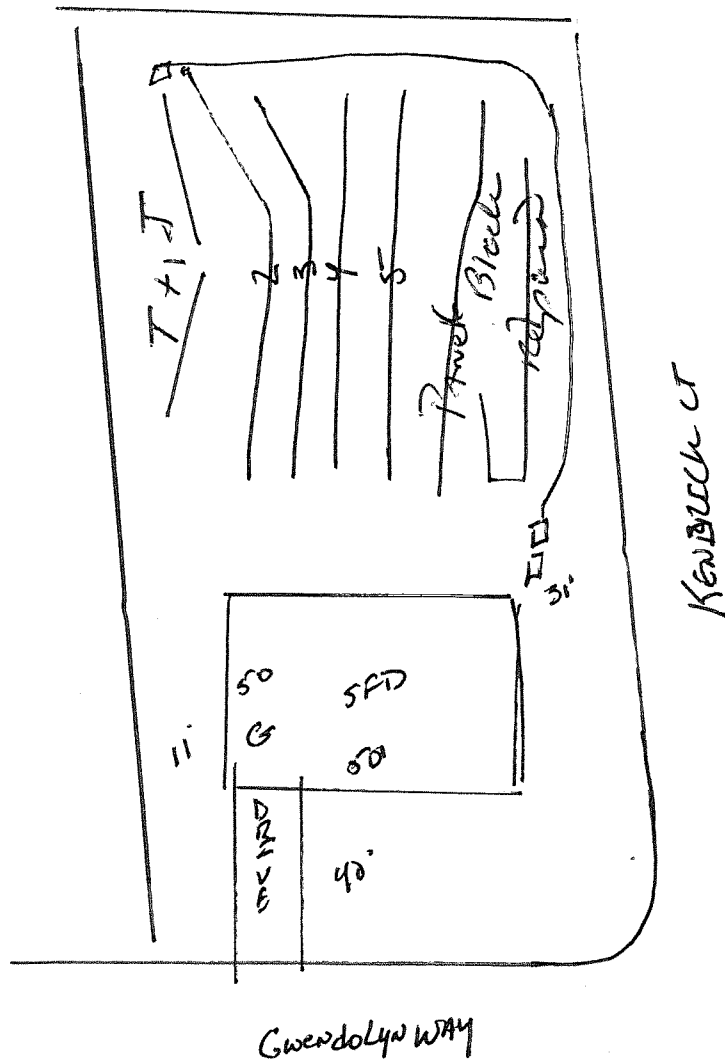

**SOIL/SITE EVALUATION  
 for ON-SITE WASTEWATER SYSTEM**

Owner:                      Applicant: *C. Hel*  
 Address:                      Date Evaluated:  
 Proposed Facility: *SFE*                      Design Flow (.1949): *360*                      Property Size:  
 Location of Site:                      Property Recorded:  
 Water Supply:                       Public  Individual  Well                       Spring                       Other  
 Evaluation Method:  Auger Boring                       Pit                       Cut  
 Type of Wastewater:                       Sewage                       Industrial Process                       Mixed

P R O F I L E #	.1940 Landscape Position/ Slope %	Horizon Depth (In.)	SOIL MORPHOLOGY .1941		OTHER PROFILE FACTORS				Profile Class & LTAR
			.1941 Structure/ Texture	.1941 Consistence Mineralogy	.1942 Soil Wetness/ Color	.1943 Soil Depth (IN.)	.1956 Sapro Class	.1944 Restr Horiz	
1	<i>L 3%</i>	<i>0-14</i>	<i>SL</i>	<i>FA. GRAN. NO</i>					
		<i>19-40</i>	<i>SEC. clay</i>	<i>FA. GRAN. SP</i>	<i>36-38</i>	<i>25% 3-1</i>			<i>.35</i>
2	<i>L 2%</i>	<i>0-12</i>	<i>SL</i>	<i>FA. GRAN. NO</i>					
		<i>12-40</i>	<i>SEC. clay</i>	<i>FA. GRAN. SP</i>	<i>38</i>	<i>25% 3-1</i>			<i>.35</i>
3	<i>L 4%</i>	<i>0-12</i>	<i>SL</i>	<i>FA. GRAN. NO</i>					
		<i>12-42</i>	<i>SEC. clay</i>	<i>FA. GRAN. SP</i>	<i>40</i>	<i>25% 3-1</i>			<i>.38</i>
4	<i>L 2%</i>	<i>0-20</i>	<i>SL</i>	<i>FA. GRAN. NO</i>					
		<i>20-48</i>	<i>SEL</i>	<i>FA. GRAN. SP</i>	<i>44</i>	<i>25% 3-1</i>			<i>.6</i>

Description	Initial System	Repair System	Other Factors (.1946): Site Classification (.1948):
Available Space (.1945)			Evaluated By: <i>[Signature]</i> Others Present:
System Type(s)	<i>21E</i>	<i>Panel Steel</i>	
Site LTAR	<i>.3</i>	<i>.6</i>	