

Initial Application Date: 9-26-13

Application # 1350032193

COUNTY OF HARNETT RESIDENTIAL LAND USE APPLICATION

CU# _____

Central Permitting 108 E. Front Street, Lillington, NC 27546 Phone: (910) 893-7525 ext:2 Fax: (910) 893-2793 www.harnett.org/permits

Owner: Harnett Land Dev.
A RECORDED SURVEY MAP, RECORDED DEED (OR OFFER TO PURCHASE) & SITE PLAN ARE REQUIRED WHEN SUBMITTING A LAND USE APPLICATION

Builder: Wynn Construction, INC. Mailing Address: 2550 Capitol Dr, Suite 105
City: Creedmoor State: NC Zip: 27522 Contact No: 919-603-7965 Email: edward@wynnconstruct.com

APPLICANT: Wynn Construction Mailing Address: 2550 Capitol Dr, Suite 105
City: Creedmoor State: NC Zip: 27522 Contact No: 919-603-7965 Email: edward@wynnconstruct.com
*Please fill out applicant information if different than landowner

CONTACT NAME APPLYING IN OFFICE: J. Edward Averett Phone # 919-603-7965

PROPERTY LOCATION: Subdivision: Trotters Ridge Lot #: 24 Lot Size: .55
State Road # _____ State Road Name: Kentucky Derby Ln. Map Book & Page: 2013/303
Parcel: 030507 0200 71 PIN: 9597-83-1867.000

Zoning: RR20 Flood Zone: NA Watershed: NA Deed Book & Page: 02807,0847 Power Company: Progress Energy
*New structures with Progress Energy as service provider need to supply premise number 6TP from Progress Energy.

PROPOSED USE:

- SFD: (Size 49w x 52) # Bedrooms: 4 # Baths: 3 Basement(w/wo bath): N Garage: Y Deck: _____ Crawl Space: _____ Slab: _____ Slab: Monolithic Slab:
(Is the bonus room finished? yes no w/ a closet? yes no (if yes add in with # bedrooms)
- Mod: (Size _____ x _____) # Bedrooms _____ # Baths _____ Basement (w/wo bath) _____ Garage: _____ Site Built Deck: _____ On Frame _____ Off Frame _____
(Is the second floor finished? yes no Any other site built additions? yes no
- Manufactured Home: _____ SW _____ DW _____ TW (Size _____ x _____) # Bedrooms: _____ Garage: _____ (site built? _____) Deck: _____ (site built? _____)
- Duplex: (Size _____ x _____) No. Buildings: _____ No. Bedrooms Per Unit: _____
- Home Occupation: # Rooms: _____ Use: _____ Hours of Operation: _____ #Employees: _____
- Addition/Accessory/Other: (Size _____ x _____) Use: _____ Closets in addition? yes no

Water Supply: County _____ Existing Well _____ New Well (# of dwellings using well _____) *Must have operable water before final
Sewage Supply: New Septic Tank (Complete Checklist) _____ Existing Septic Tank (Complete Checklist) _____ County Sewer

Does owner of this tract of land, own land that contains a manufactured home within five hundred feet (500') of tract listed above? yes no

Does the property contain any easements whether underground or overhead yes no

Structures (existing or proposed): Single family dwellings: _____ Manufactured Homes: _____ Other (specify): _____

Required Residential Property Line Setbacks:

Location	Minimum	Actual
Front	<u>35</u>	<u>36'</u>
Rear	<u>25</u>	<u>57'</u>
Side	<u>10</u>	<u>25'</u>
Street/corner lot	_____	_____
Closest Building same lot	_____	_____

Comments: _____

SPECIFIC DIRECTIONS TO THE PROPERTY FROM LILLINGTON:

27 W To Nursery Rd Left on Nursery Rd
Right on Doc's Rd Subdivision on left
Lot 86 on Back Street on Right
Horse Whisperer Ln.

If permits are granted I agree to conform to all ordinances and laws of the State of North Carolina regulating such work and the specifications of plans submitted. I hereby state that foregoing statements are accurate and correct to the best of my knowledge. Permit subject to revocation if false information is provided.

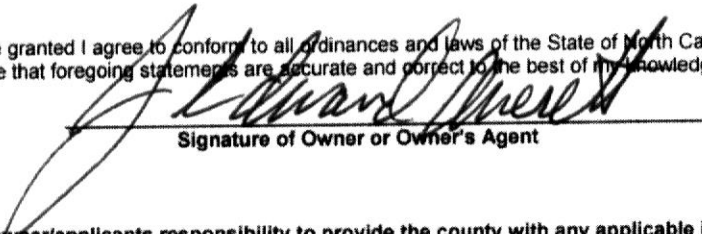

Signature of Owner or Owner's Agent

9-23-13

Date

It is the owner/applicants responsibility to provide the county with any applicable information about the subject property, including but not limited to: boundary information, house location, underground or overhead easements, etc. The county or its employees are not responsible for any incorrect or missing information that is contained within these applications.

This application expires 6 months from the initial date if permits have not been issued

MAP NO. 2013-303

SITE PLAN APPROVAL

DISTRICT RA20R USE SFD

#BEDROOMS 4

Date 9-26-13 Zoning Administrator [Signature]

MAP REFERENCE: MAP NO. 2013-303

MINIMUM BUILDING SET BACKS
 FRONT YARD 35'
 REAR YARD 25'
 SIDE YARD 10'
 CORNER LOT SIDE YARD - 20'
 MAXIMUM HEIGHT 35'



"KENTUCKY DERBY LANE" 60' R/W

CURVE RADIUS	LENGTH	CHORD	CH BEARING
C-1	25.00'	39.19'	35.30' N 60°22'17"W

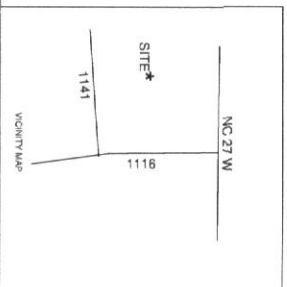

SURVEY FOR		PROPOSED PLOT PLAN - LOT - 24		TOWNSHIP BARBEQUE		COUNTY HARNETT		DATE: SEPTEMBER 19, 2013		SCALE: 1" = 40'		SURVEYED BY: RVB		FIELD BOOK	
STATE: NORTH CAROLINA		TROTTER'S RIDGE S/D - PHASE - 2-B		BARBEQUE		HARNETT		TAX PARCEL ID#		CHECKED & CLOSURE BY:		DRAWN BY: RVB		DRAWING NO. 13349	
ZONE: RA 20R		WATERFED DISTRICT		BARBEQUE		HARNETT		TAX PARCEL ID#		CHECKED & CLOSURE BY:		DRAWN BY: RVB		DRAWING NO. 13349	

BENNETT SURVEYS
 1682 CLARK RD., LILLINGTON, N.C. 27546
 (910) 893-5282

NAME: Wynn Construction, Inc

APPLICATION #: _____

County Health Department Application for Improvement Permit and/or Authorization to Construct

IF THE INFORMATION IN THIS APPLICATION IS FALSIFIED, CHANGED, OR THE SITE IS ALTERED, THEN THE IMPROVEMENT PERMIT OR AUTHORIZATION TO CONSTRUCT SHALL BECOME INVALID. The permit is valid for either 60 months or without expiration depending upon documentation submitted. (complete site plan = 60 months; complete plat = without expiration)

910-893-7525 option 1

CONFIRMATION # _____

- Environmental Health New Septic System Code 800**
 - All property irons must be made visible. Place "pink property flags" on each corner iron of lot. All property lines must be clearly flagged approximately every 50 feet between corners.
 - Place "orange house corner flags" at each corner of the proposed structure. Also flag driveways, garages, decks, out buildings, swimming pools, etc. Place flags per site plan developed at / for Central Permitting.
 - Place orange Environmental Health card in location that is easily viewed from road to assist in locating property.
 - If property is thickly wooded, Environmental Health requires that you clean out the undergrowth to allow the soil evaluation to be performed. Inspectors should be able to walk freely around site. Do not grade property.
 - All lots to be addressed within 10 business days after confirmation. \$25.00 return trip fee may be incurred for failure to uncover outlet lid, mark house corners and property lines, etc. once lot confirmed ready.
 - After preparing proposed site call the voice permitting system at 910-893-7525 option 1 to schedule and use code 800 (after selecting notification permit if multiple permits exist) for Environmental Health inspection. Please note confirmation number given at end of recording for proof of request.
 - Use Click2Gov or IVR to verify results. Once approved, proceed to Central Permitting for permits.
- Environmental Health Existing Tank Inspections Code 800**
 - Follow above instructions for placing flags and card on property.
 - Prepare for inspection by removing soil over outlet end of tank as diagram indicates, and lift lid straight up (if possible) and then close back down. (Unless inspection is for a septic tank in a mobile home park)
 - After uncovering outlet end call the voice permitting system at 910-893-7525 option 1 & select notification permit if multiple permits, then use code 800 for Environmental Health inspection. Please note confirmation number given at end of recording for proof of request.
 - Use Click2Gov or IVR to hear results. Once approved, proceed to Central Permitting for remaining permits.

SEPTIC

If applying for authorization to construct please indicate desired system type(s): can be ranked in order of preference, must choose one.

- Accepted Innovative Conventional Any
 Alternative Other _____

The applicant shall notify the local health department upon submittal of this application if any of the following apply to the property in question. If the answer is "yes", applicant must attach supporting documentation.

- YES NO Does the site contain any Jurisdictional Wetlands?
- YES NO Do you plan to have an irrigation system now or in the future?
- YES NO Does or will the building contain any drains? Please explain. _____
- YES NO Are there any existing wells, springs, waterlines or Wastewater Systems on this property?
- YES NO Is any wastewater going to be generated on the site other than domestic sewage?
- YES NO Is the site subject to approval by any other Public Agency?
- YES NO Are there any easements or Right of Ways on this property?
- YES NO Does the site contain any existing water, cable, phone or underground electric lines?
If yes please call No Cuts at 800-632-4949 to locate the lines. This is a free service.

I Have Read This Application And Certify That The Information Provided Herein Is True, Complete And Correct. Authorized County And State Officials Are Granted Right Of Entry To Conduct Necessary Inspections To Determine Compliance With Applicable Laws And Rules. I Understand That I Am Solely Responsible For The Proper Identification And Labeling Of All Property Lines And Corners And Making The Site Accessible So That A Complete Site Evaluation Can Be Performed.

J. Edward Aves
PROPERTY OWNERS OR OWNERS LEGAL REPRESENTATIVE SIGNATURE (REQUIRED)

9-23-13
DATE

LOT PURCHASE AGREEMENT

THIS LOT PURCHASE AGREEMENT ("Agreement") is made and entered into the 7th day of December, 2010 by and between Harnett Developers, LLC, a North Carolina Limited Liability Company ("Seller") and Wynn Construction, Inc., a North Carolina corporation ("Purchaser").

RECITALS

Trotter's Ridge (formerly Wood Acres), (the "Subdivision") located on Doc's Road in Harnett County, North Carolina as shown on Exhibit "A" (Preliminary plat) attached hereto. Preliminary plat proposes approximately 111 lots on parcel recorded in Plat Book 2005, Page 843, Deed Book 2524 at Page 136.

STATEMENT OF PURPOSE and AGREEMENT

Seller desires to sell and Purchaser desires to purchase from Seller all 111 lots in all phases of Trotter's Ridge Subdivision. Wynn Construction, along with Signature Home Builders and Hugh Surles Builders, will be the exclusive builder team in Trotter's Ridge Subdivision subject to the terms and conditions hereinafter set forth.

- Wynn shall close on the purchase of 15 lots within 30 days after plat recordation of Phase 1 and 1A, of which 1 lot out of these 15 will be subordinated by Seller for the purpose of a model home
- Seller shall keep 1 lot subordinated throughout the entire 111 lots for the purpose of a model home
- Wynn shall close on the purchase of an additional lot within 14 days of a closed sale of a Wynn spec home in Trotter's Ridge subdivision
- Wynn along with the aforementioned builder team shall close on all 45 lots in Phase 1 and 1A within 15 months of the initial lot closing and on all remaining lots in Trotter's Ridge within 48 months of the initial lot closing
- Purchaser and Seller acknowledge that all 111 lots are under contract by Wynn Construction, however, Wynn assigns the rights to Signature Home Builders Inc. and Hugh Surles Builders to purchase lots for the purpose of building homes for sale in Trotter's Ridge Subdivision through their respective building companies.
- Purchaser and Seller further acknowledge that as long as all terms and conditions of this contract are met that the above mentioned builders will remain as the sole purchasers of lots and exclusive builders in Trotter's Ridge Subdivision.

- b. The terms, conditions, and covenants contained in this Agreement shall survive the Closings and delivery of deeds. If the deeds and this Agreement are inconsistent, the provisions of this Agreement shall control.
- c. Any notices to be given under this Agreement shall be in writing and may be faxed, personally delivered or sent by regular mail to the addresses set forth above, or at such other addresses as the parties may specify by written notice to each other. All notices shall be deemed given when received or mailed as provided in this Paragraph.
- d. This agreement contains the entire understanding between the parties and may be amended only by written agreement signed by both Seller and Purchaser.
- e. The invalidity or unenforceability of any provision of this Agreement shall not affect the validity or enforceability of any other provisions, all of which shall be valid and enforceable to the fullest extent permitted by law.
- f. The waiver of any party of a breach of any provision of this Agreement shall not be considered a waiver of any other breach of such provision or any other provision of this Agreement.
- g. The parties acknowledge that no realtor or broker represented the interest of either party, and that no commissions are due to anyone as a result of the purchase and sale of the Lots.
- h. At all times, the parties will operate in good faith in carrying out the terms of this Agreement.
- i. Seller warrants to the Purchaser that Seller has the full power and authority to enter into this Agreement and carry out its provisions.
- j. This Agreement shall be binding upon and insure to the benefit of the Seller and the Buyer and their respective successors and assigns. This Agreement may be assigned by Buyer with the prior written consent of Seller which shall not be unreasonably withheld.

IN WITNESS WHEREOF, the parties have executed this Agreement on the dates set forth below.

PURCHASER:

Wynn Construction, Inc.
 By: William H. Wynn
 Its: President
 Date: 12/7/10

SELLER:

Hamer Developers, LLC
 By: [Signature]
 Its: Member
 Date: 12/7/10

Each section below to be filled out by whomever performing work. Must be owner or licensed contractor. Address, company name & phone must match

Application # _____
Harnett County Central Permitting
PO Box 65 Lillington, NC 27546
910-893-7525 Fax 910-893-2793 www.harnett.org/permits

Application for Residential Building and Trades Permit

Owner's Name: Wynn Construction, INC. Date: 9-23-13
Site Address: KENTUCKY Derby LN Phone: 919-603-7965
Directions to job site from Lillington: 27 W to Docs Rd, Left on Docs Rd
Right on Kentucky Derby Lane,

Subdivision Trotters Ridge Lot: 24 158
Description of Proposed Work: New Construction # of Bedrooms: 4
Heated SF: 2905 Unheated SF: 877 Finished Bonus Room? Y Crawl Space: Slab:

General Contractor Information

Wynn Construction, INC. 919 603-7965
Building Contractor's Company Name Telephone
2550 CAPITOL Dr. edward@wynnconstruction.com
Address Email Address
46295
License #

Electrical Contractor Information

Description of Work New Construction Service Size: 200 Amps T-Pole: Yes No
R. A. JACKSON 919 730-1251
Electrical Contractor's Company Name Telephone
9261 Raleigh Road Benson, NC 27504
Address Email Address
21144
License #

Mechanical/HVAC Contractor Information

Description of Work New Construction
Carolina Comfort A/C INC. 919 550-7716
Mechanical Contractor's Company Name Telephone
5212 US Hwy 70 Bus W. Clayton, NC carolinacomfortair@yahoo.com
Address Email Address
29077
License #

Plumbing Contractor Information

Description of Work New Construction # Baths 3
Thornton's Plumbing
Plumbing Contractor's Company Name Telephone
3160A Omar Rd Clayton NC
Address Email Address
22152
License #

Insulation Contractor Information

Tatum Insulation 919 661-0999
Insulation Contractor's Company Name & Address Telephone

*NOTE: General Contractor must fill out and sign the second page of this application.

Homeowners Applying to Build Their Own Home

Please answer the following questions then see a Permit Technician to determine if you qualify for permit under Owners Exemption Questionnaire per G.S. 87-14 Regulations as to Issue of Building Permits (Memo available upon request)

1. Do you own the land on which this building will be constructed? ___ Yes ___ No
2. Have you hired or intend to hire an individual to superintend and manage construction of the project? ___ Yes ___ No
3. Do you intend to directly control & supervise construction activities? ___ Yes ___ No
4. Do you intend to schedule, contract, or directly pay for all phases of construction work to be done? ___ Yes ___ No
5. Do you intend to personally occupy the building for at least 12 consecutive months following completion of construction and do you understand that if you do not do so, it creates the presumption under law that you fraudulently secured the permit? ___ Yes ___ No

I hereby certify that I have the authority to make necessary application, that the application is correct and that the construction will conform to the regulations in the Building, Electrical, Plumbing and Mechanical codes, and the Harnett County Zoning Ordinance. I state the information on the above contractors is correct as known to me and that by signing below I have obtained all subcontractors permission to obtain these permits and if any changes occur including listed contractors, site plan, number of bedrooms, building and trade plans, Environmental Health permit changes or proposed use changes, I certify it is my responsibility to notify the Harnett County Central Permitting Department of any and all changes.

EXPIRED PERMIT FEES - 6 Months to 2 years permit re-issue fee is \$150.00. After 2 years re-issue fee is as per current fee schedule.

J. Edward Averett
Signature of Owner/Contractor/Officer(s) of Corporation

9-23-13
Date

Affidavit for Worker's Compensation N.C.G.S. 87-14

The undersigned applicant being the:

___ General Contractor ___ Owner ___ Officer/Agent of the Contractor or Owner

Do hereby confirm under penalties of perjury that the person(s), firm(s) or corporation(s) performing the work set forth in the permit:

Has three (3) or more employees and has obtained workers' compensation insurance to cover them.

___ Has one (1) or more subcontractors(s) and has obtained workers' compensation insurance to cover them.

___ Has one (1) or more subcontractors(s) who has their own policy of workers' compensation insurance covering themselves.

___ Has no more than two (2) employees and no subcontractors.

While working on the project for which this permit is sought it is understood that the Central Permitting Department issuing the permit may require certificates of coverage of worker's compensation insurance prior to issuance of the permit and at any time during the permitted work from any person, firm or corporation carrying out the work.

Company or Name: *Wynn Construction, Inc.*

Sign w/Title: *J. Edward Averett*

Date: 9-23-13

Designated Lien Agent

Investors Title Insurance Company

Online: www.liensnc.com
Address: 19 W. Hargett St., Suite 507 / Raleigh, NC 27601
Email: support@liensnc.com
Fax: (919) 489-5231
Technical Support Hotline (888) 690-7384

Entry Number: 48832

Filed by: wynnhomes

Payment Amount: \$25.00

Filing Date: 09/21/2013



Owner Information

wynn construction inc
2550 capitol dr., suite 105
creedmoor NC 27522
United States
919-528-1347

Project Property

trotters ridge subdivision lot 24
kentucky derby lane Map:
lillington Block:
NC 27546 Lot: lot 24
9597932848000
Property Type: 1-2 Family Dwelling

Original Contractor

Date of First Furnishing

Pre-Permit Workers

none

Pre-Permit Worker Emails

Plan Box # A8

Date 9-26-13
Job Name Wynn

App # 32193

Valuation 218824

SQ Feet 3368

Inspections for SFD/SFA

Crawl

Slab

Mono

Basement

Footing	Footing	Plum Under Slab	Footing
Foundation	Foundation	Ele. Under Slab	Foundation
Address	Address	Address	Waterproofing
Open Floor	Slab	Mono Slab	Plum Under slab
Rough In	Rough In	Rough In	Address
Insulation	Insulation	Insulation	Slab
Final	Final	Final	Open Floor
			Rough In
			Insulation
			Final

Foundation Survey

Envir. Health

Other

Additions / Other

Footing

Foundation

Slab

Mono

Open Floor

Rough In

Insulation

Final

HARNETT COUNTY CENTRAL PERMITTING

P.O. BOX 65

LILLINGTON, NC 27546

For Inspections Call: (910) 893-7525 Fax: (910) 893-2793

Bldg Insp scheduled before 2pm available next business day.

Application Number 13-50032193 Date 10/29/13
 Intersection
 Property Address 672 KENTUCKY DERBY LN
 PARCEL NUMBER 03-0507- - -0200- -71-
 Application type description CP NEW RESIDENTIAL (SFD)
 Subdivision Name TROTTER'S RIDGE PH2B 23LOTS
 Property Zoning RES/AGRI DIST - RA-20R

Owner Contractor

 HARNETT DEVELOPERS LLC WYNN CONSTRUCTION, INC.
 2317 ENON ROAD 1696 HAYES RD
 OXFORD NC 27565 CREEDMOOR NC 27522
 (919) 528-1347

Applicant

 WYNN CONSTRUCTION INC #24
 2550 CAPITOL DR
 STE 105
 CREEDMOOR NC 27522
 (919) 603-7965

--- Structure Information 000 000 49X57 4BDR MONO W/ GARAGE
 Flood Zone FLOOD ZONE X
 Other struct info # BEDROOMS 4000000.00
 PROPOSED USE SFD
 SEPTIC - EXISTING? NEW TANK
 WATER SUPPLY COUNTY

 Permit BLDG, MECH, ELEC, PLB, INSU PERMIT
 Additional desc
 Phone Access Code 1003243
 Issue Date 10/29/13 Valuation 0
 Expiration Date 10/29/14

 Special Notes and Comments
 T/S: 09/26/2013 10:29 AM JBROCK ----
 TROTTERS RIDGE #24
 XXX
 PERMIT INCLUDES BLDG, ELEC, MECH, PLUMB
 INSULATION AND LAND USE.
 XXX
 Work must conform and comply with the
 STATE BUILDING CODE and all other State
 and local laws, ordinances & regulations

HARNETT COUNTY CENTRAL PERMITTING

P.O. BOX 65

LILLINGTON, NC 27546

For Inspections Call: (910) 893-7525 Fax: (910) 893-2793

Bldg Insp scheduled before 2pm available next business day.

Page 2
Date 10/29/13

Application Number 13-50032193
 Property Address 672 KENTUCKY DERBY LN
 PARCEL NUMBER 03-0507- - -0200- -71-
 Application description . . . CP NEW RESIDENTIAL (SFD)
 Subdivision Name TROTTER'S RIDGE PH2B 23LOTS
 Property Zoning RES/AGRI DIST - RA-20R

Permit BLDG,MECH,ELEC,PLB,INSU PERMIT

Additional desc . . .
 Phone Access Code . . . 1003243

Required Inspections

Seq	Phone Insp#	Insp Code	Description	Initials	Date
10-30	814	A814	ADDRESS CONFIRMATION	_____	___/___/___
10-999	309	P309	R*PLUMB UNDER SLAB	_____	___/___/___
10-999	205	E205	R*ELEC UNDER SLAB	_____	___/___/___
20-999	114	B114	R*BLDG MONO SLAB/TEMP SVC POLE	_____	___/___/___
20	104	B104	R*FOUND & SETBACK VERIF SURVEY	_____	___/___/___
30-50	129	I129	R*INSULATION INSPECTION	_____	___/___/___
30-60	425	R425	FOUR TRADE ROUGH IN	_____	___/___/___
30-60	125	R125	ONE TRADE ROUGH IN	_____	___/___/___
30-60	325	R325	THREE TRADE ROUGH IN	_____	___/___/___
30-60	225	R225	TWO TRADE ROUGH IN	_____	___/___/___
40-60	429	R429	FOUR TRADE FINAL	_____	___/___/___
40-60	131	R131	ONE TRADE FINAL	_____	___/___/___
40-60	329	R329	THREE TRADE FINAL	_____	___/___/___
40-60	229	R229	TWO TRADE FINAL	_____	___/___/___
999		H824	ENVIR. OPERATIONS PERMIT	_____	___/___/___