

HTE# 13-5-32069R

# Hamilton County Department of Public Health

27673

## Improvement Permit

A building permit cannot be issued with only an Improvement Permit

ISSUED TO: JSS BUILDERS Inc PROPERTY LOCATION: COPPER LOOP  
 SUBDIVISION: WEST LANDING @ THE SUMMIT LOT # 155  
 NEW  REPAIR  EXPANSION   
 Type of Structure: SFO (42x51) Site Improvements required prior to Construction Authorization Issuance:  
 Proposed Wastewater System Type: 25% REDUCTION SYSTEM  
 Projected Daily Flow: 60000 GPD  
 Number of Basements: 45 Number of Occupants: 210 max  
 Basement  Yes  No  
 Pump Required:  Yes  No  May be required based on final location and elevations of facilities  
 Type of Water Supply:  Community  Public  Well Distance from well 100 feet Permit valid for:  Five years  
 No expiration  
 Permit conditions: \_\_\_\_\_

Authorized State Agent: [Signature] Date: 9/24/13 SEE ATTACHED SITE SKETCH  
 The issuance of this permit by the Health Department in no way guarantees the issuance of other permits. The permit holder is responsible for checking with appropriate governing bodies in meeting their requirements. This site is subject to revocation if the site plan, plat, or the intended use changes. The Improvement Permit shall not be affected by a change in ownership of the site. This permit is subject to compliance with the provisions of the Laws and Rules for Sewage Treatment and Disposal and the conditions of this permit.  
REVIS 10/8/14 REVIS

## Construction Authorization

(Required for Building Permit)

The construction and installation requirements of Rules .1950, .1952, .1954, .1955, .1956, .1957, .1958, and .1959 are incorporated by references into this permit and shall be met. Systems shall be installed in accordance with the attached system layout.

ISSUED TO: JSS BUILDERS Inc PROPERTY LOCATION: COPPER LOOP  
 SUBDIVISION: WEST LANDING @ THE SUMMIT LOT # 155  
 Facility Type: SFO (42x51)  New  Expansion  Repair  
 Basement?  Yes  No Basement Fixtures?  Yes  No  
 Type of Wastewater System\*\* 25% REDUCTION SYSTEM (Initial) Wastewater Flow: 600 GPD  
 (See note below, if applicable )  
Pump To 25% REDUCTION (Repair)

**Installation Requirements/Conditions**  
 Septic Tank Size 1000 gallons  
 Pump Tank Size 1250 gallons  
 Number of trenches 1 190  
 Exact length of each trench 750 feet  
 Trenches shall be installed on contour at a Maximum Trench Depth of: 18-36 inches (Trench bottoms shall be level to +/-1/4" in all directions)  
 Trench Spacing: 9 Feet on Center  
 Soil Cover: 6-24 inches (Maximum soil cover shall not exceed 36" above the trench bottom)  
 Pump Requirements: \_\_\_\_\_ ft. TDH vs. \_\_\_\_\_ GPM \_\_\_\_\_ inches below pipe  
 Aggregate Depth: \_\_\_\_\_ inches above pipe  
 Conditions: \_\_\_\_\_ inches total

**WATER LINES (INCLUDING IRRIGATION) MUST BE 10FT. FROM ANY PART OF SEPTIC SYSTEM OR REPAIR AREA. NO UTILITIES ALLOWED IN INITIAL OR REPAIR DRAIN FIELD AREA.**

\*\*If applicable: I understand the system type specified is different from the type specified on the application. I accept the specifications of this permit.

Owner/Legal Representative Signature: \_\_\_\_\_ Date: \_\_\_\_\_  
 This Construction Authorization is subject to revocation if the site plan, plat, or the intended use changes. The Construction Authorization shall not be transferred when there is a change in ownership of the site. This Construction Authorization is subject to compliance with the provisions of the Laws and Rules for Sewage Treatment and Disposal and to the conditions of this permit. SEE ATTACHED SITE SKETCH

Authorized State Agent: [Signature] Date: 9/24/13  
REVIS 10/8/14 REVIS Construction Authorization Expiration Date: 9/24/18

HTE# 13-5-32069R

Permit # 27673

# Harnett County Department of Public Health Site Sketch

PROPERTY LOCATION: COPPER LOOP

ISSUED TO: JST BUILDERS INC SUBDIVISION WEST LANDING @ THE SUMMIT LOT # 155

Authorized State Agent: ~~RENS (OLIVER TOLKSDOTT)~~ Date: 9/24/13

REVISED 10/8/14

~~RENS~~

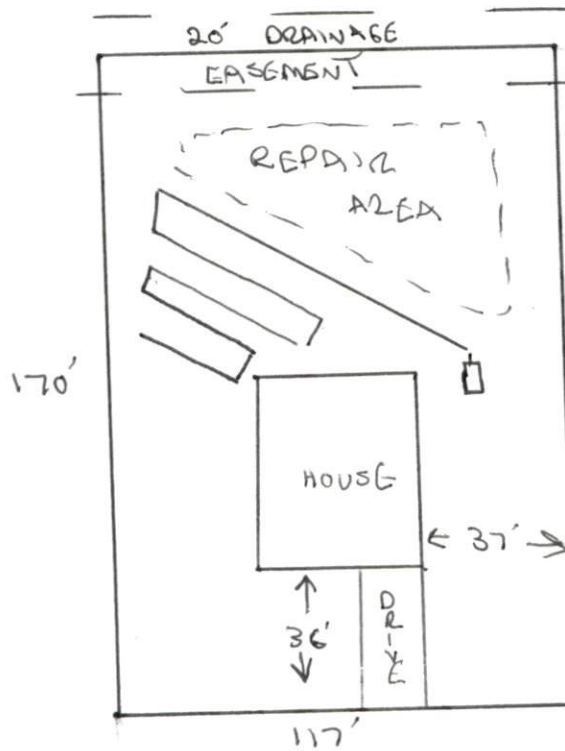

COPPER LOOP