

HTE# 13-5-31905

Harnett County Department of Public Health Improvement Permit

27564

A building permit cannot be issued with only an Improvement Permit

ISSUED TO: Bernard F Young PROPERTY LOCATION: Hwy 401N
 NEW REPAIR EXPANSION SUBDIVISION: CLASSIC CORN LOT # 5
 Type of Structure: SFD Site Improvements required prior to Construction Authorization Issuance: _____
 Proposed Wastewater System Type: 25% REDUCED
 Projected Daily Flow: 360 GPD
 Number of bedrooms: 3 Number of Occupants: 6 max
 Basement Yes No
 Pump Required: Yes No May be required based on final location and elevations of facilities
 Type of Water Supply: Community Public Well Distance from well _____ feet Permit valid for: Five years
 Permit conditions: _____ No expiration

Authorized State Agent: James E. Markham Date: 8-16-13 SEE ATTACHED SITE SKETCH
 The issuance of this permit by the Health Department in no way guarantees the issuance of other permits. The permit holder is responsible for checking with appropriate governing bodies in meeting their requirements. This site is subject to revocation if the site plan, plat, or the intended use changes. The Improvement Permit shall not be affected by a change in ownership of the site. This permit is subject to compliance with the provisions of the Laws and Rules for Sewage Treatment and Disposal and to conditions of this permit..

Construction Authorization

(Required for Building Permit)

The construction and installation requirements of Rules .1950, .1952, .1954, .1955, .1956, .1957, .1958, and .1959 are incorporated by references into this permit and shall be met. Systems shall be installed in accordance with the attached system layout.

ISSUED TO: Bernard F. Young PROPERTY LOCATION: Hwy 401N
 SUBDIVISION CLASSIC CORN LOT # 5
 Facility Type: SFD New Expansion Repair
 Basement? Yes No Basement Fixtures? Yes No
 Type of Wastewater System** Pump to 25% REDUCED system (Initial) Wastewater Flow: 360 GPD
 (See note below, if applicable) Pump to 25% REDUCED (Repair)

Installation Requirements/Conditions
 Septic Tank Size 1000 gallons Number of trenches 4
 Pump Tank Size 1000 gallons Exact length of each trench 100 feet Trench Spacing: 9 Feet on Center
 Trenches shall be installed on contour at a Soil Cover: 6 inches
 Maximum Trench Depth of: 18 inches (Maximum soil cover shall not exceed 36" above the trench bottom)
 (Trench bottoms shall be level to +/-1/4" in all directions)
 Pump Requirements: _____ ft. TDH vs. _____ GPM Aggregate Depth: 6 inches below pipe
 _____ 2 inches above pipe
 Conditions: _____ 12 inches total

**WATER LINES (INCLUDING IRRIGATION) MUST BE 10FT. FROM ANY PART OF SEPTIC SYSTEM OR REPAIR AREA.
NO UTILITIES ALLOWED IN INITIAL OR REPAIR DRAIN FIELD AREA.**

**If applicable: I understand the system type specified is different from the type specified on the application. I accept the specifications of this permit.
 Owner/Legal Representative Signature: _____ Date: _____

This Construction Authorization is subject to revocation if the site plan, plat, or the intended use changes. The Construction Authorization shall not be transferred when there is a change in ownership of the site. This Construction Authorization is subject to compliance with the provisions of the Laws and Rules for Sewage Treatment and Disposal and to the conditions of this permit. SEE ATTACHED SITE SKETCH

Authorized State Agent: James E. Markham Date: 8-16-13
 Construction Authorization Expiration Date: 8-16-18

HTE# 13-5-31905

Permit # 27564

Harnett County Department of Public Health Site Sketch

ISSUED TO: Bernard F. Young PROPERTY LOCATOR: Hwy 401 N
SUBDIVISION CLASSIC CORN LOT # 5

Authorized State Agent: James E. [Signature] Date: 8-15-13

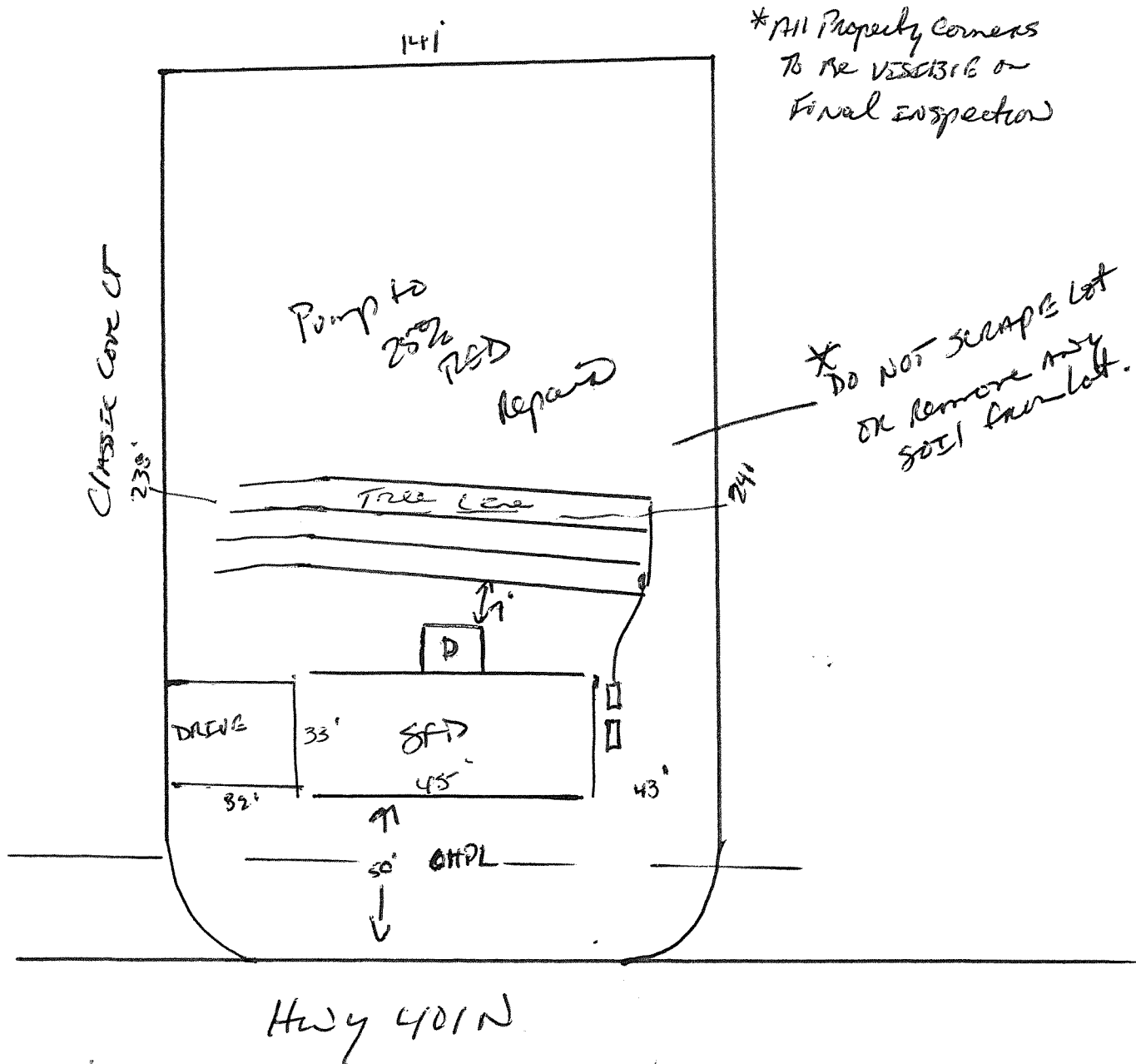

**SOIL/SITE EVALUATION
 for ON-SITE WASTEWATER SYSTEM**

Owner: Applicant: *Young*
 Address: Date Evaluated: *8-13-15*
 Proposed Facility: *SFP* Design Flow (.1949): *360* Property Size:
 Location of Site: Property Recorded:
 Water Supply: Public Individual Well Spring Other
 Evaluation Method: Auger Boring Pit Cut
 Type of Wastewater: Sewage Industrial Process Mixed

P R O F I L E #	.1940 Landscape Position/ Slope %	Horizon Depth (In.)	SOIL MORPHOLOGY .1941		OTHER PROFILE FACTORS				Profile Class & LTAR
			.1941 Structure/ Texture	.1941 Consistence Mineralogy	.1942 Soil Wetness/ Color	.1943 Soil Depth (IN.)	.1956 Sapro Class	.1944 Restr Horiz	
1	<i>L</i>	<i>0-5</i>	<i>SL</i>	<i>GN GRANSP</i>					
		<i>5-32</i>	<i>SL-Clay</i>	<i>GN 188 S.P.</i>	<i>28</i>	<i>5L</i>			<i>.25</i>
2	<i>L</i>	<i>0-6</i>	<i>SL</i>	<i>GN GRANSP</i>					
		<i>6-40</i>	<i>SL-Clay</i>	<i>GN 188 S.P.</i>	<i>30</i>	<i>5L</i>			<i>.3</i>
3	<i>L</i>	<i>0-10</i>	<i>SL</i>	<i>GN GRANSP</i>					
		<i>10-40</i>	<i>SL-Clay</i>	<i>GN 188 S.P.</i>	<i>30-32</i>	<i>5L</i>			<i>.3</i>
4	<i>L</i>	<i>0-18</i>	<i>SL</i>	<i>GN GRANSP</i>					
		<i>18-42</i>	<i>SL-Clay</i>	<i>GN 188 S.P.</i>	<i>36</i>	<i>5L</i>			<i>.3</i>

Description	Initial System	Repair System	Other Factors (.1946):
Available Space (.1945)	<i>✓</i>	<i>✓</i>	Site Classification (.1948): <i>PS</i>
System Type(s)	<i>2500</i>	<i>2500</i>	Evaluated By: <i>[Signature]</i>
Site LTAR	<i>.3</i>	<i>.3</i>	Others Present: