

HTE# 13-5-31076

Hett County Department of Pub Health

PERMIT # 27439

Operation Permit

22854

New Installation Septic Tank Nitrification Line Repair Expansion

PROPERTY LOCATION: ALPINE DR

Name: (owner) CATES BUILDING INC SUBDIVISION WEST LANDING @ THE SUMMIT LOT # 170

System Installer: EDDIE GARNER Registration # _____

Basement with plumbing: Garage Number of Bedrooms 6

Type of Water Supply: Community Public Well Distance from well 100 feet

System Type: III g Types V and VI Systems expire in 5 years.

(In accordance with Table V a)

Owner must contact Health Department 6 months prior to expiration for permit renewal.

This system has been installed in compliance with applicable North Carolina General Statutes, Rules for Sewage Treatment and Disposal, and all conditions of the Improvement Permit and Construction Authorization.

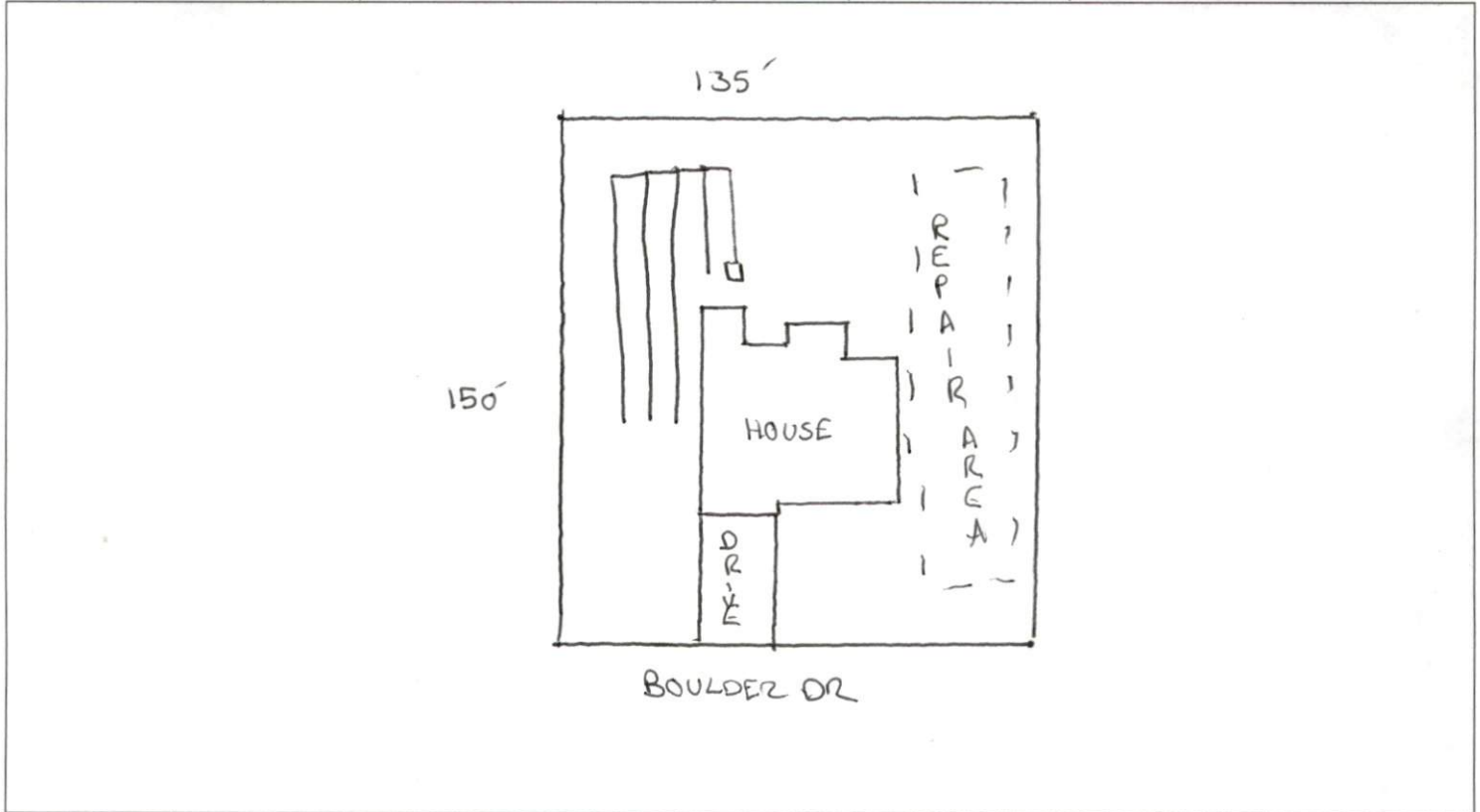

PERMIT CONDITIONS:

- I. Performance: System shall perform in accordance with Rule .1961.
- II. Monitoring: As required by Rule .1961.
- III. Maintenance: As required by Rule .1961. Other: _____
Subsurface system operator required? Yes No
If yes, see attached sheet for additional operation conditions, maintenance and reporting.

IV. Operation: _____

V. Other: SYSTEM LAYOUT CHANGED DUE TO UTILITY PLACEMENT

D-Box Pump Alarm H2O Line PWR Line

Following are the specifications for the sewage disposal system on the above captioned property.

Type of system: Conventional Other CHAMBER (Q4) Septic Tank: 1500 gallons Pump Tank: _____ gallons
 Subsurface No. of exact length width of depth of
 Drainage Field ditches 1 of each ditch 285 feet ditches 3 feet ditches 30-18 inches
 French Drain Required: _____ Linear feet

Authorized State Agent

REHS

Date

7/23/13