

FUQUAY-VARINA

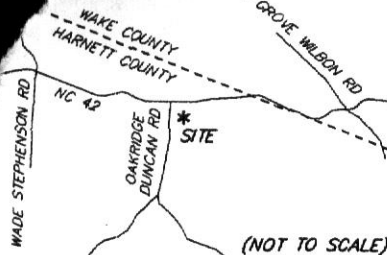

VICINITY MAP

I, Staley C. Smith, do hereby certify that this plat was drawn under my supervision from an actual survey made under my supervision using references shown hereon; that the boundaries not surveyed are shown as broken lines plotted from information shown hereon; that the ratio of precision as calculated by latitudes and departures is 1: 10,000+; witness my original signature, license number and seal this 2ND day of APRIL, A. D., 2013.

This survey is of an existing building or other structure, or natural feature, such as a watercourse.

Staley C. Smith
Surveyor

L-3766
License Number



LOT 17 ~ AUSTIN FARMS
REFERENCES: PLAT BOOK 2006, PAGE 766
DEED BOOK 2302, PAGE 352

PROPERTY ADDRESS:
156 TWIN FIELDS DRIVE
FUQUAY VARINA, NC 27526
ALL DISTANCES SHOWN HEREON ARE
HORIZONTAL GROUND MEASUREMENTS.
AREA BY THE D.M.D. METHOD

MINIMUM BUILDING SETBACKS
(PER RECORD MAP)

FRONT	35'
SIDE	10'
REAR	25'
CORNER SIDE	20'

N/F
GEORGE H. LYNAM
D.B. 2166, PG. 245
P.B. 2005, PG. 821

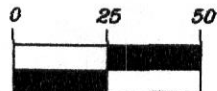

(IN FEET)
1 inch = 50 ft.

DRAWN BY
WBH

LEGEND

- EIP - ● - Existing Iron Pipe
- IPS - ○ - Iron Pipe Set
- MP - ○ - Mathematical Point Only
- R/W - Right Of Way
- WM - Water Meter
- CTV - Cable TV Pedestal
- SCO - Sewer Cleanout
- HVAC - Heating, Ventilation, and Air Conditioning

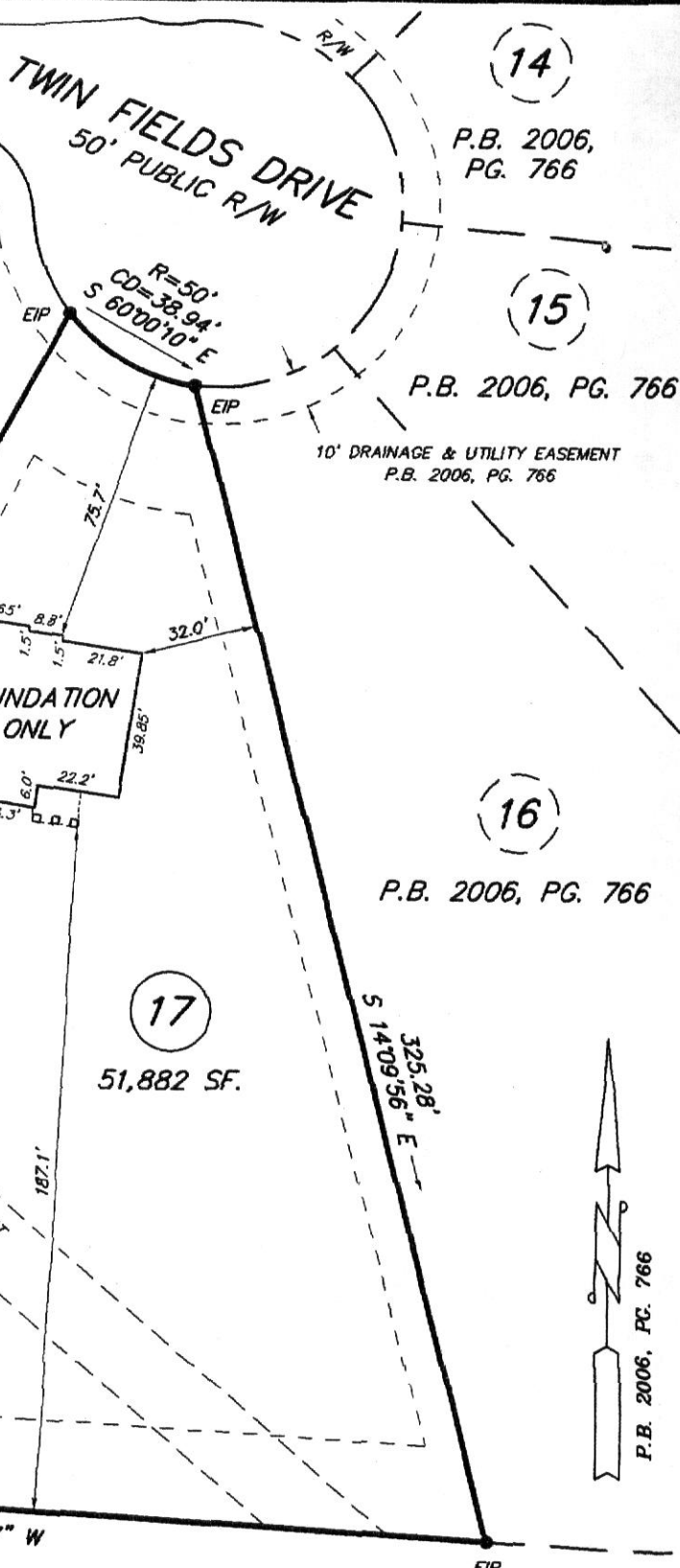

14

P.B. 2006, PG. 766

15

P.B. 2006, PG. 766

10' DRAINAGE & UTILITY EASEMENT
P.B. 2006, PG. 766

16

P.B. 2006, PG. 766

17

51,882 SF.

P.B. 2006, FC. 766

LOCATION SURVEY FOR

LELAND BUILDERS

BUCKHORN TOWNSHIP, HARNETT COUNTY, NORTH CAROLINA

Smith and Smith
surveyors

FIRM LICENSE No. C-0155

P.O. BOX 457
APEX, N.C. 27502
(919) 382-7111

PITTSBORO, N.C. 27312
(919) 542-4321

DATE APRIL 2, 2013
SCALE 1" = 50'
PIN 0645-08-3772.000
PROJECT No. 13-26