

Harnett County

INSPECTOR: IVR

DATE 2/22/13

ADDRESS : 250 SHEPARD DR
 CONTRACTOR : SAVVY HOMES, LLC
 OWNER : KENLAN DEVELOPMENT CO
 PARCEL : 12-0555- - -0216- -57-
 APPL NUMBER: 12-50030316 CP NEW RESIDENTIAL (SFD)
 DIRECTIONS : T/S: 12/21/2012 09:05 AM JBROCK ----
 210 TOWARDS FAY TAKE L AT MCNEILL HOBBS
 RD FOLLOW FOR ABOUT 4.5 MILES TO TURN R
 AT WIRE RD KENLAN FARMS S/D LOT 53

SUBDIV: KENLAN FARMS PH1SECT2
 PHONE : (919) 781-8104
 PHONE :

SCANNED

DATE

STRUCTURE: 000 000 51X42.4 4BDR SLAB W/ GARAGE

FLOOD ZONE : FLOOD ZONE X

BEDROOMS : 4000000.00

SEPTIC - EXISTING? : NEW

PROPOSED USE : SFD

WATER SUPPLY : COUNTY

PERMIT: CPSF 00 CP * SFD

TYP/SQ	REQUESTED COMPLETED	INSP RESULT	DESCRIPTION RESULTS/COMMENTS
B101 01	2/06/13	DT	R*BLDG FOOTING / TEMP SVC POLE VRU #: 002335198
	2/06/13	AP	T/S: 02/06/2013 10:42 AM DETAYLOR -----
B101 02	2/13/13	JH	R*BLDG FOOTING / TEMP SVC POLE TIME: 17:00 VRU #: 002338275
	2/13/13	CA	T/S: 02/12/2013 12:48 PM VBROWN ----- PER DAVE -----
B101 03	2/14/13	JH	R*BLDG FOOTING / TEMP SVC POLE VRU #: 002338788
	2/14/13	AP	T_POLE PASSED 250 shepard Dr -----
B103 01	2/19/13	JH	R*BLDG FOUND & TEMP SVC POLE VRU #: 002339950
	2/19/13	DA	Missing foundation projection on inside of garage on left side need engineer letter for repair do not pour footing before inspection.
A814 01	2/22/13	TI	ADDRESS CONFIRMATION TIME: 17:00 VRU #: 002342285
B103 02	2/22/13	TI	R*BLDG FOUND & TEMP SVC POLE TIME: 17:00 VRU #: 002342277

2/22/13 TI AP DT

COMMENTS AND NOTES

George G. Aiken, PE

6030 Creedmoor Rd, Suite 101
Raleigh NC, 27612

February 20th 2013

Ref: KEN 53

The following letter is to address the footing projection issue at the garage wall of the Grayson C. The following repair is recommended:

Excavate footing 12" out from furthest projection point of the wall in question 12" wide by 8" deep. Dowel rebar in to existing footing with 2 part epoxy leaving exposure of said rebar for bonding. Rebar should embed 7" into concrete and have 7" exposure. Space rebar @ 30" o.c. Pour concrete to exposed rebar. See drawing below for more information. This repair is structurally adequate.

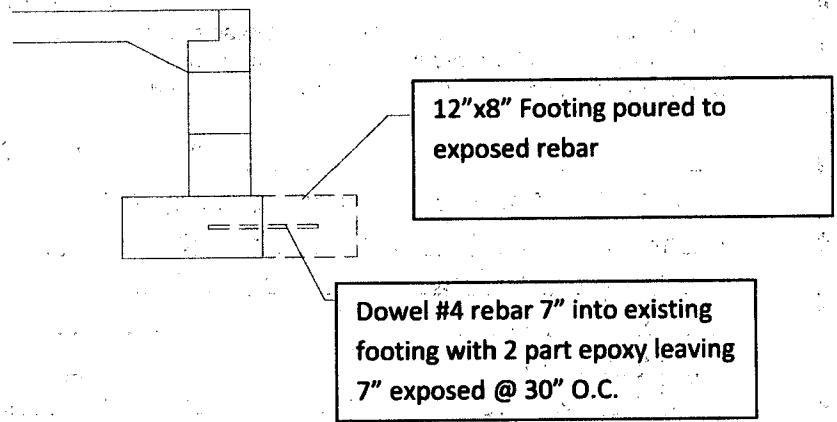

If you have any questions please contact me at: 919-279-2313.

Sincerely,



George G. Aiken
George G. Aiken, PE