

HTE# 12-5-29490

Halbert County Department of Public Health

27025

Improvement Permit

A building permit cannot be issued with only an Improvement Permit

ISSUED TO: Jeremy + Mary Beth Parrish
PROPERTY LOCATION: 51711 Brinkley RD
SUBDIVISION: Gate McComb
LOT #:
NEW [X] REPAIR [] EXPANSION []
Type of Structure: SFD
Proposed Wastewater System Type: 25% REDUCED
Projected Daily Flow: 480 GPD
Number of bedrooms: 4 Number of Occupants: 8 max
Basement [] Yes [X] No
Pump Required: [] Yes [] No [X] May be required based on final location and elevations of facilities
Type of Water Supply: [] Community [] Public [X] Well Distance from well 50 feet
Permit valid for: [X] Five years [] No expiration

Authorized State Agent: James E. Markland Date: 8-15-12 SEE ATTACHED SITE SKETCH
The issuance of this permit by the Health Department in no way guarantees the issuance of other permits. The permit holder is responsible for checking with appropriate governing bodies in meeting their requirements. This site is subject to revocation if the site plan, plat, or the intended use changes. The Improvement Permit shall not be affected by a change in ownership of the site. This permit is subject to compliance with the provisions of the Laws and Rules for Sewage Treatment and Disposal and to conditions of this permit.

Construction Authorization

(Required for Building Permit)

The construction and installation requirements of Rules .1950, .1952, .1954, .1955, .1956, .1957, .1958, and .1959 are incorporated by references into this permit and shall be met. Systems shall be installed in accordance with the attached system layout.

ISSUED TO: Jeremy + Mary Beth Parrish
PROPERTY LOCATION: 51711 Brinkley RD
SUBDIVISION: Gate McComb
LOT #:
Facility Type: SFD [X] New [] Expansion [] Repair []
Basement? [] Yes [X] No Basement Fixtures? [] Yes [X] No
Type of Wastewater System: 25% REDUCED SYSTEM (Initial) Wastewater Flow: 480 GPD
(See note below, if applicable) 25% REDUCED (Repair)

Installation Requirements/Conditions
Septic Tank Size 1200 gallons
Pump Tank Size _____ gallons
Number of trenches 2
Exact length of each trench 200 feet
Trench Spacing: 7 Feet on Center
Trenches shall be installed on contour at a
Maximum Trench Depth of: 24 inches
Soil Cover: 6 inches
(Pump bottoms shall be level to +/-1/4"
36" above the trench bottom)
Pump Requirements: _____ ft. TDH vs. _____ GPM
Aggregate Depth: 6 inches below pipe
2 inches above pipe
12 inches total
Conditions: Contractor may want to meet on site prior to install.

WATER LINES (INCLUDING IRRIGATION) MUST BE 10FT. FROM ANY PART OF SEPTIC SYSTEM OR REPAIR AREA. NO UTILITIES ALLOWED IN INITIAL OR REPAIR DRAIN FIELD AREA.

**If applicable: I understand the system type specified is different from the type specified on the application. I accept the specifications of this permit.

Owner/Legal Representative Signature: _____ Date: _____

This Construction Authorization is subject to revocation if the site plan, plat, or the intended use changes. The Construction Authorization shall not be transferred when there is a change in ownership of the site. This Construction Authorization is subject to compliance with the provisions of the Laws and Rules for Sewage Treatment and Disposal and to the conditions of this permit. SEE ATTACHED SITE SKETCH

Authorized State Agent: James E. Markland Date: 8-15-12
Construction Authorization Expiration Date: 8-15-17

HTE# 12-5-29490

Permit # ~~10-5-29490~~

Harnett County Department of Public Health Site Sketch

PROPERTY LOCATOR: SR 1711 Brinkley RD

ISSUED TO: Jeremy and Mary Beth [unclear] SUBDIVISION Gate Mills LOT # _____

Authorized State Agent: James E. [unclear] Date: 8-15-12

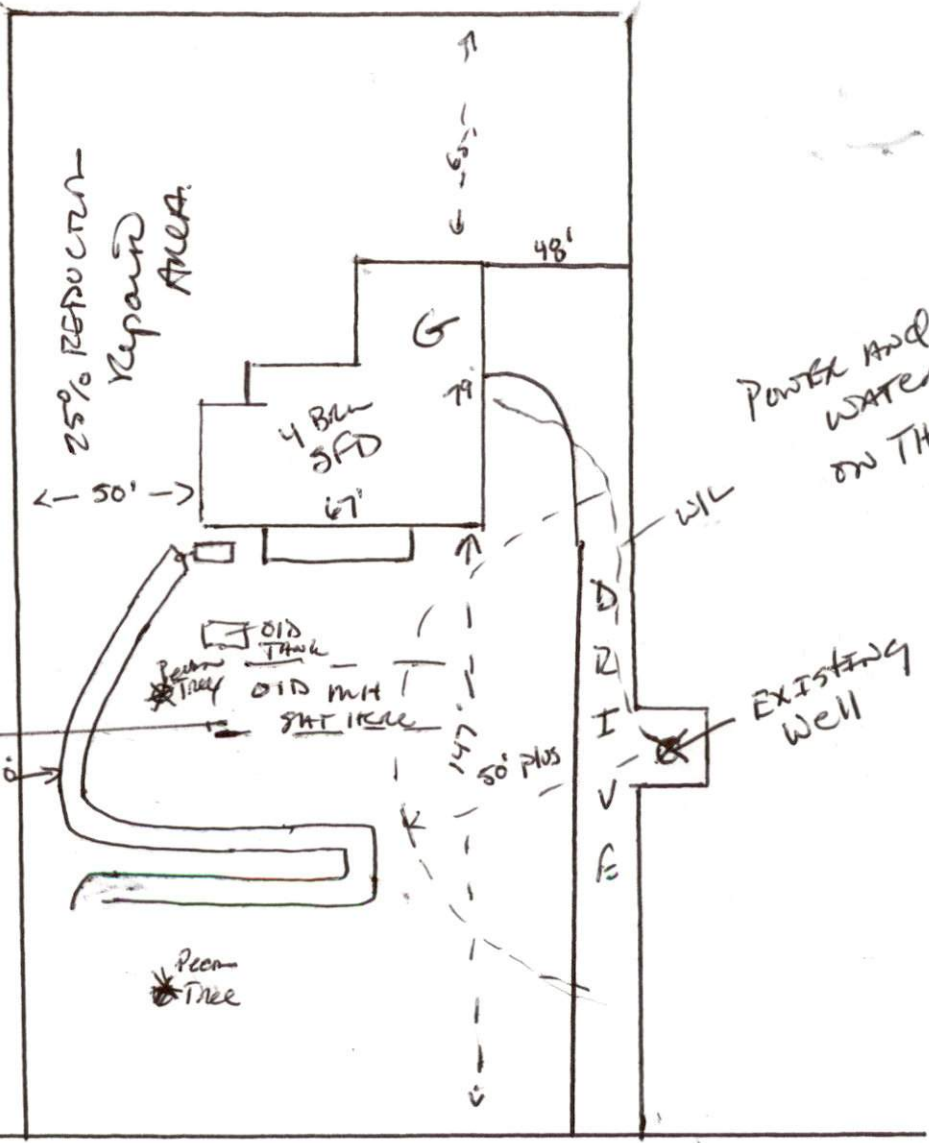
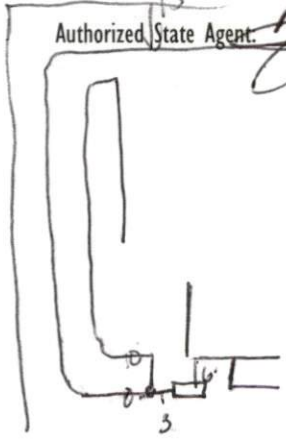

- X When RUNNING NEW DRAINLINES IF OLD LINES ARE CROSSED - SOLID PIPE THROUGH TO OTHER SIDE AND - ADD TO EXIST. PLAN
- * Fill on top of EX BH Foot Print
- * DO NOT PUT DRAINLINES in OLD MHT AREA.

POWER AND WATER ON THIS SIDE

EXISTING Well

SR 1711 Brinkley RD