

Initial Application Date: 5.23.12

Application # 12.50029001

CU# \_\_\_\_\_

**COUNTY OF HARNETT RESIDENTIAL LAND USE APPLICATION**

Central Permitting 108 E. Front Street, Lillington, NC 27546 Phone: (910) 893-7525 ext:2 Fax: (910) 893-2793 www.harnett.org/permits

**"A RECORDED SURVEY MAP, RECORDED DEED (OR OFFER TO PURCHASE) & SITE PLAN ARE REQUIRED WHEN SUBMITTING A LAND USE APPLICATION"**

LANDOWNER: Watermark, LLC Mailing Address: 3531 Chalybeate Springs Rd  
City: FURVAY VARINA State: NC Zip: 27526 Contact No: 919-649-6554 Email: williameverin@gmail.com

APPLICANT\*: Watermark, LLC Mailing Address: 3531 Chalybeate Springs Road  
City: FURVAY VARINA State: NC Zip: 27526 Contact No: 919-649-6554 Email: williameverin@gmail.com  
\*Please fill out applicant information if different than landowner

CONTACT NAME APPLYING IN OFFICE: Bill Currid Phone # 919-649-6554

PROPERTY LOCATION: Subdivision: Magnum Crest Lot #: 13 Lot Size: 59 AC  
State Road # 401 N State Road Name: 401 N Map Book & Page: 2007, 39  
Parcel: 00.0055.0007.14 PIN: 0055.53.8695  
Zoning: R20 Flood Zone: X Watershed: IV Deed Book & Page: 2027, 281 Power Company\*: \_\_\_\_\_

\*New structures with Progress Energy as service provider need to supply premise number \_\_\_\_\_ from Progress Energy.

**PROPOSED USE:**

- SFD: (Size 43 x 55.8') # Bedrooms: 3 # Baths: 2.5 Basement(w/wo bath): \_\_\_\_\_ Garage:  Deck: \_\_\_\_\_ Crawl Space:  Slab: \_\_\_\_\_ Slab: \_\_\_\_\_  
(Is the bonus room finished?  yes ( ) no w/ a closet? ( ) yes ( ) no (if yes add in with # bedrooms)
- Mod: (Size \_\_\_\_\_x\_\_\_\_\_) # Bedrooms \_\_\_\_\_ # Baths \_\_\_\_\_ Basement (w/wo bath) \_\_\_\_\_ Garage: \_\_\_\_\_ Site Built Deck: \_\_\_\_\_ On Frame \_\_\_\_\_ Off Frame \_\_\_\_\_  
(Is the second floor finished? ( ) yes ( ) no Any other site built additions? ( ) yes ( ) no
- Manufactured Home: \_\_\_\_\_SW \_\_\_\_\_DW \_\_\_\_\_TW (Size \_\_\_\_\_x\_\_\_\_\_) # Bedrooms: \_\_\_\_\_ Garage: \_\_\_\_\_(site built? \_\_\_\_\_) Deck: \_\_\_\_\_(site built? \_\_\_\_\_)
- Duplex: (Size \_\_\_\_\_x\_\_\_\_\_) No. Buildings: \_\_\_\_\_ No. Bedrooms Per Unit: \_\_\_\_\_
- Home Occupation: # Rooms: \_\_\_\_\_ Use: \_\_\_\_\_ Hours of Operation: \_\_\_\_\_ #Employees: \_\_\_\_\_
- Addition/Accessory/Other: (Size \_\_\_\_\_x\_\_\_\_\_) Use: \_\_\_\_\_ Closets in addition? ( ) yes ( ) no

Water Supply:  County \_\_\_\_\_ Existing Well \_\_\_\_\_ New Well (# of dwellings using well \_\_\_\_\_) \*Must have operable water before final

Sewage Supply:  New Septic Tank (Complete Checklist) \_\_\_\_\_ Existing Septic Tank (Complete Checklist) \_\_\_\_\_ County Sewer

Does owner of this tract of land, own land that contains a manufactured home within five hundred feet (500') of tract listed above? ( ) yes  no

Does the property contain any easements whether underground or overhead ( ) yes  no

Structures (existing or proposed): Single family dwellings: yes Manufactured Homes: \_\_\_\_\_ Other (specify): \_\_\_\_\_

**Required Residential Property Line Setbacks:**

Front	Minimum	Actual
	<u>35</u>	<u>52</u>
Rear	<u>25</u>	
Closest Side	<u>10</u>	<u>18</u>
Sidestreet/corner lot	<u>20</u>	
Nearest Building on same lot	<u>10</u>	

Comments: \_\_\_\_\_  
\_\_\_\_\_  
\_\_\_\_\_

SPECIFIC DIRECTIONS TO THE PROPERTY FROM LILLINGTON:

401 North to Rawls Club Rd. That will turn Rt just past Seater's  
Nursing home. Turn Left on Curraugh Cove into Magnolia Crest.  
Site in cul de sac

If permits are granted I agree to conform to all ordinances and laws of the State of North Carolina regulating such work and the specifications of plans submitted. I hereby state that foregoing statements are accurate and correct to the best of my knowledge. Permit subject to revocation if false information is provided.

Watermark, LLC Mark L. Curran  
Signature of Owner or Owner's Agent

5/23/12  
Date

\*\*\*It is the owner/applicants responsibility to provide the county with any applicable information about the subject property, including but not limited to: boundary information, house location, underground or overhead easements, etc. The county or its employees are not responsible for any incorrect or missing information that is contained within these applications.\*\*\*

\*\*This application expires 6 months from the initial date if permits have not been issued\*\*

# WATERMARK LLC

LOT 13, MAGNOLIA CREST, MAP # 2007 PG. 39-40

HECTOR'S CREEK TOWNSHIP HARNETT COUNTY NORTH CAROLINA

SCALE: 1" = 40'

CURVE TABLE				
CURVE	LENGTH	RADIUS	BEARING	CHORD DIST.
C-1	45.00	50.00	N00°43'40"E	43.50

MAP # 2007 PG. 39-40

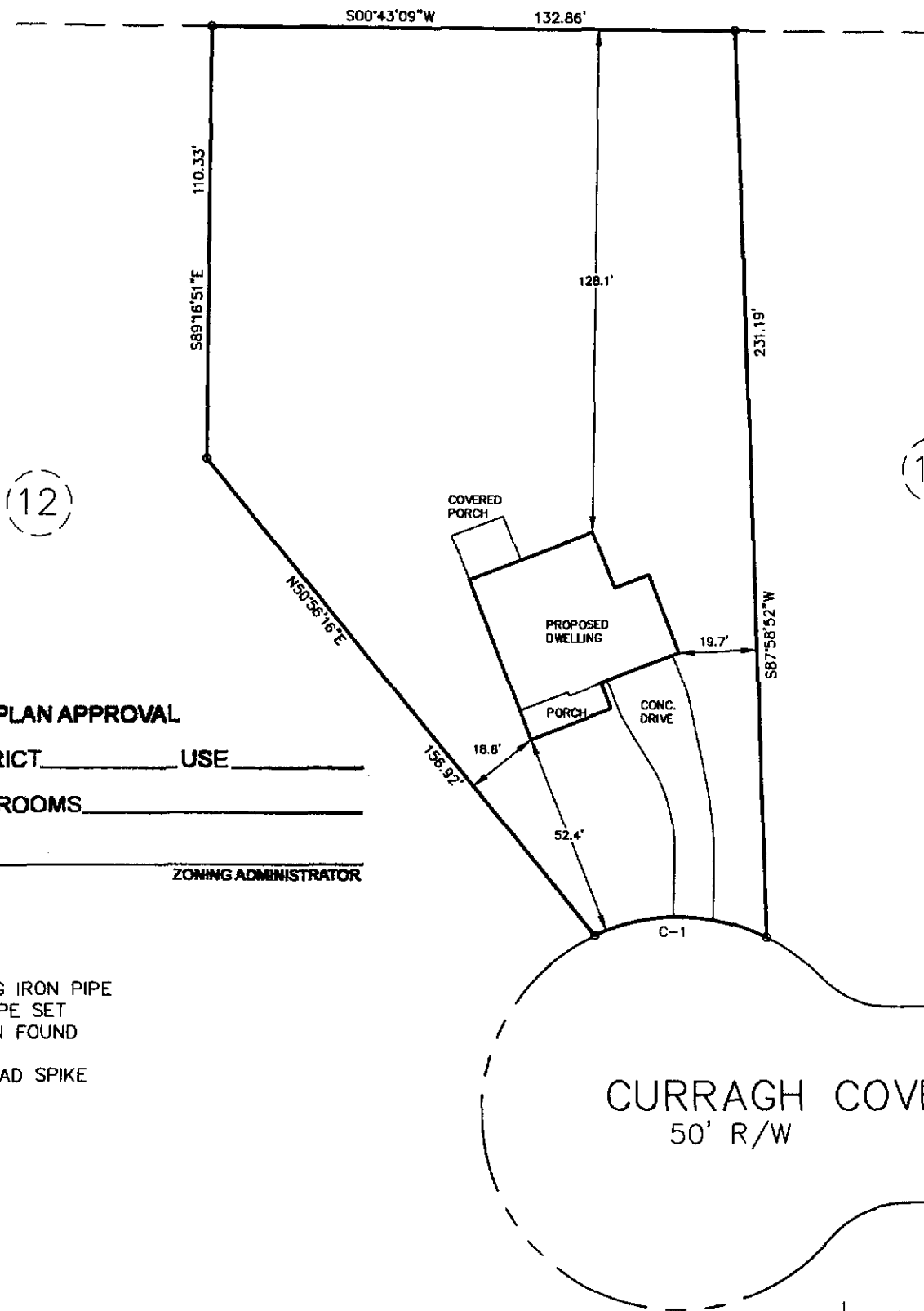

(12)

(14)

**SITE PLAN APPROVAL**

DISTRICT \_\_\_\_\_ USE \_\_\_\_\_

#BEDROOMS \_\_\_\_\_

\_\_\_\_\_  
ZONING ADMINISTRATOR

**LEGEND**

- EIP - EXISTING IRON PIPE
- IPS - IRON PIPE SET
- NIF - NO IRON FOUND
- PK - PK NAIL
- RRS - RAILROAD SPIKE

ADDRESS:  
CURRAGH COVE  
FUQUAY-VARINA, N.C. 27526

**ASHWORTH**

LAND SURVEYING

PO BOX 388, FUQUAY-VARINA, N.C. 27526 919-552-1857

05/02/2012  
05/22/2012

**PRELIMINARY PLAT**

NAME: Watermark, LLC

H8

APPLICATION #: 12-50029001

**\*This application to be filled out when applying for a septic system inspection.\***

**County Health Department Application for Improvement Permit and/or Authorization to Construct**

IF THE INFORMATION IN THIS APPLICATION IS FALSIFIED, CHANGED, OR THE SITE IS ALTERED, THEN THE IMPROVEMENT PERMIT OR AUTHORIZATION TO CONSTRUCT SHALL BECOME INVALID. The permit is valid for either 60 months or without expiration depending upon documentation submitted. (Complete site plan = 60 months; Complete plat = without expiration)

910-893-7525 option 1

CONFIRMATION # 123845

- Environmental Health New Septic System** Code 800
  - **All property irons must be made visible.** Place "pink property flags" on each corner iron of lot. All property lines must be clearly flagged approximately every 50 feet between corners.
  - Place "orange house corner flags" at each corner of the proposed structure. Also flag driveways, garages, decks, out buildings, swimming pools, etc. Place flags per site plan developed at/for Central Permitting.
  - Place orange Environmental Health card in location that is easily viewed from road to assist in locating property.
  - If property is thickly wooded, Environmental Health requires that you clean out the **undergrowth** to allow the soil evaluation to be performed. Inspectors should be able to walk freely around site. **Do not grade property.**
  - **All lots to be addressed within 10 business days after confirmation. \$25.00 return trip fee may be incurred for failure to uncover outlet lid, mark house corners and property lines, etc. once lot confirmed ready.**
  - After preparing proposed site call the voice permitting system at 910-893-7525 option 1 to schedule and use code **800** (after selecting notification permit if multiple permits exist) for Environmental Health inspection. Please note confirmation number given at end of recording for proof of request.
  - Use Click2Gov or IVR to verify results. Once approved, proceed to Central Permitting for permits.
- Environmental Health Existing Tank Inspections** Code 800
  - Follow above instructions for placing flags and card on property.
  - Prepare for inspection by removing soil over **outlet end** of tank as diagram indicates, and lift lid straight up (if possible) and then **put lid back in place.** (Unless inspection is for a septic tank in a mobile home park)
  - **DO NOT LEAVE LIDS OFF OF SEPTIC TANK**
  - After uncovering **outlet end** call the voice permitting system at 910-893-7525 option 1 & select notification permit if multiple permits, then use code **800** for Environmental Health inspection. Please note confirmation number given at end of recording for proof of request.
  - Use Click2Gov or IVR to hear results. Once approved, proceed to Central Permitting for remaining permits.

**SEPTIC**

If applying for authorization to construct please indicate desired system type(s): can be ranked in order of preference, must choose one.

- (2) Accepted      (1) Innovative      (3) Conventional      (4) Any  
 ( ) Alternative      ( ) Other \_\_\_\_\_

The applicant shall notify the local health department upon submittal of this application if any of the following apply to the property in question. If the answer is "yes", applicant **MUST ATTACH SUPPORTING DOCUMENTATION**:

- ( ) YES    () NO    Does the site contain any Jurisdictional Wetlands?
  - ( ) YES    () NO    Do you plan to have an irrigation system now or in the future?
  - () YES    ( ) NO    Does or will the building contain any drains? Please explain. foundation if permitted
  - ( ) YES    () NO    Are there any existing wells, springs, waterlines or Wastewater Systems on this property?
  - ( ) YES    () NO    Is any wastewater going to be generated on the site other than domestic sewage?
  - ( ) YES    () NO    Is the site subject to approval by any other Public Agency?
  - ( ) YES    () NO    Are there any Easements or Right of Ways on this property?
  - () YES    ( ) NO    Does the site contain any existing water, cable, phone or underground electric lines? ON street RT of way
- If yes please call No Cuts at 800-632-4949 to locate the lines. This is a free service.

**I Have Read This Application And Certify That The Information Provided Herein Is True, Complete And Correct. Authorized County And State Officials Are Granted Right Of Entry To Conduct Necessary Inspections To Determine Compliance With Applicable Laws And Rules. I Understand That I Am Solely Responsible For The Proper Identification And Labeling Of All Property Lines And Corners And Making The Site Accessible So That A Complete Site Evaluation Can Be Performed.**

Watermark, LLC      Walt S. Carr m/jm      5/23/12  
 PROPERTY OWNERS OR OWNERS LEGAL REPRESENTATIVE SIGNATURE (REQUIRED)      DATE