

HTE# 12-5-29493
EXPANSION
PERMIT # 27089

Harnett County Department of Public Health

Operation Permit

22428

New Installation Septic Tank Nitrification Line Repair Expansion

PROPERTY LOCATION: CYPRESS CHATEAU RD

Name: (owner) DR HORTON INC SUBDIVISION CYPRESS POINTE LOT # 3

System Installer: JASON MATHEWS Registration # _____

Basement with plumbing: Garage Number of Bedrooms 4

Type of Water Supply: Community Public Well Distance from well 100 feet

System Type: IIIg Types V and VI Systems expire in 5 years.

(In accordance with Table V a)

Owner must contact Health Department 6 months prior to expiration for permit renewal.

This system has been installed in compliance with applicable North Carolina General Statutes, Rules for Sewage Treatment and Disposal, and all conditions of the Improvement Permit and Construction Authorization.

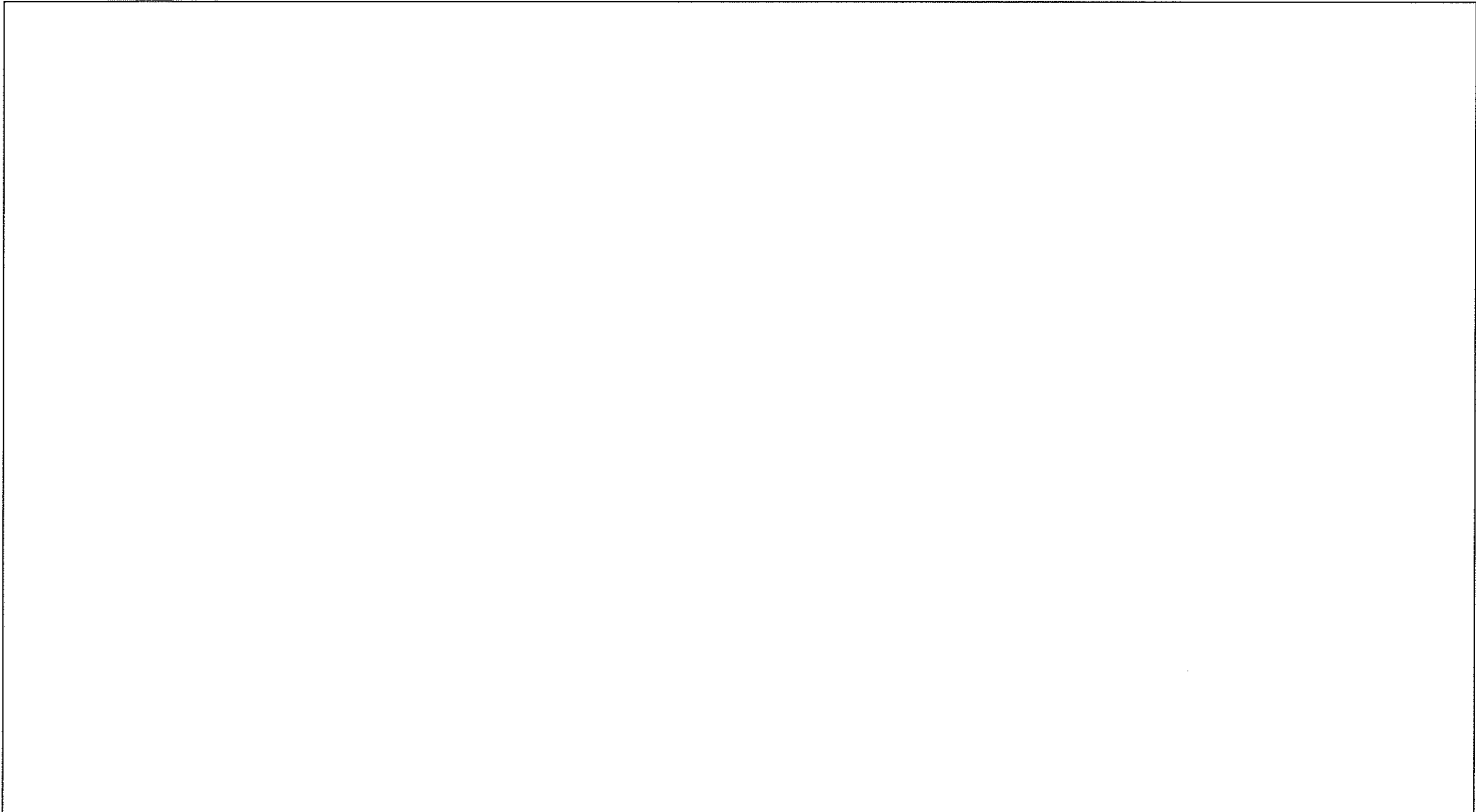

PERMIT CONDITIONS:

- I. Performance: System shall perform in accordance with Rule .1961.
- II. Monitoring: As required by Rule .1961.
- III. Maintenance: As required by Rule .1961. Other: _____
Subsurface system operator required? Yes No
If yes, see attached sheet for additional operation conditions, maintenance and reporting.

IV. Operation: _____

V. Other: SEE ORIGINAL OPERATIONS PERMIT #22403 DATED 7/9/12 FOR DRAWING. 15' ADDED TO EACH LINE PWR LINE

D-Box Pump Alarm H2O Line

Following are the specifications for the sewage disposal system on the above captioned property.

Type of system: Conventional Other EZ FLOW Septic Tank: 1000 gallons Pump Tank: _____ gallons
Subsurface No. of exact length width of depth of
Drainage Field ditches 4 of each ditch 85 feet ditches 3 feet ditches 18-24 inches
French Drain Required: _____ Linear feet **TOTAL SYSTEM SIZE**

Authorized State Agent _____

_____ PCHS

Date 8/8/12

HTE# 12-5-20793

Harnett County Department of Public Health

PERMIT # 26992

Operation Permit

22403

+ 27089 - expansion

New Installation Septic Tank Nitrification Line Repair Expansion

PROPERTY LOCATION: CYPRESS CHURCH RD

Name: (owner) DR HORTON INC

SUBDIVISION CYPRESS POINT

LOT # 3

System Installer: JASON MATTHEWS

Registration # _____

Basement with plumbing: Garage Number of Bedrooms 3

Type of Water Supply: Community Public Well Distance from well 100 feet

System Type: IIIb Types V and VI Systems expire in 5 years.

(In accordance with Table V a)

Owner must contact Health Department 6 months prior to expiration for permit renewal.

This system has been installed in compliance with applicable North Carolina General Statutes, Rules for Sewage Treatment and Disposal, and all conditions of the Improvement Permit and Construction Authorization.

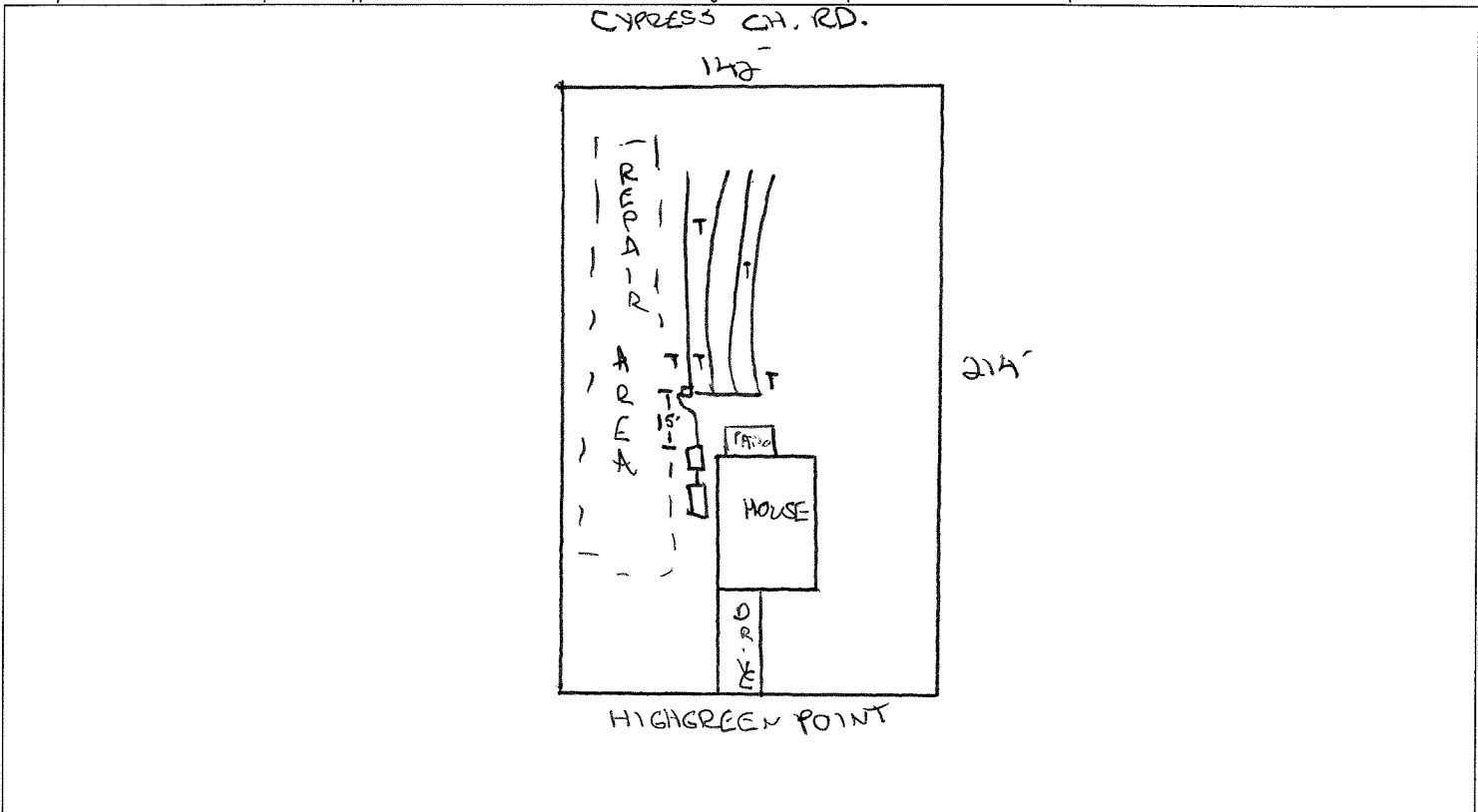

PERMIT CONDITIONS:

I. Performance: System shall perform in accordance with Rule .1961.

II. Monitoring: As required by Rule .1961.

III. Maintenance: As required by Rule .1961. Other: _____

Subsurface system operator required? Yes No

If yes, see attached sheet for additional operation conditions, maintenance and reporting.

IV. Operation: _____

V. Other: _____

D-Box Pump Alarm H2O Line PWR Line

Following are the specifications for the sewage disposal system on the above captioned property.

Type of system: Conventional Other PUMP TO EZ FLOW Septic Tank: 1000 gallons Pump Tank: 1000 gallons

Subsurface Drainage Field No. of ditches 4 exact length of each ditch 70 feet width of ditches 3 feet depth of ditches 18-24 inches

French Drain Required: _____ Linear feet

Authorized State Agent _____

REHS

Date 7/9/12