

HTE# 11-5-27814

Harnett County Department of Public Health

Improvement Permit

26778

A building permit cannot be issued with only an Improvement Permit

ISSUED TO: Wynn Construction PROPERTY LOCATION: Doc's Rd.
 NEW REPAIR EXPANSION SUBDIVISION: Trotters Ridge LOT # 90
 Type of Structure: SFD 60x60 Site Improvements required prior to Construction Authorization Issuance: _____
 Proposed Wastewater System Type: pump to 25% reduction
 Projected Daily Flow: 480 GPD
 Number of bedrooms: 4 Number of Occupants: 8 max
 Basement Yes No
 Pump Required: Yes No May be required based on final location and elevations of facilities
 Type of Water Supply: Community Public Well Distance from well _____ feet Permit valid for: Five years
 Permit conditions: _____ No expiration

Authorized State Agent: Bryan McLean, R.E.H.S. Date: 11/23/2011 SEE ATTACHED SITE SKETCH
 The issuance of this permit by the Health Department in no way guarantees the issuance of other permits. The permit holder is responsible for checking with appropriate governing bodies in meeting their requirements. This site is subject to revocation if the site plan, plat, or the intended use changes. The Improvement Permit shall not be affected by a change in ownership of the site. This permit is subject to compliance with the provisions of the Laws and Rules for Sewage Treatment and Disposal and to conditions of this permit.

Construction Authorization

(Required for Building Permit)

The construction and installation requirements of Rules .1950, .1952, .1954, .1955, .1956, .1957, .1958, and .1959 are incorporated by references into this permit and shall be met. Systems shall be installed in accordance with the attached system layout.

ISSUED TO: Wynn Construction PROPERTY LOCATION: Doc's Rd.
 SUBDIVISION: Trotters Ridge LOT # 90
 Facility Type: SFD 60x60 New Expansion Repair
 Basement? Yes No Basement Fixtures? Yes No
 Type of Wastewater System** Pump to 25% reduction system (Initial) Wastewater Flow: 480 GPD
 (See note below, if applicable Pump to 25% reduction system (Repair))

Installation Requirements/Conditions
 Septic Tank Size 1000 gallons
 Pump Tank Size 1000 gallons
 Number of trenches _____
 Exact length of each trench 200 feet
 Trenches shall be installed on contour at a Maximum Trench Depth of: 18-30 inches
 (Trench bottoms shall be level to +1-1/4" in all directions)
 Trench Spacing: 9 Feet on Center
 Soil Cover: 6 inches
 (Maximum soil cover shall not exceed 36" above the trench bottom)
 Pump Requirements: _____ ft. TDH vs. _____ GPM
 Aggregate Depth: _____ inches below pipe
 _____ inches above pipe
 _____ inches total
 Conditions: Call when lot is cleared for layout

**WATER LINES (INCLUDING IRRIGATION) MUST BE 10FT. FROM ANY PART OF SEPTIC SYSTEM OR REPAIR AREA.
NO UTILITIES ALLOWED IN INITIAL OR REPAIR DRAIN FIELD AREA.**

**If applicable: I understand the system type specified is different from the type specified on the application. I accept the specifications of this permit.

Owner/Legal Representative Signature: _____ Date: _____

This Construction Authorization is subject to revocation if the site plan, plat, or the intended use changes. The Construction Authorization shall not be transferred when there is a change in ownership of the site. This Construction Authorization is subject to compliance with the provisions of the Laws and Rules for Sewage Treatment and Disposal and to the conditions of this permit. SEE ATTACHED SITE SKETCH

Authorized State Agent: Bryan McLean, R.E.H.S. Date: 11/27/2011
 Construction Authorization Expiration Date: 11/27/2016

HTE# 11-5-27814

Permit # 26778

Harnett County Department of Public Health Site Sketch

ISSUED TO: Wynn Construction PROPERTY LOCATOR: Dair Rd.
SUBDIVISION Trotters Ridge LOT # 90

Authorized State Agent: Buyer McSwain, REHS Date: 11/23/2011

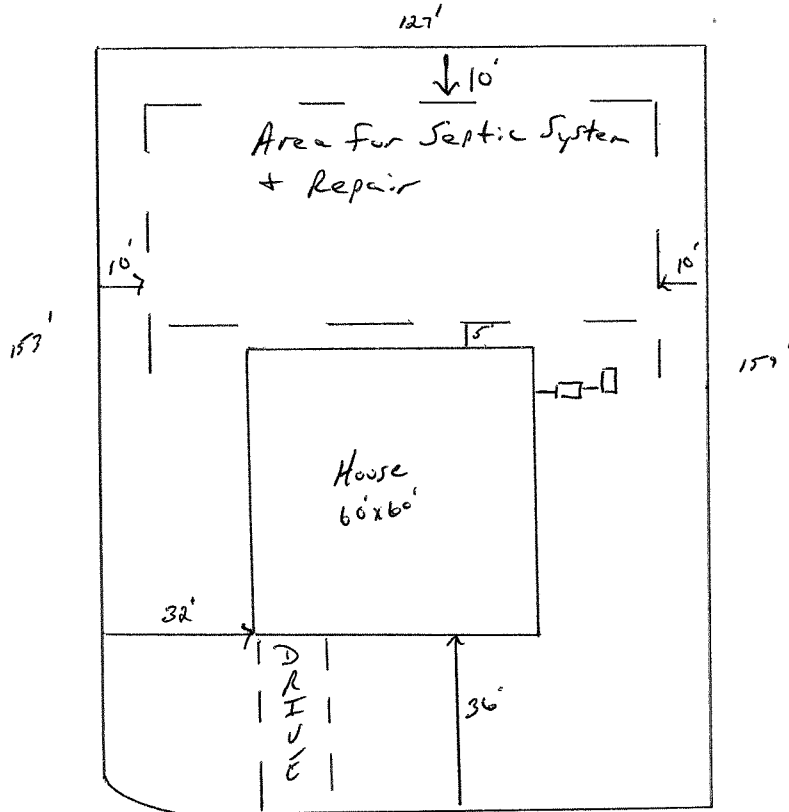

Horse Whisperer Lane