

HTE# 11-527182

Harnett County Department of Public Health Improvement Permit

26853

A building permit cannot be issued with only an Improvement Permit

ISSUED TO: CUMBERLAND HOMES INC PROPERTY LOCATION: MICRO TOWER RD
 NEW REPAIR EXPANSION SUBDIVISION TINGEN PLACE LOT # 22
 Type of Structure: SFO (55x45) Site Improvements required prior to Construction Authorization Issuance:
 Proposed Wastewater System Type: CONVENTIONAL
 Projected Daily Flow: 360 GPD
 Number of bedrooms: 3 Number of Occupants: 6 max
 Basement Yes No
 Pump Required: Yes No May be required based on final location and elevations of facilities
 Type of Water Supply: Community Public Well Distance from well 100 feet Permit valid for: Five years
 Permit conditions: _____ No expiration

Authorized State Agent: [Signature] Date: 12/8/11 **SEE ATTACHED SITE SKETCH**
 The issuance of this permit by the Health Department in no way guarantees the issuance of other permits. The permit holder is responsible for checking with appropriate governing bodies in meeting their requirements. This site is subject to revocation if the site plan, plat, or the intended use changes. The Improvement Permit shall not be affected by a change in ownership of the site. This permit is subject to compliance with the provisions of the Laws and Rules for Sewage Treatment and Disposal and to conditions of this permit.

Construction Authorization

(Required for Building Permit)

The construction and installation requirements of Rules .1950, .1952, .1954, .1955, .1956, .1957, .1958, and .1959 are incorporated by references into this permit and shall be met. Systems shall be installed in accordance with the attached system layout.

ISSUED TO: CUMBERLAND HOMES INC PROPERTY LOCATION: MICRO TOWER RD
 SUBDIVISION TINGEN PLACE LOT # 22
 Facility Type: SFO (55x45) New Expansion Repair
 Basement? Yes No Basement Fixtures? Yes No
 Type of Wastewater System** CONVENTIONAL (Initial) Wastewater Flow: 360 GPD
 (See note below, if applicable
CONVENTIONAL (Repair)

Installation Requirements/Conditions	Number of trenches <u>2</u>	Trench Spacing: <u>9</u> Feet on Center
Septic Tank Size <u>1000</u> gallons	Exact length of each trench <u>75</u> feet	Soil Cover: <u>24-6</u> inches
Pump Tank Size _____ gallons	Trenches shall be installed on contour at a Maximum Trench Depth of: <u>36-18</u> inches	(Maximum soil cover shall not exceed 36" above the trench bottom)
Pump Requirements: _____ ft. TDH vs. _____ GPM	(Trench bottoms shall be level to +/-1/4" in all directions)	Aggregate Depth: <u>6</u> inches below pipe
Conditions: _____		<u>2</u> inches above pipe
		<u>12</u> inches total

**WATER LINES (INCLUDING IRRIGATION) MUST BE 10FT. FROM ANY PART OF SEPTIC SYSTEM OR REPAIR AREA.
NO UTILITIES ALLOWED IN INITIAL OR REPAIR DRAIN FIELD AREA.**

**If applicable: I understand the system type specified is different from the type specified on the application. I accept the specifications of this permit.

Owner/Legal Representative Signature: _____ Date: _____

This Construction Authorization is subject to revocation if the site plan, plat, or the intended use changes. The Construction Authorization shall not be transferred when there is a change in ownership of the site. This Construction Authorization is subject to compliance with the provisions of the Laws and Rules for Sewage Treatment and Disposal and to the conditions of this permit. **SEE ATTACHED SITE SKETCH**

Authorized State Agent: [Signature] Date: 12/8/11
 Construction Authorization Expiration Date: 12/8/16

HTE# 11-5-27192

Permit # 26853

Harnett County Department of Public Health Site Sketch

ISSUED TO: ~~CUMBERLAND HOMES~~ PROPERTY LOCATOR: MICROTOWER RD
SUBDIVISION TINGEN PLACE LOT # 22

Authorized State Agent: ~~[Signature]~~ RGHS (OLIVER TOLKSDORF) Date: 12/8/11

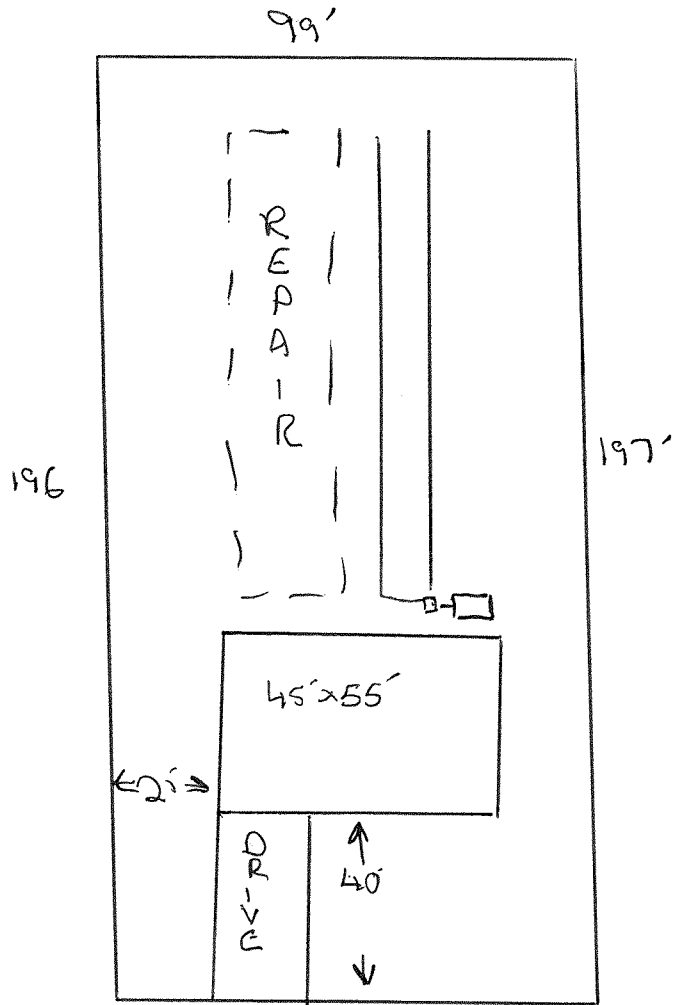

DOUGLAS ACRES