

Improvement Permit

27518

A building permit cannot be issued with only an Improvement Permit

ISSUED TO: DR HORTON INC PROPERTY LOCATION: OVERHILLS RD
 SUBDIVISION STONECROSS LOT # 113
 NEW REPAIR EXPANSION
 Type of Structure: SFD (42'6" x 38')
 Proposed Wastewater System Type: 25% REDUCTION SYSTEM
 Projected Daily Flow: 360 GPD
 Number of bedrooms: 3 Number of Occupants: 6 max
 Basement Yes No
 Pump Required: Yes No May be required based on final location and elevations of facilities
 Type of Water Supply: Community Public Well Distance from well 100 feet Permit valid for: Five years
 No expiration
 Permit conditions: HOUSE MUST USE CRAWL SPACE.
NO FILLING/CUTTING/GRADING OVER ANY PART OF SEPTIC DRAIN FIELD AREA

Authorized State Agent: [Signature] RGHS Date: 6/28/13 SEE ATTACHED SITE SKETCH

The issuance of this permit by the Health Department in no way guarantees the issuance of other permits. The permit holder is responsible for checking with appropriate governing bodies in meeting their requirements. This site is subject to revocation if the site plan, plat, or the intended use changes. The Improvement Permit shall not be affected by a change in ownership of the site. This permit is subject to compliance with the provisions of the Laws and Rules for Sewage Treatment and Disposal and to conditions of this permit.

Construction Authorization

(Required for Building Permit)

The construction and installation requirements of Rules .1950, .1952, .1954, .1955, .1956, .1957, .1958, and .1959 are incorporated by references into this permit and shall be met. Systems shall be installed in accordance with the attached system layout.

ISSUED TO: DR HORTON INC PROPERTY LOCATION: OVERHILLS RD
 SUBDIVISION STONECROSS LOT # 113
 Facility Type: SFD (43'6" x 38') New Expansion Repair
 Basement? Yes No Basement Fixtures? Yes No
 Type of Wastewater System** 25% REDUCTION SYSTEM (Initial) Wastewater Flow: 360 GPD
 (See note below, if applicable 25% REDUCTION SYSTEM (Repair))

Installation Requirements/Conditions

Septic Tank Size <u>1000</u> gallons	Number of trenches <u>3</u>	
Pump Tank Size _____ gallons	Exact length of each trench <u>75</u> feet	Trench Spacing: <u>9</u> Feet on Center
	Trenches shall be installed on contour at a	Soil Cover: <u>6</u> inches
	Maximum Trench Depth of: <u>18</u> inches	(Maximum soil cover shall not exceed
	(Trench bottoms shall be level to +/-1/4"	36" above the trench bottom)
	in all directions)	

Pump Requirements: _____ ft. TDH vs. _____ GPM _____ inches below pipe
 Aggregate Depth: _____ inches above pipe
 Conditions: SEE SITE SKETCH FOR CONDITIONS. THIS PERMIT
BASED ON A PROPOSAL FROM APPLICANTS SOIL SCIENTIST.

**WATER LINES (INCLUDING IRRIGATION) MUST BE 10FT. FROM ANY PART OF SEPTIC SYSTEM OR REPAIR AREA.
NO UTILITIES ALLOWED IN INITIAL OR REPAIR DRAIN FIELD AREA.**

**If applicable: I understand the system type specified is different from the type specified on the application. I accept the specifications of this permit.
Owner/Legal Representative Signature: _____ Date: _____

This Construction Authorization is subject to revocation if the site plan, plat, or the intended use changes. The Construction Authorization shall not be transferred when there is a change in ownership of the site. This Construction Authorization is subject to compliance with the provisions of the Laws and Rules for Sewage Treatment and Disposal and to the conditions of this permit. SEE ATTACHED SITE SKETCH

Authorized State Agent: [Signature] RGHS Date: 6/28/13
Construction Authorization Expiration Date: 6/28/18

HTE# 11-5-26932 RR

Permit # 27518

Harnett County Department of Public Health Site Sketch

ISSUED TO: DR HORTON INC PROPERTY LOCATOR: OVERHILLS RD
SUBDIVISION STONECROSS LOT # 113

Authorized State Agent: ~~REHS (OLIVER TOLKSOORS)~~ Date: 6/28/13

CONDITIONS

- * HOUSE MUST USE CRAWL SPACE.
- * NO FILLING (CUTTING) GRADING OVER DRAIN FIELD AREA
- * PATIO MAY NOT BE CONCRETE. MUST BE PAVERS.
- * FRENCH DRAIN MAY BE REQUIRED FOR 200' REPAIR AREA

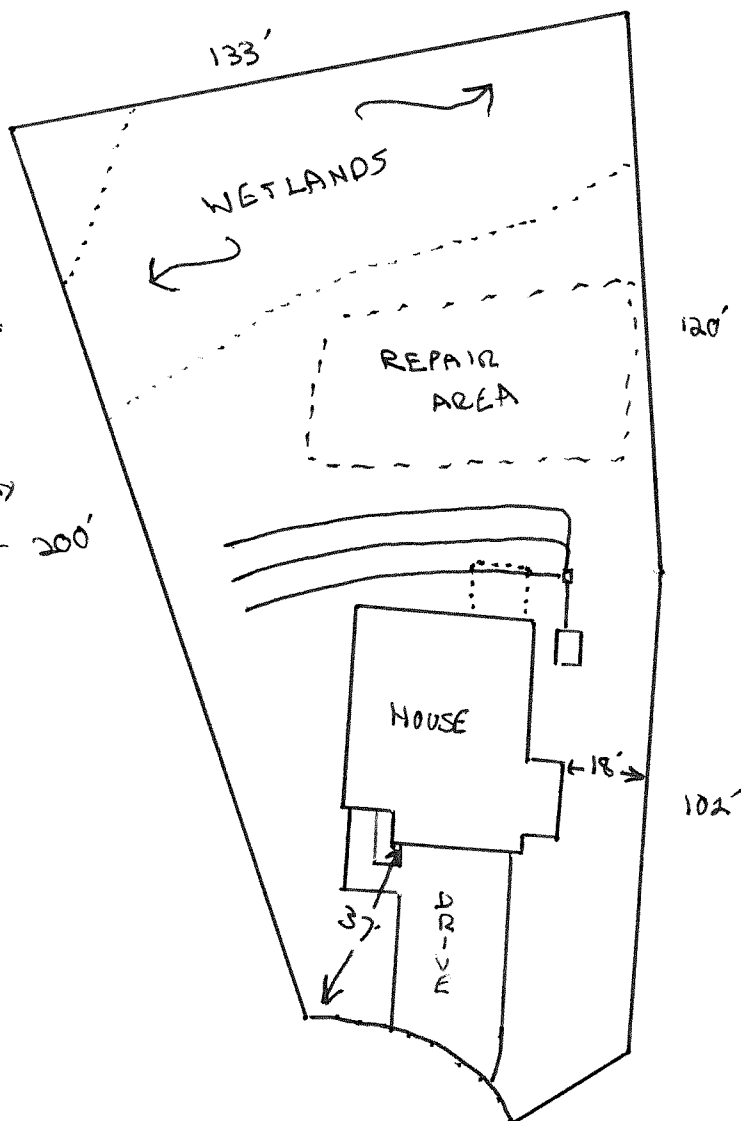

SOUTHEASTERN SOIL & ENVIRONMENTAL ASSOC., INC.

PROPOSED SUBSURFACE WASTE DISPOSAL SYSTEM DETAIL SHEET

SUBDIVISION STONE CROSS LOT 113
 INITIAL SYSTEM APPROVED 25% REDUCTION REPAIR APPROVED 25% REDUCTION
 DISTRIBUTION D-Box DISTRIBUTION TBD
 BENCHMARK 100.0 LOCATION PT ON LINE (E.P.)
 NO. BEDROOMS 3 PROPOSED LTAR 0.6 GPD/FT²

LINE FLAG COLOR ELEVATION LENGTH (FT)

Initial system

LINE	FLAG COLOR	ELEVATION	LENGTH (FT)
1	WW	100.42	75'
2	O	99.34	25'
3	B	98.03	25'
			<u>225'</u>
4	P	97.00	50'
5	B	96.00	50'
6	P	95.00	50'
7	B	93.92	50'
			<u>200' AVAILABLE</u>

BY M. EAKER DATE 06/2013

TYPICAL PROFILE
0-42 IS (VFA cap)
42" SB SL (F₁ shell)
C1 2" 4B" (initial)
INSTALL AT 13"

- * HOUSE TO USE CRAWL SPACE (NOT SLAB)
- * NOT FILLING / CUTTING / GRADING OVER ANY PART OF SEPTIC DRAINFIELD AREA