

HTE# 10-5-25720

Harnett County Department of Public Health

PERMIT # 26384

Operation Permit

22636

New Installation Septic Tank Nitrification Line Repair Expansion

PROPERTY LOCATION: Hwy 27

Name: (owner) WYNN CONSTRUCTION SUBDIVISION TINGEN POINTE LOT # 85

System Installer: THORNS PLUMBING Registration # _____

Basement with plumbing: Garage Number of Bedrooms 3

Type of Water Supply: Community Public Well Distance from well 100 feet

System Type: IIIb Types V and VI Systems expire in 5 years.

(In accordance with Table V a)

Owner must contact Health Department 6 months prior to expiration for permit renewal.

This system has been installed in compliance with applicable North Carolina General Statutes, Rules for Sewage Treatment and Disposal, and all conditions of the Improvement Permit and Construction Authorization.

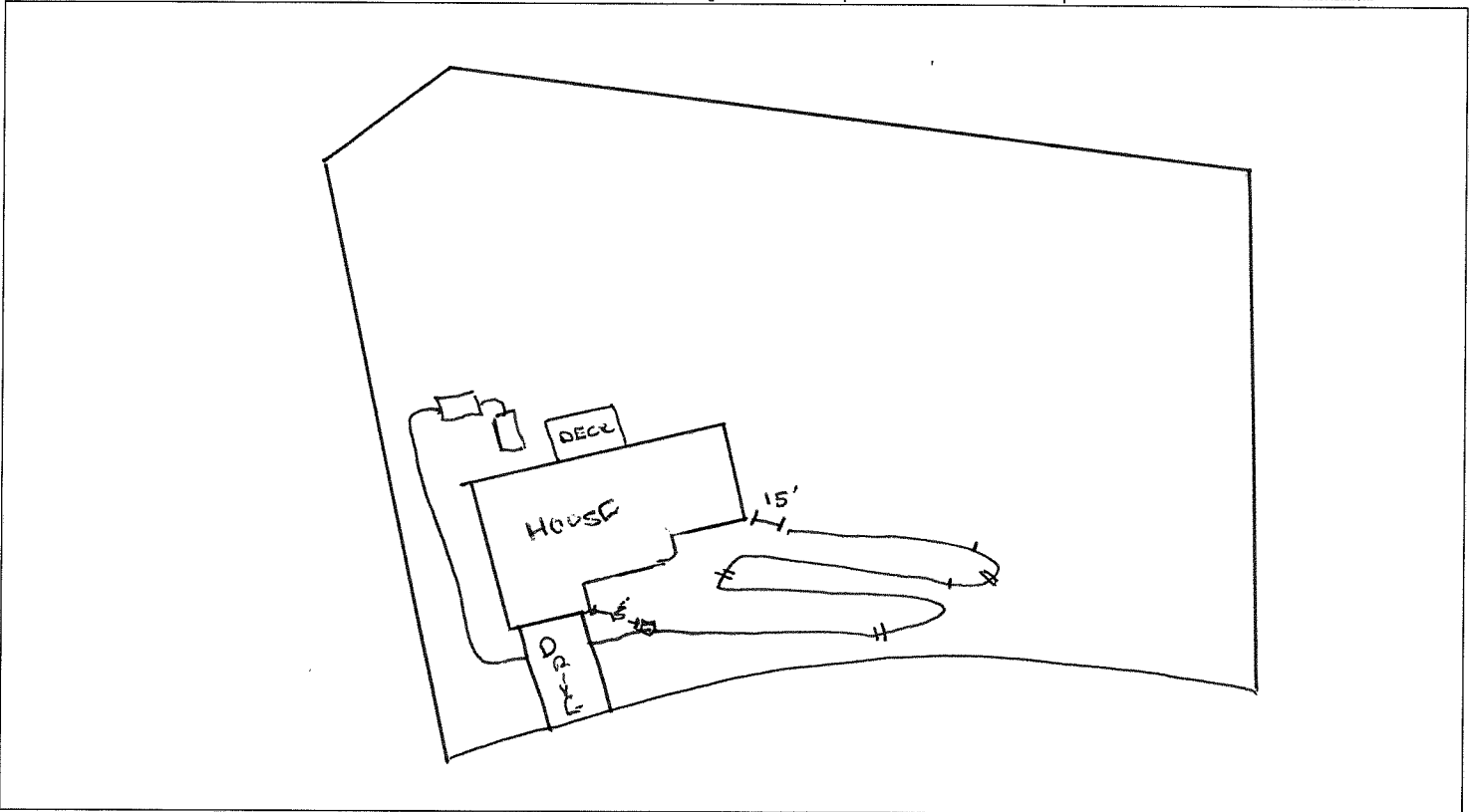

PERMIT CONDITIONS:

- I. Performance: System shall perform in accordance with Rule .1961.
- II. Monitoring: As required by Rule .1961.
- III. Maintenance: As required by Rule .1961. Other: _____
Subsurface system operator required? Yes No
If yes, see attached sheet for additional operation conditions, maintenance and reporting.

IV. Operation: _____

V. Other: _____

D-Box Pump Alarm H2O Line PWR Line

Following are the specifications for the sewage disposal system on the above captioned property.

Type of system: Conventional Other Pump To EZ Flow Septic Tank: 1000 gallons Pump Tank: 1000 gallons
 Subsurface Drainage Field: No. of ditches 3 exact length of each ditch 270 feet width of ditches 3 feet depth of ditches 18 inches
 French Drain Required: _____ Linear feet

Authorized State Agent [Signature] RGHS Date 4/2/13