

HTE# 10-5-25515

Harnett County Department of Public Health

PERMIT # 26360

Operation Permit

21923

New Installation Septic Tank Nitrification Line Repair Expansion

PROPERTY LOCATION: _____

Name: (owner) Watermark Homes SUBDIVISION CAROLINA SEASONS LOT # 74

System Installer: HAROLD CARSER Registration # _____

Basement with plumbing: Garage Number of Bedrooms 4

Type of Water Supply: Community Public Well Distance from well 100 feet

System Type: III g Types V and VI Systems expire in 5 years.

(In accordance with Table V a)

Owner must contact Health Department 6 months prior to expiration for permit renewal.

This system has been installed in compliance with applicable North Carolina General Statutes, Rules for Sewage Treatment and Disposal, and all conditions of the Improvement Permit and Construction Authorization.

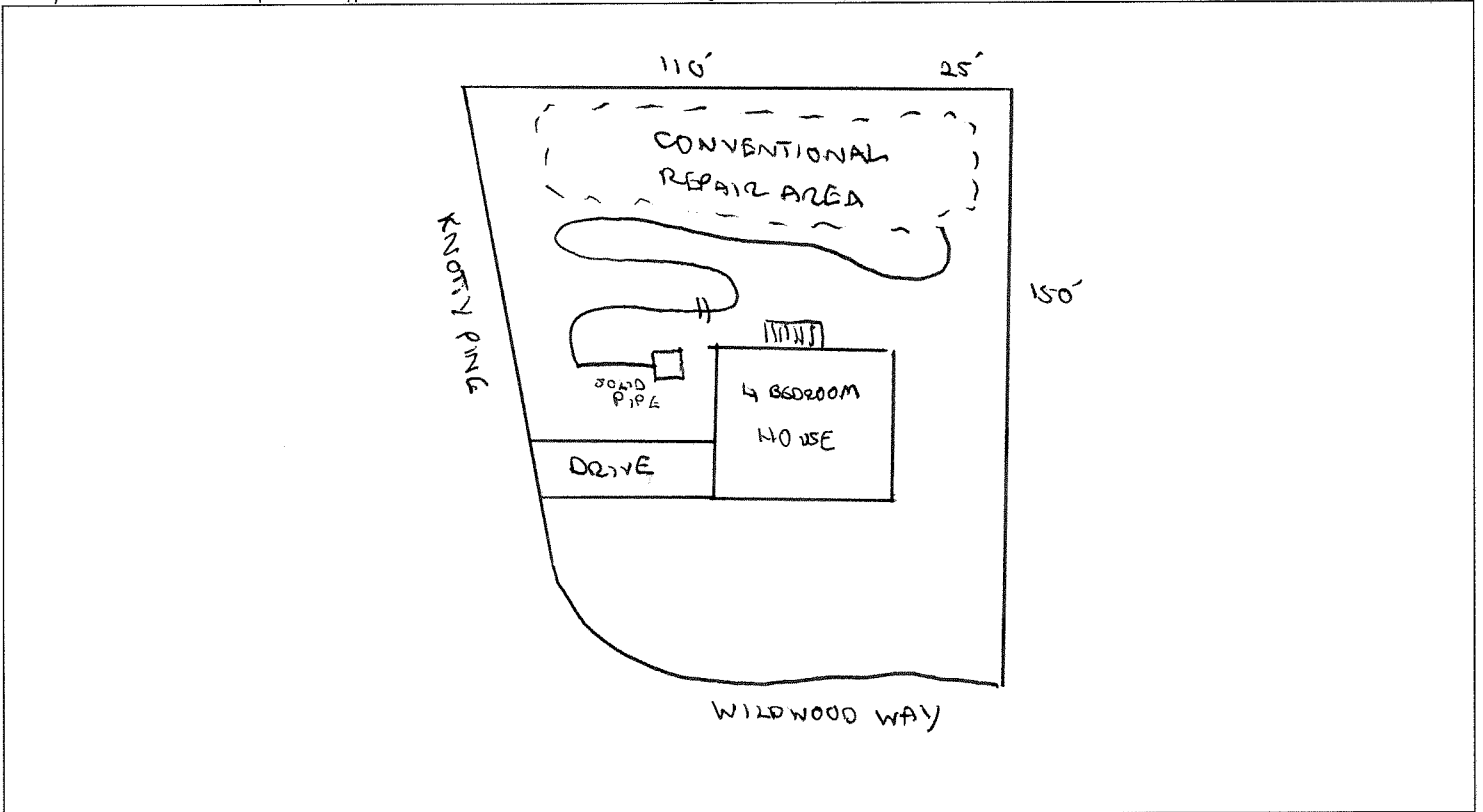

PERMIT CONDITIONS:

- I. Performance: System shall perform in accordance with Rule .1961.
- II. Monitoring: As required by Rule .1961.
- III. Maintenance: As required by Rule .1961. Other: _____
Subsurface system operator required? Yes No
If yes, see attached sheet for additional operation conditions, maintenance and reporting.

- IV. Operation: _____
- V. Other: _____

D-Box Pump Alarm H2O Line PWR Line

Following are the specifications for the sewage disposal system on the above captioned property.

Type of system: Conventional Other TIRE CAPS Septic Tank: 1000 gallons Pump Tank: _____ gallons

Subsurface Drainage Field: No. of ditches 1 exact length of each ditch 200 feet width of ditches 3 feet depth of ditches 24-18 inches

French Drain Required: _____ Linear feet

Authorized State Agent [Signature] Date 3/22/11

Central Carolina Holding, LLC
1616 McKay Town Road
Cameron, NC 28326

Ticket: 40019601
Date: 3/16/2011
Time: 07:36:48 - 08:21:57

Customer: 400102 / R's J Septic Tank

Scale
Gross: 35780 LB M OutManual Wt
Tare: 20940 LB M In Manual Wt
Net: 14820 LB

Generator: NA / Not Applicable
Dest: DEST: NA / Not Applicable
Truck: R10SEPTIC

Comment:

| Origin | Master & Services | Quantity | Unit | Rate | Amount |
|----------------------|------------------------------|----------|------|---------------|----------|
| OUT / Outbound Loads | 100% of DFM2T/2 inch DFM Ton | 7.61 | Tons | \$22.00/Ton | \$169.02 |
| | | | | Total Amount: | \$169.02 |

Weighmaster:

Libby Cameron

Driver:

PJ Cash

This load of tire chips is from the Fuel Grade location and meets the Nc specification as stated in Innovative Wastewater system approval IWWS-2002-03R for tire chip Substitution for Rock Aggregate in Nitrification Fields.