

HTE# 10-5255124

Harnett County Department of Public Health

PERMIT # 2659

Operation Permit

21924

New Installation Septic Tank Nitrification Line Repair Expansion

PROPERTY LOCATION: WILLOWOOD WAY

Name: (owner) WATERMARK HOMES SUBDIVISION CAROLINA SEASONS LOT # 73

System Installer: HAROLD CARTER Registration # _____

Basement with plumbing: Garage Number of Bedrooms 3

Type of Water Supply: Community Public Well Distance from well 100 feet

System Type: III g Types V and VI Systems expire in 5 years.

(In accordance with Table V a) Owner must contact Health Department 6 months prior to expiration for permit renewal.

This system has been installed in compliance with applicable North Carolina General Statutes, Rules for Sewage Treatment and Disposal, and all conditions of the Improvement Permit and Construction Authorization.

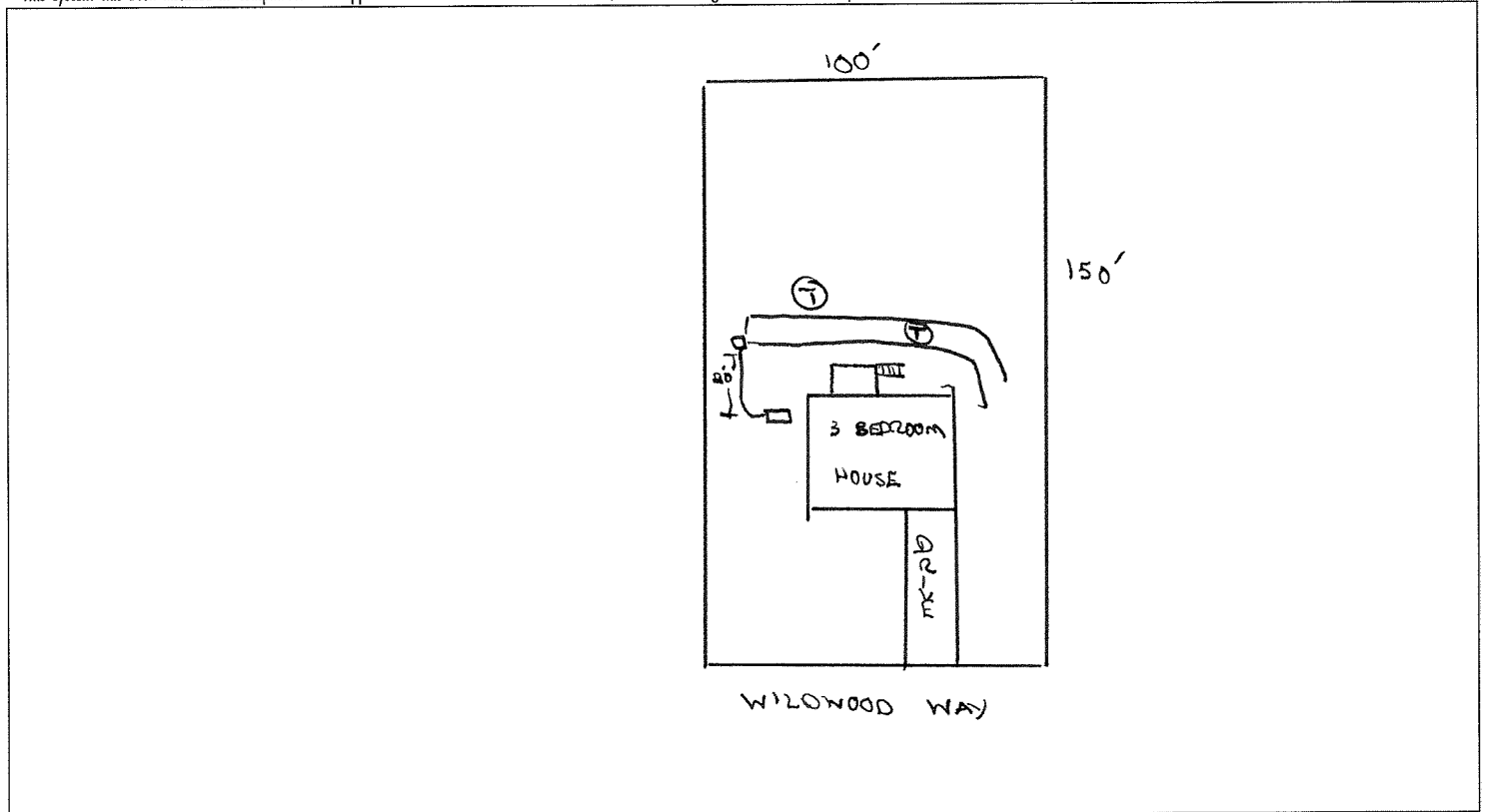

PERMIT CONDITIONS:

- I. Performance: System shall perform in accordance with Rule .1961.
- II. Monitoring: As required by Rule .1961.
- III. Maintenance: As required by Rule .1961. Other: _____
Subsurface system operator required? Yes No
If yes, see attached sheet for additional operation conditions, maintenance and reporting.
- IV. Operation: _____
- V. Other: _____

D-Box Pump Alarm H2O Line PWR Line

Following are the specifications for the sewage disposal system on the above captioned property.

Type of system: Conventional Other TIRE CHIPS Septic Tank: 1000 gallons Pump Tank: _____ gallons

Subsurface No. of exact length width of depth of
Drainage Field ditches 2 of each ditch 75 feet ditches 3 feet ditches 24-28 inches

French Drain Required: _____ Linear feet

Authorized State Agent [Signature] REAS Date 3/22/01

Central Carolina Holdings, LLC
1816 Morley Town Road
Cameron, NC 28326

Ticket: 0019606
Date: 7/16/2011
Time: 09:18:25 - 09:50:14

Customer: 400182 / R & J Septic Tank

Scale
Gross: 26280 LB M Out Manual Wt
Tare: 20920 LB M In Manual Wt
Net: 5360 LB

Generator: NA / Not Applicable
Desc: BEST NA / Not Applicable
Track: RESEPTIC

Comment:

Origin	Wastes & Services	Quantity	Unit	Rate	Amount
CYF / Outbound Loads	100% of DENZF/2 inch DEM Ton	7.69	Tons	\$22.50/Ton	\$173.98

Total Amount: \$173.98

Weightmaster: Libby Cameron

Driver:

This load of fire chips is from the Fuel Grade location and meets the NC specification as stated in innovative wastewater system approval IWS-2002-03R for the chip Substitution for Rock Aggregate in Nitrification Ponds.