

-----  
 ADDRESS . . : 118 EMMA CT  
 CONTRACTOR : GARY ROBINSON HOMES LLC  
 OWNER . . . : ABJ INVESTMENTS LLC  
 PARCEL . . . : 12-0555- - -0216- -32-  
 APPL NUMBER: 10-50025088 CP NEW RESIDENTIAL (SFD)  
 DIRECTIONS : T/S: 08/23/2010 02:07 PM RDCONTE ---  
 118 EMMA COURT / KENLAN FARMS #32  
 TAKE HWY 401S T/R ON WEST ON REAVES  
 BRIDGE ROAD. T/L INTO SUBDIVISION ON  
 KENLAN RD.  
 \*\*\*PREMISE # WAITING ON CUS\*\*\*

SUBDIV: KENLAN FARMS PH1 SET1 41LOTS  
 PHONE : (910) 977-2562  
 PHONE :

-----  
**STRUCTURE: 000 000**  
 FLOOD ZONE . . . . : FLOOD ZONE X  
 # BEDROOMS . . . . . : 3.00  
 SEPTIC - EXISTING? . . . . : NEW TANK  
 PROPOSED USE . . . . . : SFD  
 WATER SUPPLY . . . . . : COUNTY

-----  
**PERMIT: CPSF 00 CP \* SFD**

TYP/SQ	REQUESTED COMPLETED	INSP RESULT	DESCRIPTION RESULTS/COMMENTS
B101 01	9/20/10	JH	R*BLDG FOOTING / TEMP SVC POLE VRU #: 001984236
	9/20/10	AP	t-pole passed
B103 01	9/22/10	KS	R*BLDG FOUND & TEMP SVC POLE VRU #: 001985191
	9/22/10	DP	Foundation not complete \$50 re-inspection fee
			T/S: 09/22/2010 08:39 AM KSLATTUM -----
B103 02	9/23/10	JH	R*BLDG FOUND & TEMP SVC POLE TIME: 17:00 VRU #: 001986116
	9/23/10	DA	T/S: 09/22/2010 04:15 PM NTART ----- Need engineer letter for repair on footing on right side of house where block were put in as a footing, area circled on plans.
B103 03	10/04/10	JH	R*BLDG FOUND & TEMP SVC POLE VRU #: 001989227
	10/04/10	AP	-----
B111 01	10/08/10	TI	R*BLDG SLAB INSP VRU #: 001991538
	10/07/10	CA	Plumbing Slab T/S: 10/07/2010 02:50 PM NTART -----
P309 01	10/08/10	JH	R*PLUMB UNDER SLAB TIME: 17:00 VRU #: 001991702
	10/08/10	AP	T/S: 10/07/2010 02:52 PM NTART -----
B111 02	10/11/10	TI	R*BLDG SLAB INSP VRU #: 001992064
	<i>10-11-10</i>	<i>AP JH</i>	

-----  
 COMMENTS AND NOTES -----

-----

ADDRESS . . : 118 EMMA CT  
 CONTRACTOR : GARY ROBINSON HOMES LLC  
 OWNER . . . : ABJ INVESTMENTS LLC  
 PARCEL . . . : 12-0555- - -0216- -32-  
 APPL NUMBER: 10-50025088 CP NEW RESIDENTIAL (SFD)  
 DIRECTIONS : T/S: 08/23/2010 02:07 PM RDCONTE ---  
 118 EMMA COURT / KENLAN FARMS #32  
 TAKE HWY 401S T/R ON WEST ON REAVES  
 BRIDGE ROAD. T/L INTO SUBDIVISION ON  
 KENLAN RD.  
 \*\*\*PREMISE # WAITING ON CUS\*\*\*

-----

**STRUCTURE: 000 000**

FLOOD ZONE . . . . : FLOOD ZONE X  
 # BEDROOMS . . . . : 3.00  
 SEPTIC - EXISTING? . . . . : NEW TANK

PROPOSED USE . . . . . : SFD  
 WATER SUPPLY . . . . . : COUNTY

-----

**PERMIT: CPSF 00 CP \* SFD**

TYP/SQ	REQUESTED COMPLETED	INSP RESULT	DESCRIPTION RESULTS/COMMENTS
B101 01	9/20/10 <i>9-20-10 AP JH</i>	TI	R*BLDG FOOTING / TEMP SVC POLE <i>T-pole passed</i>

VRU #: 001984236

-----

COMMENTS AND NOTES

ADDRESS . . : 118 EMMA CT  
CONTRACTOR : GARY ROBINSON HOMES LLC  
OWNER . . . : ABJ INVESTMENTS LLC  
PARCEL . . . : 12-0555- - -0216- -32-  
APPL NUMBER: 10-50025088 CP NEW RESIDENTIAL (SFD)  
DIRECTIONS : T/S: 08/23/2010 02:07 PM RDCONTE ---  
118 EMMA COURT / KENLAN FARMS #32  
TAKE HWY 401S T/R ON WEST ON REAVES  
BRIDGE ROAD. T/L INTO SUBDIVISION ON  
KENLAN RD.  
\*\*\*PREMISE # WAITING ON CUS\*\*\*

SUBDIV: KENLAN FARMS PH1 SET1 41LOTS  
PHONE : (910) 977-2562  
PHONE :

STRUCTURE: 000 000

FLOOD ZONE . . . . : FLOOD ZONE X  
# BEDROOMS . . . . : 3.00  
SEPTIC - EXISTING? . . . . : NEW TANK  
PROPOSED USE . . . . . : SFD  
WATER SUPPLY . . . . . : COUNTY

PERMIT: CPSF 00 CP \* SFD

TYP/SQ	REQUESTED COMPLETED	INSP RESULT	DESCRIPTION RESULTS/COMMENTS
B101 01	9/20/10	JH	R*BLDG FOOTING / TEMP SVC POLE VRU #: 001984236
	9/20/10	AP	t-pole passed
B103 01	9/22/10	TI	R*BLDG FOUND & TEMP SVC POLE VRU #: 001985191

*9-22 DP KS*

COMMENTS AND NOTES

-----  
ADDRESS . . : 118 EMMA CT SUBDIV: KENLAN FARMS PH1 SET1 41LOTS  
CONTRACTOR : GARY ROBINSON HOMES LLC PHONE : (910) 977-2562  
OWNER . . : ABJ INVESTMENTS LLC PHONE :  
PARCEL . . : 12-0555- - -0216- -32-  
APPL NUMBER: 10-50025088 CP NEW RESIDENTIAL (SFD)  
-----

DIRECTIONS : T/S: 08/23/2010 02:07 PM RDCONTE ---  
118 EMMA COURT / KENLAN FARMS #32  
TAKE HWY 401S T/R ON WEST ON REAVES  
BRIDGE ROAD. T/L INTO SUBDIVISION ON  
KENLAN RD.  
\*\*\*PREMISE # WAITING ON CUS\*\*\*  
-----

**STRUCTURE: 000 000**

FLOOD ZONE . . . . : FLOOD ZONE X  
# BEDROOMS . . . . : 3.00 PROPOSED USE . . . . . : SFD  
SEPTIC - EXISTING? . . . . : NEW TANK WATER SUPPLY . . . . . : COUNTY  
-----

**PERMIT: CPSF 00 CP \* SFD**

TYP/SQ	REQUESTED COMPLETED	INSP RESULT	DESCRIPTION RESULTS/COMMENTS
B101 01	9/20/10	JH	R*BLDG FOOTING / TEMP SVC POLE VRU #: 001984236
	9/20/10	AP	t-pole passed -----
B103 01	9/22/10	KS	R*BLDG FOUND & TEMP SVC POLE VRU #: 001985191
	9/22/10	DP	Foundation not complete \$50 re-inspection fee
			T/S: 09/22/2010 08:39 AM KSLATTUM -----
B103 02	9/23/10	TI	R*BLDG FOUND & TEMP SVC POLE TIME: 17:00 VRU #: 001986116
	<i>9-23-10</i>	<i>DA JK</i>	T/S: 09/22/2010 04:15 PM NTART -----

----- COMMENTS AND NOTES -----  
-----

ADDRESS . . : 118 EMMA CT  
CONTRACTOR : GARY ROBINSON HOMES LLC  
OWNER . . . : ABJ INVESTMENTS LLC  
PARCEL . . . : 12-0555- - -0216- -32-  
APPL NUMBER: 10-50025088 CP NEW RESIDENTIAL (SFD)  
DIRECTIONS : T/S: 08/23/2010 02:07 PM RDCONTE ---  
118 EMMA COURT / KENLAN FARMS #32  
TAKE HWY 401S T/R ON WEST ON REAVES  
BRIDGE ROAD. T/L INTO SUBDIVISION ON  
KENLAN RD.  
\*\*\*PREMISE # WAITING ON CUS\*\*\*

SUBDIV: KENLAN FARMS PH1 SET1 41LOTS  
PHONE : (910) 977-2562  
PHONE :

STRUCTURE: 000 000

FLOOD ZONE . . . . : FLOOD ZONE X  
# BEDROOMS . . . . : 3.00  
SEPTIC - EXISTING? . . . . : NEW TANK  
PROPOSED USE . . . . . : SFD  
WATER SUPPLY . . . . . : COUNTY

PERMIT: CPSF 00 CP \* SFD

TYP/SQ	REQUESTED COMPLETED	INSP RESULT	DESCRIPTION RESULTS/COMMENTS
B101 01	9/20/10	JH	R*BLDG FOOTING / TEMP SVC POLE VRU #: 001984236
	9/20/10	AP	t-pole passed
B103 01	9/22/10	KS	R*BLDG FOUND & TEMP SVC POLE VRU #: 001985191
	9/22/10	DP	Foundation not complete \$50 re-inspection fee T/S: 09/22/2010 08:39 AM KSLATTUM
B103 02	9/23/10	JH	R*BLDG FOUND & TEMP SVC POLE TIME: 17:00 VRU #: 001986116
	9/23/10	DA	T/S: 09/22/2010 04:15 PM NTART Need engineer letter for repair on footing on right side of house where block were put in as a footing, area circled on plans.
B103 03	10/04/10	TI	R*BLDG FOUND & TEMP SVC POLE VRU #: 001989227

10-4-10 APJH

COMMENTS AND NOTES

FOUNDATION REPAIR  
DETAILS

LEFT SIDE WALL

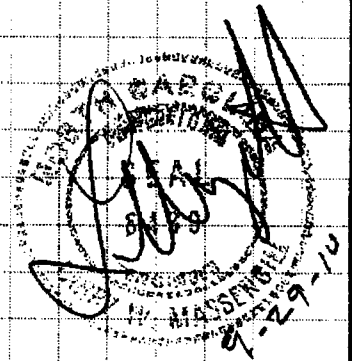
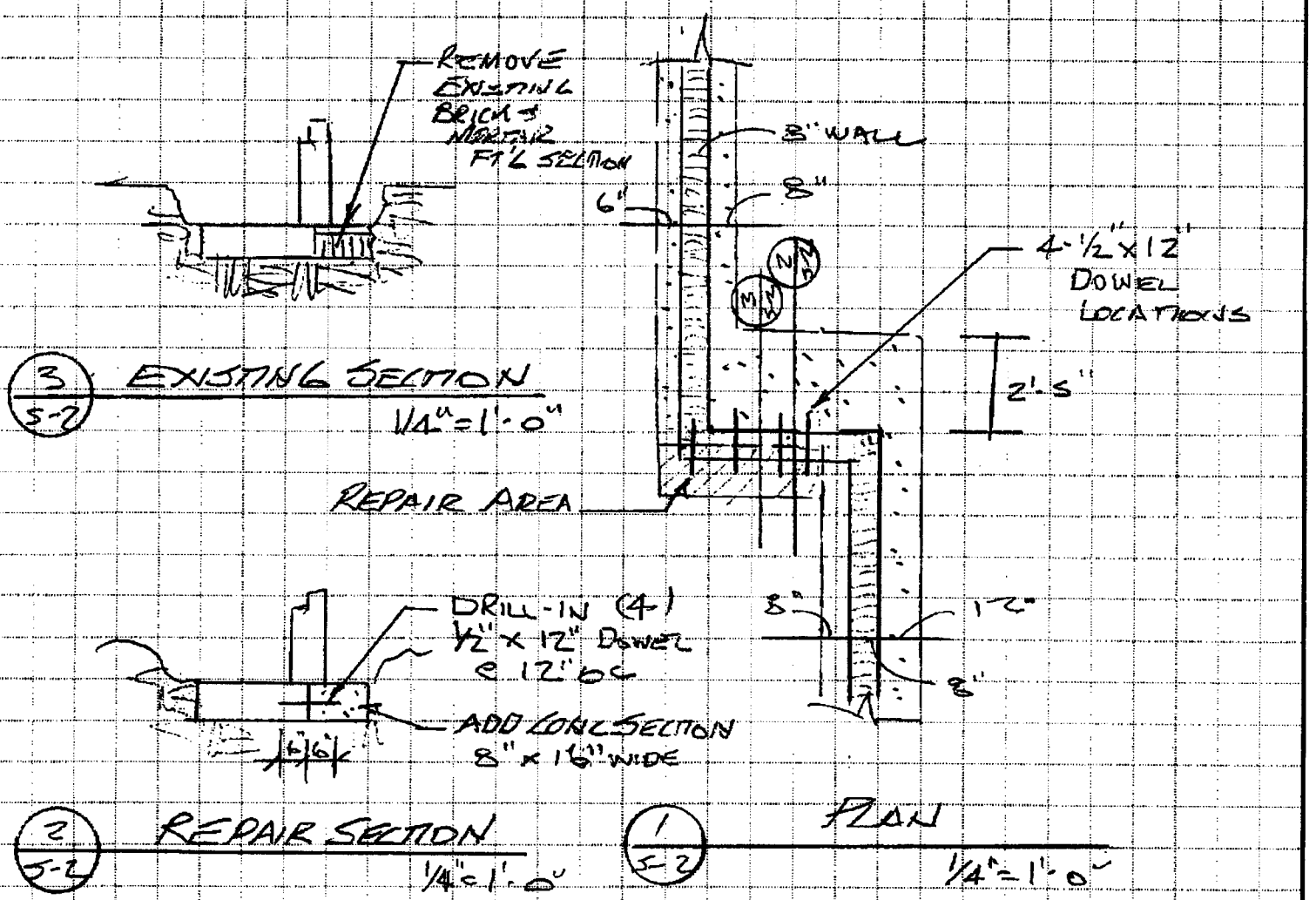

SHEET 1 OF 2

MASSENGILL ASSOCIATES, P.A.  
P.O. BOX 695  
116 EAST MAIN STREET  
BENSON, NORTH CAROLINA 27504  
PHONE: 919-894-2071  
FAX: 010-892-7288

DATE: 9 - 29 - 10

LOCATION: 118 EMMA CT.  
HARNETT CO.  
LOT 32  
KENLAN FARM'S SID

ENGINEER'S REPORT

SUBJECT: RESIDENCE FOUNDATION REPAIR

ON SEPT. 9 2010, I VISITED THE JOE SITE  
TO EXAMINE A SECTION OF CONC WALL  
FOOTING. PLEASE REFER TO SHEET 2  
FOR SIZE & LOCATION.

SUMMARY: REMOVE EXISTING BRICK/  
MORTAR FOOTING SECTION,  
DRILL IN 1/2" x 12" STEEL DOWELS  
AS SHOWN IN 2/S-2 DETAIL  
POUR CONC FOOTING 3" THICK x 16" WIDE  
BY 4'-0" LONG.

PLEASE CALL IF YOU HAVE ANY  
QUESTION.

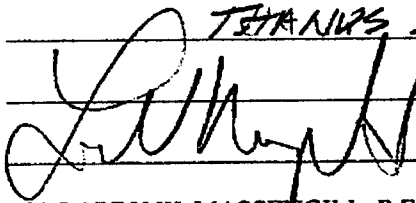
THANKS.  

BY: LARRY W. MASSENGILL, P.E.

9-29-10

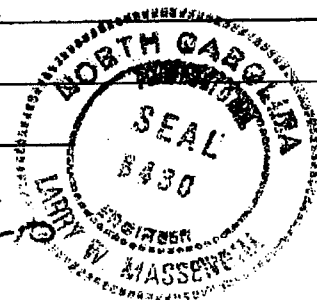

**MASSENGILL ASSOCIATES, P.A.**

CONSULTING ENGINEERING  
DESIGN AND PROJECT MANAGEMENT

114 E. MAIN ST., P.O. BOX 695 • BENSON, N.C. 27504-0695 • (919) 894-2071

TO: GARY ROBINSON FAX 866 876 4575

LOCATION: ATT. BILLY ELMORE DATE 9-29-10 TIME 5:00

FROM: LARRY W. MASSENGILL, FAX: 919.894.7288

TOTAL NUMBER OF PAGES INCLUDING COVER LETTER: 3

IF YOU DO NOT RECEIVE ALL PAGES OR HAVE ANY PROBLEM, PLEASE CALL  
919-894-2071

\*\*\*\*\*

MESSAGE: LOT 32 FOUNDATION REPAIR

\_\_\_\_\_  
\_\_\_\_\_  
\_\_\_\_\_  
\_\_\_\_\_

THANKS,

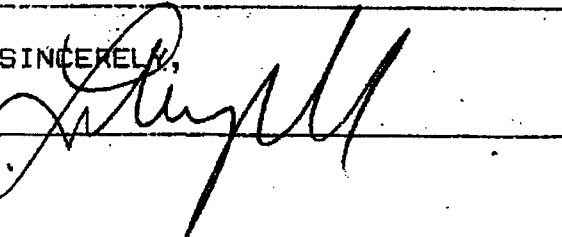
SINCERELY,  

\*\*\*\*\*

NOTICE: IF YOU HAVE RECEIVED THIS DOCUMENT IN ERROR, PLEASE NOTIFY US  
BY PHONE AT 919-894-2071. THE INFORMATION CONTAINED IN THE FACSIMILE  
TRANSMISSION IS SUBJECT TO BE PROPRIETARY AND CONFIDENTIAL IN NATURE,  
INTENDED ONLY FOR THE USE OF THE ABOVE NAMED RECIPIENT, ANY  
DISSEMINATION, DISTRIBUTION OR COPY OF THIS INFORMATION IS  
PROHIBITED. WE APPRECIATE YOU ASSISTANCE.



-----

ADDRESS . . : 118 EMMA CT SUBDIV: KENLAN FARMS PH1 SET1 41LOTS  
 CONTRACTOR : GARY ROBINSON HOMES LLC PHONE : (910) 977-2562  
 OWNER . . : ABJ INVESTMENTS LLC PHONE :  
 PARCEL . . : 12-0555- - -0216- -32-  
 APPL NUMBER: 10-50025088 CP NEW RESIDENTIAL (SFD)

-----

DIRECTIONS : T/S: 08/23/2010 02:07 PM RDCONTE ---  
 118 EMMA COURT / KENLAN FARMS #32  
 TAKE HWY 401S T/R ON WEST ON REAVES  
 BRIDGE ROAD. T/L INTO SUBDIVISION ON  
 KENLAN RD.  
 \*\*\*PREMISE # WAITING ON CUS\*\*\*

-----

**STRUCTURE: 000 000**  
 FLOOD ZONE . . . . : FLOOD ZONE X  
 # BEDROOMS . . . . . : 3.00 PROPOSED USE . . . . . : SFD  
 SEPTIC - EXISTING? . . . . : NEW TANK WATER SUPPLY . . . . . : COUNTY

-----

**PERMIT: CPSF 00 CP \* SFD**

TYP/SQ	REQUESTED COMPLETED	INSP RESULT	DESCRIPTION RESULTS/COMMENTS
B101 01	9/20/10	JH	R*BLDG FOOTING / TEMP SVC POLE VRU #: 001984236
	9/20/10	AP	t-pole passed
B103 01	9/22/10	KS	R*BLDG FOUND & TEMP SVC POLE VRU #: 001985191
	9/22/10	DP	Foundation not complete \$50 re-inspection fee T/S: 09/22/2010 08:39 AM KSLATTUM
B103 02	9/23/10	JH	R*BLDG FOUND & TEMP SVC POLE TIME: 17:00 VRU #: 001986116
	9/23/10	DA	T/S: 09/22/2010 04:15 PM NTART Need engineer letter for repair on footing on right side of house where block were put in as a footing, area circled on plans.
B103 03	10/04/10	JH	R*BLDG FOUND & TEMP SVC POLE VRU #: 001989227
	10/04/10	AP	
B111 01	10/08/10	TI	R*BLDG SLAB INSP VRU #: 001991538
	10/07/10	CA	Plumbing Slab T/S: 10/07/2010 02:50 PM NTART
P309 01	10/08/10	TI	R*PLUMB UNDER SLAB TIME: 17:00 VRU #: 001991702
			T/S: 10/07/2010 02:52 PM NTART

*10-8-10 AP JV*

----- COMMENTS AND NOTES -----

ADDRESS . : 118 EMMA CT  
 CONTRACTOR : GARY ROBINSON HOMES LLC  
 OWNER . . : ABJ INVESTMENTS LLC  
 PARCEL . . : 12-0555- - -0216- -32-  
 APPL NUMBER: 10-50025088 CP NEW RESIDENTIAL (SFD)  
 DIRECTIONS : T/S: 08/23/2010 02:07 PM RDCONTE ---  
 118 EMMA COURT / KENLAN FARMS #32  
 TAKE HWY 401S T/R ON WEST ON REAVES  
 BRIDGE ROAD. T/L INTO SUBDIVISION ON  
 KENLAN RD.  
 \*\*\*PREMISE # WAITING ON CUS\*\*\*

**STRUCTURE: 000 000**

FLOOD ZONE . . . . : FLOOD ZONE X  
 # BEDROOMS . . . . : 3.00  
 SEPTIC - EXISTING? . . . . : NEW TANK

PROPOSED USE . . . . . : SFD  
 WATER SUPPLY . . . . . : COUNTY

**PERMIT: CPSF 00 CP \* SFD**

TYP/SQ	REQUESTED COMPLETED	INSP RESULT	DESCRIPTION RESULTS/COMMENTS
B101 01	9/20/10	JH	R*BLDG FOOTING / TEMP SVC POLE VRU #: 001984236
	9/20/10	AP	t-pole passed
B103 01	9/22/10	KS	R*BLDG FOUND & TEMP SVC POLE VRU #: 001985191
	9/22/10	DP	Foundation not complete \$50 re-inspection fee
			T/S: 09/22/2010 08:39 AM KSLATTUM -----
B103 02	9/23/10	JH	R*BLDG FOUND & TEMP SVC POLE TIME: 17:00 VRU #: 001986116
	9/23/10	DA	T/S: 09/22/2010 04:15 PM NTART ----- Need engineer letter for repair on footing on right side of house where block were put in as a footing, area circled on plans.
B103 03	10/04/10	JH	R*BLDG FOUND & TEMP SVC POLE VRU #: 001989227
	10/04/10	AP	-----
B111 01	10/08/10	TI	R*BLDG SLAB INSP VRU #: 001991538
	10/07/10	CA	Plumbing Slab
			T/S: 10/07/2010 02:50 PM NTART -----
P309 01	10/08/10	JH	R*PLUMB UNDER SLAB TIME: 17:00 VRU #: 001991702
	10/08/10	AP	T/S: 10/07/2010 02:52 PM NTART -----
B111 02	10/11/10	JH	R*BLDG SLAB INSP VRU #: 001992064
	10/11/10	AP	-----
A814 01	10/26/10	TI	ADDRESS CONFIRMATION TIME: 17:00 VRU #: 001998509
			T/S: 10/25/2010 12:46 PM VBROWN -----
R425 01	10/26/10	TI	FOUR TRADE ROUGH IN TIME: 17:00 VRU #: 001998525
	<u>10-26-10</u>	<u>DA JB</u>	T/S: 10/25/2010 12:46 PM VBROWN -----

COMMENTS AND NOTES

-----  
ADDRESS . . : 118 EMMA CT  
CONTRACTOR : GARY ROBINSON HOMES LLC  
OWNER . . . : ABJ INVESTMENTS LLC  
PARCEL . . . : 12-0555- - -0216- -32-  
APPL NUMBER: 10-50025088 CP NEW RESIDENTIAL (SFD)  
DIRECTIONS : T/S: 08/23/2010 02:07 PM RDCONTE ---  
118 EMMA COURT / KENLAN FARMS #32  
TAKE HWY 401S T/R ON WEST ON REAVES  
BRIDGE ROAD. T/L INTO SUBDIVISION ON  
KENLAN RD.  
\*\*\*PREMISE # WAITING ON CUS\*\*\*  
-----

-----  
**STRUCTURE: 000 000**  
FLOOD ZONE . . . . : FLOOD ZONE X  
# BEDROOMS . . . . . : 3.00  
SEPTIC - EXISTING? . . . . : NEW TANK  
PROPOSED USE . . . . . : SFD  
WATER SUPPLY . . . . . : COUNTY  
-----

**PERMIT: CPSF 00 CP \* SFD**

TYP/SQ	REQUESTED COMPLETED	INSP RESULT	DESCRIPTION RESULTS/COMMENTS
B101 01	9/20/10	JH	R*BLDG FOOTING / TEMP SVC POLE VRU #: 001984236
	9/20/10	AP	t-pole passed
B103 01	9/22/10	KS	R*BLDG FOUND & TEMP SVC POLE VRU #: 001985191
	9/22/10	DP	Foundation not complete \$50 re-inspection fee T/S: 09/22/2010 08:39 AM KSLATTUM -----
B103 02	9/23/10	JH	R*BLDG FOUND & TEMP SVC POLE TIME: 17:00 VRU #: 001986116
	9/23/10	DA	T/S: 09/22/2010 04:15 PM NTART ----- Need engineer letter for repair on footing on right side of house where block were put in as a footing, area circled on plans.
B103 03	10/04/10	JH	R*BLDG FOUND & TEMP SVC POLE VRU #: 001989227
	10/04/10	AP	-----
B111 01	10/08/10	TI	R*BLDG SLAB INSP VRU #: 001991538
	10/07/10	CA	Plumbing Slab T/S: 10/07/2010 02:50 PM NTART -----
P309 01	10/08/10	JH	R*PLUMB UNDER SLAB TIME: 17:00 VRU #: 001991702
	10/08/10	AP	T/S: 10/07/2010 02:52 PM NTART -----
B111 02	10/11/10	JH	R*BLDG SLAB INSP VRU #: 001992064
	10/11/10	AP	-----
A814 01	10/26/10	TI	ADDRESS CONFIRMATION TIME: 17:00 VRU #: 001998509 T/S: 10/25/2010 12:46 PM VBROWN -----
R425 01	10/26/10	JH	FOUR TRADE ROUGH IN TIME: 17:00 VRU #: 001998525
	10/26/10	DA	T/S: 10/25/2010 12:46 PM VBROWN ----- X Missing shingles on house they are not completed. X Fire place needs to be installed @ roughin. X Missing windows @ master bath tub these need to be installed @ roughin. 4 3' head of water on drain lines. X 100 psi on water lines. X Need uplift straps on roof truss C1 both ends, D1B joint 16, D1C joint 15, D1D & D1E joints 6 & 9.
R425 02	10/29/10	TI	FOUR TRADE ROUGH IN VRU #: 001999770

10-29-10 *DA JH*

----- COMMENTS AND NOTES -----

ADDRESS : 118 EMMA CT SUBDIV: KENLAN FARMS PH1 SET1 41LOTS  
 CONTRACTOR : GARY ROBINSON HOMES LLC PHONE : (910) 977-2562  
 OWNER : ABJ INVESTMENTS LLC PHONE :  
 PARCEL : 12-0555- - -0216- -32-  
 APPL NUMBER: 10-50025088 CP NEW RESIDENTIAL (SFD)

DIRECTIONS : T/S: 08/23/2010 02:07 PM RDCONTE ---  
 118 EMMA COURT / KENLAN FARMS #32  
 TAKE HWY 401S T/R ON WEST ON REAVES  
 BRIDGE ROAD. T/L INTO SUBDIVISION ON  
 KENLAN RD.  
 \*\*\*PREMISE # WAITING ON CUS\*\*\*

**STRUCTURE: 000 000**

FLOOD ZONE : FLOOD ZONE X  
 # BEDROOMS : 3.00 PROPOSED USE : SFD  
 SEPTIC - EXISTING? : NEW TANK WATER SUPPLY : COUNTY

**PERMIT: CPSF 00 CP \* SFD**

TYP/SQ	REQUESTED COMPLETED	INSP RESULT	DESCRIPTION RESULTS/COMMENTS
B101 01	9/20/10	JH	R*BLDG FOOTING / TEMP SVC POLE VRU #: 001984236
	9/20/10	AP	t-pole passed
B103 01	9/22/10	KS	R*BLDG FOUND & TEMP SVC POLE VRU #: 001985191
	9/22/10	DP	Foundation not complete \$50 re-inspection fee
			T/S: 09/22/2010 08:39 AM KSLATTUM
B103 02	9/23/10	JH	R*BLDG FOUND & TEMP SVC POLE TIME: 17:00 VRU #: 001986116
	9/23/10	DA	T/S: 09/22/2010 04:15 PM NTART Need engineer letter for repair on footing on right side of house where block were put in as a footing, area circled on plans.
B103 03	10/04/10	JH	R*BLDG FOUND & TEMP SVC POLE VRU #: 001989227
	10/04/10	AP	
B111 01	10/08/10	TI	R*BLDG SLAB INSP VRU #: 001991538
	10/07/10	CA	Plumbing Slab
			T/S: 10/07/2010 02:50 PM NTART
P309 01	10/08/10	JH	R*PLUMB UNDER SLAB TIME: 17:00 VRU #: 001991702
	10/08/10	AP	T/S: 10/07/2010 02:52 PM NTART
B111 02	10/11/10	JH	R*BLDG SLAB INSP VRU #: 001992064
	10/11/10	AP	
A814 01	10/26/10	TI	ADDRESS CONFIRMATION TIME: 17:00 VRU #: 001998509
			T/S: 10/25/2010 12:46 PM VBROWN
R425 01	10/26/10	JH	FOUR TRADE ROUGH IN TIME: 17:00 VRU #: 001998525
	10/26/10	DA	T/S: 10/25/2010 12:46 PM VBROWN 1) Missing shingles on house they are not completed. 2) Fire place needs to be installed @ roughin. 3) Missing windows @ master bath tub these need to be installed @ roughin. 4) 3' head of water on drain lines. 5) 100 psi on water lines. 6) Need uplift straps on roof truss C1 both ends, D1B joint 16, D1C joint 15, D1D & D1E joints 6 & 9.
R425 02	10/29/10	JH	FOUR TRADE ROUGH IN VRU #: 001999770
	10/29/10	DP	Item #4 from previous violations were not corrected
R425 03	11/01/10	TI	FOUR TRADE ROUGH IN TIME: 17:00 VRU #: 002000834

CONTINUED ONTO NEXT PAGE

-----  
ADDRESS . . : 118 EMMA CT SUBDIV: KENLAN FARMS PH1 SET1 41LOTS  
CONTRACTOR : GARY ROBINSON HOMES LLC PHONE : (910) 977-2562  
OWNER . . : ABJ INVESTMENTS LLC PHONE :  
PARCEL . . : 12-0555- - -0216- -32-  
APPL NUMBER: 10-50025088 CP NEW RESIDENTIAL (SFD)  
-----

TYP/SQ	REQUESTED COMPLETED	INSP RESULT	DESCRIPTION RESULTS/COMMENTS
	11-1-10	APJA	T/S: 10/29/2010 02:38 PM NTART -----

----- COMMENTS AND NOTES -----

ADDRESS : 118 EMMA CT  
CONTRACTOR : GARY ROBINSON HOMES LLC  
OWNER : ABJ INVESTMENTS LLC  
PARCEL : 12-0555- - -0216- -32-  
APPL NUMBER: 10-50025088 CP NEW RESIDENTIAL (SFD)  
DIRECTIONS : T/S: 08/23/2010 02:07 PM RDCONTE ---  
118 EMMA COURT / KENLAN FARMS #32  
TAKE HWY 401S T/R ON WEST ON REAVES  
BRIDGE ROAD. T/L INTO SUBDIVISION ON  
KENLAN RD.  
\*\*\*PREMISE # WAITING ON CUS\*\*\*

SUBDIV: KENLAN FARMS PH1 SET1 41LOTS  
PHONE : (910) 977-2562  
PHONE :

STRUCTURE: 000 000

FLOOD ZONE : FLOOD ZONE X  
# BEDROOMS : 3.00  
SEPTIC - EXISTING? : NEW TANK  
PROPOSED USE : SFD  
WATER SUPPLY : COUNTY

PERMIT: CPSF 00 CP \* SFD

TYP/SQ	REQUESTED COMPLETED	INSP RESULT	DESCRIPTION RESULTS/COMMENTS
B101 01	9/20/10	JH	R*BLDG FOOTING / TEMP SVC POLE VRU #: 001984236
	9/20/10	AP	t-pole passed
B103 01	9/22/10	KS	R*BLDG FOUND & TEMP SVC POLE VRU #: 001985191
	9/22/10	DP	Foundation not complete \$50 re-inspection fee T/S: 09/22/2010 08:39 AM KSLATTUM
B103 02	9/23/10	JH	R*BLDG FOUND & TEMP SVC POLE TIME: 17:00 VRU #: 001986116
	9/23/10	DA	T/S: 09/22/2010 04:15 PM NTART Need engineer letter for repair on footing on right side of house where block were put in as a footing, area circled on plans.
B103 03	10/04/10	JH	R*BLDG FOUND & TEMP SVC POLE VRU #: 001989227
	10/04/10	AP	
B111 01	10/08/10	TI	R*BLDG SLAB INSP VRU #: 001991538
	10/07/10	CA	Plumbing Slab T/S: 10/07/2010 02:50 PM NTART
P309 01	10/08/10	JH	R*PLUMB UNDER SLAB TIME: 17:00 VRU #: 001991702
	10/08/10	AP	T/S: 10/07/2010 02:52 PM NTART
B111 02	10/11/10	JH	R*BLDG SLAB INSP VRU #: 001992064
	10/11/10	AP	
A814 01	10/26/10	TW	ADDRESS CONFIRMATION TIME: 17:00 VRU #: 001998509
	11/01/10	AP	T/S: 10/25/2010 12:46 PM VBROWN 118 EMMA CT LOT 32 LINDEN 28356 T/S: 11/01/2010 11:05 AM TWARD
R425 01	10/26/10	JH	FOUR TRADE ROUGH IN TIME: 17:00 VRU #: 001998525
	10/26/10	DA	T/S: 10/25/2010 12:46 PM VBROWN 1) Missing shingles on house they are not completed. 2) Fire place needs to be installed @ roughin. 3) Missing windows @ master bath tub these need to be installed @ roughin. 4) 3' head of water on drain lines. 5) 100 psi on water lines. 6) Need uplift straps on roof truss C1 both ends, D1B joint 16, D1C joint 15, D1D & D1E joints 6 & 9.
R425 02	10/29/10	JH	FOUR TRADE ROUGH IN VRU #: 001999770

CONTINUED ONTO NEXT PAGE

-----  
ADDRESS . . : 118 EMMA CT SUBDIV: KENLAN FARMS PH1 SET1 41LOTS  
CONTRACTOR : GARY ROBINSON HOMES LLC PHONE : (910) 977-2562  
OWNER . . : ABJ INVESTMENTS LLC PHONE :  
PARCEL . . : 12-0555- - -0216- -32-  
APPL NUMBER: 10-50025088 CP NEW RESIDENTIAL (SFD)  
-----

TYP/SQ	REQUESTED COMPLETED	INSP RESULT	DESCRIPTION RESULTS/COMMENTS
	10/29/10	DP	Item #4 from previous violations were not corrected-----
R425 03	11/01/10	JH	FOUR TRADE ROUGH IN TIME: 17:00 VRU #: 002000834
	11/01/10	AP	T/S: 10/29/2010 02:38 PM NTART -----
I129 01	11/03/10	TI	R*INSULATION INSPECTION VRU #: 002001618
	<del>11-3-10</del>	<i>DA JV</i>	

----- COMMENTS AND NOTES -----

-----  
 ADDRESS . . : 118 EMMA CT  
 CONTRACTOR : GARY ROBINSON HOMES LLC  
 OWNER . . . : ABJ INVESTMENTS LLC  
 PARCEL . . . : 12-0555- - -0216- -32-  
 APPL NUMBER: 10-50025088 CP NEW RESIDENTIAL (SFD)  
 DIRECTIONS : T/S: 08/23/2010 02:07 PM RDCONTE ---  
 118 EMMA COURT / KENLAN FARMS #32  
 TAKE HWY 401S T/R ON WEST ON REAVES  
 BRIDGE ROAD. T/L INTO SUBDIVISION ON  
 KENLAN RD.  
 \*\*\*PREMISE # WAITING ON CUS\*\*\*

SUBDIV: KENLAN FARMS PH1 SET1 41LOTS  
 PHONE : (910) 977-2562  
 PHONE :

-----  
**STRUCTURE: 000 000**

FLOOD ZONE . . . . : FLOOD ZONE X  
 # BEDROOMS . . . . . : 3.00  
 SEPTIC - EXISTING? . . . . : NEW TANK  
 PROPOSED USE . . . . . : SFD  
 WATER SUPPLY . . . . . : COUNTY

-----  
**PERMIT: CPSF 00 CP \* SFD**

TYP/SQ	REQUESTED COMPLETED	INSP RESULT	DESCRIPTION RESULTS/COMMENTS
B101 01	9/20/10	JH	R*BLDG FOOTING / TEMP SVC POLE VRU #: 001984236
	9/20/10	AP	t-pole passed
B103 01	9/22/10	KS	R*BLDG FOUND & TEMP SVC POLE VRU #: 001985191
	9/22/10	DP	Foundation not complete \$50 re-inspection fee
			T/S: 09/22/2010 08:39 AM KSLATTUM -----
B103 02	9/23/10	JH	R*BLDG FOUND & TEMP SVC POLE TIME: 17:00 VRU #: 001986116
	9/23/10	DA	T/S: 09/22/2010 04:15 PM NTART ----- Need engineer letter for repair on footing on right side of house where block were put in as a footing, area circled on plans.
B103 03	10/04/10	JH	R*BLDG FOUND & TEMP SVC POLE VRU #: 001989227
	10/04/10	AP	-----
B111 01	10/08/10	TI	R*BLDG SLAB INSP VRU #: 001991538
	10/07/10	CA	Plumbing Slab
			T/S: 10/07/2010 02:50 PM NTART -----
P309 01	10/08/10	JH	R*PLUMB UNDER SLAB TIME: 17:00 VRU #: 001991702
	10/08/10	AP	T/S: 10/07/2010 02:52 PM NTART -----
			-----
B111 02	10/11/10	JH	R*BLDG SLAB INSP VRU #: 001992064
	10/11/10	AP	-----
A814 01	10/26/10	TW	ADDRESS CONFIRMATION TIME: 17:00 VRU #: 001998509
	11/01/10	AP	T/S: 10/25/2010 12:46 PM VBROWN ----- 118 EMMA CT LOT 32 ----- LINDEN 28356
			T/S: 11/01/2010 11:05 AM TWARD -----
R425 01	10/26/10	JH	FOUR TRADE ROUGH IN TIME: 17:00 VRU #: 001998525
	10/26/10	DA	T/S: 10/25/2010 12:46 PM VBROWN ----- 1) Missing shingles on house they are not completed. 2) Fire place needs to be installed @ roughin. 3) Missing windows @ master bath tub these need to be installed @ roughin. 4) 3' head of water on drain lines. 5) 100 psi on water lines. 6) Need uplift straps on roof truss C1 both ends, D1B joint 16, D1C joint 15, D1D & D1E joints 6 & 9.
R425 02	10/29/10	JH	FOUR TRADE ROUGH IN VRU #: 001999770

----- CONTINUED ONTO NEXT PAGE -----



-----  
ADDRESS . . : 118 EMMA CT SUBDIV: KENLAN FARMS PH1 SET1 41LOTS  
CONTRACTOR : GARY ROBINSON HOMES LLC PHONE : (910) 977-2562  
OWNER . . . : ABJ INVESTMENTS LLC PHONE :  
PARCEL . . . : 12-0555- - -0216- -32-  
APPL NUMBER: 10-50025088 CP NEW RESIDENTIAL (SFD)  
-----

TYP/SQ	REQUESTED COMPLETED	INSP RESULT	DESCRIPTION RESULTS/COMMENTS
	10/29/10	DP	Item #4 from previous violations were not corrected-----
R425 03	11/01/10	JH	FOUR TRADE ROUGH IN TIME: 17:00 VRU #: 002000834
	11/01/10	AP	T/S: 10/29/2010 02:38 PM NTART -----
I129 01	11/03/10	JH	R*INSULATION INSPECTION VRU #: 002001618
	11/03/10	DA	Insulation in bonus room not finished-----
I129 02	11/05/10	TI	R*INSULATION INSPECTION VRU #: 002003101
	<u>11/5/10</u>	<u>AP D+</u>	

----- COMMENTS AND NOTES -----

ADDRESS : 118 EMMA CT SUBDIV: KENLAN FARMS PH1 SET1 41LOTS  
 CONTRACTOR : GARY ROBINSON HOMES LLC PHONE : (910) 977-2562  
 OWNER : ABJ INVESTMENTS LLC PHONE :  
 PARCEL : 12-0555- - -0216- -32-  
 APPL NUMBER: 10-50025088 CP NEW RESIDENTIAL (SFD)  
 DIRECTIONS : T/S: 08/23/2010 02:07 PM RDCONTE ---  
 118 EMMA COURT / KENLAN FARMS #32  
 TAKE HWY 401S T/R ON WEST ON REAVES  
 BRIDGE ROAD. T/L INTO SUBDIVISION ON  
 KENLAN RD.  
 \*\*\*PREMISE # WAITING ON CUS\*\*\*

**STRUCTURE: 000 000**

FLOOD ZONE : FLOOD ZONE X  
 # BEDROOMS : 3.00 PROPOSED USE : SFD  
 SEPTIC - EXISTING? : NEW TANK WATER SUPPLY : COUNTY

**PERMIT: CPSF 00 CP \* SFD**

TYP/SQ	REQUESTED COMPLETED	INSP RESULT	DESCRIPTION RESULTS/COMMENTS
B101 01	9/20/10	JH	R*BLDG FOOTING / TEMP SVC POLE VRU #: 001984236
	9/20/10	AP	t-pole passed
B103 01	9/22/10	KS	R*BLDG FOUND & TEMP SVC POLE VRU #: 001985191
	9/22/10	DP	Foundation not complete \$50 re-inspection fee
			T/S: 09/22/2010 08:39 AM KSLATTUM
B103 02	9/23/10	JH	R*BLDG FOUND & TEMP SVC POLE TIME: 17:00 VRU #: 001986116
	9/23/10	DA	T/S: 09/22/2010 04:15 PM NTART Need engineer letter for repair on footing on right side of house where block were put in as a footing, area circled on plans.
B103 03	10/04/10	JH	R*BLDG FOUND & TEMP SVC POLE VRU #: 001989227
	10/04/10	AP	
B111 01	10/08/10	TI	R*BLDG SLAB INSP VRU #: 001991538
	10/07/10	CA	Plumbing Slab
			T/S: 10/07/2010 02:50 PM NTART
P309 01	10/08/10	JH	R*PLUMB UNDER SLAB TIME: 17:00 VRU #: 001991702
	10/08/10	AP	T/S: 10/07/2010 02:52 PM NTART
B111 02	10/11/10	JH	R*BLDG SLAB INSP VRU #: 001992064
	10/11/10	AP	
A814 01	10/26/10	TW	ADDRESS CONFIRMATION TIME: 17:00 VRU #: 001998509
	11/01/10	AP	T/S: 10/25/2010 12:46 PM VBROWN ✓ 118 EMMA CT LOT 32 LINDEN 28356
			T/S: 11/01/2010 11:05 AM TWARD
R425 01	10/26/10	JH	FOUR TRADE ROUGH IN TIME: 17:00 VRU #: 001998525
	10/26/10	DA	T/S: 10/25/2010 12:46 PM VBROWN 1) Missing shingles on house they are not completed. 2) Fire place needs to be installed @ roughin. 3) Missing windows @ master bath tub these need to be installed @ roughin. 4) 3' head of water on drain lines. 5) 100 psi on water lines. 6) Need uplift straps on roof truss C1 both ends, D1B joint 16, D1C joint 15, D1D & D1E joints 6 & 9.
R425 02	10/29/10	JH	FOUR TRADE ROUGH IN VRU #: 001999770

CONTINUED ONTO NEXT PAGE

-----  
ADDRESS . . : 118 EMMA CT SUBDIV: KENLAN FARMS PH1 SET1 41LOTS  
CONTRACTOR : GARY ROBINSON HOMES LLC PHONE : (910) 977-2562  
OWNER . . : ABJ INVESTMENTS LLC PHONE :  
PARCEL . . : 12-0555- - -0216- -32-  
APPL NUMBER: 10-50025088 CP NEW RESIDENTIAL (SFD)  
-----

TYP/SQ	REQUESTED COMPLETED	INSP RESULT	DESCRIPTION RESULTS/COMMENTS
R425 03	10/29/10 11/01/10 11/01/10	DP JH AP	Item #4 from previous violations were not corrected----- FOUR TRADE ROUGH IN TIME: 17:00 VRU #: 002000834 T/S: 10/29/2010 02:38 PM NTART -----
I129 01	11/03/10 11/03/10	JH DA	R*INSULATION INSPECTION VRU #: 002001618 Insulation in bonus room not finished-----
I129 02	11/05/10 11/05/10	DT AP	R*INSULATION INSPECTION VRU #: 002003101
H824 01	11/29/10 11/29/10	BM AP	✓ ENVIR. OPERATIONS PERMIT TIME: 17:00 VRU #: 002012847 T/S: 11/30/2010 09:36 AM SZIMMER ----- T/S: 11/30/2010 09:37 AM SZIMMER -----
R429 01	1/26/11 1/26/11	JH CA	FOUR TRADE FINAL VRU #: 002033819 per Billy -----
R429 02	2/10/11 <u>2-10-11</u>	TI <u>DA JH</u>	FOUR TRADE FINAL VRU #: 002039360 HVAC Units are not set because of theft

----- COMMENTS AND NOTES -----

ADDRESS : 118 EMMA CT SUBDIV: KENLAN FARMS PH1 SET1 41LOTS  
CONTRACTOR : GARY ROBINSON HOMES LLC PHONE : (910) 977-2562  
OWNER : ABJ INVESTMENTS LLC PHONE :  
PARCEL : 12-0555- - -0216- -32-  
APPL NUMBER: 10-50025088 CP NEW RESIDENTIAL (SFD)  
DIRECTIONS : T/S: 08/23/2010 02:07 PM RDCONTE ---  
118 EMMA COURT / KENLAN FARMS #32  
TAKE HWY 401S T/R ON WEST ON REAVES  
BRIDGE ROAD. T/L INTO SUBDIVISION ON  
KENLAN RD.  
\*\*\*PREMISE # WAITING ON CUS\*\*\*

STRUCTURE: 000 000

FLOOD ZONE : FLOOD ZONE X  
# BEDROOMS : 3.00 PROPOSED USE : SFD  
SEPTIC - EXISTING? : NEW TANK WATER SUPPLY : COUNTY

PERMIT: CPSF 00 CP \* SFD

TYP/SQ	REQUESTED COMPLETED	INSP RESULT	DESCRIPTION RESULTS/COMMENTS
B101 01	9/20/10	JH	R*BLDG FOOTING / TEMP SVC POLE VRU #: 001984236
	9/20/10	AP	t-pole passed
B103 01	9/22/10	KS	R*BLDG FOUND & TEMP SVC POLE VRU #: 001985191
	9/22/10	DP	Foundation not complete \$50 re-inspection fee
			T/S: 09/22/2010 08:39 AM KSLATTUM
B103 02	9/23/10	JH	R*BLDG FOUND & TEMP SVC POLE TIME: 17:00 VRU #: 001986116
	9/23/10	DA	T/S: 09/22/2010 04:15 PM NTART Need engineer letter for repair on footing on right side of house where block were put in as a footing, area circled on plans.
B103 03	10/04/10	JH	R*BLDG FOUND & TEMP SVC POLE VRU #: 001989227
	10/04/10	AP	
B111 01	10/08/10	TI	R*BLDG SLAB INSP VRU #: 001991538
	10/07/10	CA	Plumbing Slab
			T/S: 10/07/2010 02:50 PM NTART
P309 01	10/08/10	JH	R*PLUMB UNDER SLAB TIME: 17:00 VRU #: 001991702
	10/08/10	AP	T/S: 10/07/2010 02:52 PM NTART
B111 02	10/11/10	JH	R*BLDG SLAB INSP VRU #: 001992064
	10/11/10	AP	
A814 01	10/26/10	TW	ADDRESS CONFIRMATION TIME: 17:00 VRU #: 001998509
	11/01/10	AP	T/S: 10/25/2010 12:46 PM VBROWN ✓118 EMMA CT LOT 32 LINDEN 28356
			T/S: 11/01/2010 11:05 AM TWARD
R425 01	10/26/10	JH	FOUR TRADE ROUGH IN TIME: 17:00 VRU #: 001998525
	10/26/10	DA	T/S: 10/25/2010 12:46 PM VBROWN 1) Missing shingles on house they are not completed. 2) Fire place needs to be installed @ roughin. 3) Missing windows @ master bath tub these need to be installed @ roughin. 4) 3' head of water on drain lines. 5) 100 psi on water lines. 6) Need uplift straps on roof truss C1 both ends, D1B joint 16, D1C joint 15, D1D & D1E joints 6 & 9.
R425 02	10/29/10	JH	FOUR TRADE ROUGH IN VRU #: 001999770

CONTINUED ONTO NEXT PAGE

31145602

ADDRESS : 118 EMMA CT SUBDIV: KENLAN FARMS PH1 SET1 41LOTS  
 CONTRACTOR : GARY ROBINSON HOMES LLC PHONE : (910) 977-2562  
 OWNER : ABJ INVESTMENTS LLC PHONE :  
 PARCEL : 12-0555- - -0216- -32-  
 APPL NUMBER: 10-50025088 CP NEW RESIDENTIAL (SFD)

TYP/SQ	REQUESTED COMPLETED	INSP RESULT	DESCRIPTION RESULTS/COMMENTS
R425 03	10/29/10 11/01/10 11/01/10	DP JH AP	Item #4 from previous violations were not corrected----- FOUR TRADE ROUGH IN TIME: 17:00 VRU #: 002000834 T/S: 10/29/2010 02:38 PM NTART -----
I129 01	11/03/10	JH	R*INSULATION INSPECTION VRU #: 002001618
	11/03/10	DA	Insulation in bonus room not finished-----
I129 02	11/05/10	DT	R*INSULATION INSPECTION VRU #: 002003101
	11/05/10	AP	
H824 01	11/29/10	BM	✓ ENVIR. OPERATIONS PERMIT TIME: 17:00 VRU #: 002012847
	11/29/10	AP	T/S: 11/30/2010 09:36 AM SZIMMER ----- T/S: 11/30/2010 09:37 AM SZIMMER -----
R429 01	1/26/11	JH	FOUR TRADE FINAL VRU #: 002033819
	1/26/11	CA	per Billy -----
R429 02	2/10/11	JH	FOUR TRADE FINAL VRU #: 002039360
	2/10/11	DA	HVAC Units are not set because of theft 1) Missing lock out on water heater. 2) Caulk all toilets. 3) Ladder for attic. 4) Missing bricks @ front steps. 5) Missing condensing unit & wiring, customer wants certificate of compliance because of units being robbed.
R429 03	2/22/11 <u>2-22-11</u>	TI <u>AP JW</u>	FOUR TRADE FINAL VRU #: 002044337 <i>Customer received a certificate of compliance            NO condensing unit</i>

COMMENTS AND NOTES

County of Harnett  
Building Inspections Department  
Planning Services

**Certificate of Compliance:**  **Occupancy:**

Certificate issued pursuant to the requirements of North Carolina General Statute 153A-363 and Harnett County Zoning Ordinances. This certifies at the time of issuance, this structure was in compliance with the various ordinances of the County of Harnett and the North Carolina State Building Codes. For the following:

Use Classification: SFD

Name: Gary Robinson Homes LLC

Address: 118 Emma Ct

\_\_\_\_\_

Date: 2-22-11

**Permit Numbers**

Building: \_\_\_\_\_

Electrical: \_\_\_\_\_

Insulation: \_\_\_\_\_

Plumbing: \_\_\_\_\_

Mechanical: \_\_\_\_\_

MFG Home: \_\_\_\_\_

Building Official: James T. Hall

10-5082568