

HTE# 10-5-24725

Harrell County Department of Public Health

PERMIT # 26168

Operation Permit

21610

New Installation Septic Tank Nitrification Line Repair Expansion

PROPERTY LOCATION: ALPINE

Name: (owner) BLACKWELL HOMES SUBDIVISION THE SUMMIT LOT # 111

System Installer: OTIS STRICKLAND Registration # _____

Basement with plumbing: Garage Number of Bedrooms 3

Type of Water Supply: Community Public Well Distance from well 100 feet

System Type: IIIg Types V and VI Systems expire in 5 years.

(In accordance with Table V a)

Owner must contact Health Department 6 months prior to expiration for permit renewal.

This system has been installed in compliance with applicable North Carolina General Statutes, Rules for Sewage Treatment and Disposal, and all conditions of the Improvement Permit and Construction Authorization.

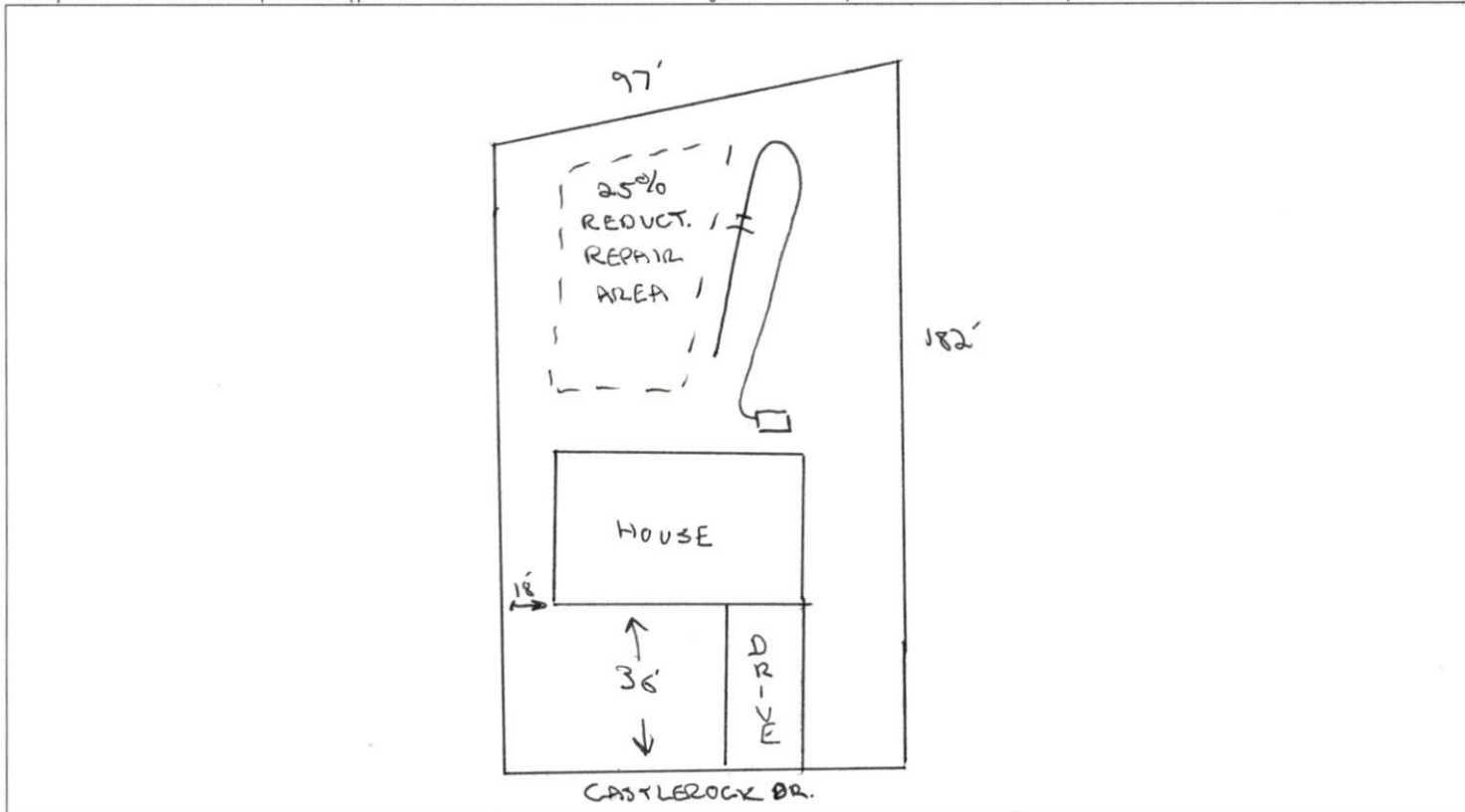

PERMIT CONDITIONS:

- I. Performance: System shall perform in accordance with Rule .1961.
- II. Monitoring: As required by Rule .1961.
- III. Maintenance: As required by Rule .1961. Other: _____
Subsurface system operator required? Yes No
If yes, see attached sheet for additional operation conditions, maintenance and reporting.

IV. Operation: _____

V. Other: STEPDOWN AT 80'. NO UTILITIES LOCATED IN REAR OF HOUSE.

D-Box Pump Alarm H2O Line PWR Line

Following are the specifications for the sewage disposal system on the above captioned property.

Type of system: Conventional Other EZ FLOW Septic Tank: 1000 gallons Pump Tank: _____ gallons
 Subsurface No. of exact length width of depth of
 Drainage Field ditches 1 of each ditch 140 feet ditches 3 feet ditches 18-24 inches
 French Drain Required: _____ Linear feet

Authorized State Agent

RENS

Date 9/2/10