

HTE# 10-5-24590 R

Harnett County Department of Public Health

PERMIT # 26148

Operation Permit

22023

New Installation Septic Tank Nitrification Line Repair Expansion

PROPERTY LOCATION: Lawrence Rd.

Name: (owner) Steve Thomas SUBDIVISION Cinnamon Hill LOT # 8

System Installer: Maple Septic Registration # _____

Basement with plumbing: Garage Number of Bedrooms 3

Type of Water Supply: Community Public Well Distance from well _____ feet

System Type: III g Types V and VI Systems expire in 5 years.

(In accordance with Table V a)

Owner must contact Health Department 6 months prior to expiration for permit renewal.

This system has been installed in compliance with applicable North Carolina General Statutes, Rules for Sewage Treatment and Disposal, and all conditions of the Improvement Permit and Construction Authorization.

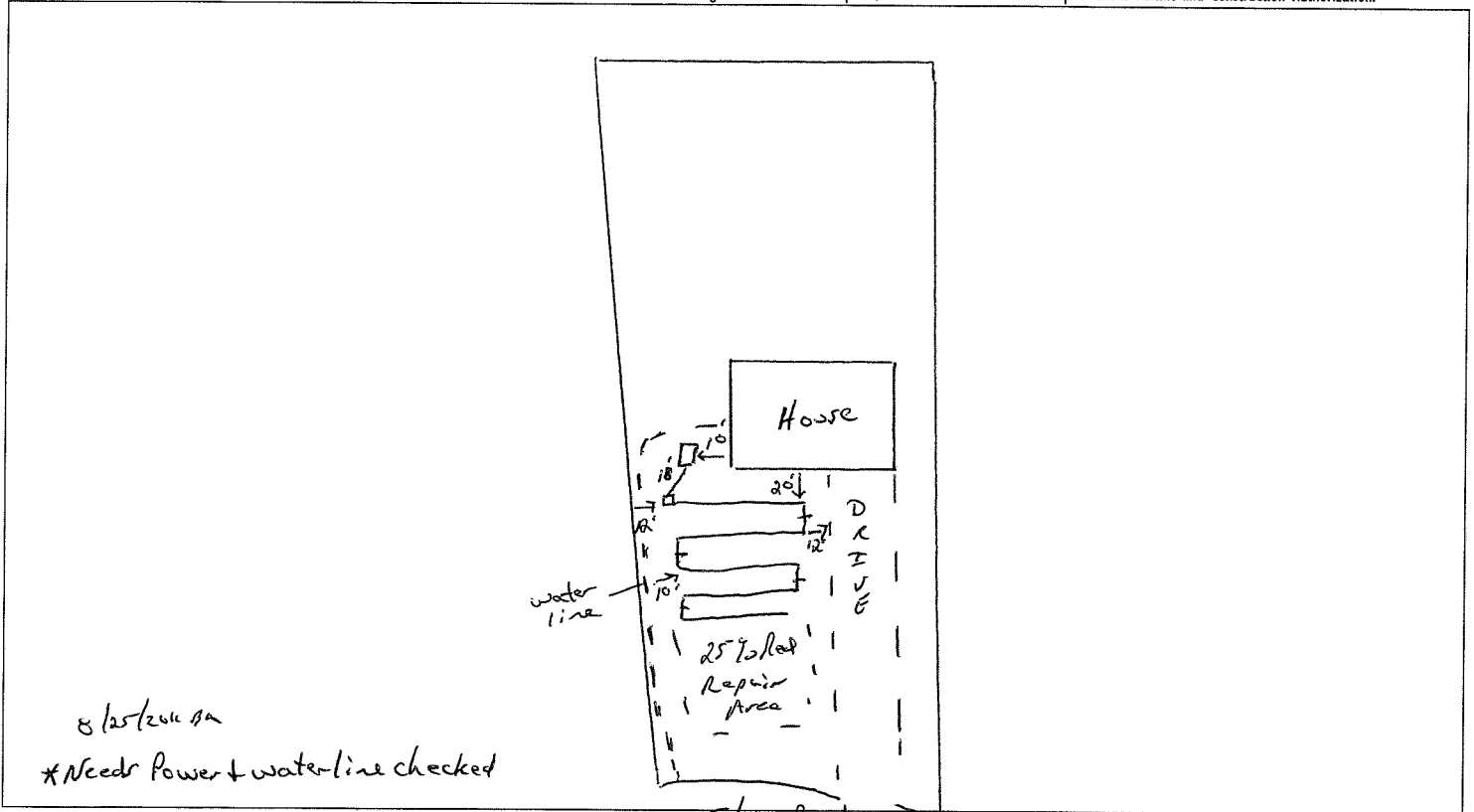

8/25/2012 on
*Needs Power & water-line checked

PERMIT CONDITIONS:

- I. Performance: System shall perform in accordance with Rule .1961.
- II. Monitoring: As required by Rule .1961.
- III. Maintenance: As required by Rule .1961. Other: _____
Subsurface system operator required? Yes No
If yes, see attached sheet for additional operation conditions, maintenance and reporting.
- IV. Operation: _____
- V. Other: _____

D-Box Pump Alarm H2O Line PWR Line

Following are the specifications for the sewage disposal system on the above captioned property.

Type of system: Conventional Other Quick Chamber Septic Tank: 1000 gallons Pump Tank: _____ gallons

Subsurface Drainage Field: No. of ditches 1 exact length of each ditch 150 feet width of ditches 3 feet depth of ditches 24-30 inches

French Drain Required: _____ Linear feet

Authorized State Agent [Signature] Date 11/16/2012