

HTE# 10-5-23935

Harnett County Department of Public Health

25934

Improvement Permit

A building permit cannot be issued with only an Improvement Permit

ISSUED TO: CUMBERLAND HOMES INC PROPERTY LOCATION: NC27
 SUBDIVISION: MIRE BRANCH LOT # 62
 NEW REPAIR EXPANSION
 Type of Structure: SFD (41x36) Site Improvements required prior to Construction Authorization Issuance:
 Proposed Wastewater System Type: CONVENTIONAL
 Projected Daily Flow: 360 GPD
 Number of bedrooms: 3 Number of Occupants: 6 max
 Basement Yes No
 Pump Required: Yes No May be required based on final location and elevations of facilities
 Type of Water Supply: Community Public Well Distance from well 100 feet Permit valid for: Five years
 No expiration
 Permit conditions: _____

Authorized State Agent: [Signature] REHS Date: 3/19/10 SEE ATTACHED SITE SKETCH
 The issuance of this permit by the Health Department in no way guarantees the issuance of other permits. The permit holder is responsible for checking with appropriate governing bodies in meeting their requirements. This site is subject to revocation if the site plan, plat, or the intended use changes. The Improvement Permit shall not be affected by a change in ownership of the site. This permit is subject to compliance with the provisions of the Laws and Rules for Sewage Treatment and Disposal and to conditions of this permit.

Construction Authorization

(Required for Building Permit)

The construction and installation requirements of Rules .1950, .1952, .1954, .1955, .1956, .1957, .1958, and .1959 are incorporated by references into this permit and shall be met. Systems shall be installed in accordance with the attached system layout.

ISSUED TO: CUMBERLAND HOMES INC PROPERTY LOCATION: NC27
 SUBDIVISION: MIRE BRANCH LOT # 62
 Facility Type: SFD (41x36) New Expansion Repair
 Basement? Yes No Basement Fixtures? Yes No
 Type of Wastewater System** CONVENTIONAL (Initial) Wastewater Flow: 360 GPD
 (See note below, if applicable) CONVENTIONAL (Repair)

Installation Requirements/Conditions
 Septic Tank Size 1000 gallons
 Pump Tank Size _____ gallons
 Number of trenches 4
 Exact length of each trench 75 feet
 Trenches shall be installed on contour at a
 Maximum Trench Depth of: 18-24 inches
 (Trench bottoms shall be level to +/- 1/4" in all directions)
 Pump Requirements: _____ ft. TDH vs. _____ GPM
 Trench Spacing: 9 Feet on Center
 Soil Cover: 6-12 inches
 (Maximum soil cover shall not exceed 36" above the trench bottom)
 Aggregate Depth: 6 inches below pipe
2 inches above pipe
12 inches total
 Conditions: WATER LINE MUST BE 10' FROM SEPTIC SYSTEM

**If applicable: I understand the system type specified is different from the type specified on the application. I accept the specifications of this permit.

Owner/Legal Representative Signature: _____ Date: _____

This Construction Authorization is subject to revocation if the site plan, plat, or the intended use changes. The Construction Authorization shall not be transferred when there is a change in ownership of the site. This Construction Authorization is subject to compliance with the provisions of the Laws and Rules for Sewage Treatment and Disposal and to the conditions of this permit.

SEE ATTACHED SITE SKETCH

Authorized State Agent: [Signature] REHS Date: 3/19/10
 Construction Authorization Expiration Date: 3/19/15

HTE# 10-5-23935

Permit # 25934

Harnett County Department of Public Health Site Sketch

ISSUED TO: CUMBERLAND HOMES INC PROPERTY LOCATION: NC27
SUBDIVISION MIRE BRANCH LOT # 62

Authorized State Agent: ~~RENS (OLIVER TOLKSDORF)~~ Date: 3/19/10

DRAWING
NTS

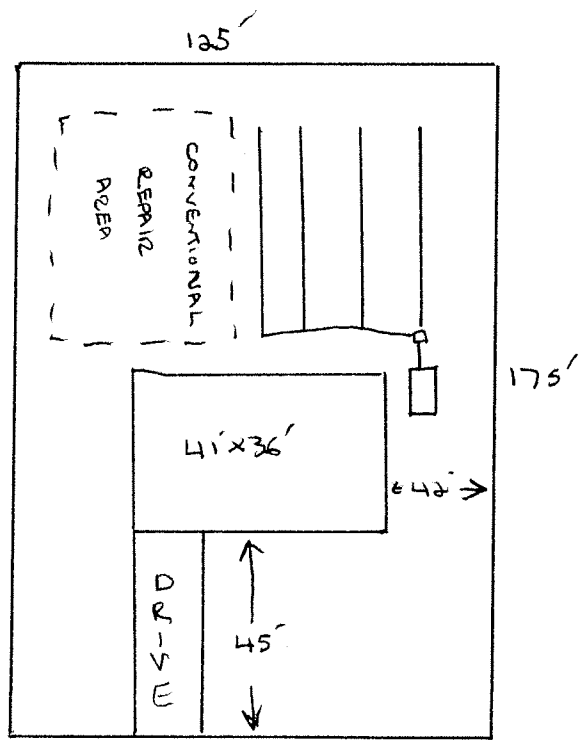

SUNRIDGE DR