ADDRESS . . : 89924 *UNASSIGNED
CONTRACTOR : POPE ROBERT
OWNER . . . : JOHNSON LUCAS N & LYNETTE B
PARCEL . . . : 04-0682- - -0216- -13-
APPL NUMBER: 10-50023673 CP NEW RESIDENTIAL (SFD)
DIRECTIONS : T/S: 01/26/2010 09:03 AM VBROWN ----
OFF OF NC 55W CREATURE MEADOW LANE OR
DRIVE. 421S, LEFT ON OLD STAGE RD,
LEFT ON NC 55, 1/4MI CREATURE MEADOW ON
LEFT.

SUBDIV:
PHONE : (919) 868-2912
PHONE :

STRUCTURE: 000 000 33X57 3BDR 2.5BATH SFD WITH CRAWL

FLOOD ZONE : FLOOD ZONE X
BEDROOMS : 3.00
SEPTIC - EXISTING? : NEW TANK
PROPOSED USE : SFD
WATER SUPPLY : COUNTY

PERMIT: CPSF 00 CP * SFD

TYP/SQ	REQUESTED	INSP	DESCRIPTION
	COMPLETED	RESULT	RESULTS/COMMENTS

B101 01	3/16/10	TI	R*BLDG FOOTING / TEMP SVC POLE TIME: 17:00 VRU #: 001895150
	<u>3-16</u>	<u>AP</u>	T/S: 03/15/2010 01:57 PM RDCONTE ----- ELEC WILL NOT BE AVAILABLE FOR SEVERAL WEEKS. WILL CALL ASAP FOR T-POLE. FOOTING ONLY.

COMMENTS AND NOTES

ADDRESS . . : 89924 *UNASSIGNED
 CONTRACTOR : POPE ROBERT
 OWNER . . : JOHNSON LUCAS N & LYNETTE B
 PARCEL . . : 04-0682- - -0216- -13-
 APPL NUMBER: 10-50023673 CP NEW RESIDENTIAL (SFD)
 DIRECTIONS : T/S: 01/26/2010 09:03 AM VBROWN -----
 OFF OF NC 55W CREATURE MEADOW LANE OR
 DRIVE. 421S, LEFT ON OLD STAGE RD,
 LEFT ON NC 55, 1/4MI CREATURE MEADOW ON
 LEFT.

SUBDIV:
 PHONE : (919) 868-2912
 PHONE :

STRUCTURE: 000 000 33X57 3BDR 2.5BATH SFD WITH CRAWL

FLOOD ZONE : FLOOD ZONE X
 # BEDROOMS : 3.00
 SEPTIC - EXISTING? : NEW TANK

PROPOSED USE : SFD
 WATER SUPPLY : COUNTY

PERMIT: CPSF 00 CP * SFD

TYP/SQ	REQUESTED COMPLETED	INSP RESULT	DESCRIPTION RESULTS/COMMENTS
B101 01	3/16/10 3/16/10	KS AP	R*BLDG FOOTING / TEMP SVC POLE TIME: 17:00 VRU #: 001895150 T/S: 03/15/2010 01:57 PM RDCONTE ----- ELEC WILL NOT BE AVAILABLE FOR SEVERAL WEEKS. WILL CALL ASAP FOR T-POLE. FOOTING ONLY.
B103 01	3/24/10 <u>3-24</u>	TI <u>AP</u>	R*BLDG FOUND & TEMP SVC POLE VRU #: 001899093 VOICE MESSAGE LEFT
			<u>KS</u> ----- COMMENTS AND NOTES -----

PREPARED 3/25/10, 14:22:44
Harnett County

INSPECTION TICKET
INSPECTOR: IVR

PAGE
DATE 3/26/10

ADDRESS . . : 89924 *UNASSIGNED
CONTRACTOR : POPE ROBERT
OWNER . . . : JOHNSON LUCAS N & LYNETTE B
PARCEL . . . : 04-0682- - -0216- -13-
APPL NUMBER: 10-50023673 CP NEW RESIDENTIAL (SFD)
DIRECTIONS : T/S: 01/26/2010 09:03 AM VBROWN -----
OFF OF NC 55W CREATURE MEADOW LANE OR
DRIVE. 421S, LEFT ON OLD STAGE RD,
LEFT ON NC 55, 1/4MI CREATURE MEADOW ON
LEFT.

SUBDIV:
PHONE : (919) 868-2912
PHONE :

STRUCTURE: 000 000 33X57 3BDR 2.5BATH SFD WITH CRAWL
FLOOD ZONE : FLOOD ZONE X
BEDROOMS : 3.00
SEPTIC - EXISTING? : NEW TANK

PROPOSED USE : SFD
WATER SUPPLY : COUNTY

PERMIT: CPSF 00 CP * SFD

TYP/SQ	REQUESTED COMPLETED	INSP RESULT	DESCRIPTION RESULTS/COMMENTS
B101 01	3/16/10 3/16/10	KS AP	R*BLDG FOOTING / TEMP SVC POLE TIME: 17:00 VRU #: 001895150 T/S: 03/15/2010 01:57 PM RDCONTE ----- ELEC WILL NOT BE AVAILABLE FOR SEVERAL WEEKS. WILL CALL ASAP FOR T-POLE. FOOTING ONLY.
B103 01	3/24/10 3/24/10	KS AP	R*BLDG FOUND & TEMP SVC POLE VRU #: 001899093 VOICE MESSAGE LEFT
B105 01	3/26/10 <u>3-26-10</u>	TI <u>DARS</u>	R*OPEN FLOOR VRU #: 001900651

COMMENTS AND NOTES

ADDRESS . . : 89924 *UNASSIGNED
CONTRACTOR : POPE ROBERT
OWNER . . . : JOHNSON LUCAS N & LYNETTE B
PARCEL . . . : 04-0682- - -0216- -13-
APPL NUMBER: 10-50023673 CP NEW RESIDENTIAL (SFD)
DIRECTIONS : T/S: 01/26/2010 09:03 AM VBROWN -----
OFF OF NC 55W CREATURE MEADOW LANE OR
DRIVE. 421S, LEFT ON OLD STAGE RD,
LEFT ON NC 55, 1/4MI CREATURE MEADOW ON
LEFT.

STRUCTURE: 000 000 33X57 3BDR 2.5BATH SFD WITH CRAWL
FLOOD ZONE : FLOOD ZONE X
BEDROOMS : 3.00
SEPTIC - EXISTING? : NEW TANK
PROPOSED USE : SFD
WATER SUPPLY : COUNTY

PERMIT: CPSF 00 CP * SFD

TYP/SQ	REQUESTED COMPLETED	INSP RESULT	DESCRIPTION RESULTS/COMMENTS
B101 01	3/16/10 3/16/10	KS AP	R*BLDG FOOTING / TEMP SVC POLE TIME: 17:00 VRU #: 001895150 T/S: 03/15/2010 01:57 PM RDCONTE ----- ELEC WILL NOT BE AVAILABLE FOR SEVERAL WEEKS. WILL CALL ASAP FOR T-POLE. FOOTING ONLY.
B103 01	3/24/10 3/24/10	KS AP	R*BLDG FOUND & TEMP SVC POLE VRU #: 001899093 VOICE MESSAGE LEFT
B105 01	3/26/10 3/26/10	BS DA	R*OPEN FLOOR VRU #: 001900651 Plan calls for a triple 2x10 girder in span on rear of house. SEE PLAN DO NOT COVER. Call to reschedule
B105 02	<u>3/29/10</u> <u>3-29-10</u>	TI <u>ARB</u>	R*OPEN FLOOR VRU #: 001901384 VOICE MESSAGE LEFT

COMMENTS AND NOTES

ADDRESS : 251 CREATURE MEADOW LN
CONTRACTOR : POPE ROBERT
OWNER : JOHNSON LUCAS N & LYNETTE B
PARCEL : 04-0682- - -0216- -13-
APPL NUMBER: 10-50023673 CP NEW RESIDENTIAL (SFD)
DIRECTIONS : T/S: 01/26/2010 09:03 AM VBROWN ----
OFF OF NC 55W CREATURE MEADOW LANE OR
DRIVE. 421S, LEFT ON OLD STAGE RD,
LEFT ON NC 55, 1/4MI CREATURE MEADOW ON
LEFT.

SUBDIV:
PHONE : (919) 868-2912
PHONE :

STRUCTURE: 000 000 33X57 3BDR 2.5BATH SFD WITH CRAWL

FLOOD ZONE : FLOOD ZONE X
BEDROOMS : 3.00
SEPTIC - EXISTING? : NEW TANK
PROPOSED USE : SFD
WATER SUPPLY : COUNTY

PERMIT: CPSF 00 CP * SFD

TYP/SQ	REQUESTED COMPLETED	INSP RESULT	DESCRIPTION RESULTS/COMMENTS
B101 01	3/16/10 3/16/10	KS AP	R*BLDG FOOTING / TEMP SVC POLE TIME: 17:00 VRU #: 001895150 T/S: 03/15/2010 01:57 PM RDCONTE ----- ELEC WILL NOT BE AVAILABLE FOR SEVERAL WEEKS. WILL CALL ASAP FOR T-POLE. FOOTING ONLY.
B103 01	3/24/10 3/24/10	KS AP	R*BLDG FOUND & TEMP SVC POLE VRU #: 001899093 VOICE MESSAGE LEFT
B105 01	3/26/10 3/26/10	BS DA	R*OPEN FLOOR VRU #: 001900651 Plan calls for a triple 2x10 girder in span on rear of house. SEE PLAN DO NOT COVER. Call to reschedule
B105 02	3/29/10 3/29/10	BS AP	R*OPEN FLOOR VRU #: 001901384 VOICE MESSAGE LEFT T/S: March 29, 2010 11:46 AM BSUTTON -----
A814 01	3/30/10 4/01/10	TW AP	ADDRESS CONFIRMATION TIME: 17:00 VRU #: 001899468 251 creature meadow ln # on house and by drive angier 27501 T/S: 04/01/2010 09:37 AM TWARD -----
R425 01	5/04/10 <i>5-4-10</i>	TI <i>DAES</i>	FOUR TRADE ROUGH IN VRU #: 001920023 VOICE MESSAGE LEFT

COMMENTS AND NOTES

ADDRESS : 251 CREATURE MEADOW LN
 CONTRACTOR : POPE ROBERT
 OWNER : JOHNSON LUCAS N & LYNETTE B
 PARCEL : 04-0682- - -0216- -13-
 APPL NUMBER: 10-50023673 CP NEW RESIDENTIAL (SFD)
 DIRECTIONS : T/S: 01/26/2010 09:03 AM VBROWN ----
 OFF OF NC 55W CREATURE MEADOW LANE OR
 DRIVE. 421S, LEFT ON OLD STAGE RD,
 LEFT ON NC 55, 1/4MI CREATURE MEADOW ON
 LEFT.

SUBDIV:
 PHONE : (919) 868-2912
 PHONE :

STRUCTURE: 000 000 33X57 3BDR 2.5BATH SFD WITH CRAWL

FLOOD ZONE : FLOOD ZONE X
 # BEDROOMS : 3.00
 SEPTIC - EXISTING? : NEW TANK

PROPOSED USE : SFD
 WATER SUPPLY : COUNTY

PERMIT: CPSF 00 CP * SFD

TYP/SQ	REQUESTED COMPLETED	INSP RESULT	DESCRIPTION RESULTS/COMMENTS
B101 01	3/16/10 3/16/10	KS AP	R*BLDG FOOTING / TEMP SVC POLE TIME: 17:00 VRU #: 001895150 T/S: 03/15/2010 01:57 PM RDCONTE ----- ELEC WILL NOT BE AVAILABLE FOR SEVERAL WEEKS. WILL CALL ASAP FOR T-POLE. FOOTING ONLY.
B103 01	3/24/10 3/24/10	KS AP	R*BLDG FOUND & TEMP SVC POLE VRU #: 001899093 VOICE MESSAGE LEFT
B105 01	3/26/10 3/26/10	BS DA	R*OPEN FLOOR VRU #: 001900651 Plan calls for a triple 2x10 girder in span on rear of house. SEE PLAN DO NOT COVER. Call to reschedule
B105 02	3/29/10 3/29/10	BS AP	R*OPEN FLOOR VRU #: 001901384 VOICE MESSAGE LEFT
A814 01	3/30/10 4/01/10	TW AP	T/S: March 29, 2010 11:46 AM BSUTTON ----- ADDRESS CONFIRMATION TIME: 17:00 VRU #: 001899468 251 creature meadow ln # on house and by drive angier 27501
R425 01	5/04/10 5/04/10	BS DA	T/S: 04/01/2010 09:37 AM TWARD ----- FOUR TRADE ROUGH IN VRU #: 001920023 VOICE MESSAGE LEFT 1. Hurricane ties on kitchen rafter. 2. Strap vent At master bath. 3. Nail plate in foyer for electrical. 4. Through bolt deck bands to house. 5. Reframe ceiling over stair opening to support roof hip/valley. 6. Need engineering on change from 2- 11 7/8 to 3 9/14 LVL over kitchen 7. Need engineering on double 2x10 right rear side of house supporting wall/roof loads, and hip/valleys supported on non-load wall below. Ok to side. Do not insulate
R425 02	5/12/10 5-12	TI AP	FOUR TRADE ROUGH IN VRU #: 001924828
E207 01	5/12/10 5-12	TI AP	R*ELEC TEMP SERVICE POLE TIME: 17:00 VRU #: 001924836 T/S: 05/11/2010 01:47 PM NTART -----

COMMENTS AND NOTES

MASSENGILL ASSOCIATES, P.A.
 Consulting Engineering
 Design And Project Management
 116 East Main Street P.O. Box 695
 BENSON, NORTH CAROLINA 27504-0695
 (919)-894-2071 FAX (919)-894-7288

JOB JOHNSON RES.
 SHEET NO. 5-1 OF 5-2
 CALCULATED BY [Signature] DATE 5-10-10
 CHECKED BY _____ DATE _____
 SCALE _____

PERMIT # 10-50023673

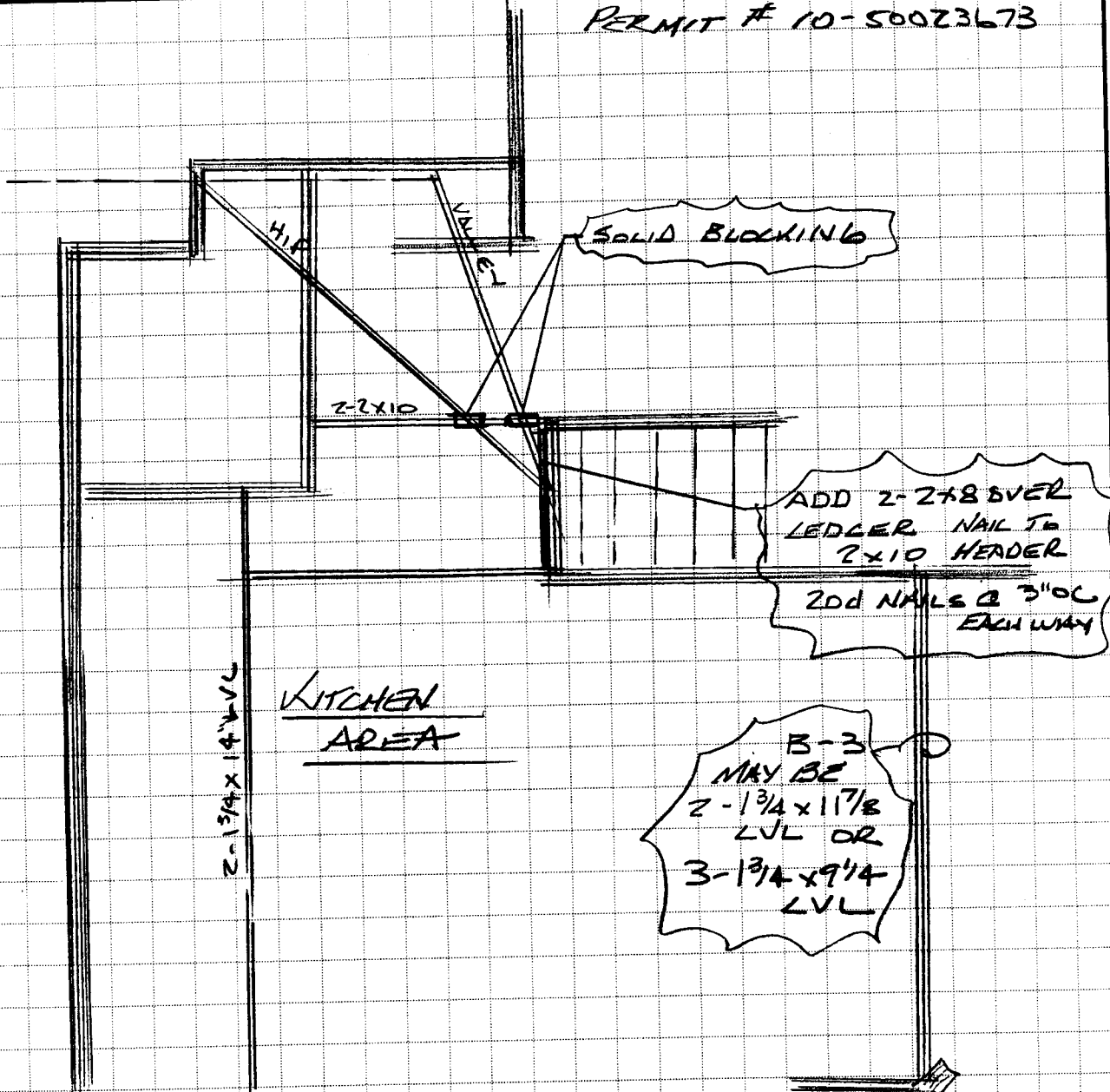

1
51

HIP + VALLEY
 SUPPORT LOCATIONS

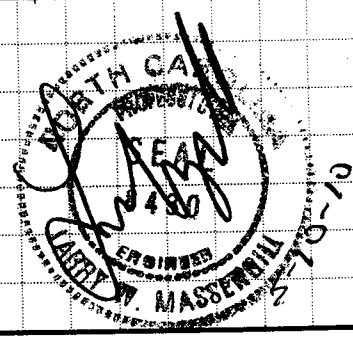

MASSENGILL ASSOCIATES, P.A.
 Consulting Engineering
 Design And Project Management
 116 East Main Street P.O. Box 695
 BENSON, NORTH CAROLINA 27504-0695
 (919)-894-2071 FAX (919)-894-7288

JOB JOHNSON RES.
 SHEET NO. S-2 OF S-2
 CALCULATED BY L. Myhill DATE 5-10-10
 CHECKED BY _____ DATE _____
 SCALE _____

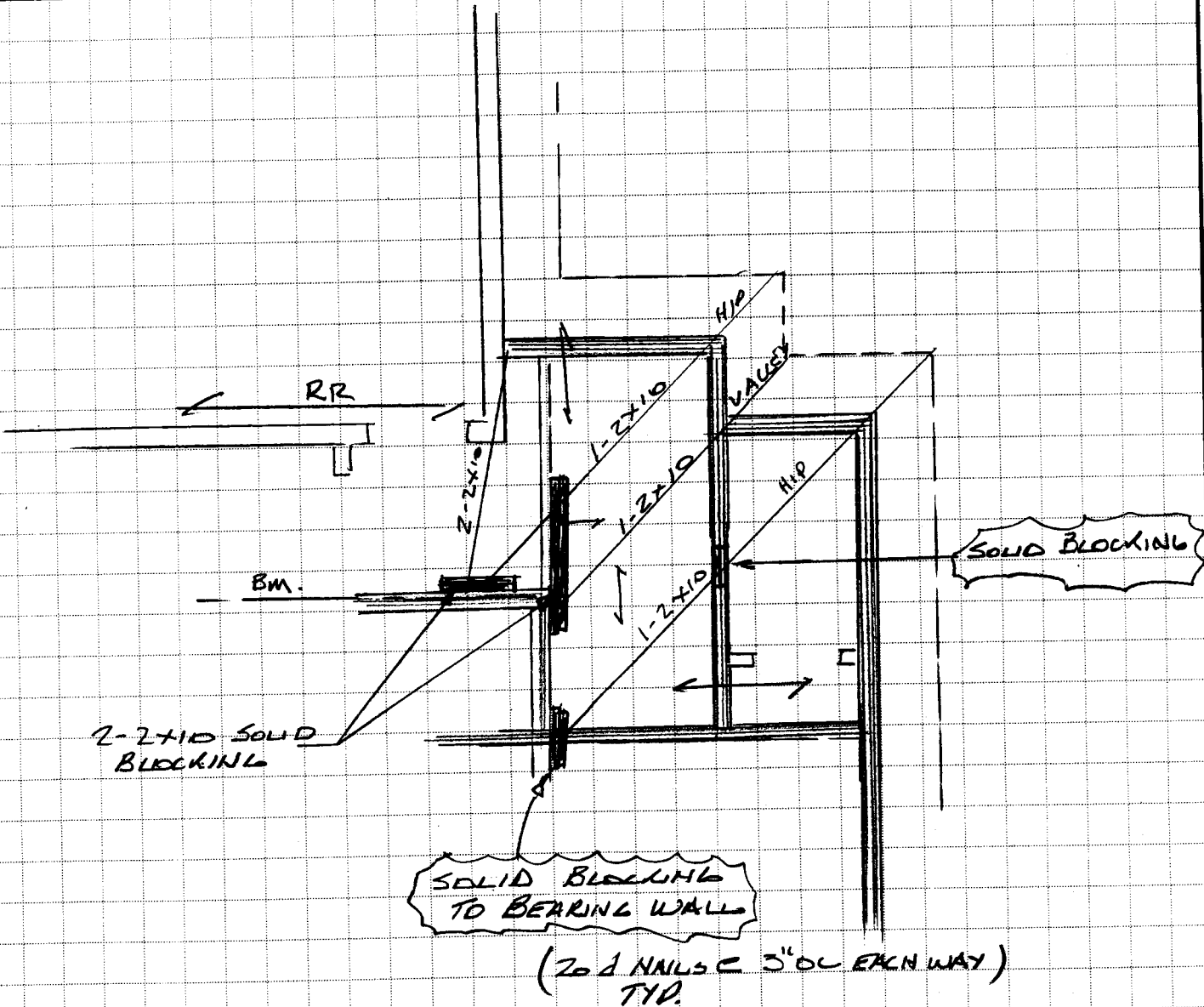

①
 S-2 HIP + VALLEY
 SUPPORT LOCATIONS 1/4" = 1'-0"

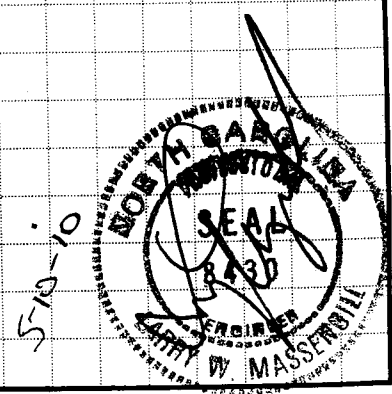

ADDRESS : 251 CREATURE MEADOW LN
 CONTRACTOR : POPE ROBERT
 OWNER : JOHNSON LUCAS N & LYNETTE B
 PARCEL : 04-0682- - -0216- -13-
 APPL NUMBER: 10-50023673 CP NEW RESIDENTIAL (SFD)
 DIRECTIONS : T/S: 01/26/2010 09:03 AM VBROWN ----
 OFF OF NC 55W CREATURE MEADOW LANE OR
 DRIVE. 421S, LEFT ON OLD STAGE RD,
 LEFT ON NC 55, 1/4MI CREATURE MEADOW ON
 LEFT.

SUBDIV:
 PHONE : (919) 868-2912
 PHONE :

STRUCTURE: 000 000 33X57 3BDR 2.5BATH SFD WITH CRAWL

FLOOD ZONE : FLOOD ZONE X
 # BEDROOMS : 3.00 PROPOSED USE : SFD
 SEPTIC - EXISTING? : NEW TANK WATER SUPPLY : COUNTY

PERMIT: CPSF 00 CP * SFD

TYP/SQ	REQUESTED COMPLETED	INSP RESULT	DESCRIPTION RESULTS/COMMENTS
B101 01	3/16/10 3/16/10	KS AP	R*BLDG FOOTING / TEMP SVC POLE TIME: 17:00 VRU #: 001895150 T/S: 03/15/2010 01:57 PM RDCONTE ----- ELEC WILL NOT BE AVAILABLE FOR SEVERAL WEEKS. WILL CALL ASAP FOR T-POLE. FOOTING ONLY.
B103 01	3/24/10 3/24/10	KS AP	R*BLDG FOUND & TEMP SVC POLE VRU #: 001899093 VOICE MESSAGE LEFT
B105 01	3/26/10 3/26/10	BS DA	R*OPEN FLOOR VRU #: 001900651 Plan calls for a triple 2x10 girder in span on rear of house. SEE PLAN DO NOT COVER. Call to reschedule
B105 02	3/29/10 3/29/10	BS AP	R*OPEN FLOOR VRU #: 001901384 VOICE MESSAGE LEFT T/S: March 29, 2010 11:46 AM BSUTTON -----
A814 01	3/30/10 4/01/10	TW AP	ADDRESS CONFIRMATION TIME: 17:00 VRU #: 001899468 251 creature meadow ln # on house and by drive angier 27501 T/S: 04/01/2010 09:37 AM TWARD -----
R425 01	5/04/10 5/04/10	BS DA	FOUR TRADE ROUGH IN VRU #: 001920023 VOICE MESSAGE LEFT 1.Hurricane ties on kitchen rafter.2 . Strap vent At master bath. 3. Nail plate in foyer for electrical. 4.Through bolt deck bands to house. 5. Reframe ceiling over stair opening to support roof hip/valley. 6. Need engineering on change from 2- 11 7/8 to 3 9/14 LVL over kitchen 7. Need engineering on double 2x10 right rear side of house supporting wall/roof loads, and hip/valleys supported on non-load wall below. Ok to side. Do not insulate
R425 02	5/12/10 5/12/10	KS AP	FOUR TRADE ROUGH IN VRU #: 001924828 Tpole inspected. No premise number to call in, T/S: 05/12/2010 02:53 PM KSLATTUM -----
E207 01	5/12/10 5/12/10	KS AP	R*ELEC TEMP SERVICE POLE TIME: 17:00 VRU #: 001924836 T/S: 05/11/2010 01:47 PM NTART ----- No premise number to call in T/S: 05/12/2010 02:53 PM KSLATTUM -----
I129 01	5/17/10 <u>5-17-10</u>	TI <u>JABS</u>	R*INSULATION INSPECTION VRU #: 001927124

COMMENTS AND NOTES

ADDRESS : 251 CREATURE MEADOW LN SUBDIV:
 CONTRACTOR : POPE ROBERT PHONE : (919) 868-2912
 OWNER : JOHNSON LUCAS N & LYNETTE B PHONE :
 PARCEL : 04-0682- - -0216- -13-
 APPL NUMBER: 10-50023673 CP NEW RESIDENTIAL (SFD)
 DIRECTIONS : T/S: 01/26/2010 09:03 AM VBROWN ----
 OFF OF NC 55W CREATURE MEADOW LANE OR
 DRIVE. 421S, LEFT ON OLD STAGE RD,
 LEFT ON NC 55, 1/4MI CREATURE MEADOW ON
 LEFT.
 T/S: 05/24/2010 09:21 AM NTART -----P
 REMISE # 83696278

STRUCTURE: 000 000 33X57 3BDR 2.5BATH SFD WITH CRAWL

FLOOD ZONE : FLOOD ZONE X
 # BEDROOMS : 3.00 PROPOSED USE : SFD
 SEPTIC - EXISTING? : NEW TANK WATER SUPPLY : COUNTY

PERMIT: CPSF 00 CP * SFD

TYP/SQ	REQUESTED COMPLETED	INSP RESULT	DESCRIPTION RESULTS/COMMENTS
B101 01	3/16/10 3/16/10	KS AP	R*BLDG FOOTING / TEMP SVC POLE TIME: 17:00 VRU #: 001895150 T/S: 03/15/2010 01:57 PM RDCONTE ----- ELEC WILL NOT BE AVAILABLE FOR SEVERAL WEEKS. WILL CALL ASAP FOR T-POLE. FOOTING ONLY.
B103 01	3/24/10 3/24/10	KS AP	R*BLDG FOUND & TEMP SVC POLE VRU #: 001899093 VOICE MESSAGE LEFT
B105 01	3/26/10 3/26/10	BS DA	R*OPEN FLOOR VRU #: 001900651 Plan calls for a triple 2x10 girder in span on rear of house. SEE PLAN DO NOT COVER. Call to reschedule
B105 02	3/29/10 3/29/10	BS AP	R*OPEN FLOOR VRU #: 001901384 VOICE MESSAGE LEFT T/S: March 29, 2010 11:46 AM BSUTTON -----
A814 01	3/30/10 4/01/10	TW AP	ADDRESS CONFIRMATION TIME: 17:00 VRU #: 001899468 251 creature meadow ln # on house and by drive angier 27501 T/S: 04/01/2010 09:37 AM TWARD -----
R425 01	5/04/10 5/04/10	BS DA	FOUR TRADE ROUGH IN VRU #: 001920023 VOICE MESSAGE LEFT 1.Hurricane ties on kitchen rafter.2 . Strap vent At master bath. 3. Nail plate in foyer for electrical. 4.Through bolt deck bands to house. 5. Reframe ceiling over stair opening to support roof hip/valley. 6. Need engineering on change from 2- 11 7/8 to 3 9/14 LVL over kitchen 7. Need engineering on double 2x10 right rear side of house supporting wall/roof loads, and hip/valleys supported on non-load wall below. Ok to side. Do not insulate
R425 02	5/12/10 5/12/10	KS AP	FOUR TRADE ROUGH IN VRU #: 001924828 Tpole inspected. No premise number to call in, T/S: 05/12/2010 02:53 PM KSLATTUM -----
E207 01	5/12/10 5/12/10	KS AP	R*ELEC TEMP SERVICE POLE TIME: 17:00 VRU #: 001924836 T/S: 05/11/2010 01:47 PM NTART ----- No premise number to call in T/S: 05/12/2010 02:53 PM KSLATTUM ----- T/S: 05/24/2010 09:22 AM NTART -----

CONTINUED ONTO NEXT PAGE

PREPARED 5/25/10, 14:03:39
Harnett County

INSPECTION TICKET
INSPECTOR: IVR

ADDRESS : 251 CREATURE MEADOW LN
CONTRACTOR : POPE ROBERT
OWNER : JOHNSON LUCAS N & LYNETTE B
PARCEL : 04-0682- - -0216- -13-
APPL NUMBER: 10-50023673 CP NEW RESIDENTIAL (SFD)

SUBDIV:
PHONE : (919) 868-2912
PHONE :

TYP/SQ	REQUESTED COMPLETED	INSP RESULT	DESCRIPTION RESULTS/COMMENTS
I129 01	5/17/10 5/17/10	DS DA	R*INSULATION INSPECTION VRU #: 001927124 This house is leaking. The insulation is wet in several places. Remove all wet insulation, side and finish roofing, and reinstall DRY insulation. DO NOT SHEET ROCK
I129 02	5/26/10 5-26	TT AP	R*INSULATION INSPECTION VRU #: 001932564 VOICE MESSAGE LEFT

COMMENTS AND NOTES

ADDRESS : 251 CREATURE MEADOW LN
 CONTRACTOR : POPE ROBERT
 OWNER : JOHNSON LUCAS N & LYNETTE B
 PARCEL : 04-0682- - -0216- -13-
 APPL NUMBER: 10-50023673 CP NEW RESIDENTIAL (SFD)
 DIRECTIONS : T/S: 01/26/2010 09:03 AM VBROWN ----
 OFF OF NC 55W CREATURE MEADOW LANE OR
 DRIVE. 421S, LEFT ON OLD STAGE RD,
 LEFT ON NC 55, 1/4MI CREATURE MEADOW ON
 LEFT.
 T/S: 05/24/2010 09:21 AM NTART ----P
 REMISE # 83696278

SUBDIV:
 PHONE : (919) 868-2912
 PHONE :

STRUCTURE: 000 000 33X57 3BDR 2.5BATH SFD WITH CRAWL

FLOOD ZONE : FLOOD ZONE X
 # BEDROOMS : 3.00
 SEPTIC - EXISTING? : NEW TANK
 PROPOSED USE : SFD
 WATER SUPPLY : COUNTY

PERMIT: CPSF 00 CP * SFD

TYP/SQ	REQUESTED COMPLETED	INSP RESULT	DESCRIPTION RESULTS/COMMENTS
B101 01	3/16/10 3/16/10	KS AP	R*BLDG FOOTING / TEMP SVC POLE TIME: 17:00 VRU #: 001895150 T/S: 03/15/2010 01:57 PM RDCONTE ---- ELEC WILL NOT BE AVAILABLE FOR SEVERAL WEEKS. WILL CALL ASAP FOR T-POLE. FOOTING ONLY.
B103 01	3/24/10 3/24/10	KS AP	R*BLDG FOUND & TEMP SVC POLE VRU #: 001899093 VOICE MESSAGE LEFT
B105 01	3/26/10 3/26/10	BS DA	R*OPEN FLOOR VRU #: 001900651 Plan calls for a triple 2x10 girder in span on rear of house. SEE PLAN DO NOT COVER. Call to reschedule
B105 02	3/29/10 3/29/10	BS AP	R*OPEN FLOOR VRU #: 001901384 VOICE MESSAGE LEFT T/S: March 29, 2010 11:46 AM BSUTTON ----
A814 01	3/30/10 4/01/10	TW AP	ADDRESS CONFIRMATION TIME: 17:00 VRU #: 001899468 ✓ 251 creature meadow ln # on house and by drive angier 27501 T/S: 04/01/2010 09:37 AM TWARD ----
R425 01	5/04/10 5/04/10	BS DA	FOUR TRADE ROUGH IN VRU #: 001920023 VOICE MESSAGE LEFT 1.Hurricane ties on kitchen rafter.2 . Strap vent At master bath. 3. Nail plate in foyer for electrical. 4.Through bolt deck bands to house. 5. Reframe ceiling over stair opening to support roof hip/valley. 6. Need engineering on change from 2- 11 7/8 to 3 9/14 LVL over kitchen 7. Need engineering on double 2x10 right rear side of house supporting wall/roof loads, and hip/valleys supported on non-load wall below. Ok to side. Do not insulate
R425 02	5/12/10 5/12/10	KS AP	FOUR TRADE ROUGH IN VRU #: 001924828 Tpole inspected. No premise number to call in, T/S: 05/12/2010 02:53 PM KSLATTUM ----
E207 01	5/12/10 5/12/10	KS AP	R*ELEC TEMP SERVICE POLE TIME: 17:00 VRU #: 001924836 T/S: 05/11/2010 01:47 PM NTART ---- No premise number to call in T/S: 05/12/2010 02:53 PM KSLATTUM ---- T/S: 05/24/2010 09:22 AM NTART ----

CONTINUED ONTO NEXT PAGE

PREPARED 8/13/10, 14:04:02
Harnett County

INSPECTION TICKET
INSPECTOR: IVR

ADDRESS : 251 CREATURE MEADOW LN
CONTRACTOR : POPE ROBERT
OWNER : JOHNSON LUCAS N & LYNETTE B
PARCEL : 04-0682- - -0216- -13-
APPL NUMBER: 10-50023673 CP NEW RESIDENTIAL (SFD)

SUBDIV:
PHONE : (919) 868-2912
PHONE :

TYP/SQ	REQUESTED COMPLETED	INSP RESULT	DESCRIPTION RESULTS/COMMENTS
I129 01	5/17/10 5/17/10	BS DA	R*INSULATION INSPECTION VRU #: 001927124 This house is leaking. The insulation is wet in several places. Remove all wet insulation, side and finish roofing, and reinstall DRY insulation. DO NOT SHEET ROCK
I129 02	5/26/10 5/26/10	KS AP	R*INSULATION INSPECTION VRU #: 001932564 VOICE MESSAGE LEFT
H824 01	6/15/10 6/15/10	JM AP	✓ ENVIR. OPERATIONS PERMIT TIME: 17:00 VRU #: 001942010 T/S: 06/16/2010 11:24 AM SZIMMER T/S: 06/16/2010 11:24 AM SZIMMER
R429 01	8/16/10 <u>8/16/10</u>	TI <u>AAB</u>	FOUR TRADE FINAL TIME: 17:00 VRU #: 001969054 ***PLEASE CALL 1 HOUR BEFORE 919-868-2912*** T/S: 08/12/2010 04:14 PM NTART

COMMENTS AND NOTES

ADDRESS : 251 CREATURE MEADOW LN SUBDIV:
CONTRACTOR : POPE ROBERT PHONE : (919) 868-2912
OWNER : JOHNSON LUCAS N & LYNETTE B PHONE :
PARCEL : 04-0682- - -0216- -13-
APPL NUMBER: 10-50023673 CP NEW RESIDENTIAL (SFD)
DIRECTIONS : T/S: 01/26/2010 09:03 AM VBROWN ----
OFF OF NC 55W CREATURE MEADOW LANE OR
DRIVE. 421S, LEFT ON OLD STAGE RD,
LEFT ON NC 55, 1/4MI CREATURE MEADOW ON
LEFT.
T/S: 05/24/2010 09:21 AM NTART -----P
REMISE # 83696278

STRUCTURE: 000 000 33X57 3BDR 2.5BATH SFD WITH CRAWL
FLOOD ZONE : FLOOD ZONE X
BEDROOMS : 3.00 PROPOSED USE : SFD
SEPTIC - EXISTING? : NEW TANK WATER SUPPLY : COUNTY

PERMIT: CPSF 00 CP * SFD

TYP/SQ	REQUESTED COMPLETED	INSP RESULT	DESCRIPTION RESULTS/COMMENTS
B101 01	3/16/10 3/16/10	KS AP	R*BLDG FOOTING / TEMP SVC POLE TIME: 17:00 VRU #: 001895150 T/S: 03/15/2010 01:57 PM RDCONTE ----- ELEC WILL NOT BE AVAILABLE FOR SEVERAL WEEKS. WILL CALL ASAP FOR T-POLE. FOOTING ONLY.
B103 01	3/24/10 3/24/10	KS AP	R*BLDG FOUND & TEMP SVC POLE VRU #: 001899093 VOICE MESSAGE LEFT
B105 01	3/26/10 3/26/10	BS DA	R*OPEN FLOOR VRU #: 001900651 Plan calls for a triple 2x10 girder in span on rear of house. SEE PLAN DO NOT COVER. Call to reschedule
B105 02	3/29/10 3/29/10	BS AP	R*OPEN FLOOR VRU #: 001901384 VOICE MESSAGE LEFT T/S: March 29, 2010 11:46 AM BSUTTON -----
A814 01	3/30/10 4/01/10	TW AP	ADDRESS CONFIRMATION TIME: 17:00 VRU #: 001899468 ✓ 251 creature meadow ln # on house and by drive angier 27501 T/S: 04/01/2010 09:37 AM TWARD -----
R425 01	5/04/10 5/04/10	BS DA	FOUR TRADE ROUGH IN VRU #: 001920023 VOICE MESSAGE LEFT 1.Hurricane ties on kitchen rafter.2 . Strap vent At master bath. 3. Nail plate in foyer for electrical. 4.Through bolt deck bands to house. 5. Reframe ceiling over stair opening to support roof hip/valley. 6. Need engineering on change from 2- 11 7/8 to 3 9/14 LVL over kitchen 7. Need engineering on double 2x10 right rear side of house supporting wall/roof loads, and hip/valleys supported on non-load wall below. Ok to side. Do not insulate
R425 02	5/12/10 5/12/10	KS AP	FOUR TRADE ROUGH IN VRU #: 001924828 Tpole inspected. No premise number to call in, T/S: 05/12/2010 02:53 PM KSLATTUM -----
E207 01	5/12/10 5/12/10	KS AP	R*ELEC TEMP SERVICE POLE TIME: 17:00 VRU #: 001924836 T/S: 05/11/2010 01:47 PM NTART ----- No premise number to call in T/S: 05/12/2010 02:53 PM KSLATTUM ----- T/S: 05/24/2010 09:22 AM NTART -----

ADDRESS : 251 CREATURE MEADOW LN
 CONTRACTOR : POPE ROBERT
 OWNER : JOHNSON LUCAS N & LYNETTE B
 PARCEL : 04-0682- - -0216- -13-
 APPL NUMBER: 10-50023673 CP NEW RESIDENTIAL (SFD)

SUBDIV:
 PHONE : (919) 868-2912
 PHONE :

TYP/SQ	REQUESTED COMPLETED	INSP RESULT	DESCRIPTION RESULTS/COMMENTS
I129 01	5/17/10 5/17/10	BS DA	R*INSULATION INSPECTION VRU #: 001927124 This house is leaking. The insulation is wet in several places. Remove all wet insulation, side and finish roofing, and reinstall DRY insulation. DO NOT SHEET
I129 02	5/26/10 5/26/10	KS AP	R*INSULATION INSPECTION VRU #: 001932564 VOICE MESSAGE LEFT
H824 01	6/15/10 6/15/10	JM AP	✓ ENVIR. OPERATIONS PERMIT TIME: 17:00 VRU #: 001942010 T/S: 06/16/2010 11:24 AM SZIMMER ----- T/S: 06/16/2010 11:24 AM SZIMMER -----
R429 01	8/16/10 8/16/10	BS DA	FOUR TRADE FINAL TIME: 17:00 VRU #: 001969054 ***PLEASE CALL 1 HOUR BEFORE 919-868-2912*** T/S: 08/12/2010 04:14 PM NTART ----- 1. Install pipe in foundation drain, seal around pipe, and install a rock bed or screen on interior of pipe. 2. Gaspiping incomplete and untested
R429 02	8/17/10	TI	FOUR TRADE FINAL TIME: 17:00 VRU #: 001970367 T/S: 08/16/2010 12:55 PM DJOHNSON -----

COMMENTS AND NOTES

County of Harnett
Building Inspections Department
Planning Services

Certificate of Compliance: ___ Occupancy: X

Certificate issued pursuant to the requirements of North Carolina General Statute 153A-363 and Harnett County Zoning Ordinances. This certifies at the time of issuance, this structure was in compliance with the various ordinances of the County of Harnett and the North Carolina State Building Codes. For the following:

Use Classification: SFD

Permit Numbers

Name: Lucas & Lynette Johnson

Building: 10-50023673

Electrical: 10-50023673

Address: 251 Creature Meadow Lane

Insulation: 10-50023673

Angier NC 27501

Plumbing: 10-50023673

Mechanical: 10-50023673

MFG Home: NANANA

Date: 08-17-10

Building Official: BSutton