

**SOIL/SITE EVALUATION  
 for ON-SITE WASTEWATER SYSTEM**

Owner:                      Applicant:  
 Address:                      Date Evaluated:  
 Proposed Facility:                      Design Flow (.1949):  
 Location of Site:                      Property Recorded:                      Property Size:  
 Water Supply:                       Public                       Individual                       Well                       Spring                       Other  
 Evaluation Method:                       Auger Boring                       Pit                       Cut  
 Type of Wastewater:                       Sewage                       Industrial Process                       Mixed

P R O F I L E #	.1940 Landscape Position/ Slope %	Horizon Depth (in.)	SOIL MORPHOLOGY .1941		OTHER PROFILE FACTORS				Profile Class & LTAR
			.1941 Structure/ Texture	.1941 Consistence Mineralogy	.1942 Soil Wetness/ Color	.1943 Soil Depth (IN.)	.1956 Sapro Class	.1944 Restr Horiz	
1	L3 02/4	0-6"	GS	VR NS/MP					
	2-5/0	6"	MC	F1 S/P					US
2		0-16"	GS	VR NS/MP					
		16-36"	SBK SCL	F2 SS/SP					P3 .4
3		0-8"	GS	FR NS/MP					
		8"	MC	F1 VS/VP	10YR 7/2 @ 14"				US
4		0-10"	GS	VR NS/MP					
		10"	MC	F1 VS/VP	10YR 7/2 @ 14"				VS
5		0-16"	GS	VR NS/MP					
		16"	MC	FR F1 S/P	10YR 7/2 @ 22"				US

Description	Initial System	Repair System	Other Factors (.1946): Site Classification (.1948): Evaluated By: Others Present:
Available Space (.1945)			
System Type(s)			
Site LTAR			

COMMENTS: \_\_\_\_\_

<u>LANDSCAPE POSITIONS</u>	<u>GROUP</u>	<u>TEXTURES</u>	<u>.1955 LTAR</u>	<u>CONSISTENCE MOIST</u>	<u>WET</u>
R-RIDGE	I	S-SAND	1.2 - 0.8	VFR-VERY FRIABLE FR-FRIABLE	NS-NON-STICKY SS-SLIGHTLY STICKY
S-SHOULDER SLOPE		LS-LOAMY SAND			
L-LINEAR SLOPE	II	SL-SANDY LOAM	0.8 - 0.6	FI-FIRM VFI-VERY FIRM	S-STICKY VS-VERY STICKY
FS-FOOT SLOPE		L-LOAM			
N-NOSE SLOPE	III	SI-SILT	0.6 - 0.3	EFI-EXTREMELY FIRM	NP-NON-PLASTIC SP-SLIGHTLY STICKY P-PLASTIC VP-VERY PLASTIC
H-HEAD SLOPE		SIL-SILT LOAM			
CC-CONCLAVE SLOPE		CL-CLAY LOAM			
CV-CONVEX SLOPE		SCL-SANDY CLAY LOAM			
T-TERRACE	IV	SIC-SILTY CLAY	0.4 - 0.1		
FP-FLOOD PLAN		C-CLAY			
		SC-SANDY CLAY			

STRUCTURE  
 SG-SINGLE GRAIN  
 M- MASSIVE  
 CR-CRUMB  
 GR-GRANULAR  
 SBK-SUBANGULAR BLOCKY  
 ABK-ANGULAR BLOCKY  
 PL-PLATY  
 PR-PRISMATIC

MINERALOGY  
 SLIGHTLY EXPANSIVE  
 EXPANSIVE

Show profile locations and other site features (dimensions, references or benchmark, and North)

A large grid for drawing site features and profile locations. The grid is approximately 20 units wide and 25 units high. It is intended for showing profile locations and other site features, including dimensions, references, benchmarks, and North.



0.58 AC  
 259.14'  
 S 43°40'33"E

3  
 0.75 AC.

1.43 AC.

6

128.45'E  
 125.03'  
 (PUBLIC)  
 90.04'  
 67.28'  
 S 46°44'38"E  
 89.61'  
 C3  
 L3  
 C5

WINGED FOOT DR. 50' R/W  
 C11  
 L1  
 C6  
 L8  
 C12  
 L2  
 C13  
 C17  
 C18

S 06°28'18"W 387.35'

7

1.56 AC.

Walnut Grove  
 lot 8

160' FRONT SETBACK

#	C	L
1	0	50
2	8	60
3	0	50
4	8	50
5	0	50
6	8	25
7	0	25

Typical Soils  
 0-18" SL  
 18-24" SCLAE  
 .3 LTAR  
 Initial - 300' accepted 25% Reduction  
 Repair - Drip Irrigation without Pretreatment

N 10°56'17"E

454.83'

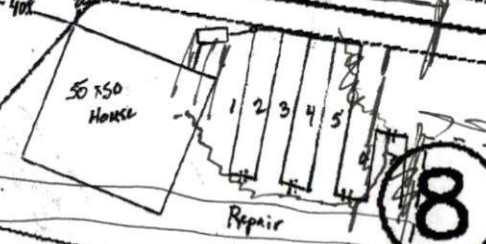

8

1.30 AC.

1"=60'

533.00'

S 14°46'55"W

9

1.41 AC.

N 21°27'20"E  
 598.00'



205.51'  
 180.64'  
 132.86'  
 E 1149.95'





