

-----

ADDRESS : 260 STRIKE EAGLE DR SUBDIV: PATTONS POINT  
 CONTRACTOR : BILL CLARK HOMES LLC PHONE : (252) 355-5805  
 OWNER : BILL CLARK HOMES OF FAY PHONE : (910) 426-2898  
 PARCEL : 03-9597- - -0039- -90-  
 APPL NUMBER: 10-50023522 CP NEW RESIDENTIAL (SFD)  
 DIRECTIONS : T/S: 01/05/2010 11:49 AM JBROCK ----  
 27 TOWARDS 87 TURN LEFT ON TINGEN RD  
 TURN LEFT INTO S/D ON STRIKE EAGLE DR  
 LOT 96

-----

STRUCTURE: 000 000 52X46 3BDR SLAB W/ GARAGE  
 FLOOD ZONE : FLOOD ZONE X  
 # BEDROOMS : 3.00 PROPOSED USE : SFD  
 SEPTIC - EXISTING? : NEW TANK WATER SUPPLY : COUNTY

-----

PERMIT: CPSF 00 CP \* SFD

TYP/SQ	REQUESTED COMPLETED	INSP RESULT	DESCRIPTION RESULTS/COMMENTS
B101 01	3/12/10 <u>3-12-10</u>	TI <u>AP-MR</u>	R*BLDG FOOTING / TEMP SVC POLE TIME: 17:00 VRU #: 001894104 T/S: 03/11/2010 12:01 PM RDCONTE ----- *****REQUESTING AM ASAP*****

----- COMMENTS AND NOTES -----

-----  
ADDRESS : 260 STRIKE EAGLE DR SUBDIV: PATTONS POINT  
CONTRACTOR : BILL CLARK HOMES LLC PHONE : (252) 355-5805  
OWNER : BILL CLARK HOMES OF FAY PHONE : (910) 426-2898  
PARCEL : 03-9597- - -0039- -90-  
APPL NUMBER: 10-50023522 CP NEW RESIDENTIAL (SFD)  
DIRECTIONS : T/S: 01/05/2010 11:49 AM JBROCK ----  
27 TOWARDS 87 TURN LEFT ON TINGEN RD  
TURN LEFT INTO S/D ON STRIKE EAGLE DR  
LOT 96  
-----

**STRUCTURE: 000 000 52X46 3BDR SLAB W/ GARAGE**

FLOOD ZONE : FLOOD ZONE X  
# BEDROOMS : 3.00 PROPOSED USE : SFD  
SEPTIC - EXISTING? : NEW TANK WATER SUPPLY : COUNTY  
-----

**PERMIT: CPSF 00 CP \* SFD**

TYP/SQ	REQUESTED COMPLETED	INSP RESULT	DESCRIPTION RESULTS/COMMENTS
B101 01	3/12/10 3/12/10	MR AP	R*BLDG FOOTING / TEMP SVC POLE TIME: 17:00 VRU #: 001894104 T/S: 03/11/2010 12:01 PM RDCONTE ----- ****REQUESTING AM ASAP**** T/S: 03/12/2010 01:38 PM MREARIC -----
A814 01	3/22/10	TI	ADDRESS CONFIRMATION VRU #: 001897891
B103 01	3/22/10 <u>3-22-10</u>	TI <u>AP-MR</u>	R*BLDG FOUND & TEMP SVC POLE VRU #: 001897909

----- COMMENTS AND NOTES -----

-----  
ADDRESS : 260 STRIKE EAGLE DR SUBDIV: PATTONS POINT  
CONTRACTOR : BILL CLARK HOMES LLC PHONE : (252) 355-5805  
OWNER : BILL CLARK HOMES OF FAY PHONE : (910) 426-2898  
PARCEL : 03-9597- - -0039- -90-  
APPL NUMBER: 10-50023522 CP NEW RESIDENTIAL (SFD)  
DIRECTIONS : T/S: 01/05/2010 11:49 AM JBROCK -----  
27 TOWARDS 87 TURN LEFT ON TINGEN RD  
TURN LEFT INTO S/D ON STRIKE EAGLE DR  
LOT 96  
-----

STRUCTURE: 000 000 52X46 3BDR SLAB W/ GARAGE  
FLOOD ZONE : FLOOD ZONE X  
# BEDROOMS : 3.00 PROPOSED USE : SFD  
SEPTIC - EXISTING? : NEW TANK WATER SUPPLY : COUNTY  
-----

PERMIT: CPSF 00 CP \* SFD

TYP/SQ	REQUESTED COMPLETED	INSP RESULT	DESCRIPTION RESULTS/COMMENTS
B101 01	3/12/10	MR	R*BLDG FOOTING / TEMP SVC POLE TIME: 17:00 VRU #: 001894104
	3/12/10	AP	T/S: 03/11/2010 12:01 PM RDCONTE ----- ****REQUESTING AM ASAP**** T/S: 03/12/2010 01:38 PM MREARIC -----
A814 01	3/22/10	TI	ADDRESS CONFIRMATION VRU #: 001897891
B103 01	3/22/10	MR	R*BLDG FOUND & TEMP SVC POLE VRU #: 001897909
	3/22/10	AP	T/S: 03/22/2010 12:46 PM MREARIC -----
P309 01	3/25/10	TI	R*PLUMB UNDER SLAB VRU #: 001899764
	<u>3-25-10</u>	<u>AP-MR</u>	

----- COMMENTS AND NOTES -----

P309 01	3/25/10	MR	R*PLUMB UNDER SLAB VRU #: 001899764
	3/25/10	AP	T/S: 03/25/2010 01:45 PM MREARIC -----
B111 01	3/26/10	TI	R*BLDG SLAB INSP VRU #: 001900688
	<u>3-26-10</u>	<u>CA-MR</u>	

----- COMMENTS AND NOTES -----

ADDRESS : 260 STRIKE EAGLE DR SUBDIV: PATTONS POINT  
 CONTRACTOR : BILL CLARK HOMES LLC PHONE : (252) 355-5805  
 OWNER : BILL CLARK HOMES OF FAY PHONE : (910) 426-2898  
 PARCEL : 03-9597- - -0039- -90-  
 APPL NUMBER: 10-50023522 CP NEW RESIDENTIAL (SFD)  
 DIRECTIONS : T/S: 01/05/2010 11:49 AM JBROCK -----  
 27 TOWARDS 87 TURN LEFT ON TINGEN RD  
 TURN LEFT INTO S/D ON STRIKE EAGLE DR  
 LOT 96

STRUCTURE: 000 000 52X46 3BDR SLAB W/ GARAGE

FLOOD ZONE : FLOOD ZONE X  
 # BEDROOMS : 3.00 PROPOSED USE : SFD  
 SEPTIC - EXISTING? : NEW TANK WATER SUPPLY : COUNTY

PERMIT: CPSF 00 CP \* SFD

TYP/SQ	REQUESTED COMPLETED	INSP RESULT	DESCRIPTION RESULTS/COMMENTS
B101 01	3/12/10	MR	R*BLDG FOOTING / TEMP SVC POLE TIME: 17:00 VRU #: 001894104
	3/12/10	AP	T/S: 03/11/2010 12:01 PM RDCONTE ----- ****REQUESTING AM ASAP**** T/S: 03/12/2010 01:38 PM MREARIC -----
A814 01	3/22/10	TI	ADDRESS CONFIRMATION VRU #: 001897891
B103 01	3/22/10	MR	R*BLDG FOUND & TEMP SVC POLE VRU #: 001897909
	3/22/10	AP	T/S: 03/22/2010 12:46 PM MREARIC -----
P309 01	3/25/10	MR	R*PLUMB UNDER SLAB VRU #: 001899764
	3/25/10	AP	T/S: 03/25/2010 01:45 PM MREARIC -----
B111 01	3/26/10	RD	R*BLDG SLAB INSP VRU #: 001900688
	3/26/10	CA	T/S: 03/26/2010 11:14 AM RDCONTE ----- CUSTOMER CANCELED
B111 02	3/29/10	TI	R*BLDG SLAB INSP TIME: 17:00 VRU #: 001901172
	<del>3/29/10</del>	<del>AP-MR</del>	T/S: 03/26/2010 11:15 AM RDCONTE ----- <i>AP-MR 3/29/10</i>
----- COMMENTS AND NOTES -----			

P309 01	3/25/10	MR	R*PLUMB UNDER SLAB VRU #: 001899764
	3/25/10	AP	T/S: 03/25/2010 01:45 PM MREARIC -----
B111 01	3/26/10	RD	R*BLDG SLAB INSP VRU #: 001900688
	3/26/10	CA	T/S: 03/26/2010 11:14 AM RDCONTE ----- CUSTOMER CANCELED
B111 02	3/29/10	MR	R*BLDG SLAB INSP TIME: 17:00 VRU #: 001901172
	3/29/10	AP	T/S: 03/26/2010 11:15 AM RDCONTE ----- T/S: 03/29/2010 12:27 PM MREARIC -----
R425 01	5/03/10	TI	FOUR TRADE ROUGH IN VRU #: 001918964
	<del>5-3-10</del>	<del>DA-MR</del>	<i>5-3-10 DA-MR</i>

----- COMMENTS AND NOTES -----

ADDRESS : 260 STRIKE EAGLE DR SUBDIV: PATTONS POINT  
 CONTRACTOR : BILL CLARK HOMES LLC PHONE : (252) 355-5805  
 OWNER : BILL CLARK HOMES OF FAY PHONE : (910) 426-2898  
 PARCEL : 03-9597- - -0039- -90-  
 APPL NUMBER: 10-50023522 CP NEW RESIDENTIAL (SFD)  
 DIRECTIONS : T/S: 01/05/2010 11:49 AM JBROCK ----  
 27 TOWARDS 87 TURN LEFT ON TINGEN RD  
 TURN LEFT INTO S/D ON STRIKE EAGLE DR  
 LOT 96

**STRUCTURE: 000 000 52X46 3BDR SLAB W/ GARAGE**

FLOOD ZONE : FLOOD ZONE X  
 # BEDROOMS : 3.00 PROPOSED USE : SFD  
 SEPTIC - EXISTING? : NEW TANK WATER SUPPLY : COUNTY

**PERMIT: CPSF 00 CP \* SFD**

TYP/SQ	REQUESTED COMPLETED	INSP RESULT	DESCRIPTION RESULTS/COMMENTS
B101 01	3/12/10 3/12/10	MR AP	R*BLDG FOOTING / TEMP SVC POLE TIME: 17:00 VRU #: 001894104 T/S: 03/11/2010 12:01 PM RDCONTE ----- ****REQUESTING AM ASAP**** T/S: 03/12/2010 01:38 PM MREARIC -----
B103 01	3/22/10 3/22/10	MR AP	R*BLDG FOUND & TEMP SVC POLE VRU #: 001897909 T/S: 03/22/2010 12:46 PM MREARIC -----
A814 01	3/22/10 3/30/10	TW AP	ADDRESS CONFIRMATION TIME: 17:00 VRU #: 001897891 260 STRIKE EAGLE DR LOT 96 ----- BROADWAY 27505 T/S: 03/30/2010 03:55 PM TWARD -----
P309 01	3/25/10 3/25/10	MR AP	R*PLUMB UNDER SLAB VRU #: 001899764 T/S: 03/25/2010 01:45 PM MREARIC -----
B111 01	3/26/10 3/26/10	RD CA	R*BLDG SLAB INSP VRU #: 001900688 T/S: 03/26/2010 11:14 AM RDCONTE ----- CUSTOMER CANCELED
B111 02	3/29/10 3/29/10	MR AP	R*BLDG SLAB INSP TIME: 17:00 VRU #: 001901172 T/S: 03/26/2010 11:15 AM RDCONTE ----- T/S: 03/29/2010 12:27 PM MREARIC -----
R425 01	5/03/10 5/03/10	MR DA	FOUR TRADE ROUGH IN VRU #: 001918964 T/S: 05/03/2010 11:49 AM MREARIC ----- fireblock at garage wall outlet spscing- rear bedroom nail guard over dryer letter on truss alteration
R425 02	5/05/10	TI	FOUR TRADE ROUGH IN VRU #: 001920529
I129 01	<del>5-5-10</del> 5/05/10	<del>DA-MR</del> TI	R*INSULATION INSPECTION TIME: 17:00 VRU #: 001920537 T/S: 05/04/2010 11:38 AM NTART -----

COMMENTS AND NOTES

# **HARNETT COUNTY**

Building Inspections Dept.

108 E. Front St.

Lillington, NC 27546

910-893-7525

**DO NOT REMOVE**

DATE: 05-05-10

PERMIT # 10-50023522

ADDRESS: 260 strike eagle

## **VIOLATIONS:**

1. Provide insulation under the plywood over the main bath
2. Provide for insulation retention at all wall lines with un-insulated areas
3. Provide fireblocking at garage wall ceiling area
4. Wrap insulation around bonus room floor / wall junction

Harnett County Building Department

Mike Rearic . cell# (910) 984- 4772

# ITW Building Components Group, Inc.

1950 Marley Drive Haines City, FL 33844  
Page 1 of 1 Document ID: IU0B6680Z1322161120

Truss Fabricator: **R&D Thiel dba Carpenter Contractors of America**  
Job Identification: **REPAIR / 35748-101**  
Truss Count: **1**  
Model Code: **IRC**  
Truss Criteria: **IRC2006/TPI-2002(STD)**  
Engineering Software: **Alpine Software, Version 9.02.**  
Minimum Design Loads: **Roof - 40.0 PSF @ 1.15 Duration**  
**Floor - N/A**  
**Wind - 100 MPH ASCE 7-05 -Closed**

Notes:

- Determination as to the suitability of these truss components for the structure is the responsibility of the building designer/engineer of record, as defined in ANSI/TPI 1**
- As shown on attached drawings; the drawing number is preceded by: HCUSR6680**

Details: -

Seal Date: 03/22/2010

-Truss Design Engineer-  
Doug Fleming

1950 Marley Drive  
Haines City, FL 33844

#	Ref	Description	Drawing#	Date
1	21839--B3		10081117	03/22/10

(35748-101 BIR38 - B3)

THIS DWG PREPARED FROM COMPUTER INPUT (LOADS & DIMENSIONS) SUBMITTED BY TRUSS MFR.

This truss is repaired to stub the right end by 3.5" into a hanger bearing as shown.

Refer to drawing R6680 10036016 for plates and other data not given here.

Repair(s) must comply with Alpine designs & specifications

Shore Truss and any supported spans in proper position as repair is being made.

**++ CAREFULLY REMOVE UNWANTED PORTION OF TRUSS. REMAINING PORTIONS OF TRUSS AND ALPINE PLATES MUST REMAIN INTACT & FREE FROM DAMAGE.**

+ FIELD APPLIED 2X4 SP #2 (OR BETTER) NEW MEMBER. CUT TO FIT TIGHT IN PLANE OF TRUSS.

\*\* (2) NEW 3/4"XSIZE SHOWN) TRIMMED TO FIT APA SPAN RATED 48/24 SHEATHING (PLYWOOD OR OSB). ATTACH ONE GUSSET TO EACH FACE OF THE TRUSS WITH 2 ROWS OF 0.113"X2.0" NAILS SPACED 3" OC PER ROW, STAGGERED THROUGHOUT ALL MEMBERS, WITHOUT SPLITTING THE LUMBER.

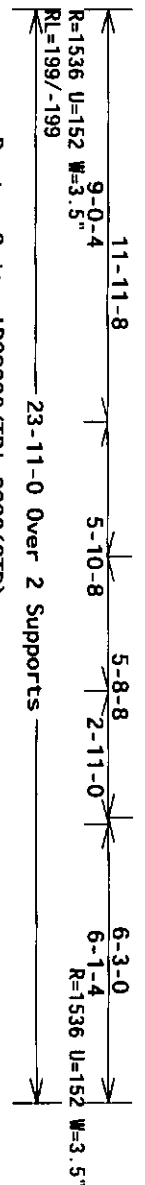
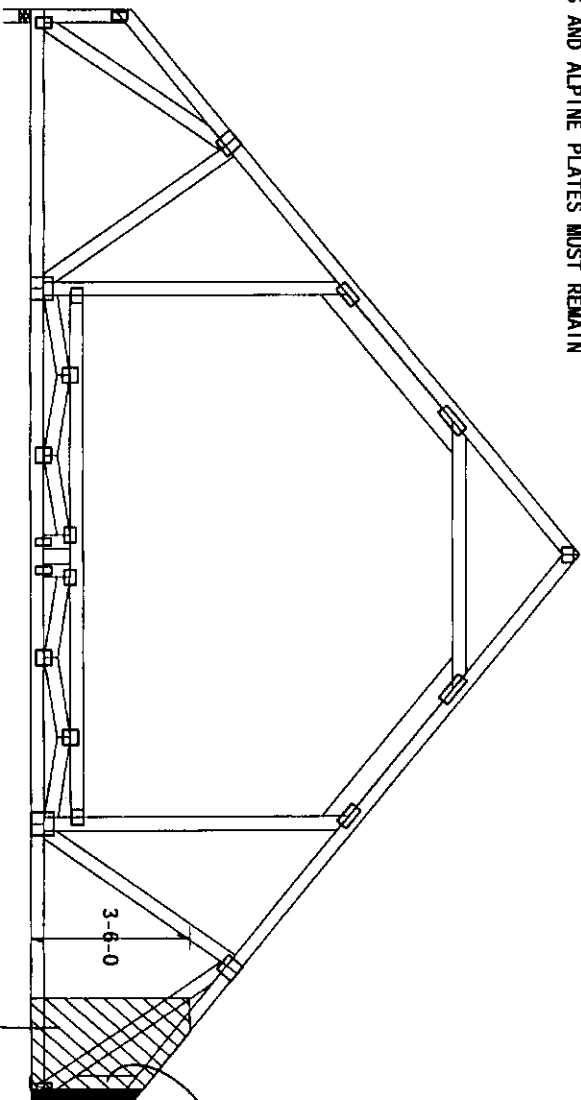

PLT TYP. Wave

Design Crit: IRC2006/TPI-2002(STD)  
FT/RT=0%(0%)/0(0)

9.02.00.0501.10

QTY: 1

Scale = .25"/Ft.

TRUSS REPAIR

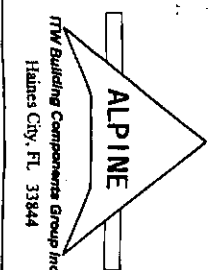

DAMAGED TRUSSES MUST BE CAREFULLY EVALUATED TO DETERMINE THE EXTENT OF DAMAGE AND THE FEASIBILITY OF REPAIR. IN SOME CASES THE PRUDENT SOLUTION IS TO SCRAP THE DAMAGED TRUSSES AND REBUILD. INTERNAL WOOD FIBER DAMAGE AND EXCESSIVE CONNECTION STRESS FROM MEMOIRS OR SHOCK CANNOT BE READILY DETECTED. THEREFORE, IT IS VITAL THAT THE TRUSS FABRICATOR AND BUILDING CONTRACTOR CONSIDER THE CAUSE OF THE DAMAGE IN THEIR DECISION WHETHER TO REPAIR OR REBUILD.

REPAIR WORK SHOWN ON THIS DRAWING APPLIES ONLY TO THOSE SECTIONS OF THE TRUSS REPORTED BY THE TRUSS MANUFACTURER TO HAVE BEEN DAMAGED. A QUALIFIED THIRD PARTY INSPECTOR SHALL CHECK TRUSSES TO DETERMINE THE EXTENT OF ANY FURTHER DAMAGE. IF ANY, AND VERIFY THAT REPAIRS HAVE BEEN PERFORMED AS INDICATED ON THIS DRAWING.

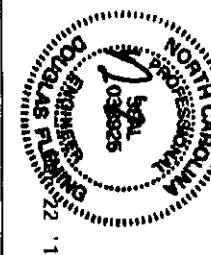

TC LL	20.0 PSF	REF	R6680-21839
TC DL	10.0 PSF	DATE	03/22/10
BC DL	10.0 PSF	DRW	HCSUR6680 10081117
BC LL	0.0 PSF	HC-ENG	DF/DF
TOT. LD.	40.0 PSF	SEQN-	218101
DUR. FAC.	1.15	FROM	EZC
SPACING	24.0"	JREF-	1U0B6680Z13



ADDRESS : 260 STRIKE EAGLE DR SUBDIV: PATTONS POINT  
 CONTRACTOR : BILL CLARK HOMES LLC PHONE : (252) 355-5805  
 OWNER : BILL CLARK HOMES OF FAY PHONE : (910) 426-2898  
 PARCEL : 03-9597- - -0039- -90-  
 APPL NUMBER: 10-50023522 CP NEW RESIDENTIAL (SFD)  
 DIRECTIONS : T/S: 01/05/2010 11:49 AM JBROCK ----  
 27 TOWARDS 87 TURN LEFT ON TINGEN RD  
 TURN LEFT INTO S/D ON STRIKE EAGLE DR  
 LOT 96

**STRUCTURE: 000 000 52X46 3BDR SLAB W/ GARAGE**

FLOOD ZONE : FLOOD ZONE X  
 # BEDROOMS : 3.00 PROPOSED USE : SFD  
 SEPTIC - EXISTING? : NEW TANK WATER SUPPLY : COUNTY

**PERMIT: CPSF 00 CP \* SFD**

TYP/SQ	REQUESTED COMPLETED	INSP RESULT	DESCRIPTION RESULTS/COMMENTS
B101 01	3/12/10 3/12/10	MR AP	R*BLDG FOOTING / TEMP SVC POLE TIME: 17:00 VRU #: 001894104 T/S: 03/11/2010 12:01 PM RDCONTE ----- ***REQUESTING AM ASAP*** T/S: 03/12/2010 01:38 PM MREARIC -----
B103 01	3/22/10 3/22/10	MR AP	R*BLDG FOUND & TEMP SVC POLE VRU #: 001897909 T/S: 03/22/2010 12:46 PM MREARIC -----
A814 01	3/22/10 3/30/10	TW AP	ADDRESS CONFIRMATION TIME: 17:00 VRU #: 001897891 260 STRIKE EAGLE DR LOT 96 ----- BROADWAY 27505 T/S: 03/30/2010 03:55 PM TWARD -----
P309 01	3/25/10 3/25/10	MR AP	R*PLUMB UNDER SLAB VRU #: 001899764 T/S: 03/25/2010 01:45 PM MREARIC -----
B111 01	3/26/10 3/26/10	RD CA	R*BLDG SLAB INSP VRU #: 001900688 T/S: 03/26/2010 11:14 AM RDCONTE ----- CUSTOMER CANCELED
B111 02	3/29/10 3/29/10	MR AP	R*BLDG SLAB INSP TIME: 17:00 VRU #: 001901172 T/S: 03/26/2010 11:15 AM RDCONTE ----- T/S: 03/29/2010 12:27 PM MREARIC -----
R425 01	5/03/10 5/03/10	MR DA	FOUR TRADE ROUGH IN VRU #: 001918964 T/S: 05/03/2010 11:49 AM MREARIC ----- fireblock at garage wall outlet spscing- rear bedroom nail guard over dryer letter on truss alteration
R425 02	5/05/10 5/05/10	MR DA	FOUR TRADE ROUGH IN VRU #: 001920529 T/S: 05/05/2010 01:03 PM NTART ----- T/S: 05/05/2010 01:12 PM MREARIC ----- insulate under plywood over main bath 2. provide insulation retention at all wall lines with un-insulated spaces 3. provide fireblocking at garage/ bedroom wall 4. wrap insulation around the bonus room floor/wall junction
I129 01	5/05/10 5/05/10	MR DA	R*INSULATION INSPECTION TIME: 17:00 VRU #: 001920537 T/S: 05/04/2010 11:38 AM NTART ----- T/S: 05/05/2010 01:02 PM NTART -----
I129 02	5/06/10 <u>5-6-10</u>	TI <u>AP-MF</u>	R*INSULATION INSPECTION VRU #: 001921345

PREPARED 5/05/10, 13:58:24  
Harnett County

INSPECTION TICKET  
INSPECTOR: IVR

PAGE 29  
DATE 5/06/10

-----  
ADDRESS . . : 260 STRIKE EAGLE DR SUBDIV: PATTONS POINT  
CONTRACTOR : BILL CLARK HOMES LLC PHONE : (252) 355-5805  
OWNER . . . : BILL CLARK HOMES OF FAY PHONE : (910) 426-2898  
PARCEL . . . : 03-9597- - -0039- -90-  
APPL NUMBER: 10-50023522 CP NEW RESIDENTIAL (SFD)  
-----

TYP/SQ	REQUESTED COMPLETED	INSP RESULT	DESCRIPTION RESULTS/COMMENTS
R425 03	5/06/10 <u>5-6-10</u>	TI <u>AP-MR</u>	FOUR TRADE ROUGH IN VRU #: 001921337

----- COMMENTS AND NOTES -----

-----  
 ADDRESS : 260 STRIKE EAGLE DR SUBDIV: PATTONS POINT  
 CONTRACTOR : BILL CLARK HOMES LLC PHONE : (252) 355-5805  
 OWNER : BILL CLARK HOMES OF FAY PHONE : (910) 426-2898  
 PARCEL : 03-9597- - -0039- -90-  
 APPL NUMBER: 10-50023522 CP NEW RESIDENTIAL (SFD)  
 DIRECTIONS : T/S: 01/05/2010 11:49 AM JBROCK ----  
 27 TOWARDS 87 TURN LEFT ON TINGEN RD  
 TURN LEFT INTO S/D ON STRIKE EAGLE DR  
 LOT 96  
 -----

**STRUCTURE: 000 000 52X46 3BDR SLAB W/ GARAGE**

FLOOD ZONE : FLOOD ZONE X  
 # BEDROOMS : 3.00 PROPOSED USE : SFD  
 SEPTIC - EXISTING? : NEW TANK WATER SUPPLY : COUNTY  
 -----

**PERMIT: CPSF 00 CP \* SFD**

TYP/SQ	REQUESTED COMPLETED	INSP RESULT	DESCRIPTION RESULTS/COMMENTS
B101 01	3/12/10 3/12/10	MR AP	R*BLDG FOOTING / TEMP SVC POLE TIME: 17:00 VRU #: 001894104 T/S: 03/11/2010 12:01 PM RDCONTE ----- ****REQUESTING AM ASAP**** T/S: 03/12/2010 01:38 PM MREARIC -----
B103 01	3/22/10 3/22/10	MR AP	R*BLDG FOUND & TEMP SVC POLE VRU #: 001897909 T/S: 03/22/2010 12:46 PM MREARIC -----
A814 01	3/22/10 3/30/10	TW AP	ADDRESS CONFIRMATION TIME: 17:00 VRU #: 001897891 ✓ 260 STRIKE EAGLE DR LOT 96 ----- BROADWAY 27505 T/S: 03/30/2010 03:55 PM TWARD -----
P309 01	3/25/10 3/25/10	MR AP	R*PLUMB UNDER SLAB VRU #: 001899764 T/S: 03/25/2010 01:45 PM MREARIC -----
B111 01	3/26/10 3/26/10	RD CA	R*BLDG SLAB INSP VRU #: 001900688 T/S: 03/26/2010 11:14 AM RDCONTE ----- CUSTOMER CANCELED
B111 02	3/29/10 3/29/10	MR AP	R*BLDG SLAB INSP TIME: 17:00 VRU #: 001901172 T/S: 03/26/2010 11:15 AM RDCONTE ----- T/S: 03/29/2010 12:27 PM MREARIC -----
R425 01	5/03/10 5/03/10	MR DA	FOUR TRADE ROUGH IN VRU #: 001918964 T/S: 05/03/2010 11:49 AM MREARIC ----- fireblock at garage wall outlet spscing- rear bedroom nail guard over dryer letter on truss alteration
R425 02	5/05/10 5/05/10	MR DA	FOUR TRADE ROUGH IN VRU #: 001920529 T/S: 05/05/2010 01:03 PM NTART ----- T/S: 05/05/2010 01:12 PM MREARIC ----- insulate under plywood over main bath 2. provide insulation retention at all wall lines with un-insulated spaces 3. provide fireblocking at garage/ bedroom wall 4. wrap insulation around the bonus room floor/wall junction
I129 01	5/05/10 5/05/10	MR DA	R*INSULATION INSPECTION TIME: 17:00 VRU #: 001920537 T/S: 05/04/2010 11:38 AM NTART ----- T/S: 05/05/2010 01:02 PM NTART -----
I129 02	5/06/10 5/06/10	MR AP	R*INSULATION INSPECTION VRU #: 001921345 T/S: 05/06/2010 01:04 PM MREARIC -----

PREPARED 7/20/10, 13:59:35  
Harnett County

INSPECTION TICKET  
INSPECTOR: IVR

PAGE 8  
DATE 7/21/10

-----  
ADDRESS . : 260 STRIKE EAGLE DR SUBDIV: PATTONS POINT  
CONTRACTOR : BILL CLARK HOMES LLC PHONE : (252) 355-5805  
OWNER . . : BILL CLARK HOMES OF FAY PHONE : (910) 426-2898  
PARCEL . . : 03-9597- - -0039- -90-  
APPL NUMBER: 10-50023522 CP NEW RESIDENTIAL (SFD)  
-----

TYP/SQ	REQUESTED COMPLETED	INSP RESULT	DESCRIPTION RESULTS/COMMENTS
R425 03	5/06/10	MR	FOUR TRADE ROUGH IN VRU #: 001921337
	5/06/10	AP	T/S: 05/06/2010 01:04 PM MREARIC -----
R429 01	7/21/10	TI	FOUR TRADE FINAL VRU #: 001957208
	<u>7-21-10</u>	<u>AP-MR</u>	

----- COMMENTS AND NOTES -----

County of Harnett  
Building Inspections Department  
Planning Services

Certificate of Compliance: x Occupancy: x

Certificate issued pursuant to the requirements of North Carolina General Statute 153A-363 and Harnett County Zoning Ordinances. This certifies at the time of issuance, this structure was in compliance with the various ordinances of the County of Harnett and the North Carolina State Building Codes. For the following:

Use Classification: R-3

Permit Numbers

Name: Bill Clark Homes of Fayetteville

Building: 10-50023522

Electrical: "

Address: \_\_\_\_\_

Insulation: "

260 Strike Eagle Dr.

Plumbing: "

Mechanical: "

MFG Home: \_\_\_\_\_

Date: 7-21-10

Building Official: T. Michael Ream