

HTE# 04-5-23284

Harnett County Department of Public Health

25804

Improvement Permit

A building permit cannot be issued with only an Improvement Permit

ISSUED TO: Jeff Lucas PROPERTY LOCATION: Ponderosa Rd.
 NEW REPAIR EXPANSION SUBDIVISION: Carolina Seaw LOT # 32
 Type of Structure: SFD 56x52 Site Improvements required prior to Construction Authorization Issuance:
 Proposed Wastewater System Type: Conventional
 Projected Daily Flow: 480 GPD
 Number of bedrooms: 4 Number of Occupants: 8 max
 Basement Yes No
 Pump Required: Yes No May be required based on final location and elevations of facilities
 Type of Water Supply: Community Public Well Distance from well _____ feet Permit valid for: Five years
 Permit conditions: _____ No expiration

Authorized State Agent: Bryan McLean, RCHS Date: 11/30/2009 SEE ATTACHED SITE SKETCH
 The issuance of this permit by the Health Department in no way guarantees the issuance of other permits. The permit holder is responsible for checking with appropriate governing bodies in meeting their requirements. This site is subject to revocation if the site plan, plat, or the intended use changes. The Improvement Permit shall not be affected by a change in ownership of the site. This permit is subject to compliance with the provisions of the Laws and Rules for Sewage Treatment and Disposal and to conditions of this permit.

Construction Authorization

(Required for Building Permit)

The construction and installation requirements of Rules .1950, .1952, .1954, .1955, .1956, .1957, .1958, and .1959 are incorporated by references into this permit and shall be met. Systems shall be installed in accordance with the attached system layout.

ISSUED TO: Jeff Lucas PROPERTY LOCATION: Ponderosa Rd.
 SUBDIVISION: Carolina Seaw LOT # 32
 Facility Type: SFD New Expansion Repair
 Basement? Yes No Basement Fixtures? Yes No
 Type of Wastewater System** Conventional (Initial) Wastewater Flow: 480 GPD
 (See note below, if applicable) 25% Reduction System (Repair)

Installation Requirements/Conditions
 Septic Tank Size 1000 gallons Number of trenches 3
 Pump Tank Size _____ gallons Exact length of each trench 67 feet Trench Spacing: 9 Feet on Center
 Trenches shall be installed on contour at a Soil Cover: 12 inches
 Maximum Trench Depth of: 24 inches (Maximum soil cover shall not exceed 36" above the trench bottom)
 (Trench bottoms shall be level to +/-1/4" in all directions)
 Pump Requirements: _____ ft. TDH vs. _____ GPM Aggregate Depth: 6 inches below pipe
2 inches above pipe
12 inches total
 Conditions: Permit based on soils consultants proposal. Rerun drain lines on contour. No utilities allowed in system or repair areas. Water line must be 10ft. from any part of septic system.

**If applicable: I understand the system type specified is different from the type specified on the application. I accept the specifications of this permit.
 Owner/Legal Representative Signature: _____ Date: _____

This Construction Authorization is subject to revocation if the site plan, plat, or the intended use changes. The Construction Authorization shall not be transferred when there is a change in ownership of the site. This Construction Authorization is subject to compliance with the provisions of the Laws and Rules for Sewage Treatment and Disposal and to the conditions of this permit. SEE ATTACHED SITE SKETCH

Authorized State Agent: Bryan McLean, RCHS Date: 11/30/2009
 Construction Authorization Expiration Date: 11/30/2014

HTE# 09-5-23284

Permit # 25804

Harnett County Department of Public Health Site Sketch

ISSUED TO: Jeff Lucas

PROPERTY LOCATION: Ponderosa Rd.

SUBDIVISION Carolina Meadows

LOT # 32

Authorized State Agent: Bryan McSwain REHS

Date: 11/30/2009

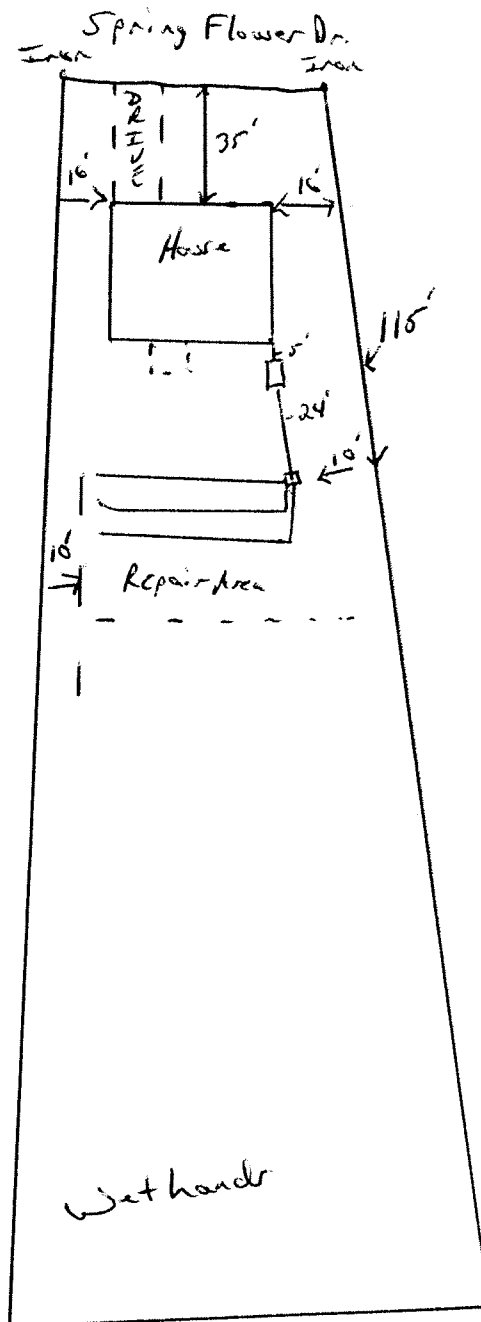

SOUTHEASTERN SOIL & ENVIRONMENTAL ASSOC, INC.

PROPOSED SUBSURFACE WASTE DISPOSAL SYSTEM DETAIL SHEET

SUBDIVISION Caroline Springs

LOT 32

INITIAL SYSTEM CONVENTIONAL

REPAIR Approved 1/13/09

DISTRIBUTION D-box

DISTRIBUTION D-box

BENCHMARK 100.0

LOCATION Top of elec box

NO. BEDROOMS 4

pad 31/32

proposed LTR = 0.8 gal/ft²

LINE FLAG COLOR ELEVATION ACTUAL LENGTH

Initial

LINE	FLAG COLOR	ELEVATION	ACTUAL LENGTH
1	R	90.00	67'
2	W	89.34	67'
3	N	88.50	67'
			<u>201'</u>
4	W	87.67	100'
5	N	86.84	100'
			<u>200'</u>

BY M GAY

DATE 08/2009

*some washed sand grains
30-42" unmatte
underneath*

Typ Profile
0-48 15/16 (VF, w-)
C 2 > 48"

Southeastern Soil & Environmental Associates, Inc.

P.O. Box 9321
Fayetteville, NC 28311
Phone/Fax (910) 822-4540
Email mike@southeasternsoil.com

CAROLINA SEASONS

LOT 32

PROPOSED SEPTIC

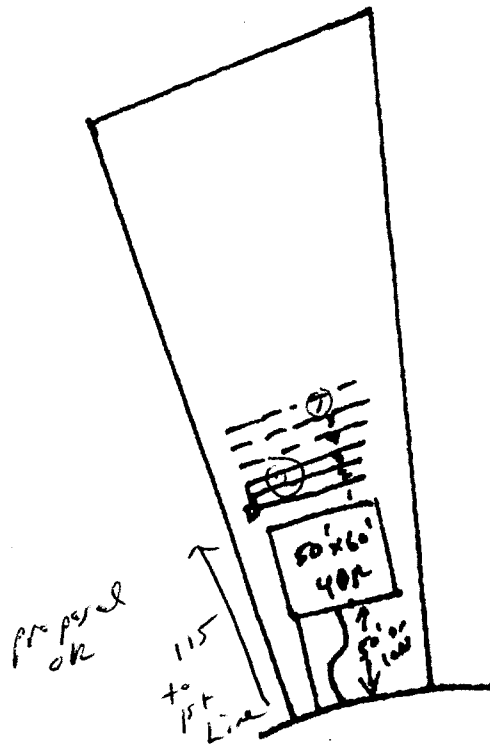

1" = 100'