

Initial Application Date: 8.26.09

Application # 09.50022720

COUNTY OF HARNETT LAND USE APPLICATION
Central Permitting 108 E. Front Street, Lillington, NC 27546 Phone: (910) 893-7525 Fax: (910) 893-2793 www.harnett.org

LANDOWNER: STANCIL BUILDERS INC. Mailing Address: 466 Stancil Rd
City: Angier State: NC Zip: 27501 Home #: 919-639-2073 Contact #: 919-868-2189

APPLICANT: STANCIL BUILDERS INC. Mailing Address: 466 Stancil Rd
City: Angier State: NC Zip: 27501 Home #: _____ Contact #: _____
*Please fill out applicant information if different than landowner

PROPERTY LOCATION: State Road #: 1141 State Road Name: Micro Tower Rd.
Parcel: 039597 0225 G1 PIN: 9597 40 9550.000

Zoning: RA-20R Subdivision: R-30 Pattons Point II Lot #: 182 Lot Size: 0.347
Flood Plain: X Panel: N/A Watershed: N/A Deed Book/Page: 2271/860 Plat Book/Page: 2008/148

SPECIFIC DIRECTIONS TO THE PROPERTY FROM LILLINGTON: _____
US 401, right on Hwy 27, left on Doc's Rd, right on Micro Tower Rd,
Subdivision on right

PROPOSED USE: Circle:
 SFD (Size 40x60) # Bedrooms 3 # Baths 2 Basement (w/wo bath) _____ Garage X Deck X Crawl Space / Slab
 Modular: ___ On frame ___ Off frame (Size ___ x ___) # Bedrooms ___ # Baths ___ Garage ___ (site built? ___) Deck ___ (site built? ___)
 Multi-Family Dwelling No. Units _____ No. Bedrooms/Unit _____
 Manufactured Home: ___ SW ___ DW ___ TW (Size ___ x ___) # Bedrooms ___ Garage ___ (site built? ___) Deck ___ (site built? ___)
 Business Sq. Ft. Retail Space _____ Type _____ # Employees: _____ Hours of Operation: _____
 Industry Sq. Ft. _____ Type _____ # Employees: _____ Hours of Operation: _____
 Church Seating Capacity _____ # Bathrooms _____ Kitchen _____
 Home Occupation (Size ___ x ___) # Rooms _____ Use _____ Hours of Operation: _____
 Accessory/Other (Size ___ x ___) Use _____ Closets in addition (___)yes (___)no
 Addition to Existing Building (Size ___ x ___) Use _____

Water Supply: County Well (No. dwellings _____) Other
Sewage Supply: New Septic Tank (Need to fill out New Tank Checklist) Existing Septic Tank County Sewer Other
Property owner of this tract of land own land that contains a manufactured home w/in five hundred feet (500') of tract listed above? YES NO
Structures on this tract of land: Single family dwellings 1 Proposed Manufactured Homes _____ Other (specify) _____

Required Residential Property Line Setbacks: Comments: _____

Front	Minimum	<u>35</u>	Actual	<u>46</u>	_____
Rear		<u>25</u>		<u>60</u>	_____
Side		<u>10</u>		<u>20</u>	_____
Corner/Sidestreet		<u>20</u>		_____	_____
Nearest Building on same lot		<u>10</u>		_____	_____

If permits are granted I agree to conform to all ordinances and the laws of the State of North Carolina regulating such work and the specifications of plans submitted. I hereby state that the foregoing statements are accurate and correct to the best of my knowledge. This permit is subject to revocation if false information is provided on this form.

Brenda Saldaña V.P. Date 8-25-09
Signature of Owner or Owner's Agent

****This application expires 6 months from the initial date if no permits have been issued****
A RECORDED SURVEY MAP, RECORDED DEED (OR OFFER TO PURCHASE) AND PLAT ARE REQUIRED WHEN APPLYING FOR LAND USE APPLICATION

Please use Blue or Black Ink ONLY

1" = 50'

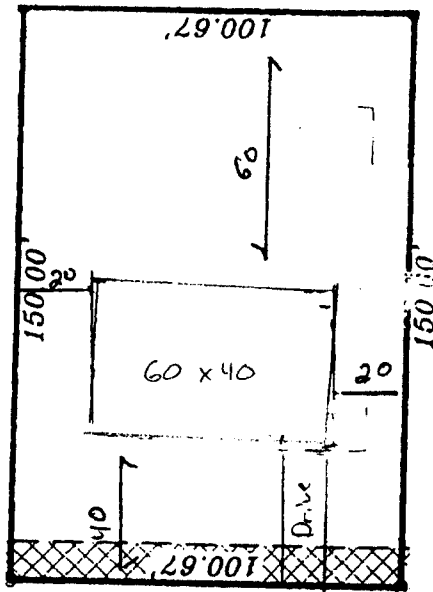

Lot 182 Patton's Point Phase 2
155 Jumpmaster Dr

SITE PLAN APPROVAL
DISTRICT RAZOR USE SFD
#BEDROOMS 3
8.26.09 djohnson
ADMINISTRATOR

22720

OWNER NAME: Stancil

APPLICATION #: CA.50022720

This application to be filled out only when applying for a new septic system.

County Health Department Application for Improvement Permit and/or Authorization to Construct

IF THE INFORMATION IN THIS APPLICATION IS FALSIFIED, CHANGED, OR THE SITE IS ALTERED, THEN THE IMPROVEMENT PERMIT OR AUTHORIZATION TO CONSTRUCT SHALL BECOME INVALID. The permit is valid for either 60 months or without expiration depending upon documentation submitted. (complete site plan = 60 months; complete plat = without expiration)

DEVELOPMENT INFORMATION

- New single family residence
- Expansion of existing system
- Repair to malfunctioning sewage disposal system
- Non-residential type of structure

WATER SUPPLY

- New well
- Existing well
- Community well
- Public water
- Spring

Are there any existing wells, springs, or existing waterlines on this property?

yes no unknown

SEPTIC

If applying for authorization to construct please indicate desired system type(s): can be ranked in order of preference, must choose one.

- Accepted Innovative
- Alternative Other
- Conventional Any

The applicant shall notify the local health department upon submittal of this application if any of the following apply to the property in question. If the answer is "yes", applicant must attach supporting documentation.

- YES NO Does the site contain any Jurisdictional Wetlands?
- YES NO Does the site contain any existing Wastewater Systems?
- YES NO Is any wastewater going to be generated on the site other than domestic sewage?
- YES NO Is the site subject to approval by any other Public Agency?
- YES NO Are there any easements or Right of Ways on this property?
- YES NO Does the site contain any existing water, cable, phone or underground electric lines?

If yes please call No Cuts at 800-632-4949 to locate the lines. This is a free service.

I Have Read This Application And Certify That The Information Provided Herein Is True, Complete And Correct. Authorized County And State Officials Are Granted Right Of Entry To Conduct Necessary Inspections To Determine Compliance With Applicable Laws And Rules.

I Understand That I Am Solely Responsible For The Proper Identification And Labeling Of All Property Lines And Corners And Making The Site Accessible So That A Complete Site Evaluation Can Be Performed.

Brenda Saldaña V.P.
PROPERTY OWNERS OR OWNERS LEGAL REPRESENTATIVE SIGNATURE (REQUIRED)

8-25-09
DATE

UNRECORDED



2006015559

HARNETT COUNTY TAX ID#

03-4597-0225

8-24-06 BY KLD

FOR REGISTRATION REGISTER OF DEEDS
KIMBERLY S. HERRIDGE
HARNETT COUNTY, NC
2006 AUG 24 09:29:59 AM
BK 2271 PG 060-062 FEE \$17.00
NC REV STAMP \$354.00
INSTRUMENT # 2006015559

Excise Tax \$384.00 Recording Time, Book & Page

The Property is Insured by: Stetley Land Title

BRIEF DESCRIPTION: 35.347 Acres Residual Tract, Map # 2006-708

Mail To: Grantee

Parcel Identification No.: Out of 0022984

Prepared By: Currie Lee Howell, Attorney at Law
Adams & Howell, P.A.

NORTH CAROLINA GENERAL WARRANTY DEED

This WARRANTY DEED is made this 23rd day of August, 2006 by and between DAVID T. MCNEILL and wife, SANDRA S. MCNEILL, whose address is Post Office Box 181, Olivia, North Carolina 28368, party(ies) of the first part, hereinafter referred to as the Grantor(s); and STANCIL BUILDERS, INC. (A North Carolina Corporation), whose address is 466 Stancil Road, Angier, North Carolina 27504, party(ies) of the second part, hereinafter referred to as the Grantee(s).

WITNESSETH:

WHEREAS Grantor(s) for and in consideration of the Sum of Ten Dollars (\$10.00) and other good and valuable consideration, receipt of which is hereby acknowledged, have given, granted, bargained, sold and conveyed, and by these presents do hereby give, grant, bargain, sell and convey unto the Grantee in fee simple. Said property being all of that certain piece, parcel or tract of land situated, lying and being in Barbecue Township, Harnett County, North Carolina, and more particularly described as follows:

BEING all of that 35.347 Acres Residual Tract as shown in Map Number 2006-708, Harnett County Registry.

Grantor herein reserves the right of ingress and egress and installation of utilities over the "New 50' Access & Utility Easement" as shown in Map Number 2006-708, Harnett County Registry. Grantor reserves the right to said easement for access to Lot 1, containing 4.112 Acres, which shall be retained by Grantor.

Subject to all easements, rights-of-way, covenants and other restrictions as shown on the public record or as would be disclosed by an accurate survey and inspection of the land.

This conveyance is expressly made subject to the lien created by all the Grantors' real 2006 Harnett County ad valorem taxes on said tract of land which the Grantee(s) agree to assume and pay in full when due.

See Deed Book 1411, Page 92.

TO HAVE AND TO HOLD the above described lands and premises, together with all appurtenances thereunto belonging, or in anywise appertaining, unto the Grantees in fee simple, their heirs, successors and assigns forever, but subject always, however, to the limitations set out above.