

HTE# 09-5-22715RL

# Harris County Department of Public Health

25623

## Improvement Permit

A building permit cannot be issued with only an Improvement Permit

ISSUED TO: Palmetto Building, Inc. PROPERTY LOCATION: Lasater Rd.  
 SUBDIVISION Walnut Grove LOT # 2  
 NEW  REPAIR  EXPANSION  Site Improvements required prior to Construction Authorization Issuance: \_\_\_\_\_  
 Type of Structure: SFD 42x60  
 Proposed Wastewater System Type: conventional  
 Projected Daily Flow: 360 GPD  
 Number of bedrooms: 3 Number of Occupants: 6 max  
 Basement  Yes  No  
 Pump Required:  Yes  No  May be required based on final location and elevations of facilities  
 Type of Water Supply:  Community  Public  Well Distance from well \_\_\_\_\_ feet Permit valid for:  Five years  
 Permit conditions: \_\_\_\_\_  No expiration

Authorized State Agent: [Signature] Date: 9/22/2009 SEE ATTACHED SITE SKETCH  
 The issuance of this permit by the Health Department in no way guarantees the issuance of other permits. The permit holder is responsible for checking with appropriate governing bodies in meeting their requirements. This site is subject to revocation if the site plan, plat, or the intended use changes. The Improvement Permit shall not be affected by a change in ownership of the site. This permit is subject to compliance with the provisions of the Laws and Rules for Sewage Treatment and Disposal and to conditions of this permit.

## Construction Authorization

(Required for Building Permit)

The construction and installation requirements of Rules .1950, .1952, .1954, .1955, .1956, .1957, .1958, and .1959 are incorporated by references into this permit and shall be met. Systems shall be installed in accordance with the attached system layout.

ISSUED TO: Palmetto Building, Inc. PROPERTY LOCATION: Lasater Rd.  
 SUBDIVISION Walnut Grove LOT # 2  
 Facility Type: SFD  New  Expansion  Repair  
 Basement?  Yes  No Basement Fixtures?  Yes  No  
 Type of Wastewater System\*\* conventional (Initial) Wastewater Flow: \_\_\_\_\_ GPD  
 (See note below, if applicable  PPBPS (Repair)

Installation Requirements/Conditions  
 Septic Tank Size 1000 gallons Number of trenches 3  
 Pump Tank Size \_\_\_\_\_ gallons Exact length of each trench 80 feet Trench Spacing: 9 Feet on Center  
 Trenches shall be installed on contour at a Soil Cover: 12-18 inches  
 Maximum Trench Depth of: 24-30 inches (Maximum soil cover shall not exceed 36" above the trench bottom)  
 (Trench bottoms shall be level to +1-1/4" in all directions)

Pump Requirements: \_\_\_\_\_ ft. TDH vs. \_\_\_\_\_ GPM  
 Aggregate Depth: 6 inches below pipe  
2 inches above pipe  
12 inches total

Conditions: Permit based on soil consultant proposal  
No utilities allowed in initial septic area or repair area  
Water line must be at least 15ft. from any part of septic system

\*\*If applicable: I understand the system type specified is different from the type specified on the application. I accept the specifications of this permit.

Owner/Legal Representative Signature: \_\_\_\_\_ Date: \_\_\_\_\_

This Construction Authorization is subject to revocation if the site plan, plat, or the intended use changes. The Construction Authorization shall not be transferred when there is a change in ownership of the site. This Construction Authorization is subject to compliance with the provisions of the Laws and Rules for Sewage Treatment and Disposal and to the conditions of this permit. SEE ATTACHED SITE SKETCH

Authorized State Agent: [Signature] Date: 9/22/2009  
 Construction Authorization Expiration Date: 9/22/2014

HTE# 09-5.22715RR

Permit # 25623

## Harnett County Department of Public Health Site Sketch

ISSUED TO: Palmetto Building Inc. PROPERTY LOCATOR: Harater Rd.  
SUBDIVISION Walnut Grove LOT # 2  
Authorized State Agent: [Signature] Date: 9/22/2009

\*See attachment for  
site sketch

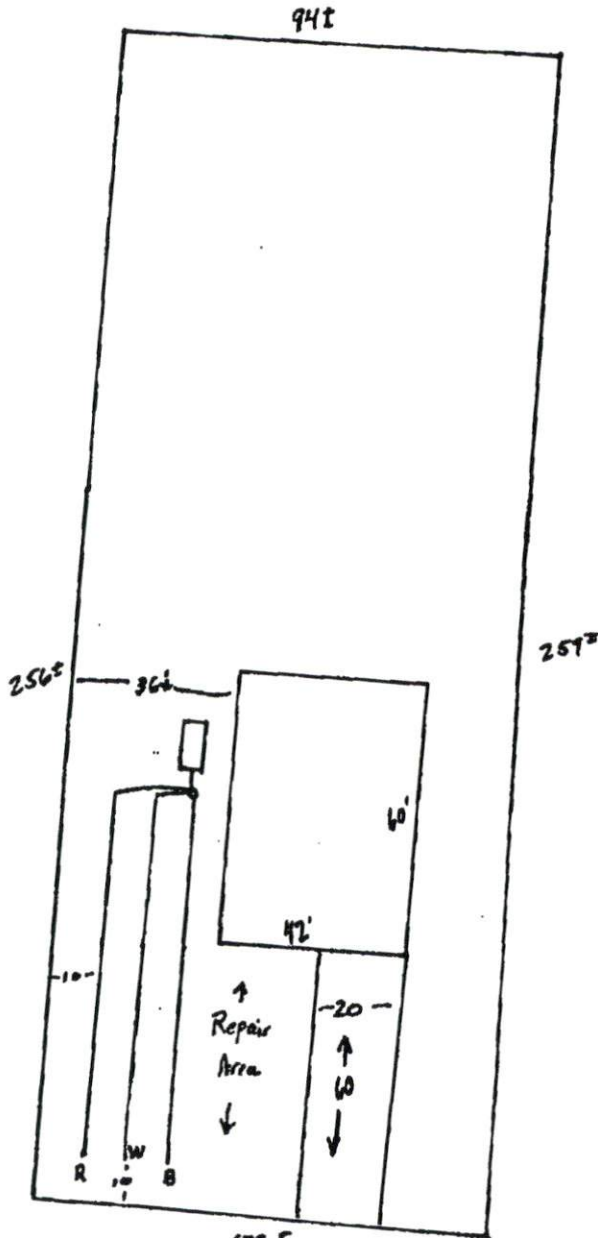

Walnut Grove Lot 2

1" = 40'

Typical Soils in Initial + Repair Area

0-30 LS  
30-42+54L  
.5 LTAR

Initial System

$$360 \text{ gpd} \div .5 = 800 \text{ ft}^2$$

$$800 \text{ ft}^2 \div 3 \text{ ft} = 240 \text{ ft}$$

Install 3-80' lines (conventional)  
at 24"-30"

Repair System

LPP at .4 LTAR

900 ft<sup>2</sup> required

180 linear ft

OR

PPBPS at .5 LTAR

120 linear ft required



9-17-07