

Initial Application Date: 8-13-09

Application # 0950022659

CU# \_\_\_\_\_

**COUNTY OF HARNETT RESIDENTIAL LAND USE APPLICATION**

Central Permitting 108 E. Front Street, Lillington, NC 27546 Phone: (910) 893-7525 Fax: (910) 893-2793 www.harnett.org/permits

LANDOWNER: David Taylor Mailing Address: 465 Lawrence Rd.

City: Broadway State: N.C. Zip: 27505 Home #: \_\_\_\_\_ Contact #: \_\_\_\_\_

APPLICANT\*: Steve Thomas Mailing Address: P.O. Box 875

City: Broadway State: N.C. Zip: 27505 Home #: \_\_\_\_\_ Contact #: 919-906-4069

\*Please fill out applicant information if different than landowner

CONTACT NAME APPLYING IN OFFICE: Barry Watkins Phone #: 919-883-6806

PROPERTY LOCATION: Subdivision w/phase or section: Cinnamon Hill Lot #: 9 Lot Acreage: 0.70

State Road #: 1272 State Road Name: Lawrence Map Book&Page: 2008, 186

Parcel: 13 9691 0128 12 PIN: 9691-48-8508,000

Zoning: RA30 Flood Zone: X Watershed: WA Deed Book&Page: 1232, 342 Power Company\*: UK

\*New homes with Progress Energy as service provider need to supply premise number \_\_\_\_\_ from Progress Energy.

SPECIFIC DIRECTIONS TO THE PROPERTY FROM LILLINGTON: 421 toward Sanford - Rt. on Holly Springs Rd. - Left on Lawrence

PROPOSED USE: 1440 sq'

SFD (Size 64'0" x 37'6") # Bedrooms 3 # Baths 2 Basement (w/wo bath) \_\_\_\_\_ Garage  Deck \_\_\_\_\_ Circle: Slab  
 (Is the bonus room finished? \_\_\_\_\_ w/ a closet \_\_\_\_\_ if so add in with # bedrooms)

Mod (Size \_\_\_\_\_ x \_\_\_\_\_) # Bedrooms \_\_\_\_\_ # Baths \_\_\_\_\_ Basement (w/wo bath) \_\_\_\_\_ Garage \_\_\_\_\_ Site Built Deck \_\_\_\_\_ ON Frame / OFF  
 (Is the second floor finished? \_\_\_\_\_ Any other site built additions? \_\_\_\_\_)

Manufactured Home: \_\_\_\_\_ SW \_\_\_\_\_ DW \_\_\_\_\_ TW (Size \_\_\_\_\_ x \_\_\_\_\_) # Bedrooms \_\_\_\_\_ Garage \_\_\_\_\_ (site built? \_\_\_\_\_) Deck \_\_\_\_\_ (site built? \_\_\_\_\_)

Duplex (Size \_\_\_\_\_ x \_\_\_\_\_) No. Buildings \_\_\_\_\_ No. Bedrooms/Unit \_\_\_\_\_

Home Occupation # Rooms \_\_\_\_\_ Use \_\_\_\_\_ Hours of Operation: \_\_\_\_\_ #Employees \_\_\_\_\_

Addition/Accessory/Other (Size \_\_\_\_\_ x \_\_\_\_\_) Use \_\_\_\_\_ Closets in addition ( )yes ( )no

Water Supply:  County ( ) Well (No. dwellings \_\_\_\_\_) **MUST** have operable water before final

Sewage Supply:  New Septic Tank (Complete **Checklist**) ( ) Existing Septic Tank (Complete **Checklist**) ( ) County Sewer

Property owner of this tract of land own land that contains a manufactured home w/in five hundred feet (500') of tract listed above? ( ) YES  NO

Structures (existing & proposed): Stick Built/Modular Stick Built Manufactured Homes \_\_\_\_\_ Other (specify) \_\_\_\_\_

Required Residential Property Line Setbacks:      Comments: \_\_\_\_\_

Front	Minimum <u>35</u>	Actual <u>15.0</u>	_____
Rear	<u>25</u>	<u>104.8</u>	_____
Closest Side	<u>10</u>	<u>16.2</u>	_____
Sidestreet/corner lot	_____	_____	_____
Nearest Building on same lot	_____	_____	_____

If permits are granted I agree to conform to all ordinances and laws of the State of North Carolina regulating such work and the specifications of plans submitted. I hereby state that foregoing statements are accurate and correct to the best of my knowledge. Permit subject to revocation if false information is provided.

Signature of Owner or Owner's Agent: Barry Watkins Date: 8-13-09

**\*\*This application expires 6 months from the initial date if no permits have been issued\*\***

**A RECORDED SURVEY MAP, RECORDED DEED (OR OFFER TO PURCHASE) AND PLAT ARE REQUIRED WHEN APPLYING FOR LAND USE APPLICATION**

Please use Blue or Black Ink ONLY

MAP REFERENCE: MAP NO. 2008-986

MAP NO. 2008-986

"ELSIE BUCHANAN LANE" 50' R/W

8

S 74°03'10"E 301.08'

150'

50.00'

12.2'

9

0.70 AC. 150

66.00'

PROPOSED HOUSE LOCATION

PROPOSED DRIVE

16.2'

154.8'

S 12°48'20"W 100.09'

N 74°06'46"W 305.44'

10

SITE PLAN APPROVAL GFD

DISTRICT AA 30 USE 3

#BEDROOMS 3

8-13-09 V.C. Brock  
Date Zoning Administrator

MINIMUM BUILDING SET BACKS  
FRONT YARD --- 30'  
REAR YARD --- 20'  
SIDE YARD --- 10'  
CORNER LOT SIDE YARD --- 20'  
MAXIMUM HEIGHT --- 35'

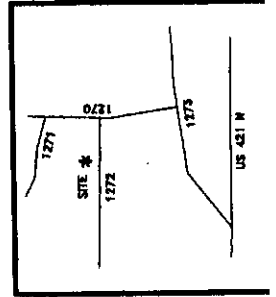

SURVEY FOR:

PROPOSED PLOT PLAN - LOT - 9  
CINNAMON HILL SUBDIVISION

TOWNSHIP: UPPER LITTLE RIVER

COUNTY: HARNETT

DATE: AUGUST 05, 2009

STATE: NORTH CAROLINA

JOB NO. 09454

**BENNETT SURVEYS, INC.** C-1080  
1962 CLARK RD., LILLINGTON, N.C. 27546  
(910) 893-5252

20 0 40

SURVEYED BY:

DRAWN BY: RYB

SCALE: 1" = 40'

FIELD BOOK

DRAWING N

NAME: \_\_\_\_\_

APPLICATION #: 0950022659

**\*This application to be filled out when applying for a septic system inspection.\***

**County Health Department Application for Improvement Permit and/or Authorization to Construct**

IF THE INFORMATION IN THIS APPLICATION IS FALSIFIED, CHANGED, OR THE SITE IS ALTERED, THEN THE IMPROVEMENT PERMIT OR AUTHORIZATION TO CONSTRUCT SHALL BECOME INVALID. The permit is valid for either 60 months or without expiration (depending upon documentation submitted. (complete site plan = 60 months; complete plat = without expiration)

910-893-7525 option 1

CONFIRMATION # 102135

**Environmental Health New Septic System Code 800**

- Place "pink property flags" on each corner iron of lot. All property lines must be clearly flagged approximately every 50 feet between corners.
- Place "orange house corner flags" at each corner of the proposed structure. Also flag driveways, garages, decks, out buildings, swimming pools, etc. Place flags per site plan developed at/for Central Permitting.
- Place orange Environmental Health card in location that is easily viewed from road to assist in locating property.
- If property is thickly wooded, Environmental Health requires that you clean out the undergrowth to allow the soil evaluation to be performed. Inspectors should be able to walk freely around site. **Do not grade property.**
- Call No Cuts to locate utility lines prior to scheduling inspection, 800-632-4949 (This is a free service)
- After preparing proposed site call the voice permitting system at 910-893-7525 option 1 to schedule and use code 800 (after selecting notification permit if multiple permits exist) for Environmental Health inspection. **Please note confirmation number given at end of recording for proof of request.**
- Use Click2Gov or IVR to verify results. Once approved, proceed to Central Permitting for permits.

**Environmental Health Existing Tank Inspections Code 800**

- Follow above instructions for placing flags and card on property.
- Prepare for inspection by removing soil over door as diagram indicates. Loosen trap door cover. (Unless inspection is for a septic tank in a mobile home park)
- After preparing trapdoor call the voice permitting system at 910-893-7525 option 1 & select notification permit if multiple permits, then use code 800 for Environmental Health inspection. **Please note confirmation number given at end of recording for proof of request.**
- Use Click2Gov or IVR to hear results. Once approved, proceed to Central Permitting for remaining permits.

**SEPTIC**

If applying for authorization to construct please indicate desired system type(s): can be ranked in order of preference, must choose one.

- Accepted       Innovative       Conventional       Any  
 Alternative       Other \_\_\_\_\_

The applicant shall notify the local health department upon submittal of this application if any of the following apply to the property in question. If the answer is "yes", applicant must attach supporting documentation.

- YES  NO Does the site contain any Jurisdictional Wetlands?  
 YES  NO Do you plan to have an irrigation system now or in the future?  
 YES  NO Does or will the building contain any drains? Please explain. \_\_\_\_\_  
 YES  NO Are there any existing wells, springs, waterlines or Wastewater Systems on this property?  
 YES  NO Is any wastewater going to be generated on the site other than domestic sewage?  
 YES  NO Is the site subject to approval by any other Public Agency?  
 YES  NO Are there any easements or Right of Ways on this property?  
 YES  NO Does the site contain any existing water, cable, phone or underground electric lines?

If yes please call No Cuts at 800-632-4949 to locate the lines. This is a free service.

**I Have Read This Application And Certify That The Information Provided Herein Is True, Complete And Correct. Authorized County And State Officials Are Granted Right Of Entry To Conduct Necessary Inspections To Determine Compliance With Applicable Laws And Rules.**

**I Understand That I Am Solely Responsible For The Proper Identification And Labeling Of All Property Lines And Corners And Making The Site Accessible So That A Complete Site Evaluation Can Be Performed.**

Bany Waltham

8-13-09

PROPERTY OWNERS OR OWNERS LEGAL REPRESENTATIVE SIGNATURE (REQUIRED)

DATE