

HTE# 09-5-22407

Har t County Department of Public Health

20794

PERMIT # 25558

Operation Permit

New Installation Septic Tank Repair Nitrification Line Expansion

PROPERTY LOCATION: TINGEN RD

Name: (owner) AO CONTRACTING

SUBDIVISION TINGEN PLACE

LOT # 38

System Installer: LARRY SHARPE

Registration # _____

Basement with plumbing: Garage Number of Bedrooms 3

Type of Water Supply: Community Public Well Distance from well 100 feet

System Type: IIIg Types V and VI Systems expire in 5 years.

(In accordance with Table V a)

Owner must contact Health Department 6 months prior to expiration for permit renewal.

This system has been installed in compliance with applicable North Carolina General Statutes, Rules for Sewage Treatment and Disposal, and all conditions of the Improvement Permit and Construction Authorization.

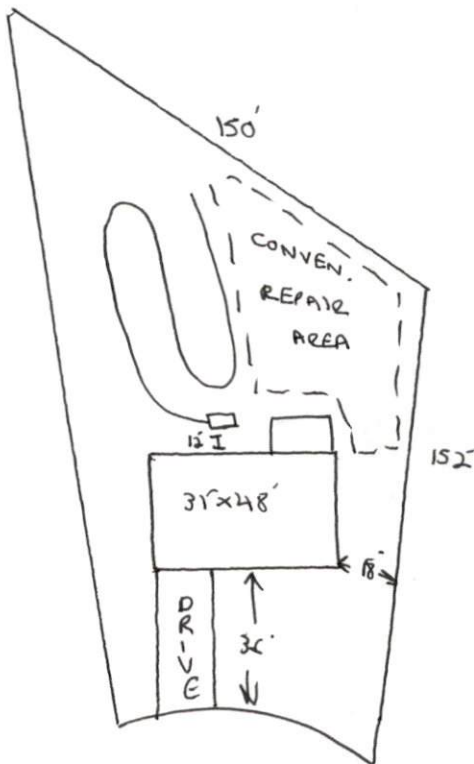

PERMIT CONDITIONS:

I. Performance: System shall perform in accordance with Rule .1961.

II. Monitoring: As required by Rule .1961.

III. Maintenance: As required by Rule .1961. Other: _____

Subsurface system operator required? Yes No

If yes, see attached sheet for additional operation conditions, maintenance and reporting.

IV. Operation: _____

V. Other: _____

Following are the specifications for the sewage disposal system on the above captioned property.

Type of system: Conventional Other TIRE CHIPS Septic Tank: 1000 gallons Pump Tank: _____ gallons

Subsurface No. of exact length width of depth of
Drainage Field ditches 1 of each ditch 150 feet ditches 3 feet ditches 24-36 inches

French Drain Required: _____ linear feet

Authorized State Agent [Signature] RS

Date 8/24/09