

HTE# 09-5-2221

Harriet County Department of Public Health

25327

Improvement Permit

A building permit cannot be issued with only an Improvement Permit

ISSUED TO: KEITH BULLOCK BUILDERS INC PROPERTY LOCATION: LASATER RD
 SUBDIVISION WALNUT GROVE LOT # 36
 NEW REPAIR EXPANSION
 Type of Structure: SFD (60x60) Site Improvements required prior to Construction Authorization Issuance:
 Proposed Wastewater System Type: 25% REDUCTION SYSTEM
 Projected Daily Flow: 360 GPD
 Number of bedrooms: 3 Number of Occupants: 6 max
 Basement Yes No
 Pump Required: Yes No May be required based on final location and elevations of facilities
 Type of Water Supply: Community Public Well Distance from well 100 feet Permit valid for: Five years
 Permit conditions: IF PROPER FALL FROM TANK TO DRAINFIELD CAN NOT BE MAINTAINED THEN A PUMP WILL BE REQUIRED. No expiration

Authorized State Agent: [Signature] Date: 6/23/09 SEE ATTACHED SITE SKETCH
 The issuance of this permit by the Health Department in no way guarantees the issuance of other permits. The permit holder is responsible for checking with appropriate governing bodies in meeting their requirements. This site is subject to revocation if the site plan, plat, or the intended use changes. The Improvement Permit shall not be affected by a change in ownership of the site. This permit is subject to compliance with the provisions of the Laws and Rules for Sewage Treatment and Disposal and to conditions of this permit.

Construction Authorization

(Required for Building Permit)

The construction and installation requirements of Rules .1950, .1952, .1954, .1955, .1956, .1957, .1958, and .1959 are incorporated by references into this permit and shall be met. Systems shall be installed in accordance with the attached system layout.

ISSUED TO: KEITH BULLOCK BUILDERS INC PROPERTY LOCATION: LASATER RD
 SUBDIVISION WALNUT GROVE LOT # 36
 Facility Type: SFD (60x60) New Expansion Repair
 Basement? Yes No Basement Fixtures? Yes No
 Type of Wastewater System** 25% REDUCTION SYSTEM (Initial) Wastewater Flow: 360 GPD
 (See note below, if applicable)

DELEGATION W/OUT PRETREATMENT (Repair)

Installation Requirements/Conditions
 Septic Tank Size 1000 gallons
 Pump Tank Size _____ gallons
 Number of trenches 1
 Exact length of each trench 330 feet
 Trenches shall be installed on contour at a
 Maximum Trench Depth of: 12 inches
 (Trench bottoms shall be level to +/-1/4" in all directions)
 Trench Spacing: _____ Feet on Center
 Soil Cover: _____ inches
 (Maximum soil cover shall not exceed 36" above the trench bottom)
 Pump Requirements: _____ ft. TDH vs. _____ GPM _____ inches below pipe
 Aggregate Depth: _____ inches above pipe
 Conditions: 6" OF COVER REQUIRED OVER DRAINFIELD. THIS PERMIT BASED ON PROPOSAL FROM APPLICANTS SOIL CONSULTANT. SEE ATTACHED DRAWING. _____ inches total

**If applicable: I understand the system type specified is different from the type specified on the application. I accept the specifications of this permit.

Owner/Legal Representative Signature: _____ Date: _____

This Construction Authorization is subject to revocation if the site plan, plat, or the intended use changes. The Construction Authorization shall not be transferred when there is a change in ownership of the site. This Construction Authorization is subject to compliance with the provisions of the Laws and Rules for Sewage Treatment and Disposal and to the conditions of this permit. SEE ATTACHED SITE SKETCH

Authorized State Agent: [Signature] Date: 6/23/09
 Construction Authorization Expiration Date: 6/23/14

Walnut Grove lot 36
Keith Bullock Builders

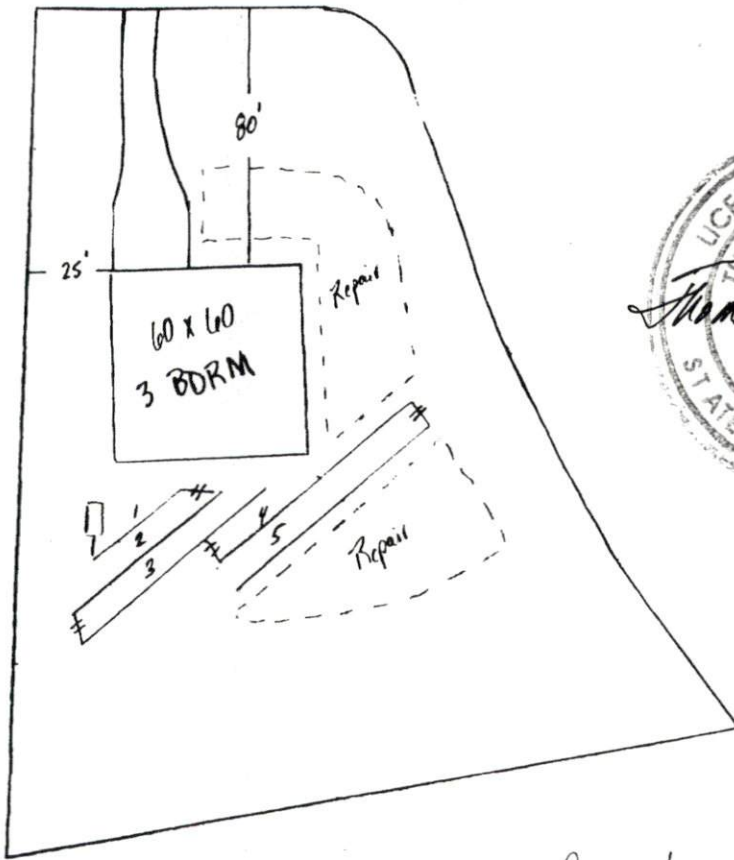

	C	L
1	B	35
2	W	60
3	R	75
4	B	80
5	W	80
		<u>330</u>

1" = 60'

.3 LTAR
~~330'~~ Accepted Required
 12" Trench Depth
 6" cover required over system area

Repair - Drip Irrigation without Pretreatment
 .1 LTAR = 3600 ft²