

HTE# 09-5-22207R

Harnett County Department of Public Health

25604

Improvement Permit

A building permit cannot be issued with only an Improvement Permit

ISSUED TO: Wynn Construction PROPERTY LOCATION: 27 West
 SUBDIVISION: Tingen Point LOT # 53
 NEW REPAIR EXPANSION
 Type of Structure: SFD 42x42'
 Proposed Wastewater System Type: Pump to 25% reduction
 Projected Daily Flow: 360 GPD
 Number of bedrooms: 3 Number of Occupants: 6 max
 Basement Yes No
 Pump Required: Yes No May be required based on final location and elevations of facilities
 Type of Water Supply: Community Public Well Distance from well _____ feet Permit valid for: Five years
 Permit conditions: _____ No expiration

Authorized State Agent: Bryan McSwain, R.S. Date: 8/25/2009 SEE ATTACHED SITE SKETCH
 The issuance of this permit by the Health Department in no way guarantees the issuance of other permits. The permit holder is responsible for checking with appropriate governing bodies in meeting their requirements. This site is subject to revocation if the site plan, plat, or the intended use changes. The Improvement Permit shall not be affected by a change in ownership of the site. This permit is subject to compliance with the provisions of the Laws and Rules for Sewage Treatment and Disposal and to conditions of this permit.

Construction Authorization

(Required for Building Permit)

The construction and installation requirements of Rules .1950, .1952, .1954, .1955, .1956, .1957, .1958, and .1959 are incorporated by references into this permit and shall be met. Systems shall be installed in accordance with the attached system layout.

ISSUED TO: Wynn Construction PROPERTY LOCATION: 27 West
 SUBDIVISION: Tingen Point LOT # 53
 Facility Type: SFD New Expansion Repair
 Basement? Yes No Basement Fixtures? Yes No
 Type of Wastewater System** Pump to 25% reduction system (Initial) Wastewater Flow: 360 GPD
 (See note below, if applicable)
Pump to 25% reduction (Repair)

Installation Requirements/Conditions
 Septic Tank Size 1000 gallons Number of trenches 1
 Pump Tank Size 1000 gallons Exact length of each trench 260 feet Trench Spacing: 9 Feet on Center
 Trenches shall be installed on contour at a Soil Cover: 6 inches
 Maximum Trench Depth of: 18 inches (Maximum soil cover shall not exceed
 (Trench bottoms shall be level to +/-1/4" 36" above the trench bottom)
 in all directions)

Pump Requirements: _____ ft. TDH vs. _____ GPM _____ inches below pipe
 Aggregate Depth: _____ inches above pipe
 _____ inches total
 Conditions: Run drainliner on contour
* All parts of septic system must be 10 ft. from water line
AND REPAIR AREA

**If applicable: I understand the system type specified is different from the type specified on the application. I accept the specifications of this permit.

Owner/Legal Representative Signature: _____ Date: _____

This Construction Authorization is subject to revocation if the site plan, plat, or the intended use changes. The Construction Authorization shall not be transferred when there is a change in ownership of the site. This Construction Authorization is subject to compliance with the provisions of the Laws and Rules for Sewage Treatment and Disposal and to the conditions of this permit. SEE ATTACHED SITE SKETCH

Authorized State Agent: Bryan McSwain, R.S. Date: 8/25/2009 8/2/2011 Revision
 Construction Authorization Expiration Date: 8/25/2014 8/2/2016 Bm

HTE# 09-5-22207 R

Permit # 25604

Harnett County Department of Public Health Site Sketch

ISSUED TO: Wynn Construction PROPERTY LOCATOR: 27 West
SUBDIVISION: Tingen Point LOT # 53

Authorized State Agent: [Signature] Date: 8/25/2009 8/2/2011 *Revision*
BM

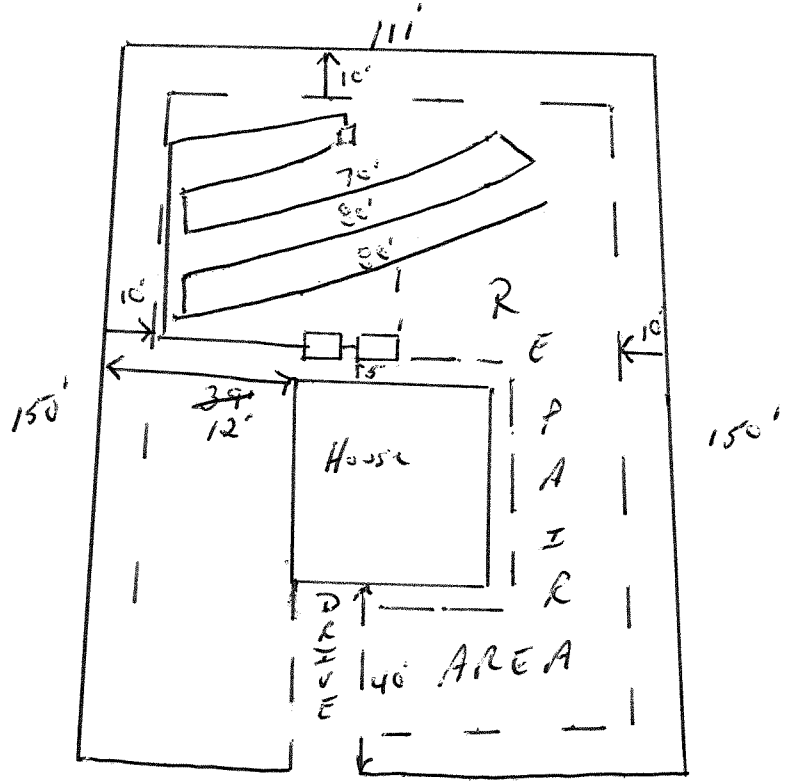

Juno Drive

Southeastern Soil & Environmental Associates, Inc.

P.O. Box 9321
Fayetteville, NC 28311
Phone/Fax (910) 822-4540
Email mike@southeasternsoil.com

original layout
from Horn. Co.
(Boyan McSwain)

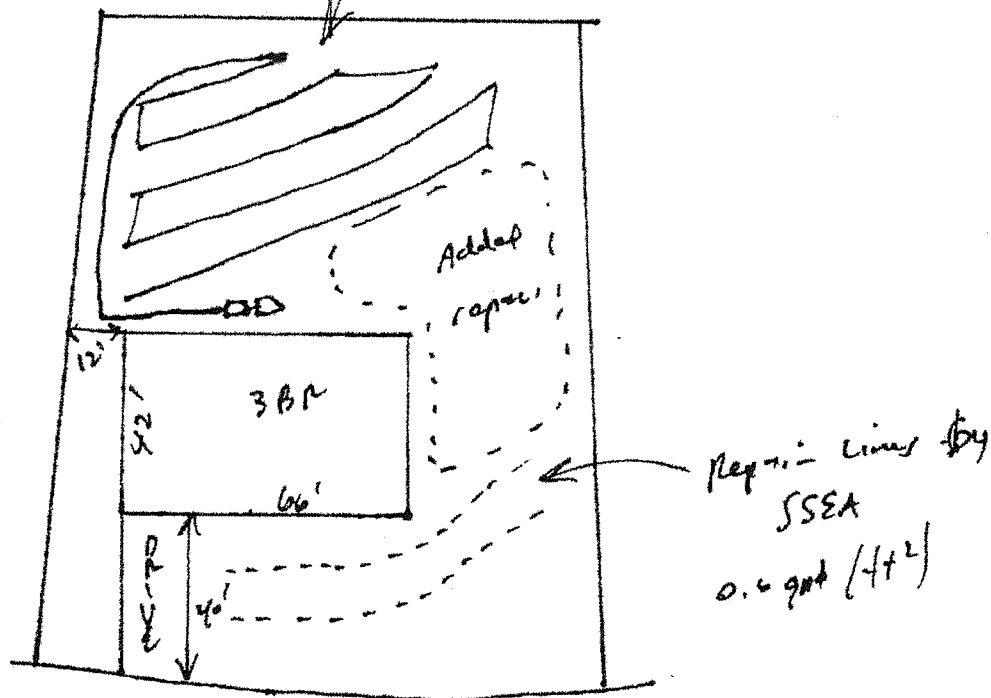

1" = 40'