

HTE# 09-5-22172

# Harnett County Department of Public Health Improvement Permit

25275

A building permit cannot be issued with only an Improvement Permit

ISSUED TO: Wynn Construction PROPERTY LOCATION: SR 1235 Adcock Rd.  
 NEW  REPAIR  EXPANSION  SUBDIVISION: Pioneer Farms LOT # 17  
 Type of Structure: SFD 43x45 Site Improvements required prior to Construction Authorization Issuance: \_\_\_\_\_  
 Proposed Wastewater System Type: conventional  
 Projected Daily Flow: 360 GPD  
 Number of bedrooms: 3 Number of Occupants: 6 max  
 Basement  Yes  No  
 Pump Required:  Yes  No  May be required based on final location and elevations of facilities  
 Type of Water Supply:  Community  Public  Well Distance from well \_\_\_\_\_ feet Permit valid for:  Five years  
 Permit conditions: \_\_\_\_\_  No expiration

Authorized State Agent: Guy McSwain R.S. Date: 6/5/2009 SEE ATTACHED SITE SKETCH  
 The issuance of this permit by the Health Department in no way guarantees the issuance of other permits. The permit holder is responsible for checking with appropriate governing bodies in meeting their requirements. This site is subject to revocation if the site plan, plat, or the intended use changes. The Improvement Permit shall not be affected by a change in ownership of the site. This permit is subject to compliance with the provisions of the Laws and Rules for Sewage Treatment and Disposal and to conditions of this permit.

## Construction Authorization

(Required for Building Permit)

The construction and installation requirements of Rules .1950, .1952, .1954, .1955, .1956, .1957, .1958, and .1959 are incorporated by references into this permit and shall be met. Systems shall be installed in accordance with the attached system layout.

ISSUED TO: Wynn Construction PROPERTY LOCATION: SR 1235  
 Facility Type: SFD 43x45'  New  Expansion  Repair  
 Basement?  Yes  No Basement Fixtures?  Yes  No SUBDIVISION: Pioneer Farms LOT # 17  
 Type of Wastewater System\*\* conventional (Initial) Wastewater Flow: 360 GPD  
 (See note below, if applicable )

### Installation Requirements/Conditions

Number of trenches 4  
 Septic Tank Size 1000 gallons Exact length of each trench 80 feet Trench Spacing: 9 Feet on Center  
 Pump Tank Size if needed gallons Trenches shall be installed on contour at a Soil Cover: 6 inches  
 (Maximum soil cover shall not exceed 36" above the trench bottom)  
 Maximum Trench Depth of: 18 inches  
 (Trench bottoms shall be level to +/- 1/4" in all directions)  
 Pump Requirements: \_\_\_\_\_ ft. TDH vs. \_\_\_\_\_ GPM Aggregate Depth: 6 inches below pipe  
2 inches above pipe

Conditions: Drainlines to be run on contour & NO DEEPER than 18 inches 12 inches total  
If plumbing cannot be stubbed out where shown pump will be required  
& tanks placed between house & left property line

\*\*If applicable: I understand the system type specified is different from the type specified on the application. I accept the specifications of this permit.

Owner/Legal Representative Signature: \_\_\_\_\_ Date: \_\_\_\_\_

This Construction Authorization is subject to revocation if the site plan, plat, or the intended use changes. The Construction Authorization shall not be transferred when there is a change in ownership of the site. This Construction Authorization is subject to compliance with the provisions of the Laws and Rules for Sewage Treatment and Disposal and to the conditions of this permit. SEE ATTACHED SITE SKETCH

Authorized State Agent: Guy McSwain R.S. Date: 6/5/2009  
 Construction Authorization Expiration Date: 6/5/2014

HTE# 09-5-22172

Permit # 25275

# Harnett County Department of Public Health Site Sketch

ISSUED TO: Wynn Construction PROPERTY LOCATOR: SR 1235 Adcock Rd.  
SUBDIVISION: Pioneer Farms LOT # 17

Authorized State Agent: Bryan McSwain, P.E. Date: 6/5/2009

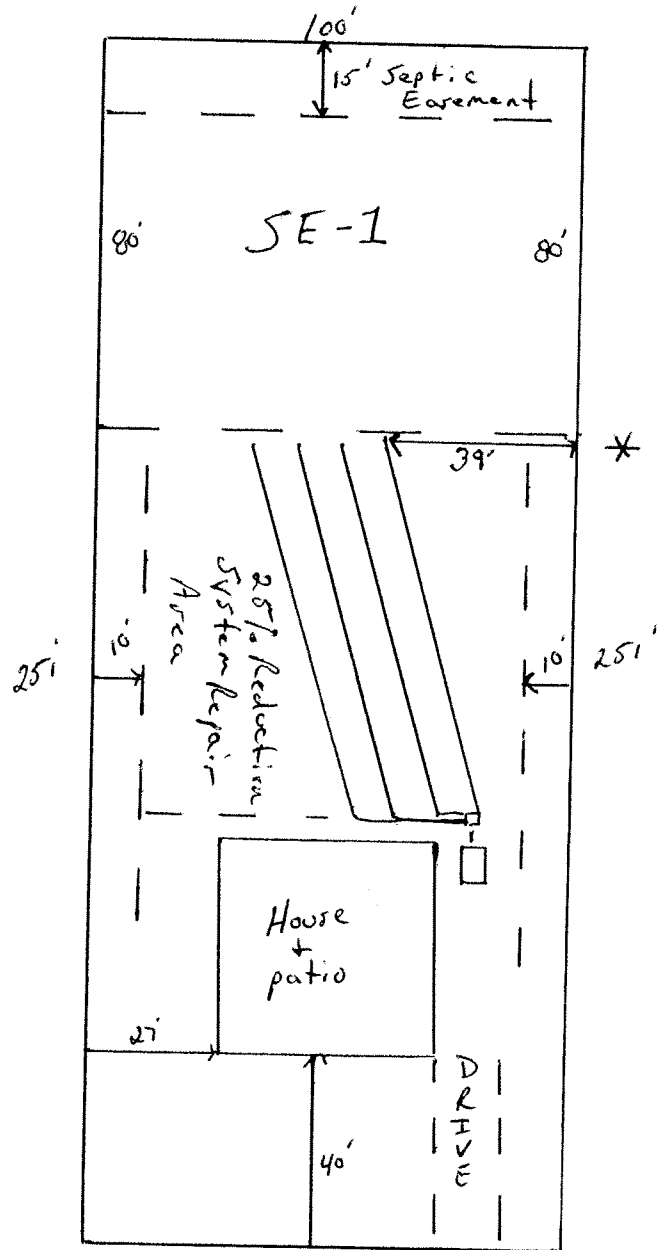

Letcher Lane