

HTE# 09-5-22157

Harnett County Department of Public Health

PERMIT # _____

Operation Permit

21720

New Installation Septic Tank Nitrification Line Repair Expansion

PROPERTY LOCATION 21412 Christchurch Rd

SUBDIVISION LAKEVIEW LOT # 3

Name: (owner) ERIC GLAF

System Installer: DAVE'S MECHANICAL Registration # _____

Basement with plumbing: Garage Number of Bedrooms 5

Type of Water Supply: Community Public Well Distance from well _____ feet

System Type: Mawtee to 25' DRAINAGE SYSTEM TYPE II Types V and VI Systems expire in 5 years.

(In accordance with Table V a) B 12244 Owner must contact Health Department 6 months prior to expiration for permit renewal.

This system has been installed in compliance with applicable North Carolina General Statutes, Rules for Sewage Treatment and Disposal, and all conditions of the Improvement Permit and Construction Authorization.

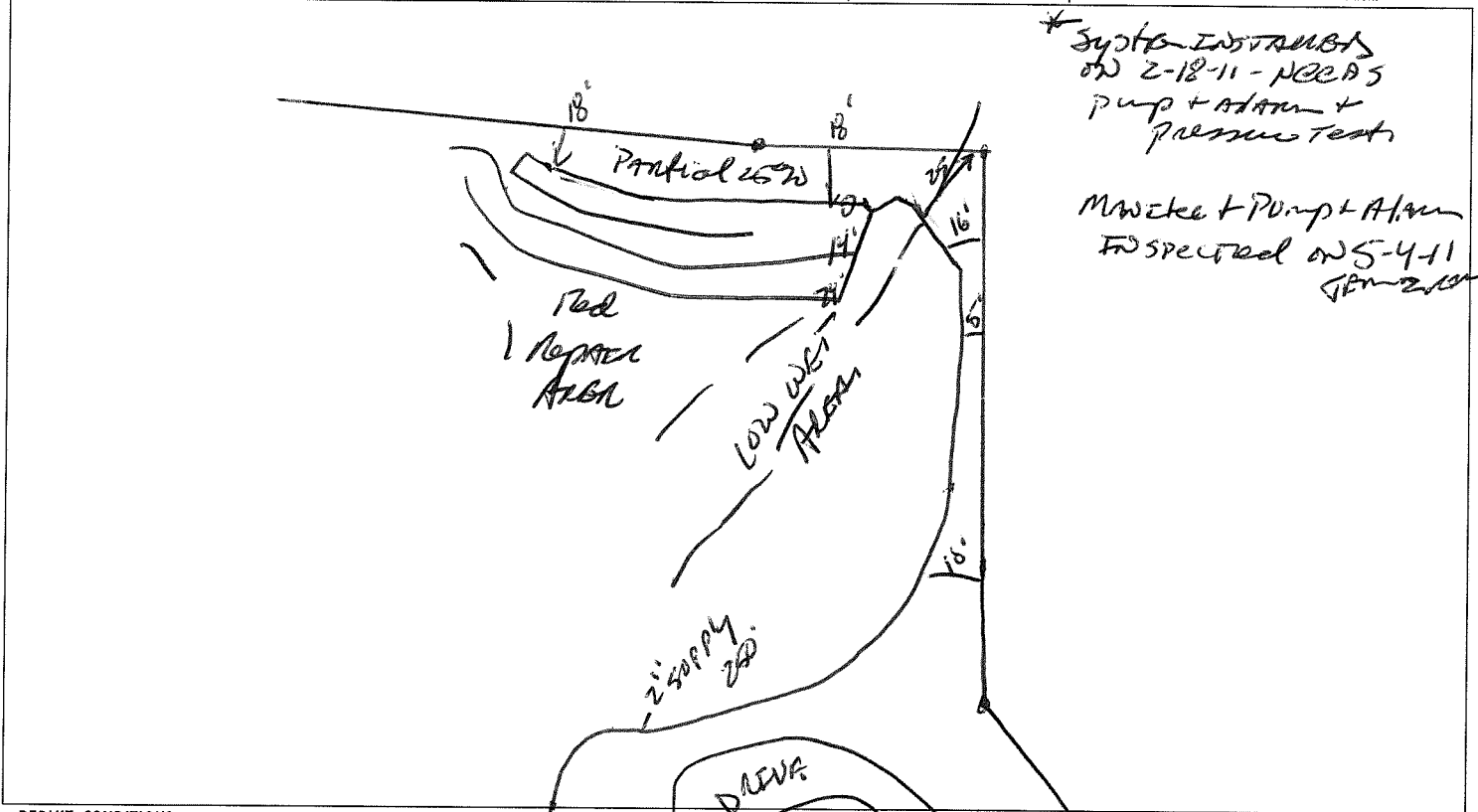

* SYSTEM INSTALLED ON 2-18-11 - PERMITS
 Pump + Alarm + Pressure Test
 Mawtee + Pump + Alarm
 Inspected on 5-4-11
 JEM 210

PERMIT CONDITIONS:

- I. Performance: System shall perform in accordance with Rule .1961.
- II. Monitoring: As required by Rule .1961.
- III. Maintenance: As required by Rule .1961. Other: _____
 Subsurface system operator required? Yes No
 If yes, see attached sheet for additional operation conditions, maintenance and reporting.
- IV. Operation: _____
- V. Other: _____

D-Box Pump Alarm H2O Line PWR Line

Following are the specifications for the sewage disposal system on the above captioned property.

Type of system: Conventional Other Mawtee to 25' DRAINAGE Septic Tank: 1200 gallons Pump Tank: 1000 gallons
 Subsurface Drainage Field No. of ditches 3 exact length of each ditch 125 feet width of ditches 3 feet depth of ditches 22-20 inches
 French Drain Required: _____ Linear feet

Authorized State Agent James E. Manhart Date 5-5-11