

SOIL/SITE EVALUATION for ON-SITE WASTEWATER SYSTEM

Owner: _____
 Address: _____
 Proposed Facility: **4 BEDROOM HOME** Design Flow (.1949): **490 gpd**
 Location of Site: _____
 Water Supply: Public Individual Well
 Evaluation Method: Auger Boring Pit
 Type of Wastewater: Sewage Industrial Process

Applicant: _____
 Date Evaluated: _____
 Property Size: _____
 Property Recorded: _____
 Spring Other
 Cut
 Mixed

P R O F I L E #	.1940 Landscape Position/ Slope%	Horizon Depth (IN.)	SOIL MORPHOLOGY .1941		OTHER PROFILE FACTORS				Profile Class & LTAR
			.1941 Structure/ Texture	.1941 Consistence Mineralogy	.1942 Soil Wetness/ Color	.1943 Soil Depth (IN.)	.1956 Sapro Class	.1944 Restr Horiz	
1	L5 0-2%	0-12	LS/DIST. BURN PINE FILL	REMNANTS					PS .6
		12-42	GS	VFL NS/MP					
		42-48	SBK SL	FR SS/MP					
2		0-16	BURN PINE	REMNANTS					PS .6
		16-42	GS	VFL NS/MP					
		42-48	SBK SL	FR SS/MP					
3		0-18	BURN PINE	REMNANTS (FILL)					PS .6
		18-36	GS	VFL NS/MP					
		36-48	SBK SL	FR SS/MP					

Description	Initial System	Repair System
Available Space (.1945)	✓	✓
System Type(s)	CON	CON
Site LTAR	.6	6

Other Factors (.1946): _____
 Site Classification (.1948): **PS**
 Evaluated By: **GT**
 Others Present: _____

4x50 @ 30" = REPAIR

COMMENTS: _____

<u>LANDSCAPE POSITIONS</u>	<u>GROUP</u>	<u>TEXTURES</u>	<u>.1955 LTAR</u>	<u>CONSISTENCE MOIST</u>	<u>WET</u>
R-RIDGE	I	S-SAND	1.2 - 0.8	VFR-VERY FRIABLE FR-FRIABLE	NS-NON-STICKY SS-SLIGHTLY STICKY
S-SHOULDER SLOPE		LS-LOAMY SAND			
L-LINEAR SLOPE	II	SL-SANDY LOAM	0.8 - 0.6	FI-FIRM VFI-VERY FIRM	S-STICKY VS-VERY STICKY
FS-FOOT SLOPE		L-LOAM			
N-NOSE SLOPE	III	SI-SILT-	0.6 - 0.3	EFI-EXTREMELY FIRM	NP-NON-PLASTIC SP-SLIGHTLY STICKY P-PLASTIC VP-VERY PLASTIC
H-HEAD SLOPE		SIL-SILT LOAM			
CC-CONCLAVE SLOPE		CL-CLAY LOAM			
CV-CONVEX SLOPE		SCL-SANDY CLAY LOAM			
T-TERRACE		SICL-SILTY CLAY LOAM			
FP-FLOOD PLAN	IV	SIC-SILTY CLAY	0.4 - 0.1		
		C-CLAY			
		SC-SANDY CLAY			

STRUCTURE

- SG-SINGLE GRAIN
- M-MASSIVE
- CR-CRUMB
- GR-GRANULAR
- SBK-SUBANGULAR BLOCKY
- ABK-ANGULAR BLOCKY
- PL-PLATY
- PR-PRISMATIC

MINERALOGY

- SLIGHTLY EXPANSIVE
- EXPANSIVE

Show profile locations and other site features (dimensions, reference or benchmark, and North).

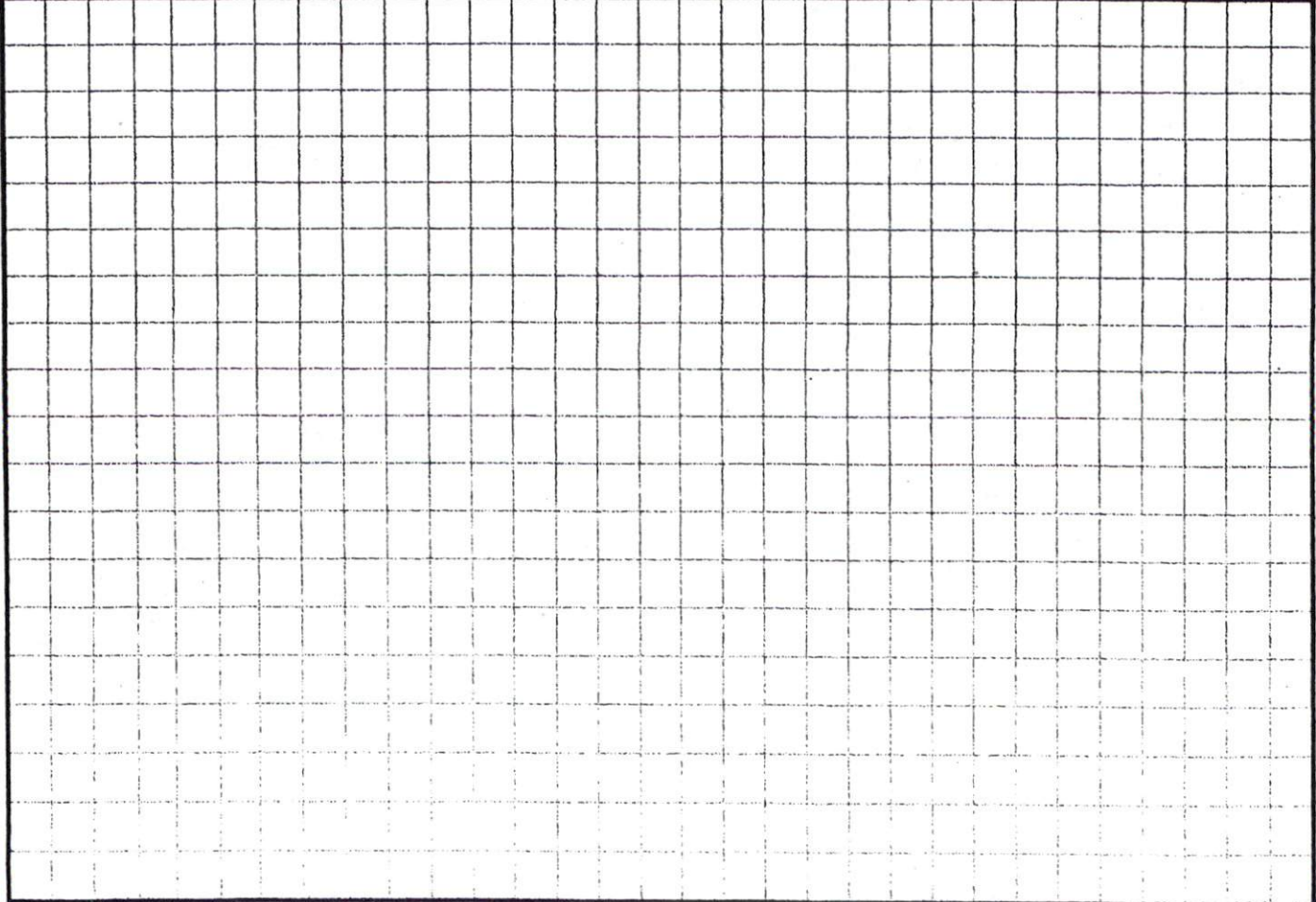

SITE PLAN APPROVAL

DISTRICT BAACB USE SFD

#BEDROOMS 3

Date 5/13/05
Zoning RE-MIN-1-R2000

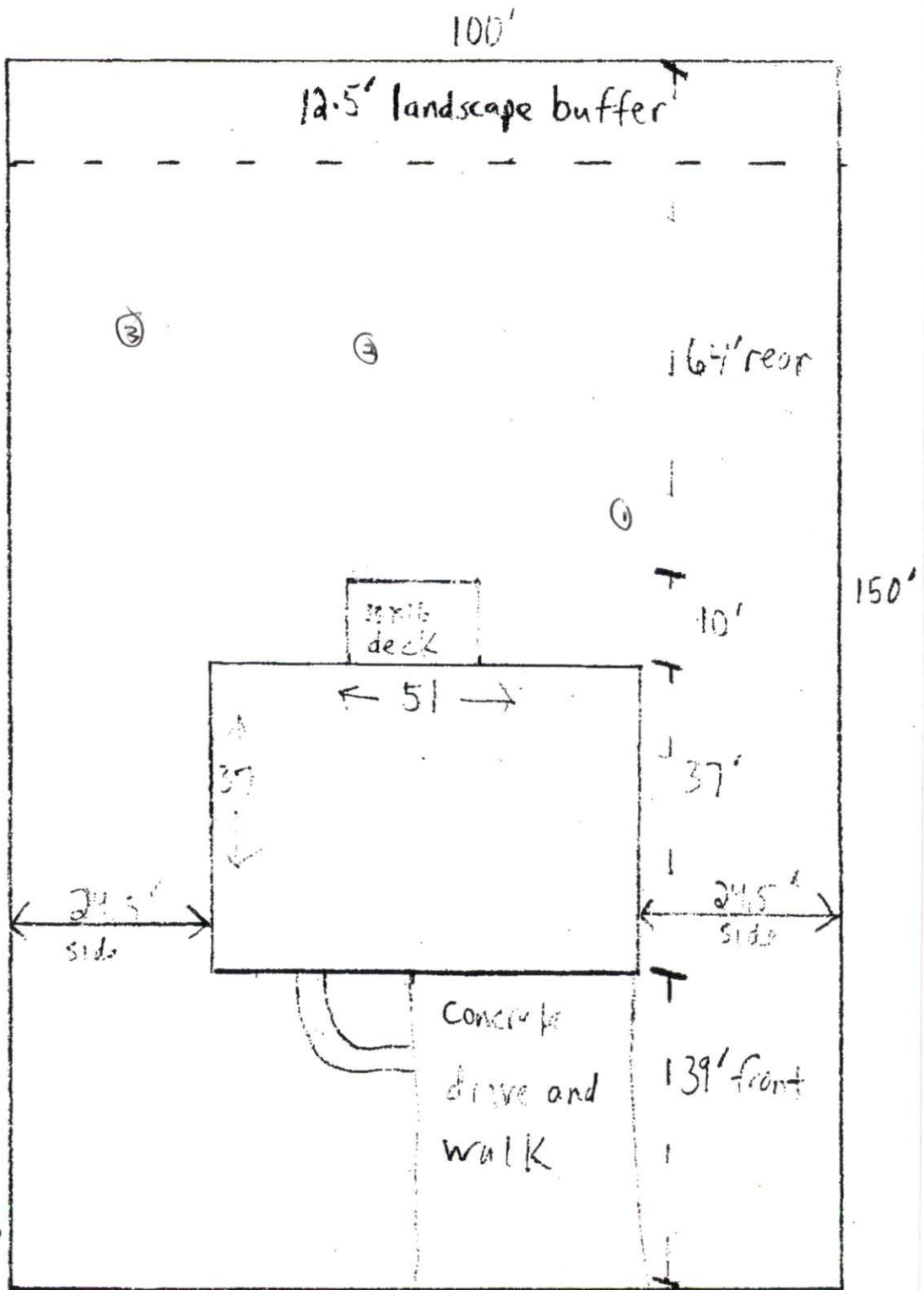

Lot 166 Northview Dr.,
Sunset Ridge, Sec. 3

1=200