

ADDRESS : 78 WILLOWCROFT CT
CONTRACTOR : STANTON HOMES INC.
OWNER : AUTRY JAMES DALE & JULIA P
PARCEL : 02-1518- - -0099- -17-
APPL NUMBER: 09-50022030 CP NEW RESIDENTIAL (SFD)
DIRECTIONS : 78 WILLOWCROFT COURT, LEIGH LAUREL SUB
DIV #14 OFF OF FAIRGROUND RD. 421S TO
FAIRGROUND RD, 3MI RIGHT INTO SUB DIV
ON BIRCHDALE DR, RIGHT ONTO WILLOWCROFT
COURT #14.
T/S: 05/06/2009 10:23 AM VBROWN ----
*****PREMIS NUMBER 55967823*****
LAND NOTES : LXMN 6/18/04 LEIGH LAUREL SD LOT#14
LXMN 6/21/04 SPLIT FROM THE 03 PARCEL

SUBDIV: LEIGH LAUREL
PHONE : (919) 278-8070
PHONE :

*Call for T pole
@ 2:33 PM*

STRUCTURE: 000 000 48X54 4BDR 3BATH WITH GAR, DECK, CRAWL

FLOOD ZONE : FLOOD ZONE X

BEDROOMS : 4.00

PROPOSED USE : SFD

SEPTIC - EXISTING? : NEW SEPTIC

WATER SUPPLY : COUNTY

PERMIT: CPSF 00 CP * SFD

TYP/SQ	REQUESTED COMPLETED	INSP RESULT	DESCRIPTION RESULTS/COMMENTS
B101 01	5/29/09 <i>5-29</i>	TI <i>AP</i>	R*BLDG FOOTING / TEMP SVC POLE TIME: 13:00 REQUESTING 1:00PM INSPECTION. WILL CALL IN MORNING TO CONFIRM. RD VRU #: 001774207

COMMENTS AND NOTES

ADDRESS : 78 WILLOWCROFT CT SUBDIV: LEIGH LAUREL
CONTRACTOR : STANTON HOMES INC. PHONE : (919) 278-8070
OWNER : AUTRY JAMES DALE & JULIA P PHONE :
PARCEL : 02-1518- - -0099- -17-
APPL NUMBER: 09-50022030 CP NEW RESIDENTIAL (SFD)

DIRECTIONS : 78 WILLOWCROFT COURT, LEIGH LAUREL SUB
DIV #14 OFF OF FAIRGROUND RD. 421S TO
FAIRGROUND RD, 3MI RIGHT INTO SUB DIV
ON BIRCHDALE DR, RIGHT ONTO WILLOWCROFT
COURT #14.
T/S: 05/06/2009 10:23 AM VBROWN ----
*****PREMIS NUMBER 55967823*****
LAND NOTES : LXMN 6/18/04 LEIGH LAUREL SD LOT#14
LXMN 6/21/04 SPLIT FROM THE 03 PARCEL

STRUCTURE: 000 000 48X54 4BDR 3BATH WITH GAR, DECK, CRAWL
FLOOD ZONE : FLOOD ZONE X
BEDROOMS : 4.00 PROPOSED USE : SFD
SEPTIC - EXISTING? : NEW SEPTIC WATER SUPPLY : COUNTY

PERMIT: CPSF 00 CP * SFD

TYP/SQ	REQUESTED COMPLETED	INSP RESULT	DESCRIPTION RESULTS/COMMENTS
B101 01	5/29/09 5/29/09	KS AP	R*BLDG FOOTING / TEMP SVC POLE TIME: 13:00 VRU #: 001774207 REQUESTING 1:00PM INSPECTION. WILL CALL IN MORNING TO CONFIRM. RD t-pole inspected OK
B104 01	6/02/09 6/01/09	TI CA	R*BLDG FOUNDATION SURVEY VRU #: 001775329
B103 01	6/02/09 <u>6-02</u>	TI <u>DP</u>	R*BLDG FOUND & TEMP SVC POLE TIME: 17:00 VRU #: 001775857

----- COMMENTS AND NOTES -----

PAGE () OF ()	ADDRESS:		NAME: SAMIR W. BAHHO P.E. CIVIL & STRUCTURAL ENGINEERING SERVICES, PLLC
PHONE: 919-851-1642	4812 KAPLAN DRIVE		
CELL: 919-621-1960	RALEIGH, NC 27806		
FAX: 919-854-1960			

Structural Notes

1. Floor Joists : Use 2x10 @ 16" o.c.
2. Walls : Use Stud Walls 2x4
3. Ceiling Joists : Use 2x8 @ 16" o.c.
4. Rafters : Use 2x8 @ 16" o.c.
5. Valleys, HIPS & Rises : Use 2x10

Post-it® Fax Note	7671	Date	6/1/09	# of pages	1
To	Stan William	From	Samir Bahho		
Co./Dept.	Stanton Homes	Co.	Civil & Str.		
Phone	(919) 278-8070	Phone	(919) 621-0628		
Fax	(919) 577-0559	Fax	(919) 854-1960		

Samir Bahho
June 01, 09

FOUNDATION 8" Block or Brick on Block with Top 8" Solid
over 24"x10" concrete footer

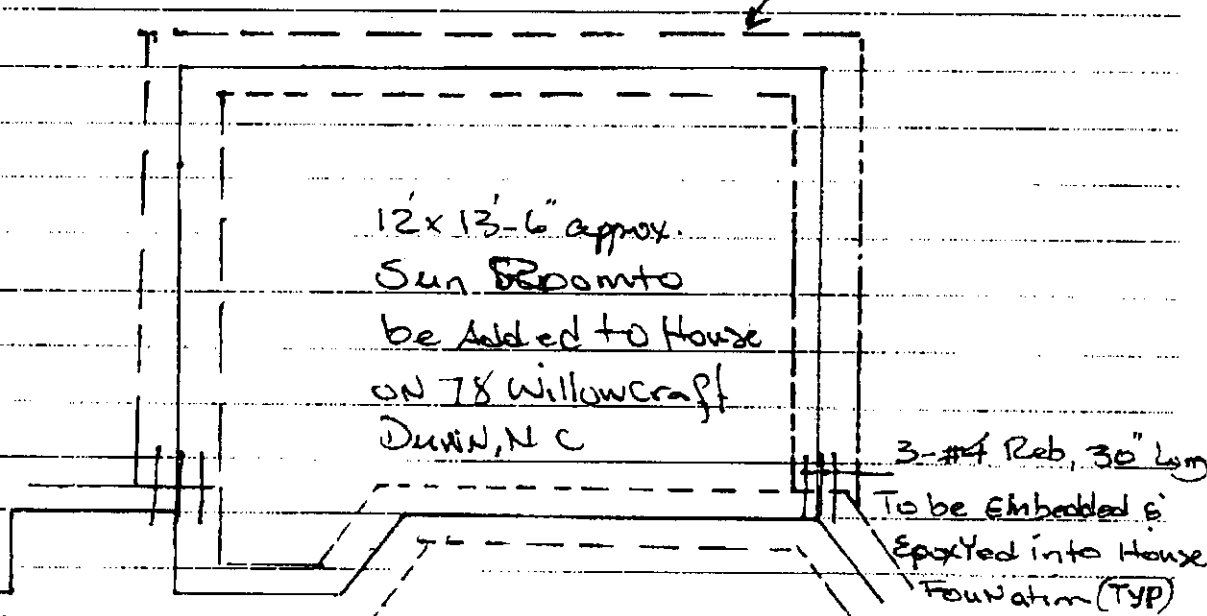

SUN ROOM to be Added to
Back of House under construction
78 Willowcraft, DUNN, NC

ADDRESS : 78 WILLOWCROFT CT SUBDIV: LEIGH LAUREL
 CONTRACTOR : STANTON HOMES INC. PHONE : (919) 278-8070
 OWNER : AUTRY JAMES DALE & JULIA P PHONE :
 PARCEL : 02-1518- - -0099- -17-
 APPL NUMBER: 09-50022030 CP NEW RESIDENTIAL (SFD)
 DIRECTIONS : 78 WILLOWCROFT COURT, LEIGH LAUREL SUB
 DIV #14 OFF OF FAIRGROUND RD. 421S TO
 FAIRGROUND RD, 3MI RIGHT INTO SUB DIV
 ON BIRCHDALE DR, RIGHT ONTO WILLOWCROFT
 COURT #14.
 T/S: 05/06/2009 10:23 AM VBROWN ----
 *****PREMIS NUMBER 55967823*****

LAND NOTES : LXMN 6/18/04 LEIGH LAUREL SD LOT#14
 LXMN 6/21/04 SPLIT FROM THE 03 PARCEL

STRUCTURE: 000 000 48X54 4BDR 3BATH WITH GAR, SUNRM, CRAWL
 FLOOD ZONE : FLOOD ZONE X
 # BEDROOMS : 4.00 PROPOSED USE : SFD
 SEPTIC - EXISTING? : NEW SEPTIC WATER SUPPLY : COUNTY

PERMIT: CPSF 00 CP * SFD

TYP/SQ	REQUESTED COMPLETED	INSP RESULT	DESCRIPTION RESULTS/COMMENTS
B101 01	5/29/09 5/29/09	KS AP	R*BLDG FOOTING / TEMP SVC POLE TIME: 13:00 VRU #: 001774207 REQUESTING 1:00PM INSPECTION. WILL CALL IN MORNING TO CONFIRM. RD t-pole inspected OK
B104 01	6/02/09 6/01/09	TI CA	R*BLDG FOUNDATION SURVEY VRU #: 001775329
B103 01	6/02/09 6/02/09	KS DP	R*BLDG FOUND & TEMP SVC POLE TIME: 17:00 VRU #: 001775857 Foundation not complete nor permitted. Do not start floor framing. \$50 re-inspection fee.
B103 02	6/03/09 6/03/09	KS CA	R*BLDG FOUND & TEMP SVC POLE VRU #: 001776301
A814 01	6/03/09 6/03/09	TI AP	ADDRESS CONFIRMATION TIME: 17:00 VRU #: 001776319 78 willowcroft ct lot 14 dunn 28334
B113 01	6/03/09 6/03/09	KS CA	R*BLDG WATER/DAMP PROOFING TIME: 17:00 VRU #: 001776327
P307 01	6/03/09 6/03/09	KS CA	R*PLUMBWATER CONNECTION TIME: 17:00 VRU #: 001776335
B104 02	6/08/09 6/05/09	TI CA	R*BLDG FOUNDATION SURVEY VRU #: 001778141 Please include damp proofing inspection and main water line trench.
B103 03	6/08/09 6/08/09	KS AP	R*BLDG FOUND & TEMP SVC POLE TIME: 17:00 VRU #: 001778430
B105 01	6/09/09 <u>6-9</u>	TI <u>AP</u>	R*OPEN FLOOR VRU #: 001778679 Floor system will be ready monday evening

----- COMMENTS AND NOTES -----

ADDRESS . : 78 WILLOWCROFT CT SUBDIV: LEIGH LAUREL
 CONTRACTOR : STANTON HOMES INC. PHONE : (919) 278-8070
 OWNER . . : AUTRY JAMES DALE & JULIA P PHONE :
 PARCEL . . : 02-1518- - -0099- -17-
 APPL NUMBER: 09-50022030 CP NEW RESIDENTIAL (SFD)
 DIRECTIONS : 78 WILLOWCROFT COURT, LEIGH LAUREL SUB
 DIV #14 OFF OF FAIRGROUND RD. 421S TO
 FAIRGROUND RD, 3MI RIGHT INTO SUB DIV
 ON BIRCHDALE DR, RIGHT ONTO WILLOWCROFT
 COURT #14.
 T/S: 05/06/2009 10:23 AM VBROWN ----
 *****PREMIS NUMBER 55967823*****

LAND NOTES : LXMN 6/18/04 LEIGH LAUREL SD LOT#14
 LXMN 6/21/04 SPLIT FROM THE 03 PARCEL

STRUCTURE: 000 000 48X54 4BDR 3BATH WITH GAR, SUNRM, CRAWL
 FLOOD ZONE : FLOOD ZONE X
 # BEDROOMS : 4.00 PROPOSED USE : SFD
 SEPTIC - EXISTING? : NEW SEPTIC WATER SUPPLY : COUNTY

PERMIT: CPSF 00 CP * SFD

TYP/SQ	REQUESTED COMPLETED	INSP RESULT	DESCRIPTION RESULTS/COMMENTS
B101 01	5/29/09 5/29/09	KS AP	R*BLDG FOOTING / TEMP SVC POLE TIME: 13:00 VRU #: 001774207 REQUESTING 1:00PM INSPECTION. WILL CALL IN MORNING TO CONFIRM. RD t-pole inspected OK
B104 01	6/02/09 6/01/09	TI CA	R*BLDG FOUNDATION SURVEY VRU #: 001775329
B103 01	6/02/09 6/02/09	KS DP	R*BLDG FOUND & TEMP SVC POLE TIME: 17:00 VRU #: 001775857 Foundation not complete nor permitted. Do not start floor framing. \$50 re-inspection fee.
B103 02	6/03/09 6/03/09	KS CA	R*BLDG FOUND & TEMP SVC POLE VRU #: 001776301
A814 01	6/03/09 6/03/09	TI AP	ADDRESS CONFIRMATION TIME: 17:00 VRU #: 001776319 78 willowcroft ct lot 14 dunn 28334
B113 01	6/03/09 6/03/09	KS CA	R*BLDG WATER/DAMP PROOFING TIME: 17:00 VRU #: 001776327
P307 01	6/03/09 6/03/09	KS CA	R*PLUMB WATER CONNECTION TIME: 17:00 VRU #: 001776335
B104 02	6/08/09 6/05/09	TI CA	R*BLDG FOUNDATION SURVEY VRU #: 001778141 Please include damp proofing inspection and main water line trench.
B103 03	6/08/09 6/08/09	KS AP	R*BLDG FOUND & TEMP SVC POLE TIME: 17:00 VRU #: 001778430
B105 01	6/09/09 6/09/09	KS AP	R*OPEN FLOOR VRU #: 001778679 Floor system will be ready monday evening
R427 01	6/22/09	TI	FOUR TRADE ROUGH IN >2500 VRU #: 001784453

G-22 DIA

----- COMMENTS AND NOTES -----

Violation Notice
Do Not Remove

Harnett County Inspection Department
102 East Front St P.O. Box 65
Lillington, NC 27546
Phone (910) 893-7525 Fax (910) 893-2793

09-50022030

June 22, 2009

1. Insulation baffles shall be installed for rough-in
2. Top plate plumbing and electrical not fire caulked.
3. Need to install flashing for brick veneer.
4. Fire caulk plywood to right of garaged entry door.
5. Water not in standpipe.
6. Bath tub traps not rat proofed.
7. Valley rafters shall be supported at the ridge to bearing point.
8. Extend platform for hvac to attic access.
9. No more than 2 studs can be bored and shall be doubled in upstairs bathroom
10. Install roof and roof boots for plumbing vents.
11. Seal drain thru foundation.
12. Install front door and bathroom window.
13. Need tempered window next to rear door.

Do not brick nor insulate until re-inspection

Ken Slattum

ADDRESS : 78 WILLOWCROFT CT SUBDIV: LEIGH LAUREL
 CONTRACTOR : STANTON HOMES INC. PHONE : (919) 278-8070
 OWNER : AUTRY JAMES DALE & JULIA P PHONE :
 PARCEL : 02-1518- - -0099- -17-
 APPL NUMBER: 09-50022030 CP NEW RESIDENTIAL (SFD)
 DIRECTIONS : 78 WILLOWCROFT COURT, LEIGH LAUREL SUB
 DIV #14 OFF OF FAIRGROUND RD. 421S TO
 FAIRGROUND RD, 3MI RIGHT INTO SUB DIV
 ON BIRCHDALE DR, RIGHT ONTO WILLOWCROFT
 COURT #14.
 T/S: 05/06/2009 10:23 AM VBROWN ----
 *****PREMIS NUMBER 55967823*****
 LAND NOTES : LXMN 6/18/04 LEIGH LAUREL SD LOT#14
 LXMN 6/21/04 SPLIT FROM THE 03 PARCEL

STRUCTURE: 000 000 48X54 4BDR 3BATH WITH GAR, SUNRM, CRAWL
 FLOOD ZONE : FLOOD ZONE X
 # BEDROOMS : 4.00 PROPOSED USE : SFD
 SEPTIC - EXISTING? : NEW SEPTIC WATER SUPPLY : COUNTY

PERMIT: CPSF 00 CP * SFD

TYP/SQ	REQUESTED COMPLETED	INSP RESULT	DESCRIPTION RESULTS/COMMENTS
B101 01	5/29/09 5/29/09	KS AP	R*BLDG FOOTING / TEMP SVC POLE TIME: 13:00 VRU #: 001774207 REQUESTING 1:00PM INSPECTION. WILL CALL IN MORNING TO CONFIRM. RD t-pole inspected OK
B104 01	6/02/09 6/01/09	TI CA	R*BLDG FOUNDATION SURVEY VRU #: 001775329
B103 01	6/02/09 6/02/09	KS DP	R*BLDG FOUND & TEMP SVC POLE TIME: 17:00 VRU #: 001775857 Foundation not complete nor permitted. Do not start floor framing. \$50 re-inspection fee.
B103 02	6/03/09 6/03/09	KS CA	R*BLDG FOUND & TEMP SVC POLE VRU #: 001776301
A814 01	6/03/09 6/03/09	TI AP	ADDRESS CONFIRMATION TIME: 17:00 VRU #: 001776319 78 willowcroft ct lot 14 dunn 28334
B113 01	6/03/09 6/03/09	KS CA	R*BLDG WATER/DAMP PROOFING TIME: 17:00 VRU #: 001776327
P307 01	6/03/09 6/03/09	KS CA	R*PLUMB WATER CONNECTION TIME: 17:00 VRU #: 001776335
B104 02	6/08/09 6/05/09	TI CA	R*BLDG FOUNDATION SURVEY VRU #: 001778141 Please include damp proofing inspection and main water line trench.
B103 03	6/08/09 6/08/09	KS AP	R*BLDG FOUND & TEMP SVC POLE TIME: 17:00 VRU #: 001778430
B105 01	6/09/09 6/09/09	KS AP	R*OPEN FLOOR VRU #: 001778679 Floor system will be ready monday evening
R427 01	6/22/09	TI	FOUR TRADE ROUGH IN >2500 VRU #: 001784453
R327 01	6/23/09 <u>6-23</u>	TI <u>DA</u>	THREE TRADE ROUGH IN >2500 VRU #: 001784982

COMMENTS AND NOTES

ADDRESS : 78 WILLOWCROFT CT SUBDIV: LEIGH LAUREL
CONTRACTOR : STANTON HOMES INC. PHONE : (919) 278-8070
OWNER : AUTRY JAMES DALE & JULIA P PHONE :
PARCEL : 02-1518- - -0099- -17-
APPL NUMBER: 09-50022030 CP NEW RESIDENTIAL (SFD)
DIRECTIONS : 78 WILLOWCROFT COURT, LEIGH LAUREL SUB
DIV #14 OFF OF FAIRGROUND RD. 421S TO
FAIRGROUND RD, 3MI RIGHT INTO SUB DIV
ON BIRCHDALE DR, RIGHT ONTO WILLOWCROFT
COURT #14.
T/S: 05/06/2009 10:23 AM VBROWN ----
*****PREMIS NUMBER 55967823*****
LAND NOTES : LXMN 6/18/04 LEIGH LAUREL SD LOT#14
LXMN 6/21/04 SPLIT FROM THE 03 PARCEL

STRUCTURE: 000 000 48X54 4BDR 3BATH WITH GAR, SUNRM, CRAWL
FLOOD ZONE : FLOOD ZONE X
BEDROOMS : 4.00 PROPOSED USE : SFD
SEPTIC - EXISTING? : NEW SEPTIC WATER SUPPLY : COUNTY

PERMIT: CPSF 00 CP * SFD

TYP/SQ	REQUESTED COMPLETED	INSP RESULT	DESCRIPTION RESULTS/COMMENTS
B101 01	5/29/09 5/29/09	KS AP	R*BLDG FOOTING / TEMP SVC POLE TIME: 13:00 VRU #: 001774207 REQUESTING 1:00PM INSPECTION. WILL CALL IN MORNING TO CONFIRM. RD t-pole inspected OK
B104 01	6/02/09 6/01/09	TI CA	R*BLDG FOUNDATION SURVEY VRU #: 001775329
B103 01	6/02/09 6/02/09	KS DP	R*BLDG FOUND & TEMP SVC POLE TIME: 17:00 VRU #: 001775857 Foundation not complete nor permitted. Do not start floor framing. \$50 re-inspection fee.
B103 02	6/03/09 6/03/09	KS CA	R*BLDG FOUND & TEMP SVC POLE VRU #: 001776301
A814 01	6/03/09 6/03/09	TI AP	ADDRESS CONFIRMATION TIME: 17:00 VRU #: 001776319 78 willowcroft ct lot 14 dunn 28334
B113 01	6/03/09 6/03/09	KS CA	R*BLDG WATER/DAMP PROOFING TIME: 17:00 VRU #: 001776327
P307 01	6/03/09 6/03/09	KS CA	R*PLUMBWATER CONNECTION TIME: 17:00 VRU #: 001776335
B104 02	6/08/09 6/05/09	TI CA	R*BLDG FOUNDATION SURVEY VRU #: 001778141 Please include damp proofing inspection and main water line trench.
B103 03	6/08/09 6/08/09	KS AP	R*BLDG FOUND & TEMP SVC POLE TIME: 17:00 VRU #: 001778430
B105 01	6/09/09 6/09/09	KS AP	R*OPEN FLOOR VRU #: 001778679 Floor system will be ready monday evening
R427 01	6/22/09 6/22/09	KS DA	FOUR TRADE ROUGH IN >2500 VRU #: 001784453 1. Need baffles installed 2. Top plate not firecaulked. 3. Install flassing for brick veneer. 4. Fire caulk plywood in dead space to right of garage. 5. No water in standpipe. 6. Bathtubs no ratproofed.

ADDRESS : 78 WILLOWCROFT CT
 CONTRACTOR : STANTON HOMES INC.
 OWNER : AUTRY JAMES DALE & JULIA P
 PARCEL : 02-1518- - -0099- -17-
 APPL NUMBER: 09-50022030 CP NEW RESIDENTIAL (SFD)

SUBDIV: LEIGH LAUREL
 PHONE : (919) 278-8070
 PHONE :

TYP/SQ	REQUESTED COMPLETED	INSP RESULT	DESCRIPTION RESULTS/COMMENTS
			7. Extend platform to access hole 8. valley rafters not supported 9. no more than 2 studs can be bored. 10. install roof and boots. 11. seal drain in foundation 12. install front door and bathroom window. 13. need tempered glass at rear door.
R327 01	6/23/09 6/23/09	KS DA	THREE TRADE ROUGH IN >2500 VRU #: 001784982 1. Valley rafter not supported to load point. 2. Drains for pstairs bathroom not corrected. Ok to insulate.
I129 01	6/26/09 <u>6-26</u>	TI <u>AP</u>	R*INSULATION INSPECTION TIME: 17:00 VRU #: 001786078 T/S: 06/24/2009 11:54 AM NTART -----
R127 01	6/26/09 6/24/09	TI CA	ONE TRADE ROUGH IN > 2500 TIME: 17:00 VRU #: 001785393 Insulation Inspection T/S: 06/24/2009 11:53 AM NTART ----- T/S: 06/24/2009 11:54 AM NTART -----
R427 02	6/26/09 <u>6-26</u>	TI <u>AP</u>	FOUR TRADE ROUGH IN >2500 TIME: 17:00 VRU #: 001786094 T/S: 06/24/2009 11:54 AM NTART -----

COMMENTS AND NOTES

ADDRESS : 78 WILLOWCROFT CT SUBDIV: LEIGH LAUREL
 CONTRACTOR : STANTON HOMES INC. PHONE : (919) 278-8070
 OWNER : AUTRY JAMES DALE & JULIA P PHONE :
 PARCEL : 02-1518- - -0099- -17-
 APPL NUMBER: 09-50022030 CP NEW RESIDENTIAL (SFD)
 DIRECTIONS : 78 WILLOWCROFT COURT, LEIGH LAUREL SUB
 DIV #14 OFF OF FAIRGROUND RD. 421S TO
 FAIRGROUND RD, 3MI RIGHT INTO SUB DIV
 ON BIRCHDALE DR, RIGHT ONTO WILLOWCROFT
 COURT #14.
 T/S: 05/06/2009 10:23 AM VBROWN ----
 *****PREMIS NUMBER 55967823*****
 LAND NOTES : LXMN 6/18/04 LEIGH LAUREL SD LOT#14
 LXMN 6/21/04 SPLIT FROM THE 03 PARCEL

STRUCTURE: 000 000 48X54 4BDR 3BATH WITH GAR, SUNRM,CRAWL
 FLOOD ZONE : FLOOD ZONE X
 # BEDROOMS : 4.00 PROPOSED USE : SFD
 SEPTIC - EXISTING? : NEW SEPTIC WATER SUPPLY : COUNTY

PERMIT: CPSF 00 CP * SFD

TYP/SQ	REQUESTED COMPLETED	INSP RESULT	DESCRIPTION RESULTS/COMMENTS
B101 01	5/29/09 5/29/09	KS AP	R*BLDG FOOTING / TEMP SVC POLE TIME: 13:00 VRU #: 001774207 REQUESTING 1:00PM INSPECTION. WILL CALL IN MORNING TO CONFIRM. RD t-pole inspected OK
B104 01	6/02/09 6/01/09	TI CA	R*BLDG FOUNDATION SURVEY VRU #: 001775329
B103 01	6/02/09 6/02/09	KS DP	R*BLDG FOUND & TEMP SVC POLE TIME: 17:00 VRU #: 001775857 Foundation not complete nor permitted. Do not start floor framing. \$50 re-inspection fee.
B103 02	6/03/09 6/03/09	KS CA	R*BLDG FOUND & TEMP SVC POLE VRU #: 001776301
A814 01	6/03/09 6/03/09	TI AP	ADDRESS CONFIRMATION TIME: 17:00 VRU #: 001776319 ✓78 willowcroft ct lot 14 dunn 28334
B113 01	6/03/09 6/03/09	KS CA	R*BLDG WATER/DAMP PROOFING TIME: 17:00 VRU #: 001776327
P307 01	6/03/09 6/03/09	KS CA	R*PLUMB WATER CONNECTION TIME: 17:00 VRU #: 001776335
B104 02	6/08/09 6/05/09	TI CA	R*BLDG FOUNDATION SURVEY VRU #: 001778141 Please include damp proofing inspection and main water line trench.
B103 03	6/08/09 6/08/09	KS AP	R*BLDG FOUND & TEMP SVC POLE TIME: 17:00 VRU #: 001778430
B105 01	6/09/09 6/09/09	KS AP	R*OPEN FLOOR VRU #: 001778679 Floor system will be ready monday evening
R427 01	6/22/09 6/22/09	KS DA	FOUR TRADE ROUGH IN >2500 VRU #: 001784453 1. Need baffles installed 2. Top plate not firecaulked. 3. Install flassing for brick veneer. 4. Fire caulk plywood in dead space to right of garage. 5. No water in standpipe. 6. Bathtubs no ratproofed.

ADDRESS : 78 WILLOWCROFT CT
 CONTRACTOR : STANTON HOMES INC.
 OWNER : AUTRY JAMES DALE & JULIA P
 PARCEL : 02-1518- - -0099- -17-
 APPL NUMBER: 09-50022030 CP NEW RESIDENTIAL (SFD)

SUBDIV: LEIGH LAUREL
 PHONE : (919) 278-8070
 PHONE :

TYP/SQ	REQUESTED COMPLETED	INSP RESULT	DESCRIPTION RESULTS/COMMENTS
			7. Extend platform to access hole 8. valley rafters not supported 9. no more than 2 studs can be bored. 10. install roof and boots. 11. seal drain in foundation 12. install front door and bathroom window. 13. need tempered glass at rear door.
R327 01	6/23/09	KS	THREE TRADE ROUGH IN >2500 VRU #: 001784982
	6/23/09	DA	1. Valley rafter not supported to load point. 2. Drains for pstairs bathroom not corrected. Ok to insulate.
I129 01	6/26/09	KS	R*INSULATION INSPECTION TIME: 17:00 VRU #: 001786078
	6/26/09	AP	T/S: 06/24/2009 11:54 AM NTART -----
R127 01	6/26/09	TI	ONE TRADE ROUGH IN > 2500 TIME: 17:00 VRU #: 001785393
	6/24/09	CA	Insulation Inspection T/S: 06/24/2009 11:53 AM NTART ----- T/S: 06/24/2009 11:54 AM NTART -----
R427 02	6/26/09	KS	FOUR TRADE ROUGH IN >2500 TIME: 17:00 VRU #: 001786094
	6/26/09	AP	T/S: 06/24/2009 11:54 AM NTART -----
H824 01	7/22/09	JM	✓ ENVIR. OPERATIONS PERMIT TIME: 17:00 VRU #: 001799493
	7/22/09	AP	T/S: 07/23/2009 10:31 AM SSTEWARD ----- T/S: 07/23/2009 10:34 AM SSTEWARD -----
R431 01	8/05/09	TI	FOUR TRADE FINAL >2500 VRU #: 001804939
	<u>8-5-09</u>	<u>DPBS</u>	

----- COMMENTS AND NOTES -----

Harnett County

INSPECTOR: IVR

DATE 8/11/09

ADDRESS : 78 WILLOWCROFT CT
CONTRACTOR : STANTON HOMES INC.
OWNER : AUTRY JAMES DALE & JULIA P
PARCEL : 02-1518- - -0099- -17-

SUBDIV: LEIGH LAUREL
PHONE : (919) 278-8070
PHONE :

APPL NUMBER: 09-50022030 CP NEW RESIDENTIAL (SFD)
DIRECTIONS : 78 WILLOWCROFT COURT, LEIGH LAUREL SUB
DIV #14 OFF OF FAIRGROUND RD. 421S TO
FAIRGROUND RD, 3MI RIGHT INTO SUB DIV
ON BIRCHDALE DR, RIGHT ONTO WILLOWCROFT
COURT #14.

T/S: 05/06/2009 10:23 AM VBROWN ----
*****PREMIS NUMBER 55967823*****

LAND NOTES : LXMN 6/18/04 LEIGH LAUREL SD LOT#14
LXMN 6/21/04 SPLIT FROM THE 03 PARCEL

Called 11 08

STRUCTURE: 000 000 48X54 4BDR 3BATH WITH GAR, SUNRM,CRAWL

FLOOD ZONE : FLOOD ZONE X

BEDROOMS : 4.00

PROPOSED USE : SFD

SEPTIC - EXISTING? : NEW SEPTIC

WATER SUPPLY : COUNTY

PERMIT: CPSF 00 CP * SFD

Table with 4 columns: TYP/SQ, REQUESTED COMPLETED, INSP RESULT, DESCRIPTION RESULTS/COMMENTS. Contains multiple rows of inspection records with dates, results (KS, AP, TI, CA, DP), and descriptions of work items like 'R*BLDG FOOTING / TEMP SVC POLE' and 'R*BLDG FOUND & TEMP SVC POLE'.

Waret County

INSPECTOR: IVR

DATE 8/11/09

 ADDRESS : 78 WILLOWCROFT CT
 CONTRACTOR : STANTON HOMES INC.
 OWNER : AUTRY JAMES DALE & JULIA P
 PARCEL : 02-1518- - -0099- -17-
 APPL NUMBER: 09-50022030 CP NEW RESIDENTIAL (SFD)

SUBDIV: LEIGH LAUREL
 PHONE : (919) 278-8070
 PHONE :

TYP/SQ	REQUESTED COMPLETED	INSP RESULT	DESCRIPTION RESULTS/COMMENTS
			7. Extend platform to access hole 8. valley rafters not supported 9. no more than 2 studs can be bored. 10. install roof and boots. 11. seal drain in foundation 12. install front door and bathroom window. 13. need tempered glass at rear door.
R327 01	6/23/09	KS	THREE TRADE ROUGH IN >2500 VRU #: 001784982
	6/23/09	DA	1. Valley rafter not supported to load point. 2. Drains for pstairs bathroom not corrected. Ok to insulate.
I129 01	6/26/09	KS	R*INSULATION INSPECTION TIME: 17:00 VRU #: 001786078
	6/26/09	AP	T/S: 06/24/2009 11:54 AM NTART -----
R127 01	6/26/09	TI	ONE TRADE ROUGH IN > 2500 TIME: 17:00 VRU #: 001785393
	6/24/09	CA	Insulation Inspection T/S: 06/24/2009 11:53 AM NTART ----- T/S: 06/24/2009 11:54 AM NTART -----
R427 02	6/26/09	KS	FOUR TRADE ROUGH IN >2500 TIME: 17:00 VRU #: 001786094
	6/26/09	AP	T/S: 06/24/2009 11:54 AM NTART -----
H824 01	7/22/09	JM	✓ ENVIR. OPERATIONS PERMIT TIME: 17:00 VRU #: 001799493
	7/22/09	AP	T/S: 07/23/2009 10:31 AM S STEWART ----- T/S: 07/23/2009 10:34 AM S STEWART -----
R431 01	8/05/09	BS	FOUR TRADE FINAL >2500 VRU #: 001804939
	8/05/09	DP	1. No address. 2. Need handrail on front. 3. Water heater not plumbed/gas line. 4. washer and micro rec. must be 20 amp rated. 5. Finish guardrails/handrails on stairs. 6. Install fan in living room. 7. Insulate pulldown. 8. Need float switch on attic AHU. 9. Caulk toilets. 10. Insulation down in kneewall upstairs. 11. Deck steps not finished. 12. Need tempered glass at rear door. 13. Clean out crawlspace. 14. Need access for whirlpool. 15. Insulate attic door in back upstairs bedroom. 16. Seal hvac lineset at unit. 17. Secure water service piping in crawlspace.
R331 01	8/07/09	TI	THREE TRADE FINAL >2500 VRU #: 001806058
	8/06/09	CA	Request PM inspection if possible T/S: 08/06/2009 02:08 PM NTART -----
R431 02	8/07/09	TI	FOUR TRADE FINAL >2500 TIME: 17:00 VRU #: 001805670
	8/07/09	CA	T/S: 08/06/2009 09:19 AM NTART ----- T/S: 08/07/2009 08:50 AM NTART -----
R331 02	8/10/09	TI	THREE TRADE FINAL >2500 VRU #: 001806181
	8/07/09	CA	T/S: 08/07/2009 08:50 AM NTART -----
R431 03	8/11/09	TI	FOUR TRADE FINAL >2500 VRU #: 001807130

Handwritten signature/initials

----- COMMENTS AND NOTES -----

**COUNTY OF HARNETT
DEPARTMENT OF BUILDING INSPECTION
AND PLANNING/DEVELOPMENT
CERTIFICATE OF OCCUPANCY**

This certificate issued pursuant to the requirements of Section 105 of the North Carolina State Building Code and the Harnett County Zoning Ordinance certifies at the time of issuance this structure was in compliance with the various ordinances of the County of Harnett regulating development and building construction or use. For the following:

Use Classification: Residential

Type of Construction: _____

Owner of Building: Starter Home

Building Address: 78 Willowcroft

Zoning District: _____

Zoning Permit No.: _____

Conditional Use Permit No.: _____

Building Permit No.: _____

Electrical Permit No.: _____

Insulation Permit No.: _____

Plumbing Permit No.: _____

Mech. Permit No.: _____

Envir. C.O. No.: _____

Date: 8-11-09

Ken Slatt

Building Official

Zoning Official

09 50022030